



MILAN DRAWER BED

Assembly instructions

Actual product size

Double: H131 x W144 x L206 cm

King: H131 x W159 x L216cm

Super King: H131 x W189 x L216cm

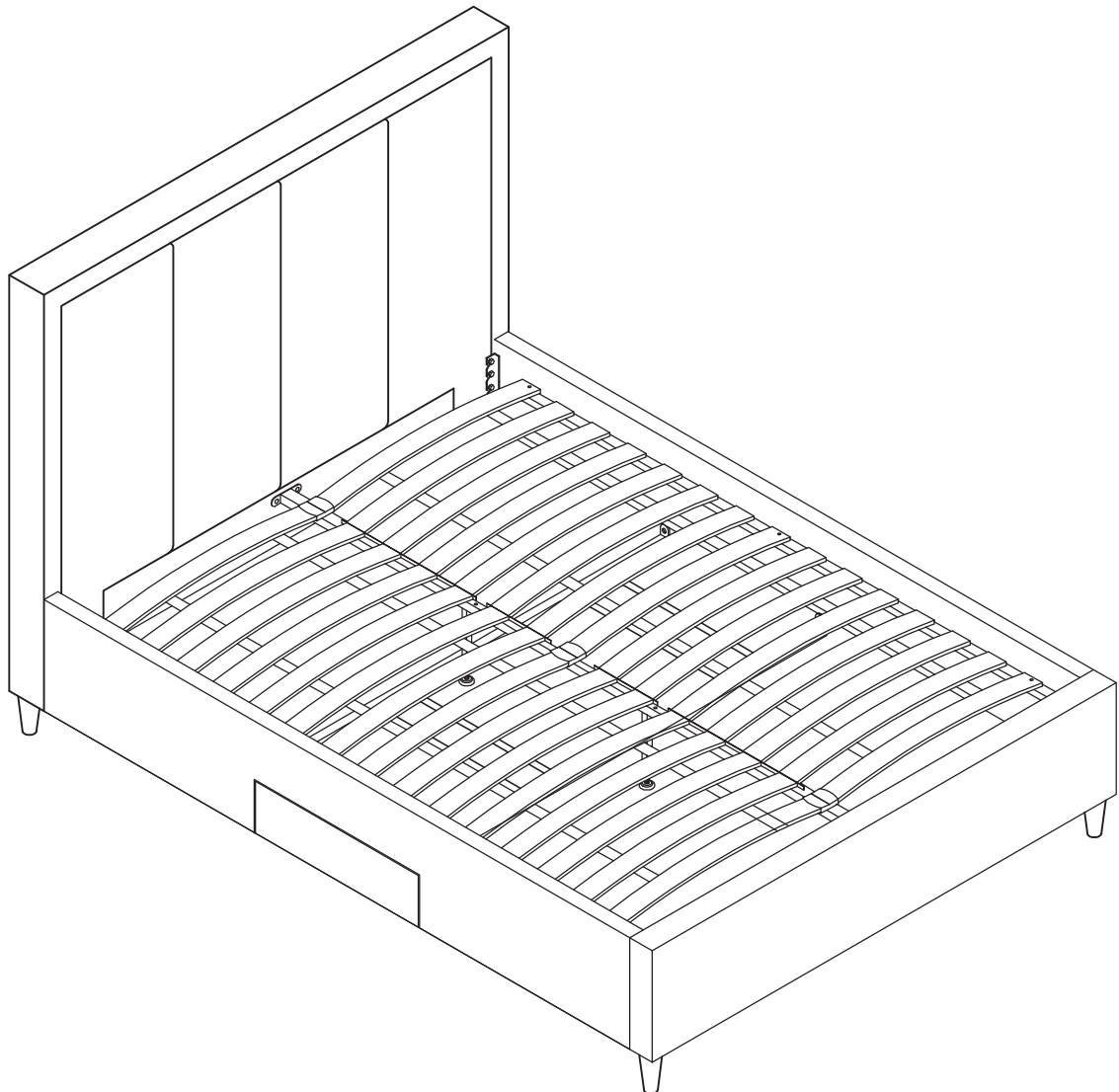

Item number	Fabric name	Fabric composition
577635	Wool Stone	51% Wool, 30% Viscose, 19% Polyester
586100	Wool Grey	51% Wool, 30% Viscose, 19% Polyester
566322	SCONT SLV	100 % polyester
920242	Opulence Stone	
347668	Opulence Steel	

IMPORTANT – RETAIN FOR FUTURE REFERENCE

Need Help?

With: Assembly instructions
Missing or damaged parts

CALL: 0333 777 8999



PARIS FLIP BED

Assembly instructions

BEFORE YOU START

Warnings

We suggest you retain these instructions for future reference.
Keep fittings out of children's reach and keep children well away from the construction area.
This product should only be used on firm, level ground.
Please periodically check all fittings and re-tighten as necessary.
Please do not jump or stand on your furniture.
Avoid exposing the furniture to excessive heat or direct sunlight as this can cause deterioration of the colour.
Unwrap all packaging materials and place the components on top of the carton box or on a clean floor to protect it from damage.

Do's

We suggest you spend a short time reading through this leaflet before you start.
When you are ready to start, make sure that you have the right tools and plenty of space.
Unwrap all packaging materials and place the components on a clean surface to protect it from damage.
We recommend that the packaging is used to protect the surfaces during assembly.
Carefully check that you have all the parts before beginning assembly.
Due to the size of the product we recommend that it is assembled in the room intended for use.
Ensure the product is fully assembled as illustrated and all fixings are fully tightened before use.
Lift your bed when moving it, never drag it. Please check that the center support rail is securely fixed in place.
When adjusting the support legs ensure that the foot is set 5-10 mm from the floor surface without the mattress in place. When in use the legs will create the required support for the product.
To clean your item, please use a vacuum or lightly brush clean.

Don'ts

Do not drag or pull your furniture.
Never allow any kind of liquid to remain on your furniture.
Absorption can cause materials to warp or finishes to de-laminate

Number of people required to assemble

Two persons are required to assemble this item.

Time to assemble

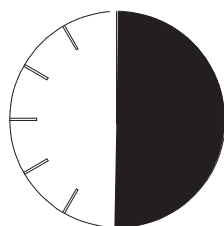

30 min.



Missing parts

If you are missing any fixtures and fittings for your product please contact our customer service team on 0333 777 8999 and they will be happy to arrange for a replacement to be sent to you free of charge.

Home service technicians

If you have a fault with your product please contact our customer service team on 0333 777 8999. If you have had the product for 28 days or less you may be offered a replacement, refund or for a fully trained home service technician to visit your home to assess the fault and repair the product where possible. If you have had the product for more than 28 days we will send an independent home service technician to review and repair the product where possible and recommend further action.

You can write to us at

Home Customer Services
Next Retail Ltd,
Desford Road,
Leicester,
LE19 4AT

To View our full furniture range please visit www.next.co.uk



MILAN DRAWER BED

Assembly instructions

GETTING TO KNOW YOUR PRODUCT

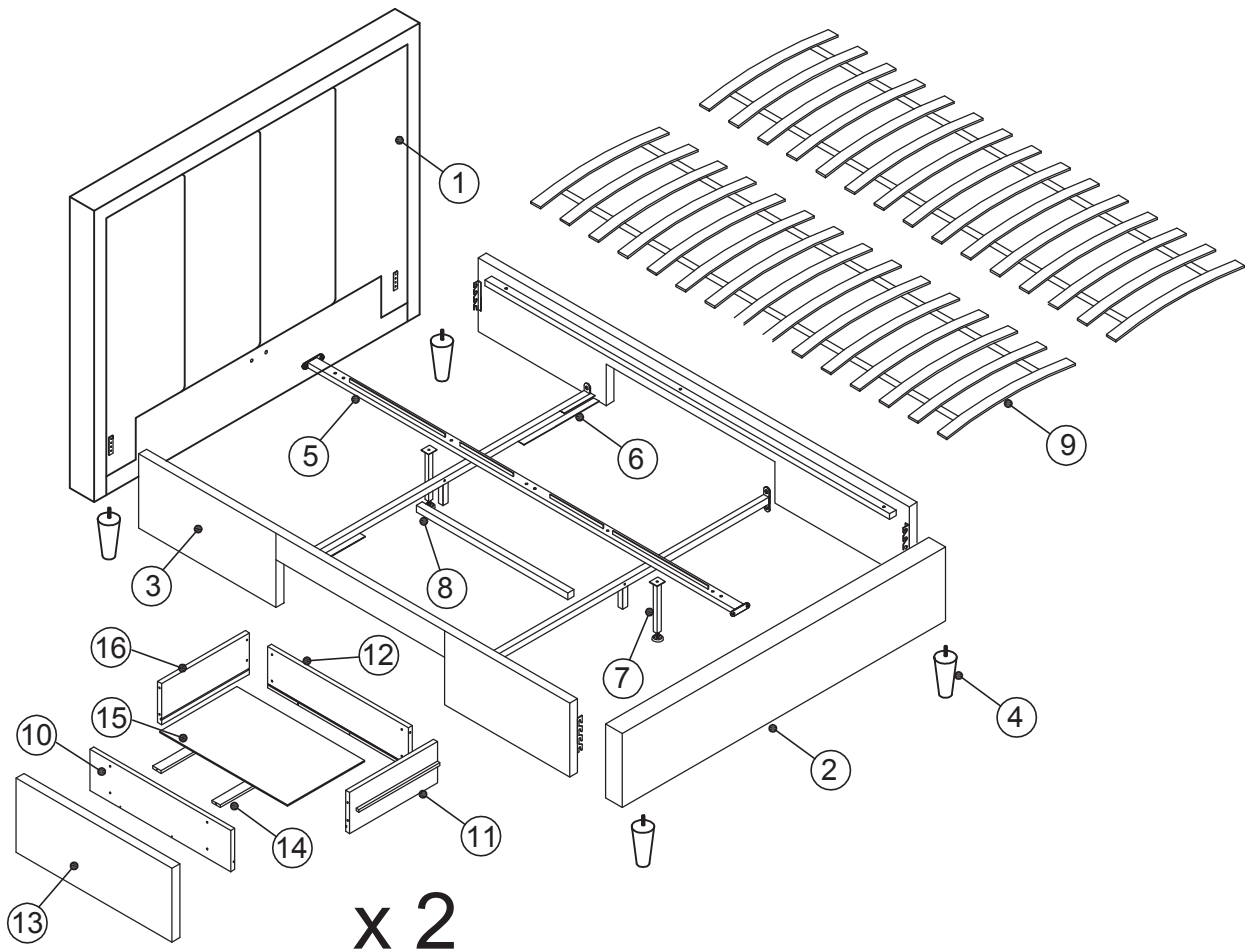

Components supplied. Please use this guide if you require replacement parts.

Ref	Dimension	Visual	Qty	Ref	Dimension	Visual	Qty
1	Double:144x117cm King:159x117cm Super King:189x117cm		1	9	Double:180 x 68cm King:190 x 75.6cm Super King:190 x 90cm		2
2	Double:144 x 31cm King: 159x31cm Super King:189x31cm		1	10	69 x 13cm		2
3	Double: 194x31cm King: 204x31cm Super King:204x31cm		2	11	55 x 13cm		2
4	14 x 6cm		4	12	69 x 13cm		2
5	Double:194 x 4cm King:204 x 4cm Super King:204 x 4cm		1	13	75 x 17.5cm		2
6	Double:137 x 20cm King:152 x 20cm Super King:182 x 20cm		2	14	52 x 6cm		4
7	31 x 2.5 cm		2	15	70.5 x 52.5cm		2
8	75 x 2.5cm		1	16	55 x 13cm		2



MILAN DRAWER BED

Assembly instructions

Fixtures and fittings
supplied (actual size)

Ref	Dimension	Qty	Spare
A	8 x 25mm	20	2
B	6 x 35mm	12	2
C	6 x 20mm	8	1
D	8 x 25mm	8	1
E	8 x 13mm	20	2
F	6 x 11mm	20	2
G	4 x 60mm	2	N/A
H	5 x 60mm	2	N/A
I	65 x 56mm	4	1
J	4 x 20mm	4	N/A
K	3 x 40mm	4	N/A
L	2 x 11mm	4	N/A

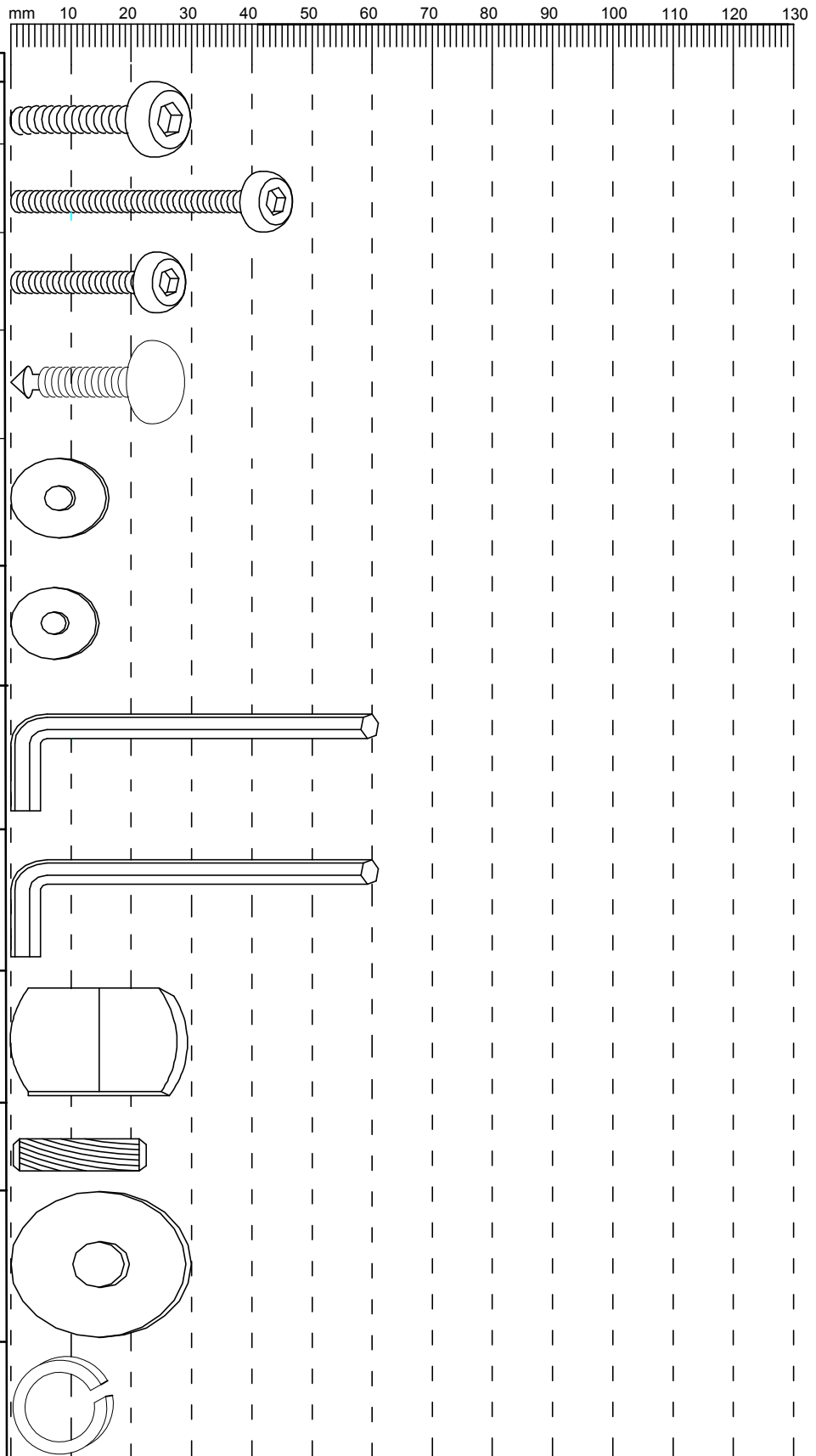



MILAN DRAWER BED

Assembly instructions

1

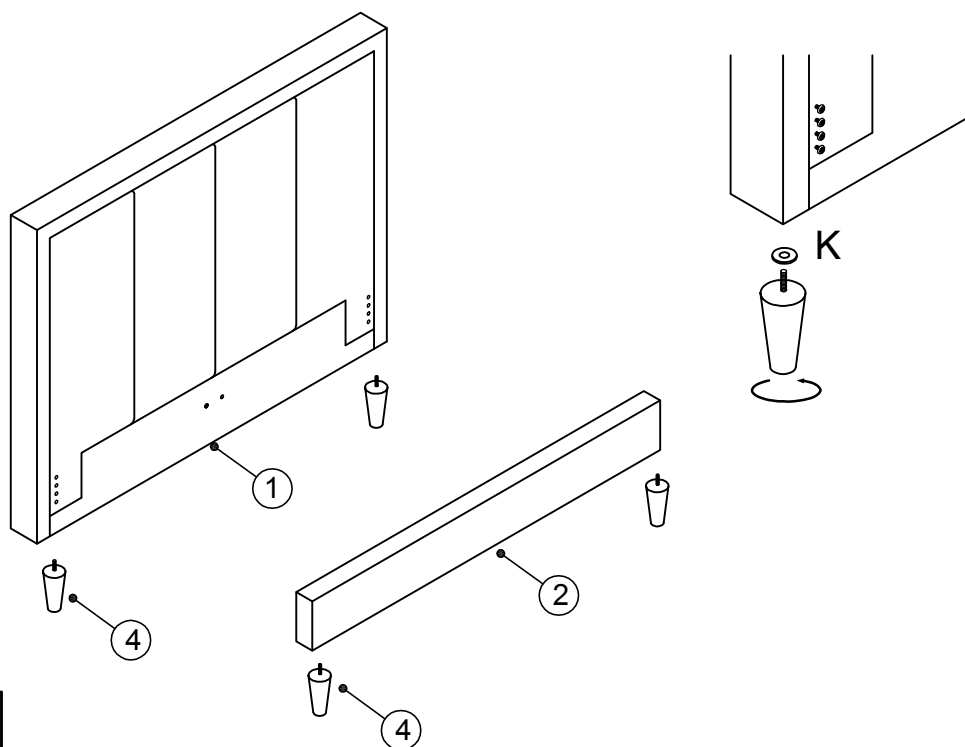

K x 4 3 x 40mm



2

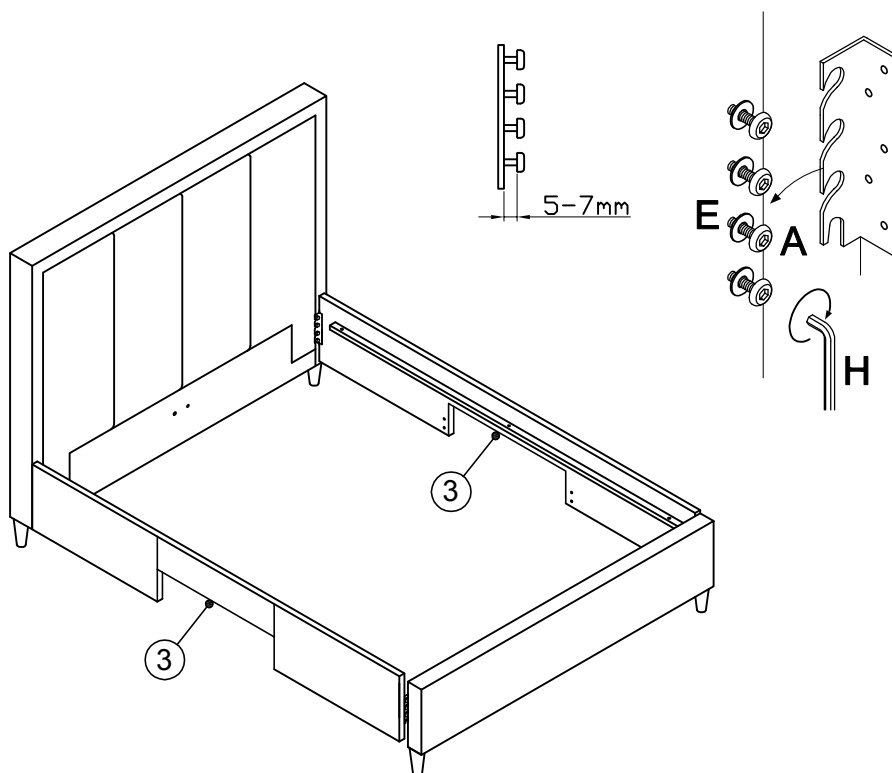

A x 16 8 x 25mm

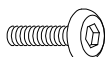

E x 16 8 x 13mm



H x 1 5 x 60mm

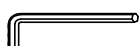



MILAN DRAWER BED

Assembly instructions

3

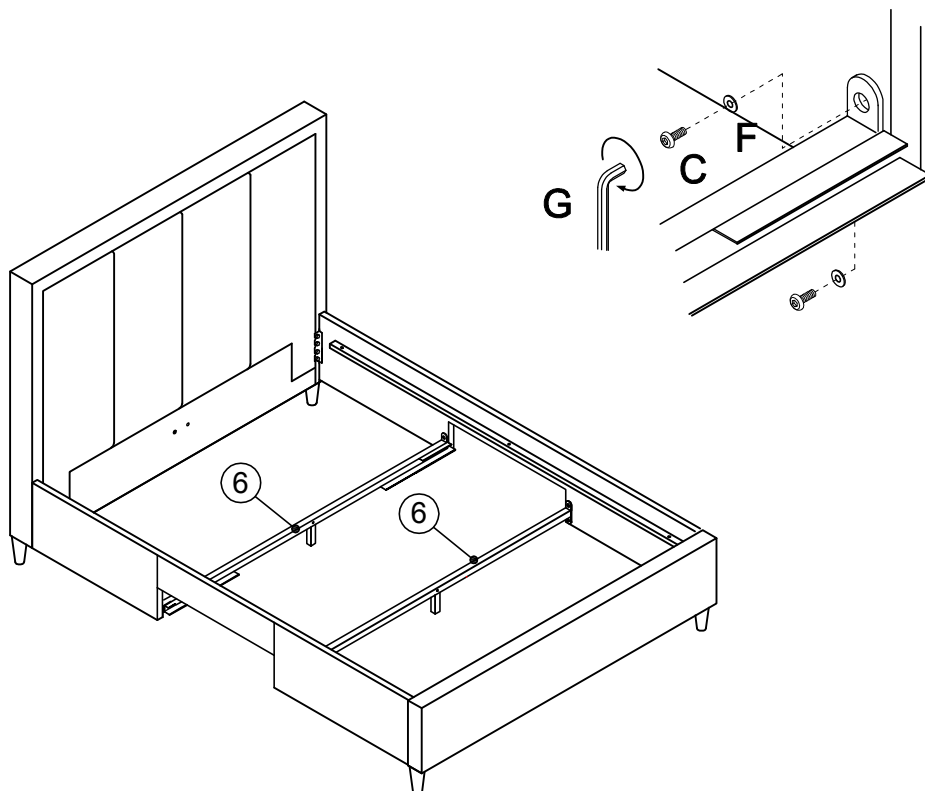

C x 8 6 x 20mm

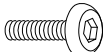

F x 8 6 x 11mm



G x 1 4 x 60mm



4

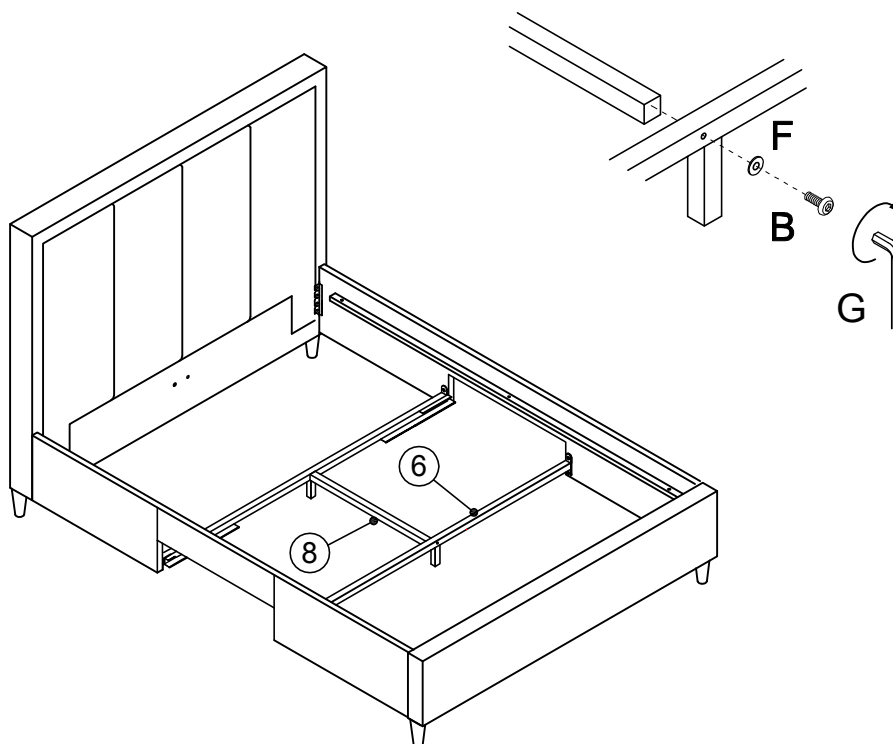

B x 2 6 x 35mm

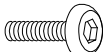

F x 2 6 x 11mm



G x 1 4 x 60mm





MILAN DRAWER BED

Assembly instructions

5

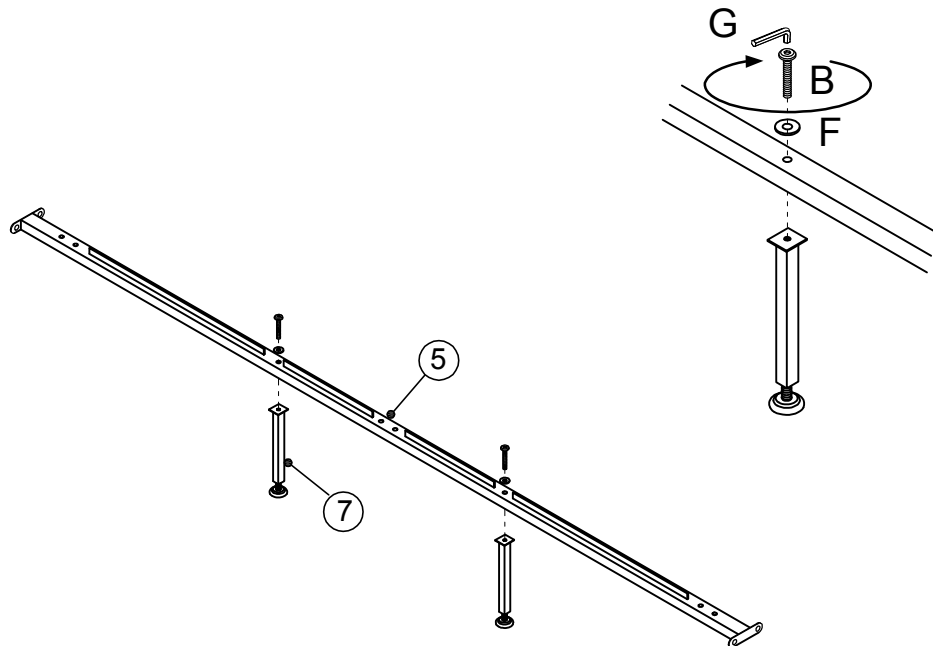

B x 2 6 x 35mm

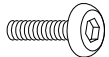

F x 2 6 x 11mm



G x 1 4 x 60mm



6

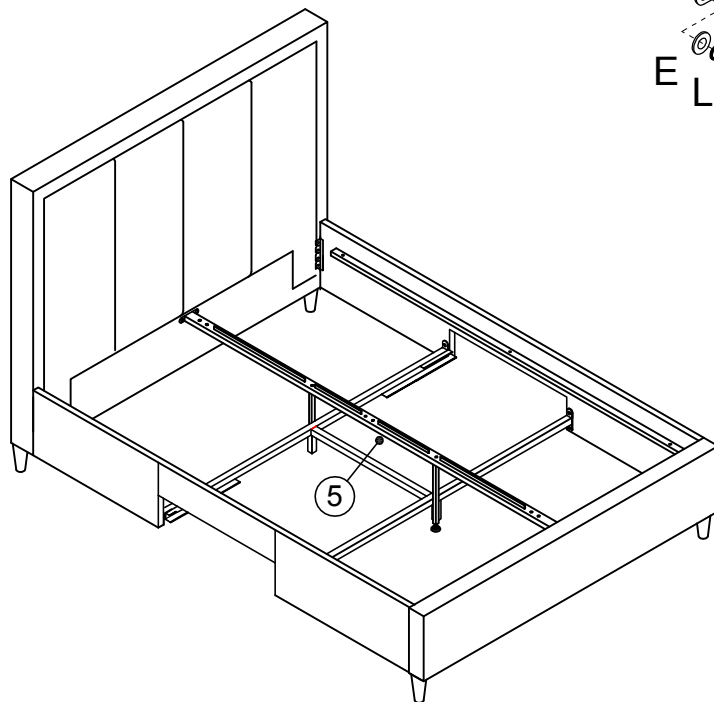

A x 4 8 x 25mm

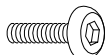

E x 4 8 x 13mm



H x 1 5 x 60mm



L x 4 2 x 11mm

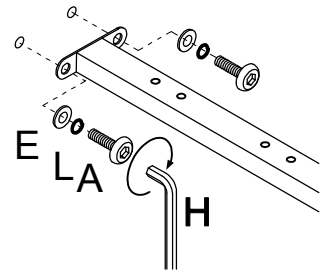

7 x 2

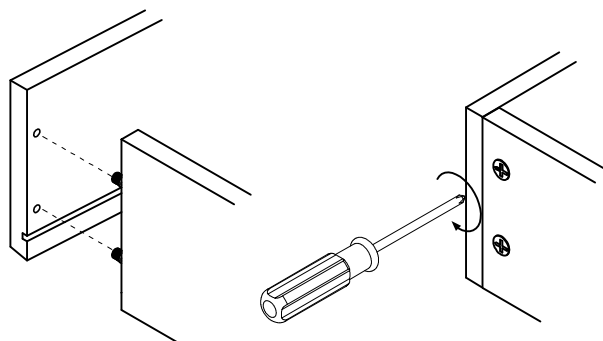
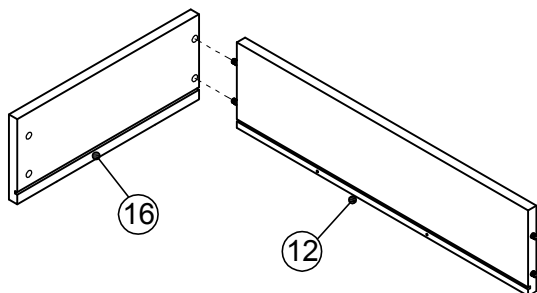

WHEN TIGHTENING THE CAM
TURN THE CAM IN A CLOCKWISE DIRECTION UNTIL THE
ARROW POINTS IN THE POSITIONS SHOWN IN THE
DIAGRAMS BELOW



START



MINIMUM
LOCK



MAXIMUM
LOCK

8 x 2

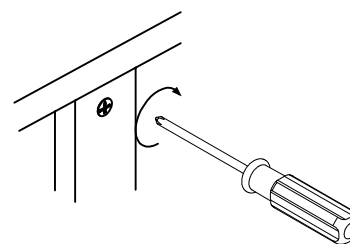
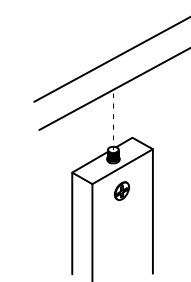
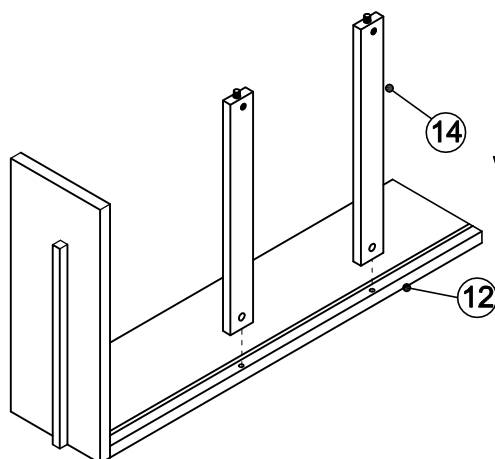

9

x 2

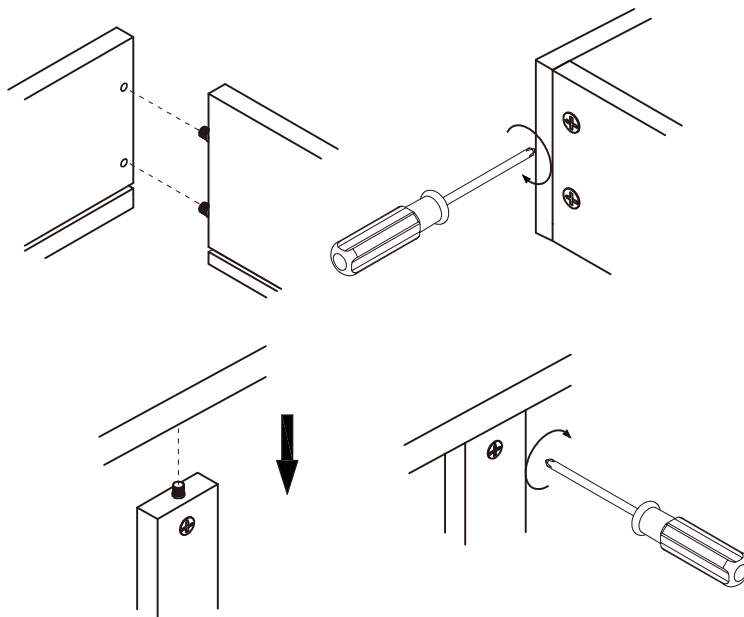
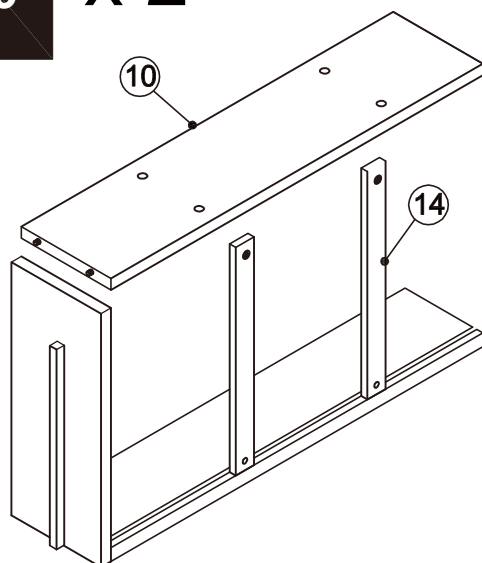

10

x 2

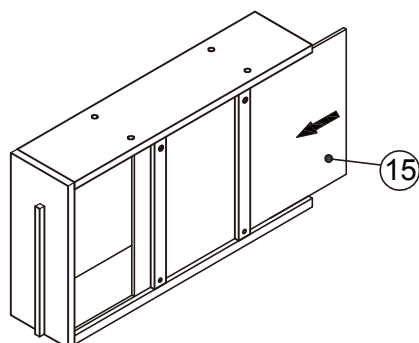

11

x 2

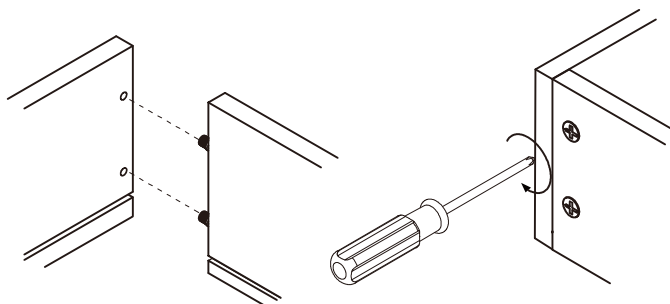
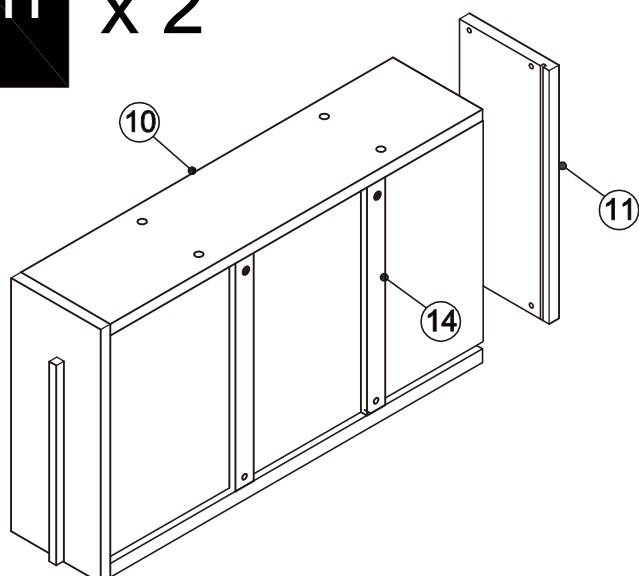



MILAN DRAWER BED

Assembly instructions

12 x 2

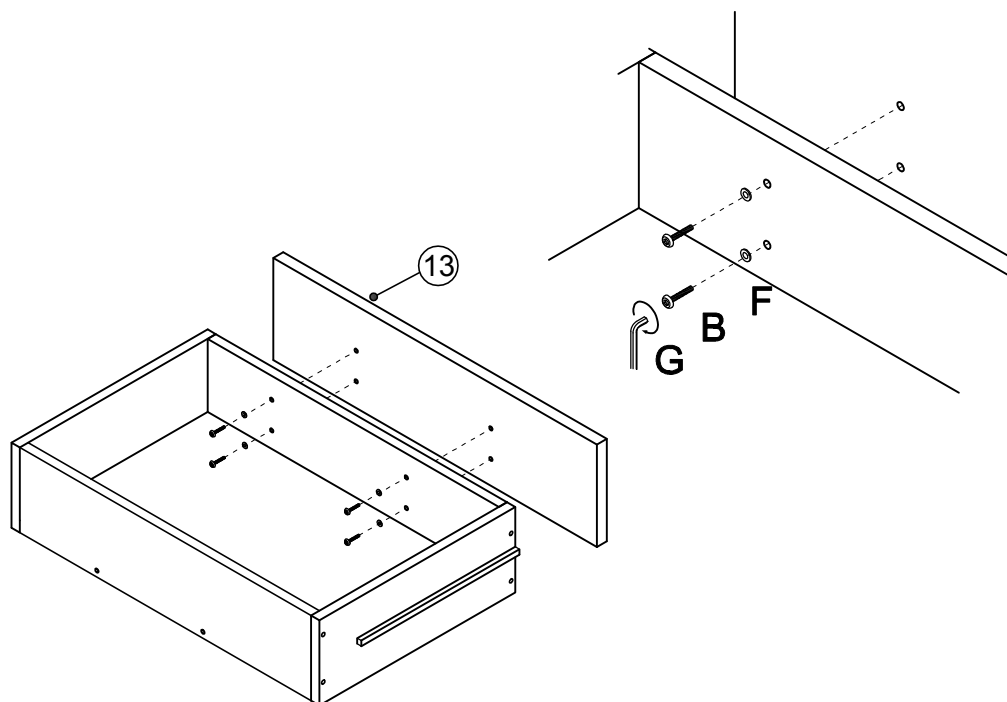

B x 8 6 x 35mm

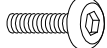

F x 8 6 x 11mm



G x 1 4 x 60mm



13 x 2

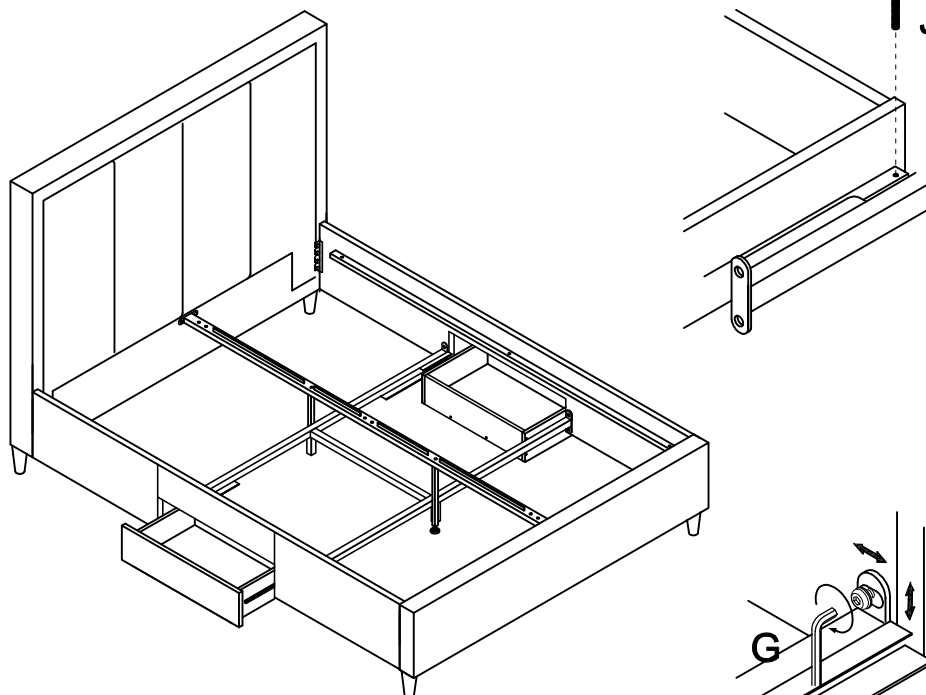

J x 4 4 x 20mm



G x 1 4 x 60mm



Adjust supporting tube for drawer



MILAN DRAWER BED

Assembly instructions

14

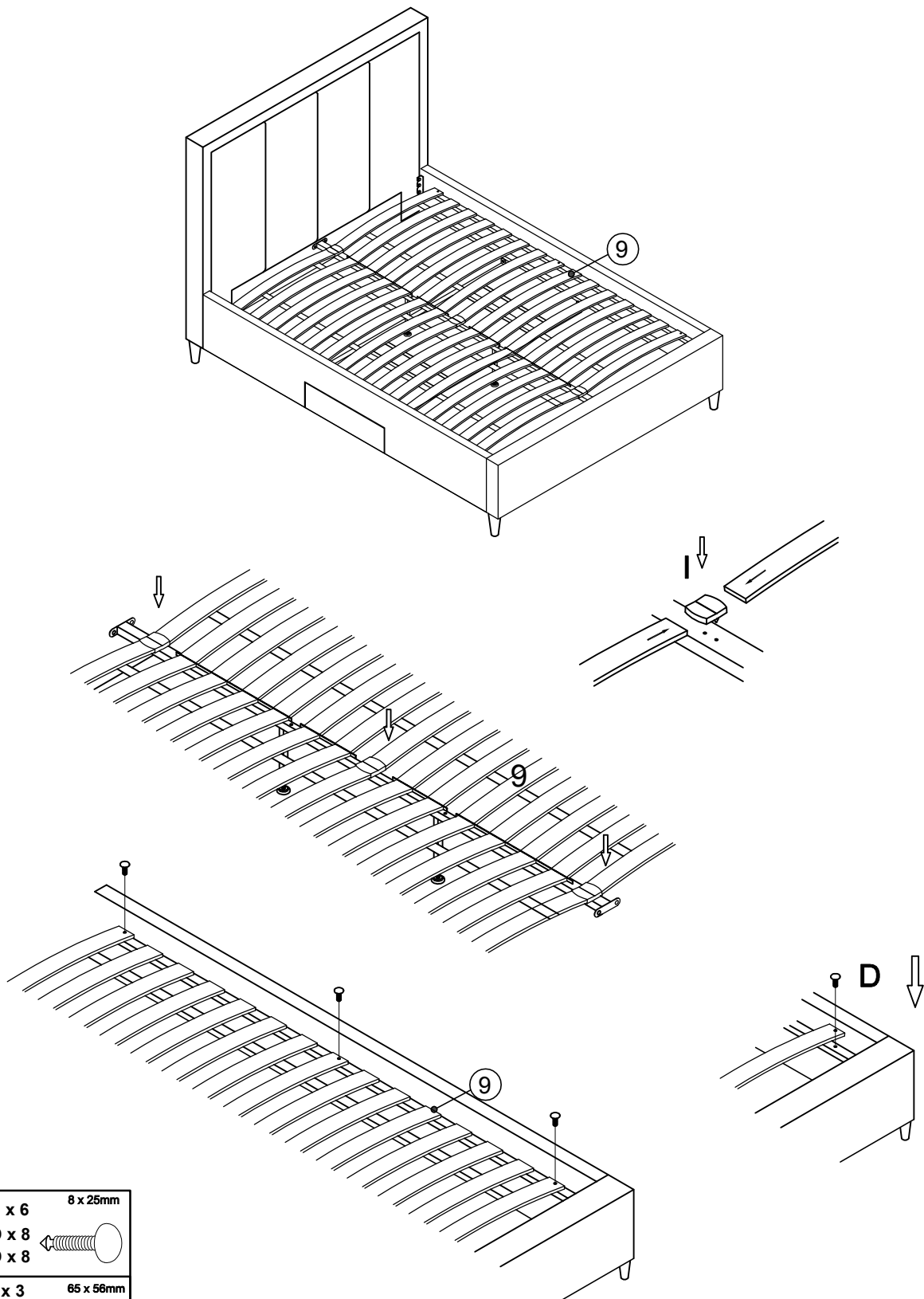

Double	D x 6	8 x 25mm
King	D x 8	
Super King	D x 8	
Double	I x 3	65 x 56mm
King	I x 4	
Super King	I x 4	



MILAN DRAWER BED

Actual product size

Double: H131 x W144 x L206 cm

King: H131 x W159 x L216cm

Super King: H131 x W189 x L216cm

