

# NEXT

## KENDAL WHITE TRIPLE WARDROBE

349013

Assembly instructions

**Actual product size**

H186x W140x D55cm

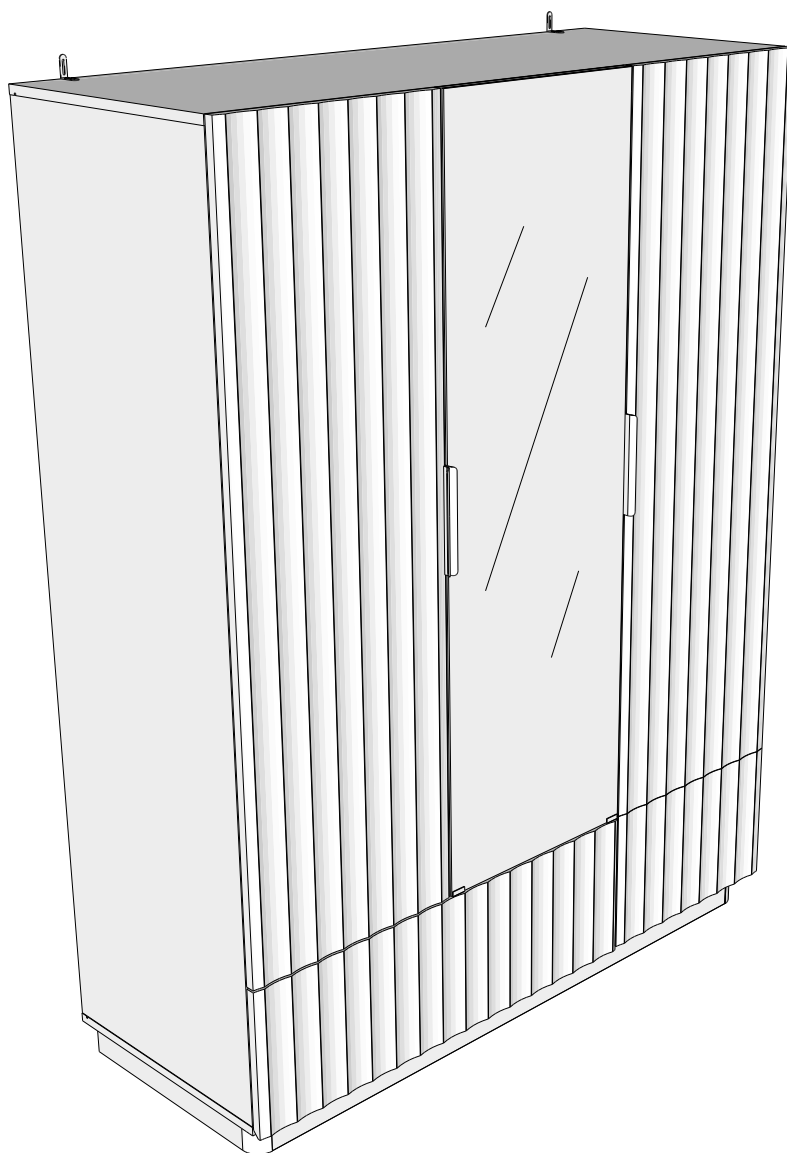

### Need Help ?

With: Assembly instruction

Missing or damaged parts

**IMPORTANT - RETAIN FOR FUTURE REFERENCE**

**CALL: 0333 777 8999**

# NEXT

## KENDAL WHITE TRIPLE WARDROBE

349013

Assembly instructions

### BEFORE YOU START

#### Number of people required to assemble

Two people are required to assemble this item



**Time to assemble : 30 minutes**



#### Tools required

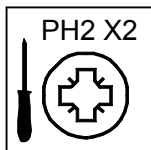

not supplied

#### Do's

We suggest you spend a short time reading through this leaflet before you start.

When you are ready to start, make sure that you have the right tools and plenty of space.

Unwrap all packaging materials and place the components on a clean surface to protect it from damage, We recommend that the packaging is used to protect the surfaces during assembly.

Carefully check that you have all the parts before beginning assembly.

Due to the size of this product we recommend that it is assembled in the room intended for use.

Ensure the product is fully assembled as illustrated and all fixings fully tightened before use.

Wipe occasionally with a soft cloth slightly dampened with water. Then buff with a dry clean soft cloth.

Wood will mellow and change colour over time, we recommend that ornaments and items placed on the surface are moved regularly for the first few months to prevent uneven mellowing.

#### Don'ts

Do not drag or pull your furniture.

Do not rub or scrub the surface when cleaning.

Do not use silicone based furniture polish. Silicone in furniture polishes can break down the finish.

Never allow any kind of liquid to remain on your furniture.  
Absorption can cause wood to warp or finishes to de-laminate.

Do not place hot items (e.g. hot drinks) directly on to the wood surface. Please make sure you use a placemat or coaster.

# NEXT

## KENDAL WHITE TRIPLE WARDROBE

349013

Assembly instructions

### GETTING TO KNOW YOUR PRODUCT

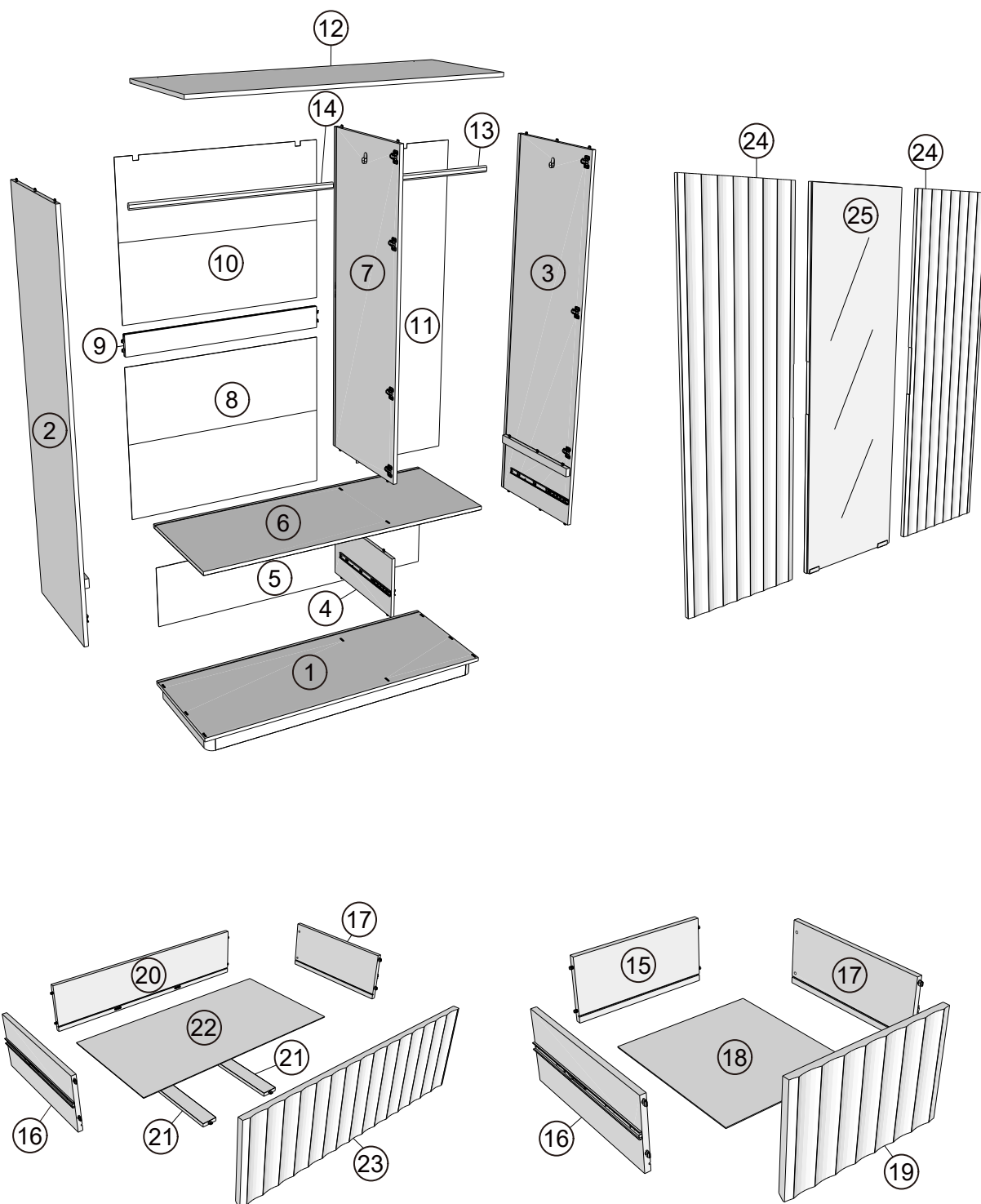

# NEXT

## KENDAL WHITE TRIPLE WARDROBE

349013  
Assembly instructions

Components supplied. Please use this guide if you require replacement parts.

| Ref | Dimensions | Visual | Qty | Ctn |
|-----|------------|--------|-----|-----|
| 1   | 53x140cm   |        | 1   | 1   |
| 2   | 53x175.5cm |        | 1   | 2   |
| 3   | 53x175.5cm |        | 1   | 2   |
| 4   | 28.5x51cm  |        | 1   | 1   |
| 5   | 29x137cm   |        | 1   | 2   |
| 6   | 53x136.5cm |        | 1   | 1   |
| 7   | 52.5x145cm |        | 1   | 2   |
| 8   | 69x90.5cm  |        | 1   | 2   |
| 9   | 9.5x89.5cm |        | 1   | 1   |
| 10  | 69x90.5cm  |        | 1   | 2   |
| 11  | 45.5x146cm |        | 1   | 2   |
| 12  | 53x140cm   |        | 1   | 1   |
| 13  | 3x44cm     |        | 1   | 1   |

| Ref | Dimensions   | Visual | Qty | Ctn |
|-----|--------------|--------|-----|-----|
| 14  | 3x89cm       |        | 1   | 1   |
| 15  | 19.5x40cm    |        | 1   | 1   |
| 16  | 19.5x45cm    |        | 2   | 1   |
| 17  | 19.5x45cm    |        | 2   | 1   |
| 18  | 40.5x43.5cm  |        | 1   | 2   |
| 19  | 30x46.5cm    |        | 1   | 1   |
| 20  | 19.5x84.5cm  |        | 1   | 1   |
| 21  | 6x43cm       |        | 2   | 1   |
| 22  | 43.5x85.5cm  |        | 1   | 2   |
| 23  | 30x93cm      |        | 1   | 1   |
| 24  | 46.5x148.5cm |        | 2   | 3   |
| 25  | 46.5x148.5cm |        | 1   | 3   |



## NEXT FITTINGS ASSEMBLE INSTRUCTIONS

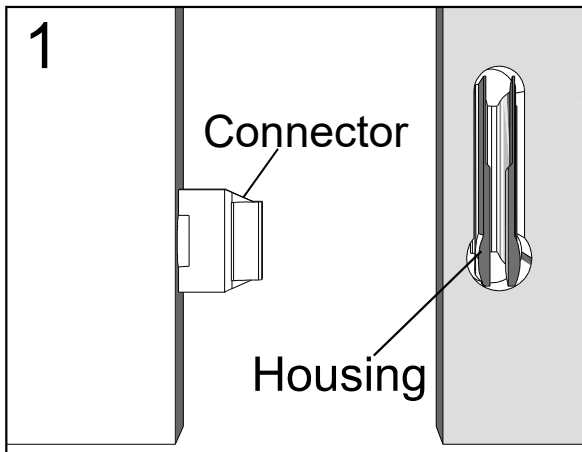

Push connector into housing to join.

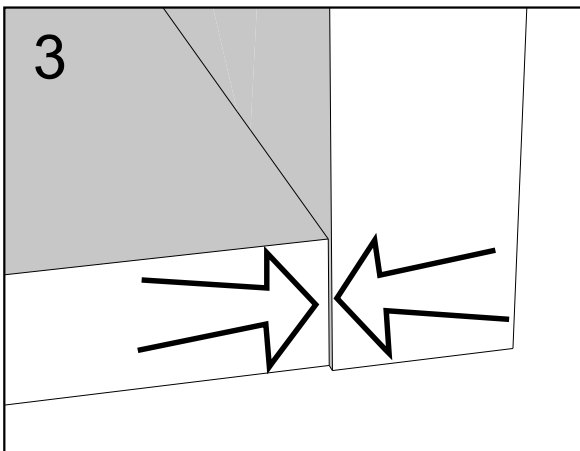

Make sure there is no gap between the panels.

# NEXT

## KENDAL WHITE TRIPLE WARDROBE

349013

Assembly instructions

### Fixtures and fittings supplied (actual size)

| Ref  | Dimensions  | Qty | Spare Qty |
|------|-------------|-----|-----------|
| U139 | Ø4.5 x 15mm | 20  | 2         |
| S41  | Ø4 x 16mm   | 3   | 1         |
| U143 | Ø4 x 15mm   | 20  | 2         |

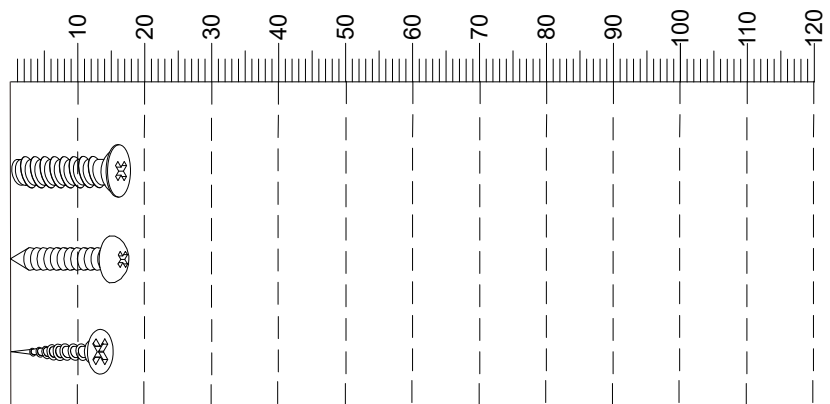

### Fixtures and fittings supplied ( not to scale)

| Ref | Dimensions | Qty | Spare Qty | Visual |
|-----|------------|-----|-----------|--------|
| N1  | N/A        | 2   | N/A       |        |
| C16 | N/A        | 10  | N/A       |        |
| E39 | N/A        | 3   | N/A       |        |
| T38 | N/A        | 20  | 2         |        |

# NEXT

## KENDAL WHITE TRIPLE WARDROBE

349013

Assembly instructions

1

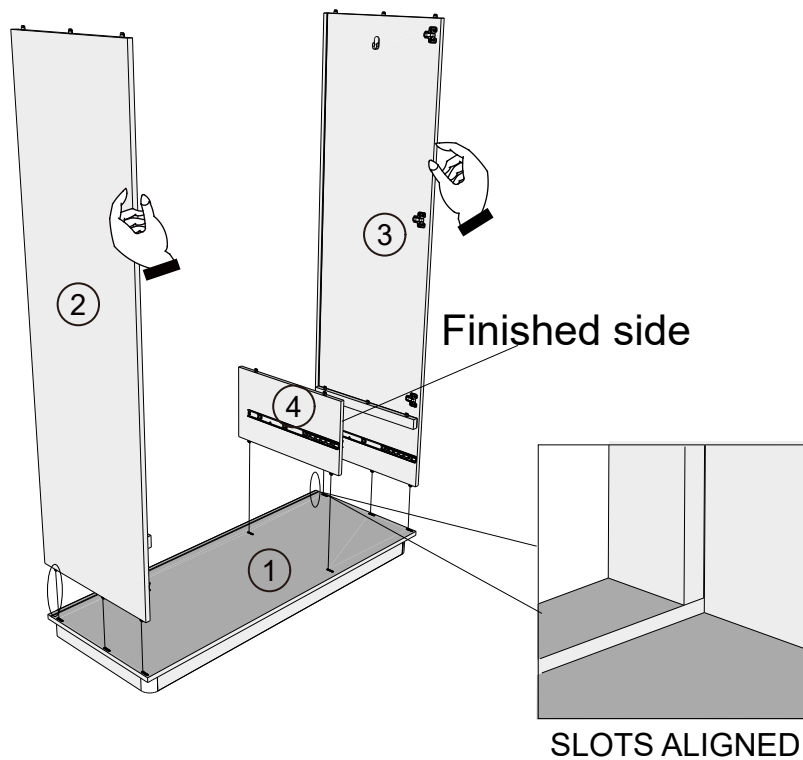

2

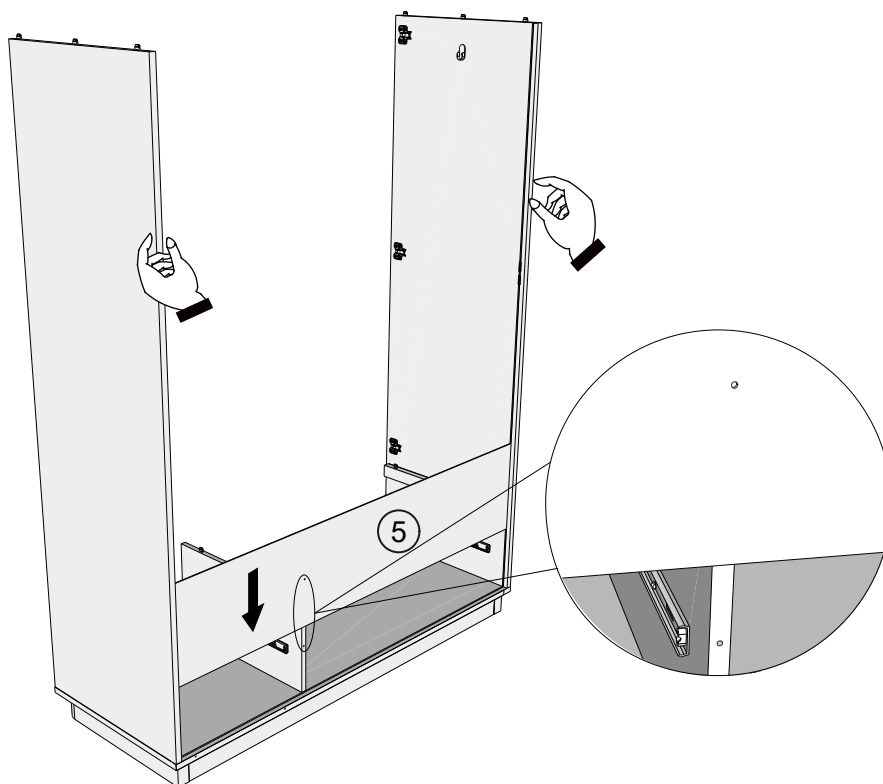

# NEXT

## KENDAL WHITE TRIPLE WARDROBE

349013

Assembly instructions

3

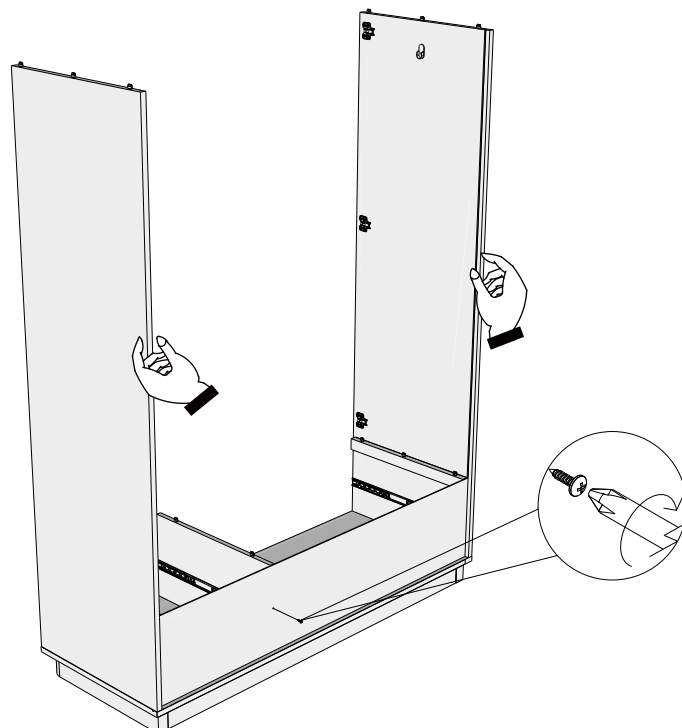

S41

Ø4 x 16mm

1



4

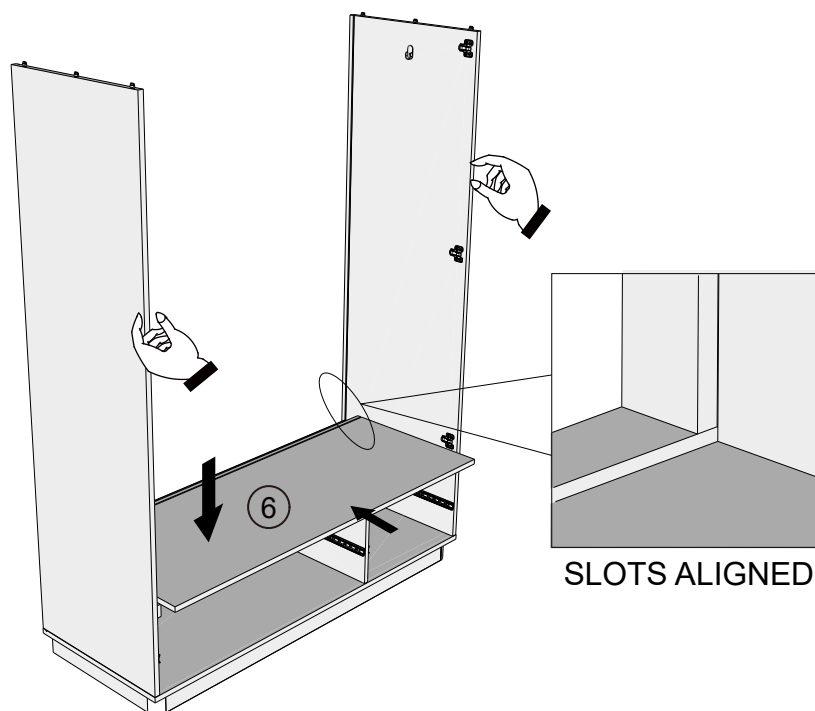

# NEXT

## KENDAL WHITE TRIPLE WARDROBE

349013

Assembly instructions

5

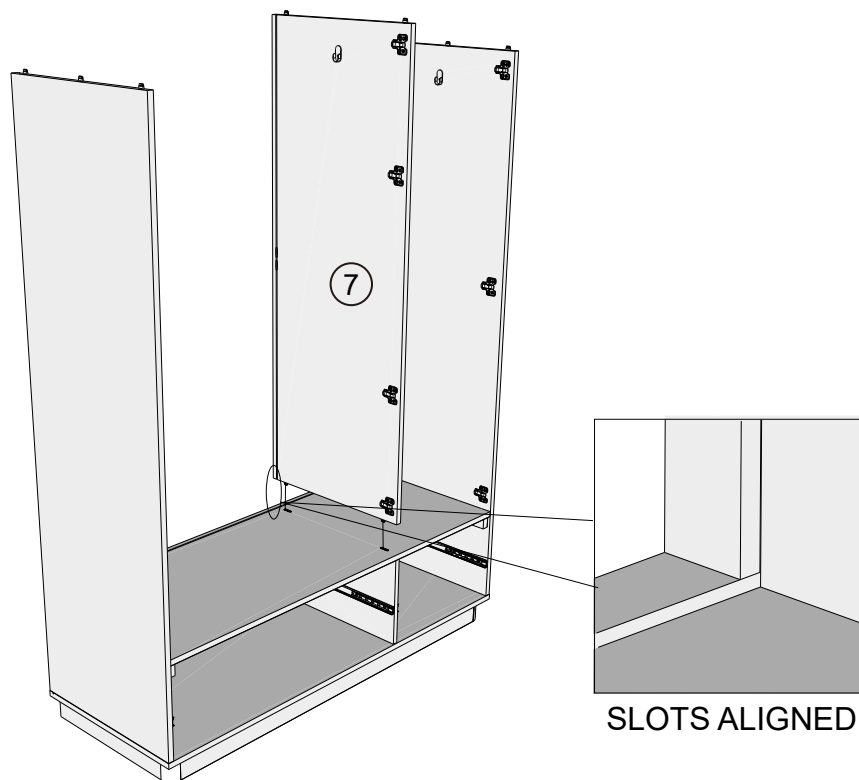

6

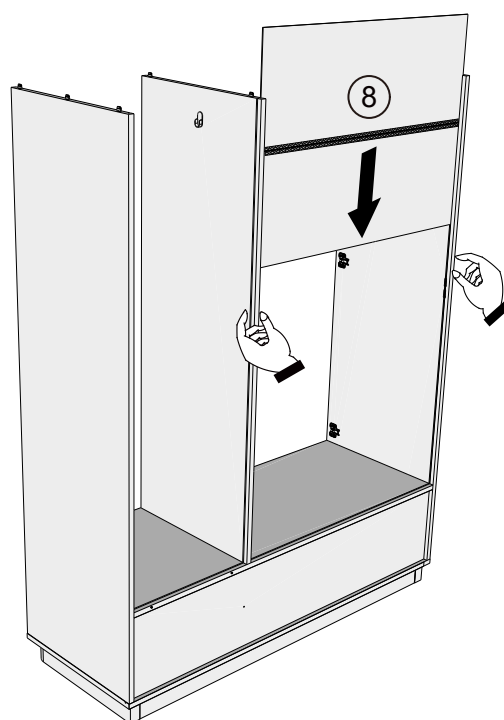

# NEXT

## KENDAL WHITE TRIPLE WARDROBE

349013  
Assembly instructions

7

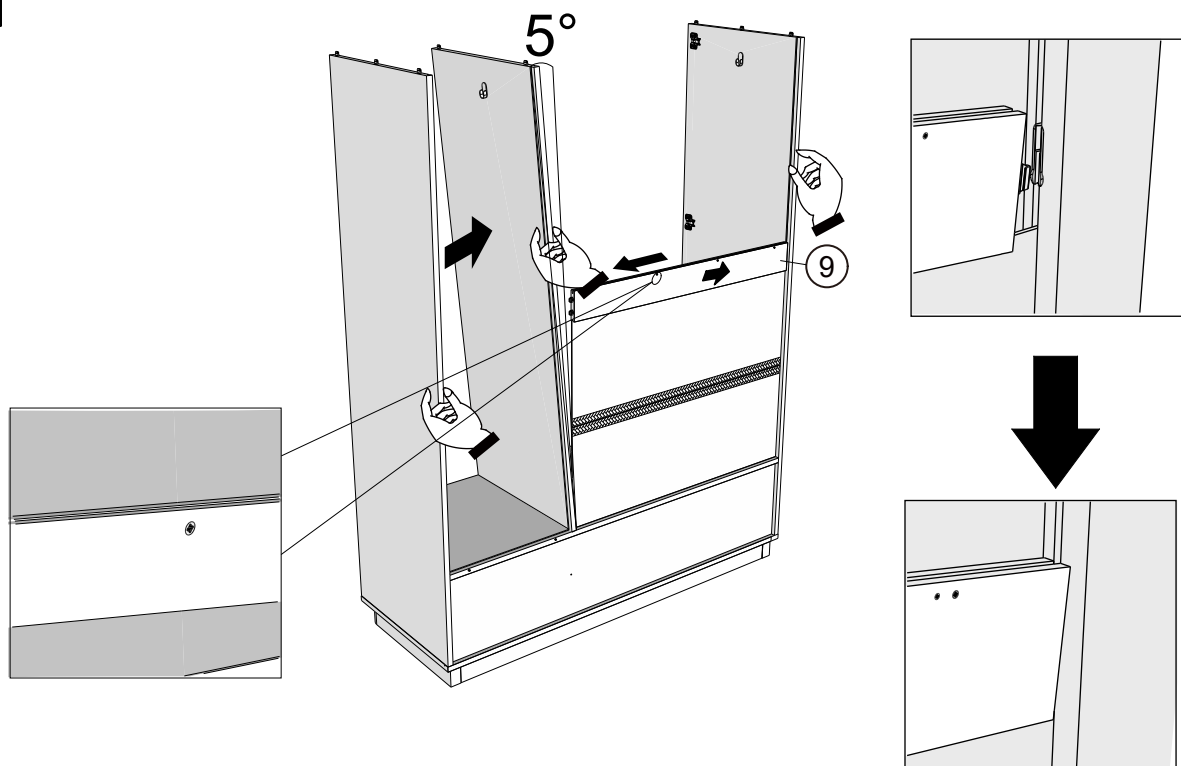

8

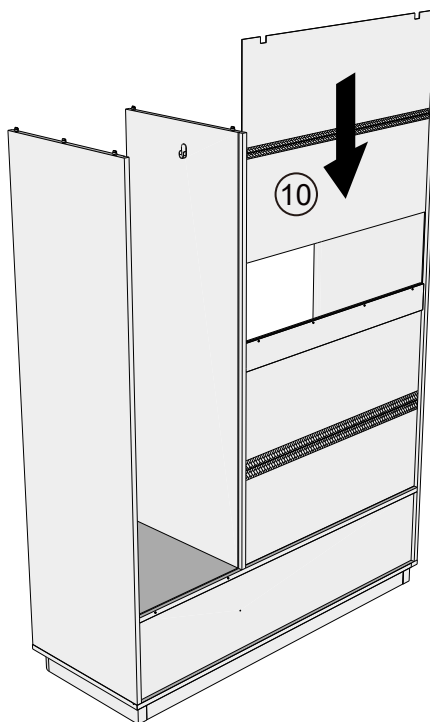

9

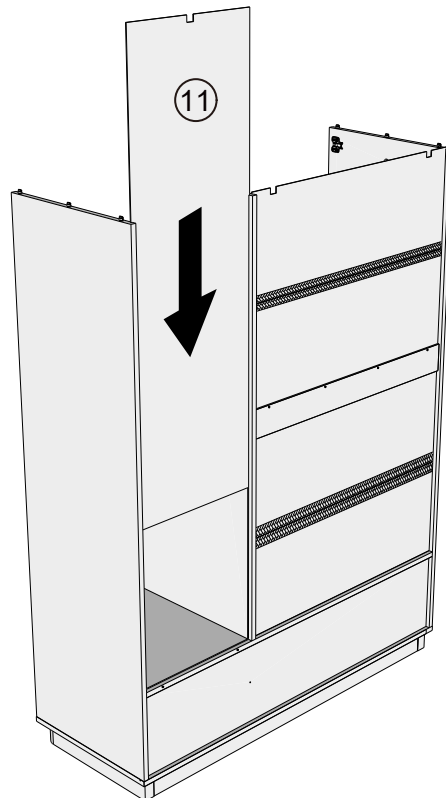

10

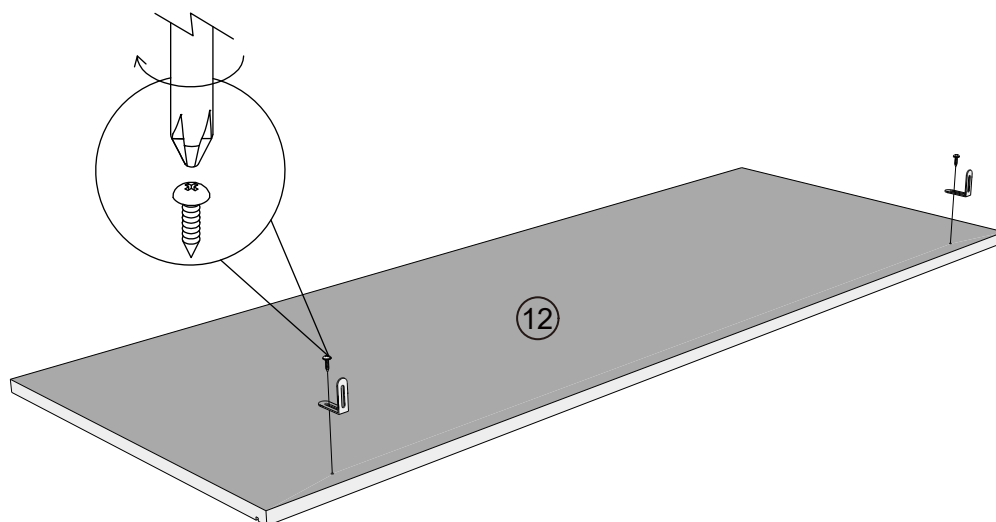

|     |           |   |                  |
|-----|-----------|---|------------------|
| N1  | N/A       | 2 |                  |
| S41 | Ø4 x 16mm | 2 | <br>not supplied |

# NEXT

## KENDAL WHITE TRIPLE WARDROBE

349013

Assembly instructions

11

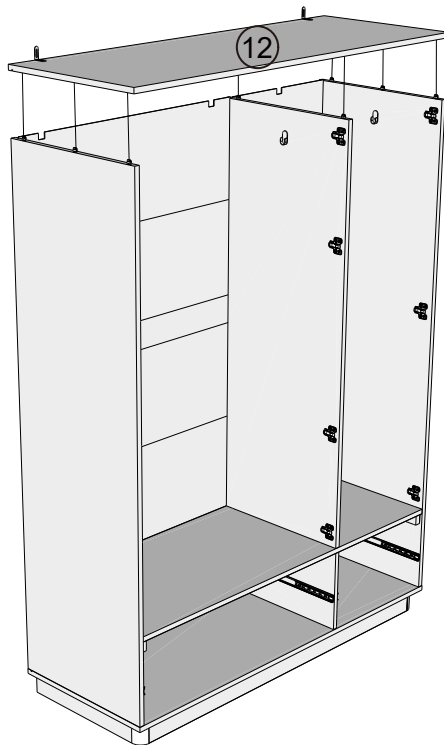

12

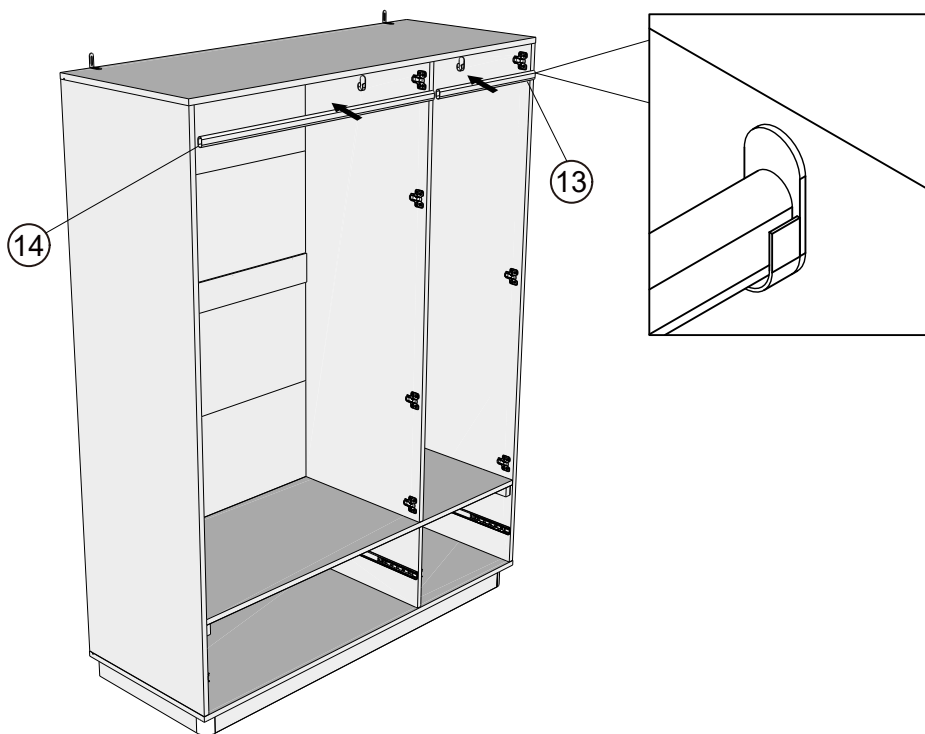



# NEXT

## KENDAL WHITE TRIPLE WARDROBE

349013

Assembly instructions

13

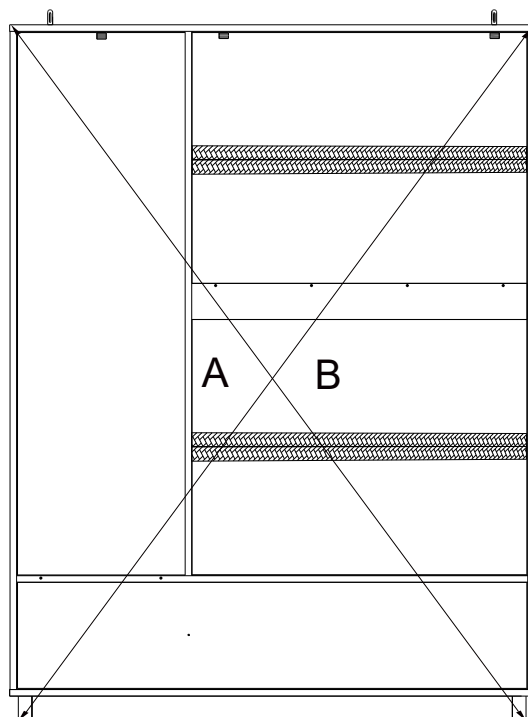

A=B

14

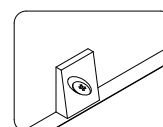
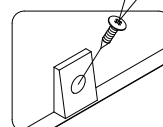
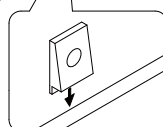

T38

N/A

20



not supplied

# NEXT

## KENDAL WHITE TRIPLE WARDROBE

349013

Assembly instructions

15

We recommend the use of the wall attachment bracket/strap provided for safety reasons. Move unit into desired position. Secure the 2X"L" metal brackets to the wall with an appropriate screw and wall plug for your wall type (not provided).

Warning: Always ensure intended wall area to be drilled is free from hidden electrical wires, water and gas pipes.

NB: Wall fixings are not included-Please source suitable fixing for your wall type.

If in doubt please consult a qualified trades person.

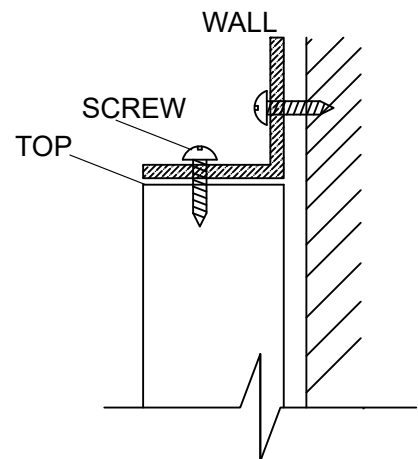
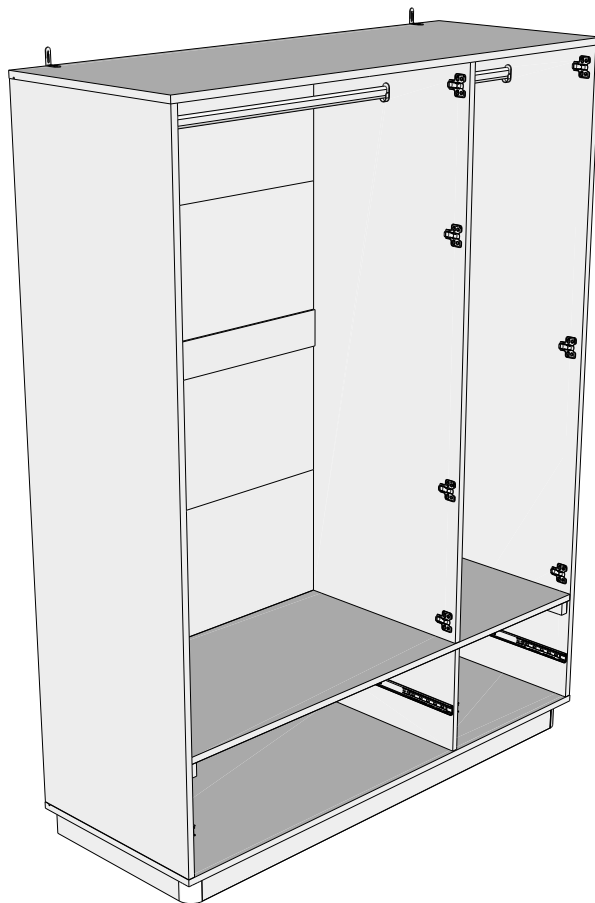

# NEXT

## KENDAL WHITE TRIPLE WARDROBE

349013

Assembly instructions

16

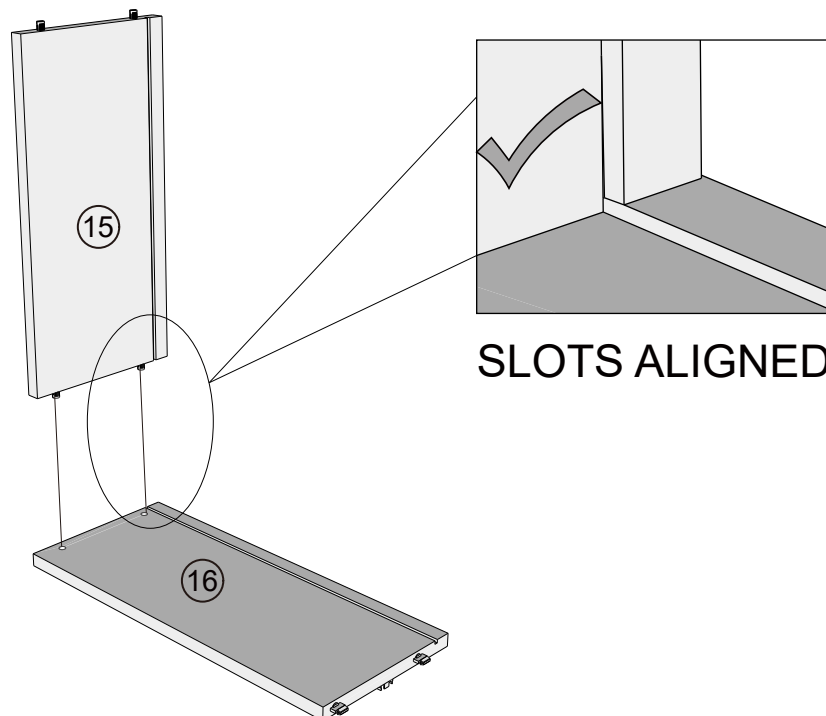

17

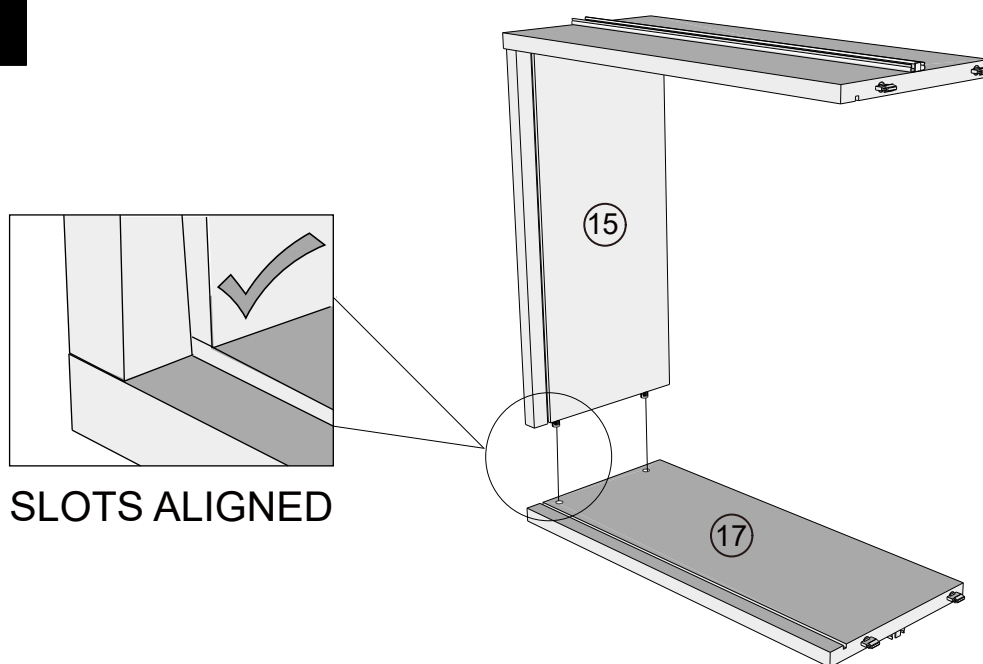

# NEXT

## KENDAL WHITE TRIPLE WARDROBE

349013  
Assembly instructions

18

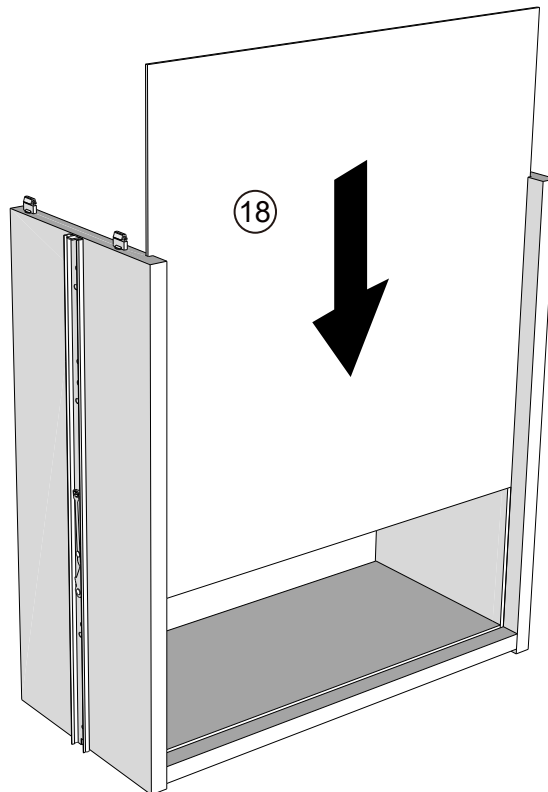

19

Note: Drawer will be permanently assembled once panel 19 is fitted.

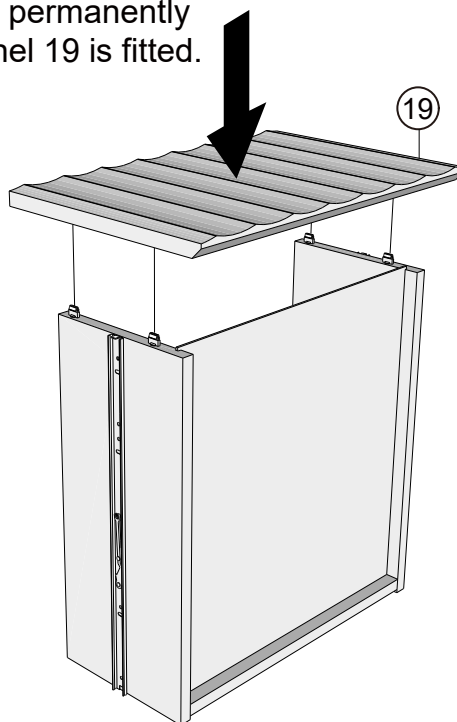

# NEXT

## KENDAL WHITE TRIPLE WARDROBE

349013

Assembly instructions

20

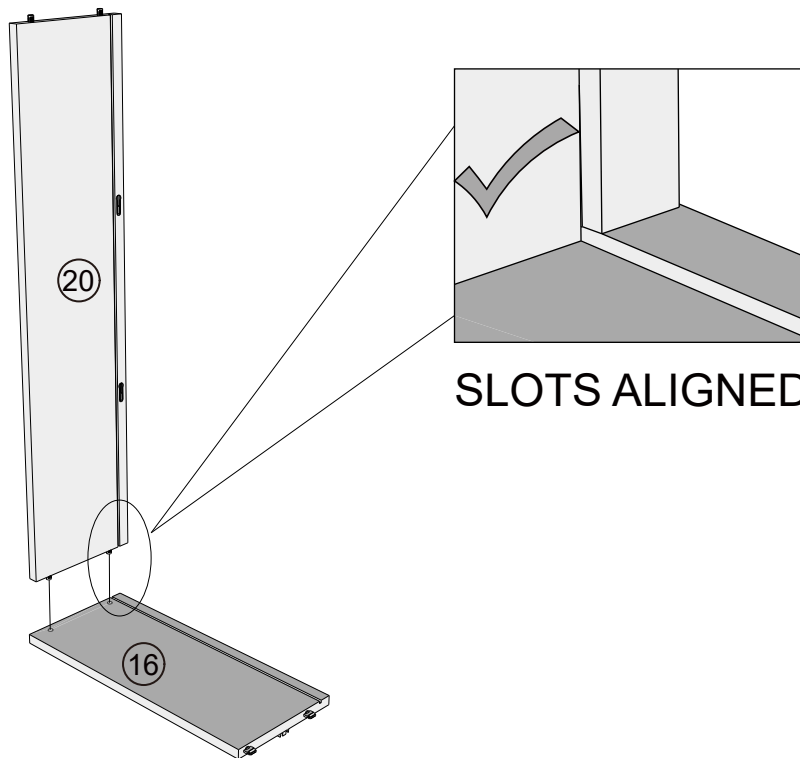

21

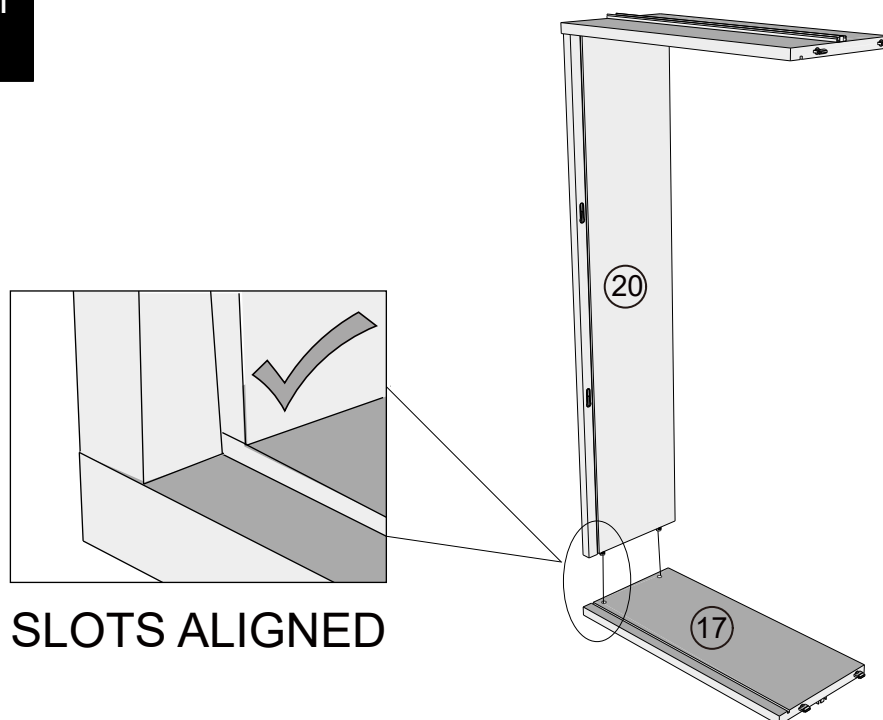

# NEXT

## KENDAL WHITE TRIPLE WARDROBE

349013

Assembly instructions

22

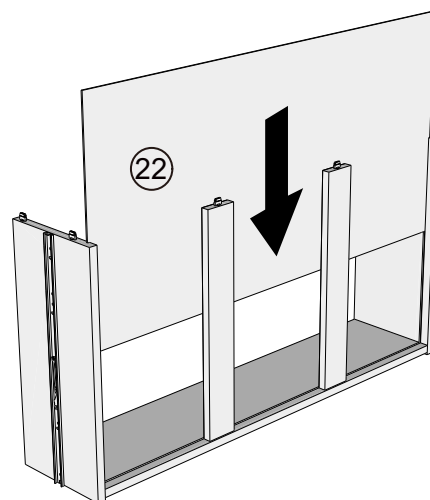
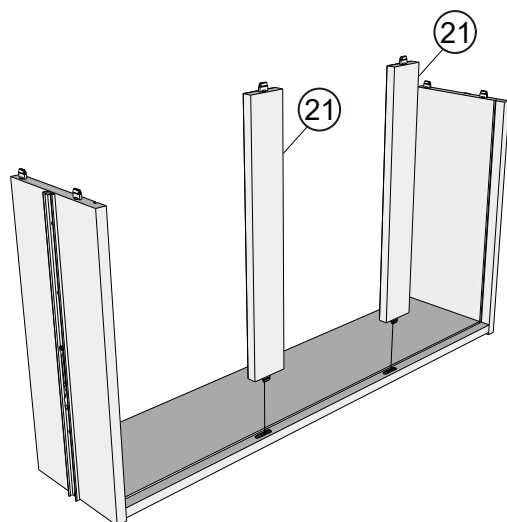

23

Note: Drawer will be permanently assembled once panel 23 is fitted.

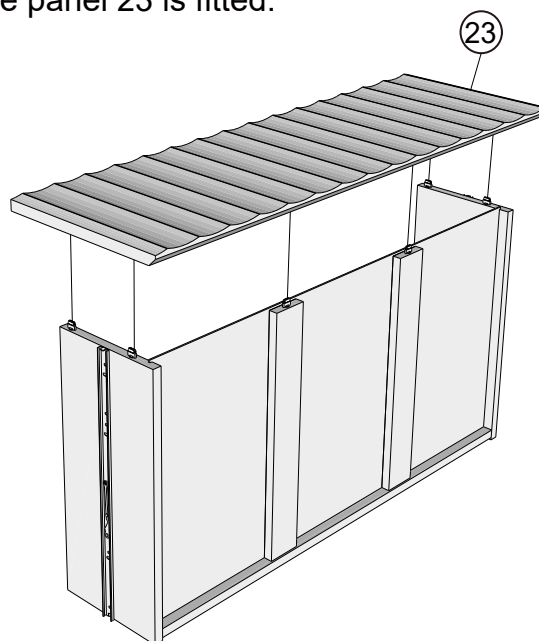

# NEXT

## KENDAL WHITE TRIPLE WARDROBE

349013  
Assembly instructions

24

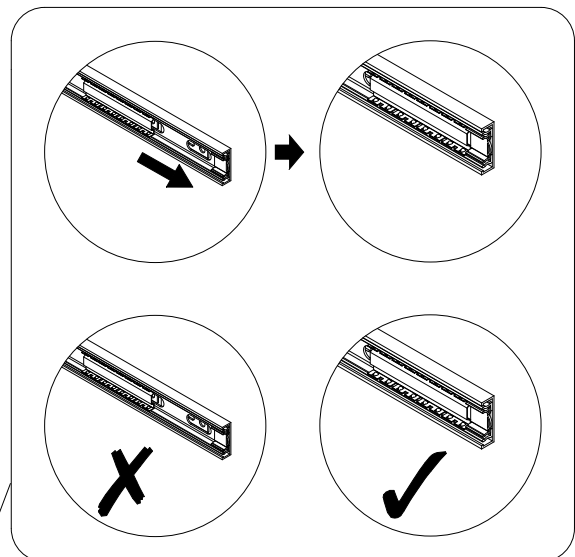
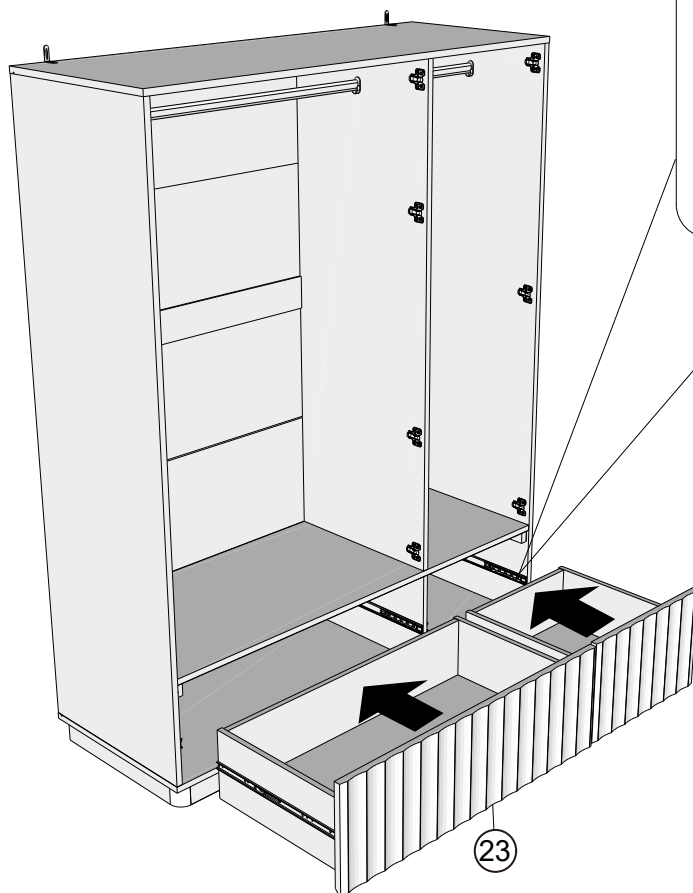



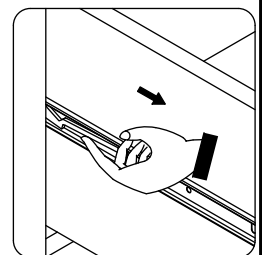
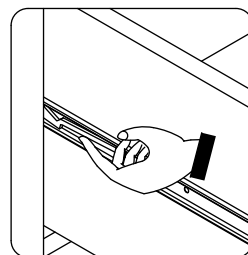

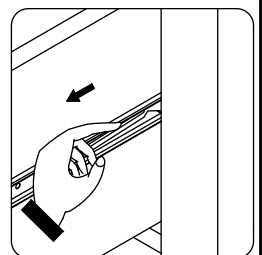
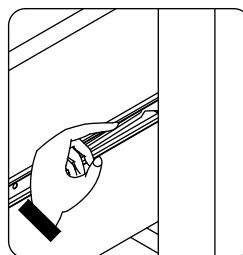

Left side

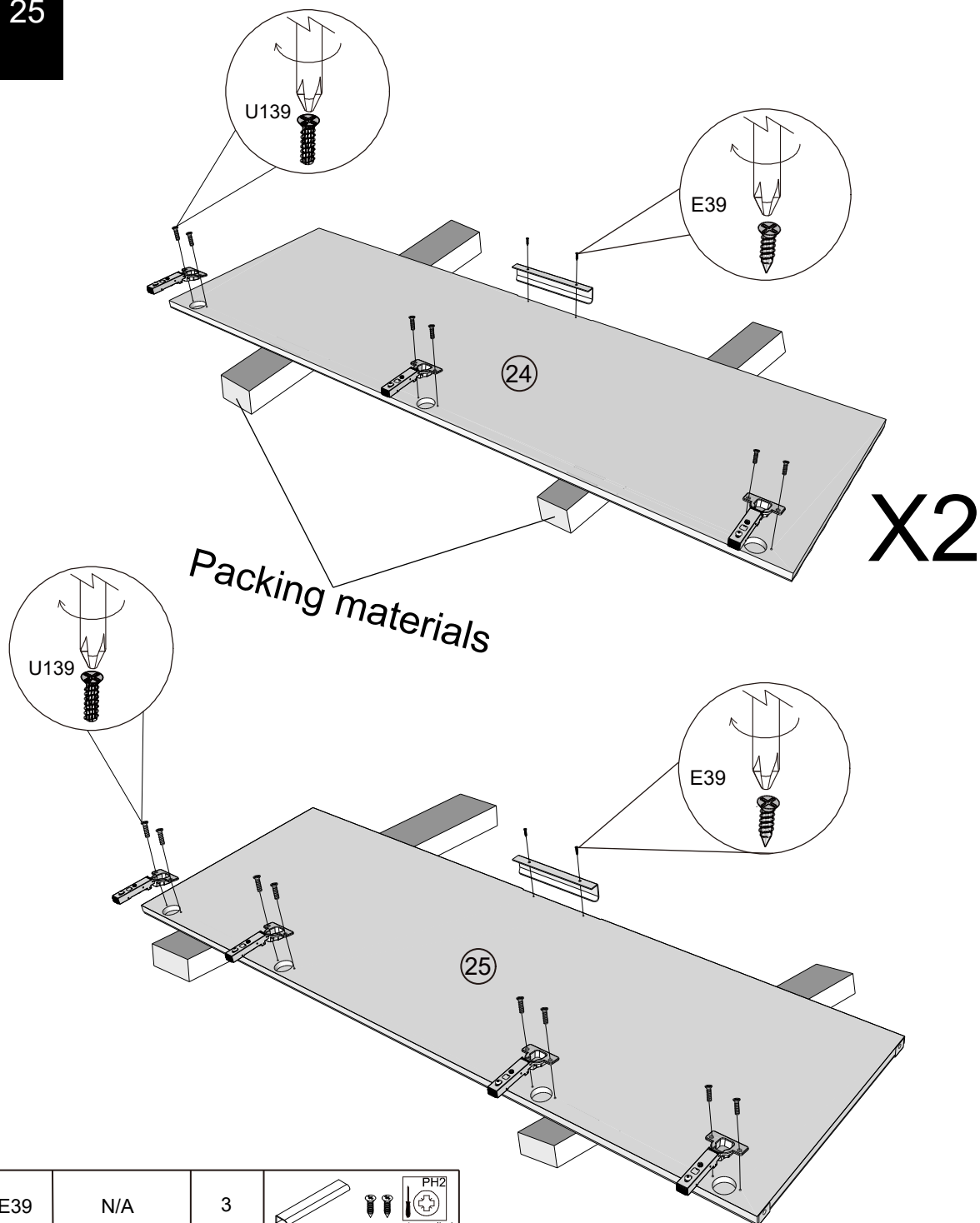

Right side





|      |             |    |   |
|------|-------------|----|---|
| E39  | N/A         | 3  |   <br>not supplied |
| U139 | Ø4.5 x 15mm | 20 |  <br>not supplied   |
| C16  | N/A         | 10 |    |



# NEXT

## KENDAL WHITE TRIPLE WARDROBE

349013

Assembly instructions

26

Note: Please start installing from the bottom hinge of each door panel.

Install hinge

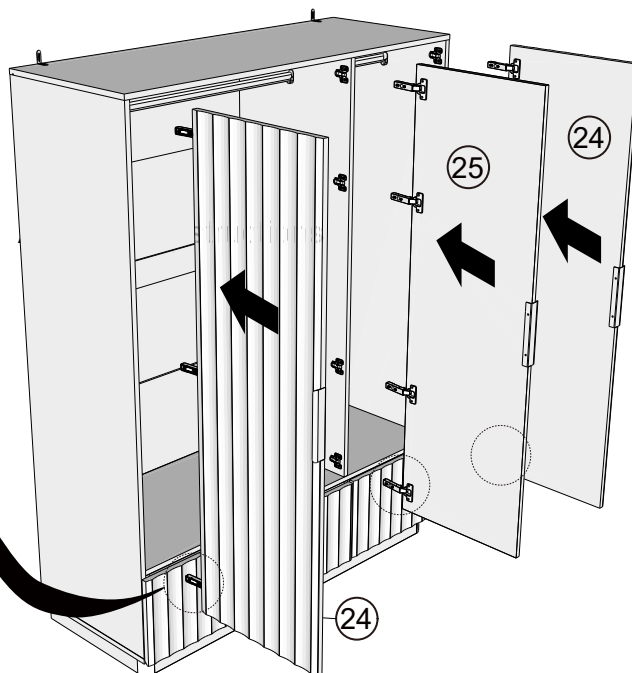
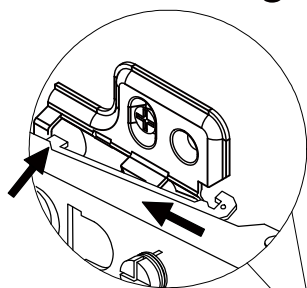

Adjust Hinge Position

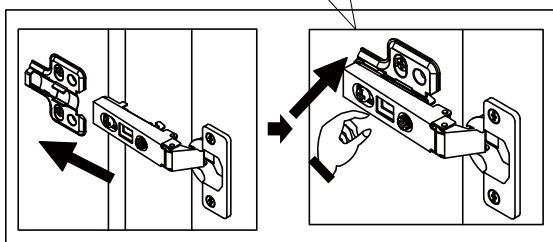

Remove hinge

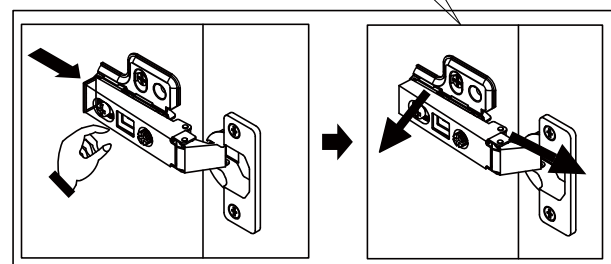
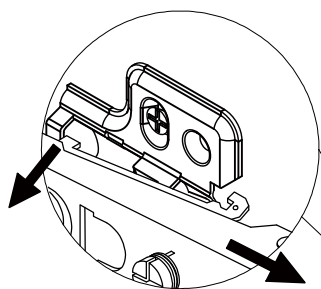

LATERAL

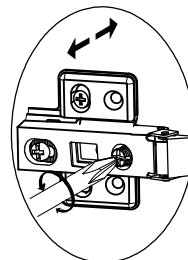

VERTICAL

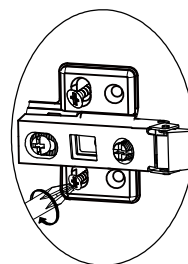
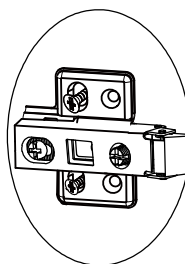
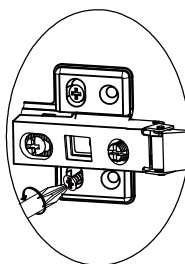

FRONT- TO-BACK

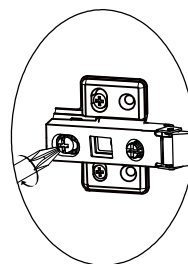
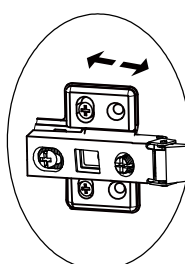
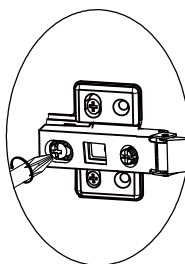

# NEXT



## KENDAL WHITE TRIPLE WARDROBE

349013

Assembly instructions

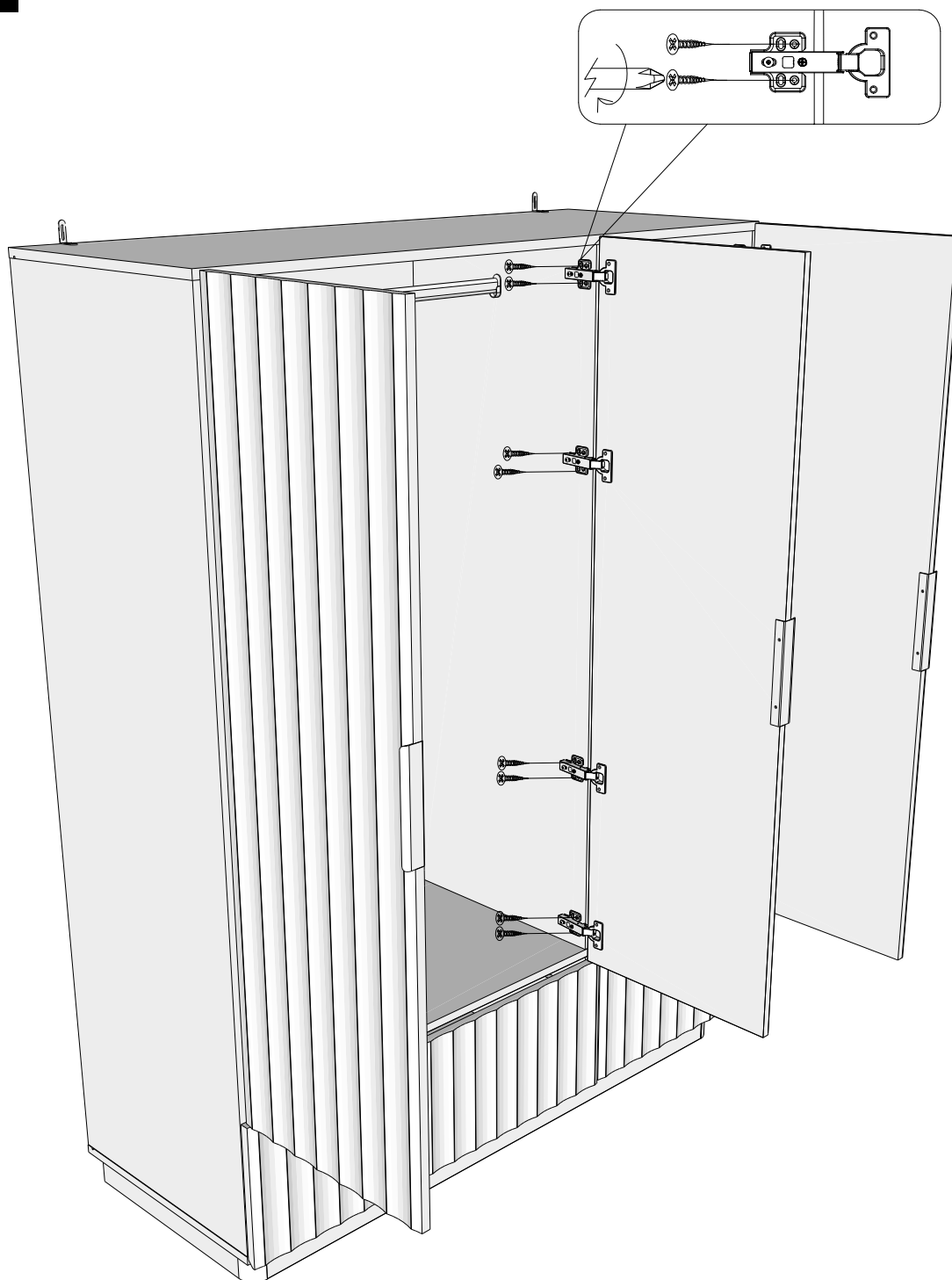
27



|      |           |    |   |   |
|------|-----------|----|---|---|
| U143 | Ø4 x 15mm | 20 |  | <br>not supplied |
|------|-----------|----|---|---|

# NEXT

## KENDAL WHITE TRIPLE WARDROBE

349013

Assembly instructions

28

To disassemble:

Step1: Remove the plastic wedge (T38) from the back plate, and remove the screws from the rear of the panel(6) and the panel(9);

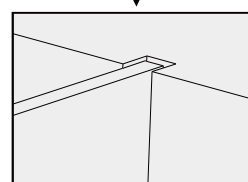
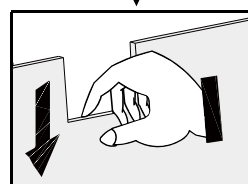
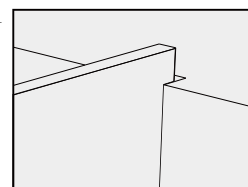
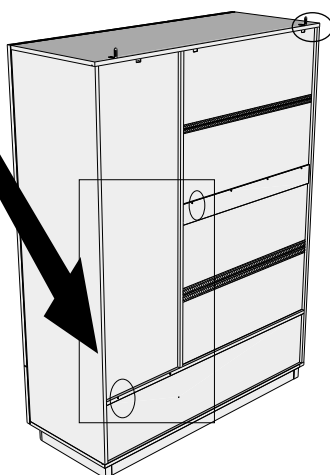
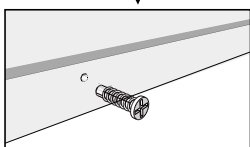
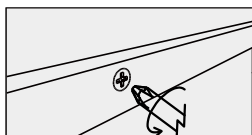

Step2: Press down the two back panels so they are clear of the top panel slot;

29

Slide the top panel front to unlock, then lift off. Follow the same sequence to remove the other panels;

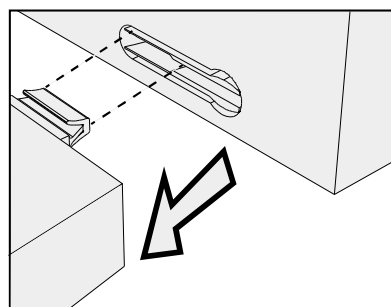
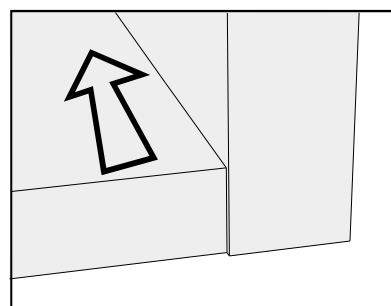

# NEXT

## KENDAL WHITE TRIPLE WARDROBE 349013

### Actual product size

H186x W140x D55cm

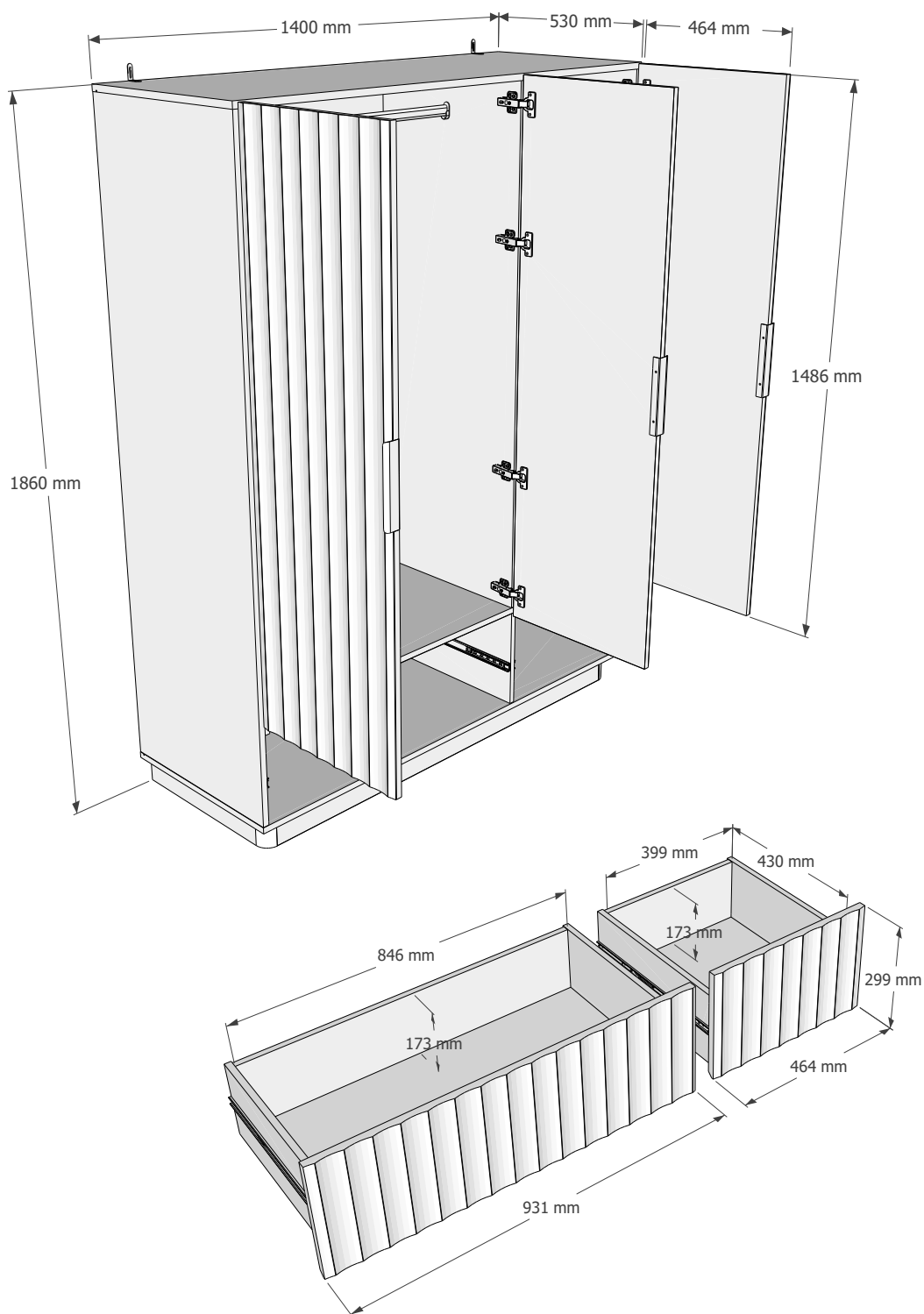

# NEXT

## KENDAL WHITE TRIPLE WARDROBE 349013

### Warnings

We suggest you retain these instructions for future reference.

Keep fittings out of children's reach and keep children well away from construction area.

Please periodically check all fittings and re-tighten as necessary.

Please do not sit or stand on your furniture.

Avoid exposing the furniture to excessive heat or direct sunlight as this can cause deterioration of the colour.

Unwrap all packaging materials and place the components on top of the carton box or on a clean floor to protect it from damage

Name and Address:NEXT RETAIL LTD.LE19 4AT  
identification and model Number:349013 KENDAL WHITE TRIPLE WARDROBE  
Date of Manufacture:  
Contract number:  
Nominal thickness of Glass:4mm,Annealed glass  
Country of Origin:China

If a glass component is chipped or broken replace with glass of the type described on this label.Consult with the retailer with regard to obtaining a manufacturing specification and shape for replacement glass quoting the model number,batch number and date of manufacture.

### Missing parts

If you are missing any fixtures and fittings for your product.  
Please contact our customer service team on 0333 777 8999 and they will be happy to arrange for a replacement to be sent to you free of charge.

### Home service technicians

If you have a fault with your product, please contact our customer service team on 0333 777 8999. If you have had the product for 28 days or less you may be offered a replacement,refund or for a fully trained home service technician to visit your home to assess the fault and repair the product where possible. If you have had the product for more than 28 days we will send an independant home service technician to review and repair the product where possible and recommend further action.

### You can write to us at

Home Customer Services  
Next Retail Ltd.  
Desford Road,  
Leicester,  
LE19 4AT

To view our full furniture range please visit [www.next.co.uk](http://www.next.co.uk)