

next

# FLYNN SINGLE BED

565137-12

Assembly instructions

**Actual product size**

H90 x W103 x D196cm

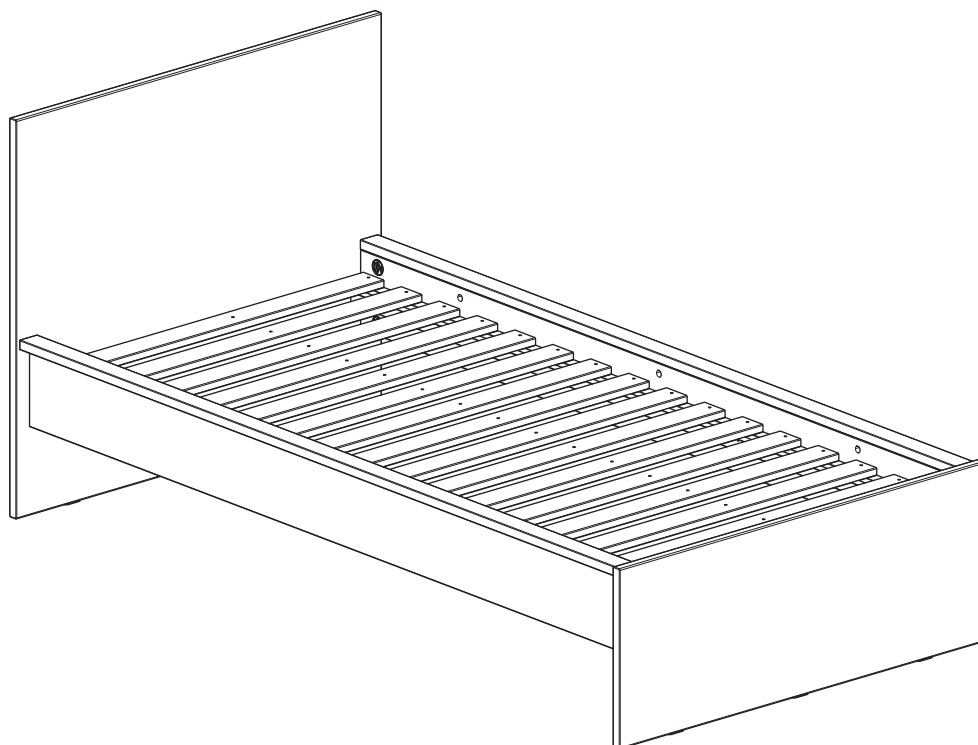

**Need Help?**

With: Assembly instructions  
Missing or damaged parts

**IMPORTANT— RETAIN FOR FUTURE REFERENCE**

**CALL: 0333 777 8999**

## BEFORE YOU START

### Warnings

#### WE SUGGEST YOU RETAIN THESE INSTRUCTIONS FOR FUTURE REFERENCE.

Keep fittings out of children's reach and keep children well away from the construction area.

This product should only be used on firm, level ground.

Please periodically check all fittings and re-tighten as necessary.

Please do not sit or stand on your furniture.

Avoid exposing the furniture to excessive heat or direct sunlight as this can cause deterioration of the colour.

Unwrap all packaging materials and place the components on top of the carton box or on a clean floor to protect it from damage.

This product is suitable for use by a person over the age of 4 years.

Do not use the product if any part is broken, damaged torn or missing, approved replacement parts can be obtained from Next Plc.

Do not place this product near heat sources, windows and other furniture.

Conforms to BS 8509:2008

Size of the mattress to be used with this bed is W190xD90 cm

### Do's

We suggest you spend a short time reading through this leaflet before you start.

When you are ready to start, make sure that you have the right tools and plenty of space.

Unwrap all packaging materials and place the components on a clean surface to protect it from damage.

We recommend that the packaging is used to protect the surfaces during assembly.

Carefully check that you have all the parts before beginning assembly

Due to the size of the product we recommend that it is assembled in the room intended for use.

Ensure the product is fully assembled as illustrated and all fixings are fully tightened before use.

Periodically check that fittings are tightened properly

Wipe occasionally with a soft cloth slightly dampened with water. Then buff with a dry clean soft cloth.

Wood will mellow and change colour over time, we recommend that ornaments and items placed on the surface are moved regularly for the first few months to prevent uneven mellowing.

### Don't's

Do not drag or pull your furniture.

Do not use silicone based furniture polish. Silicone in furniture polishes can break down the finish.

Never allow any kind of liquid to remain on your furniture.

Absorption can cause wood to warp or finishes to de-laminate.

Do not place hot items (e.g. hot drinks) directly on to the wood surface. Please make sure you use a placement or coaster.

Do not disassemble the bed once built.

Children are likely to play, bounce, jump and climb on beds, therefore the child's bed should not be placed too close to other furniture or windows, and should be placed either tight to any wall of have a gap 300mm between the wall and the side of the bed.

### Number of people required to assemble

Two persons are required to assemble this item.

### Time to assemble



### Tools required



not supplied

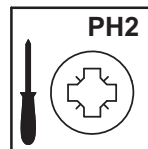

not supplied

### Missing parts

If you are missing any fixtures and fittings for your product please contact our customer service team on 0333 777 8999 and they will be happy to arrange for a replacement to be sent to you free of charge.

### Home service technicians

If you have a fault with your product please contact our customer service team on 0333 777 8999. If you have had the product for 28 days or less you may be offered a replacement, refund or for a fully trained home service technician to visit your home to assess the fault and repair the product where possible. If you have had the product for more than 28 days we will send an independent home service technician to review and repair the product where possible and recommend further action.

### You can write to us at

Home Customer Services  
Next Retail Ltd,  
Desford Road,  
Leicester,  
LE19 4AT

To View our full furniture range please visit [www.next.co.uk](http://www.next.co.uk)

## GETTING TO KNOW YOUR PRODUCT

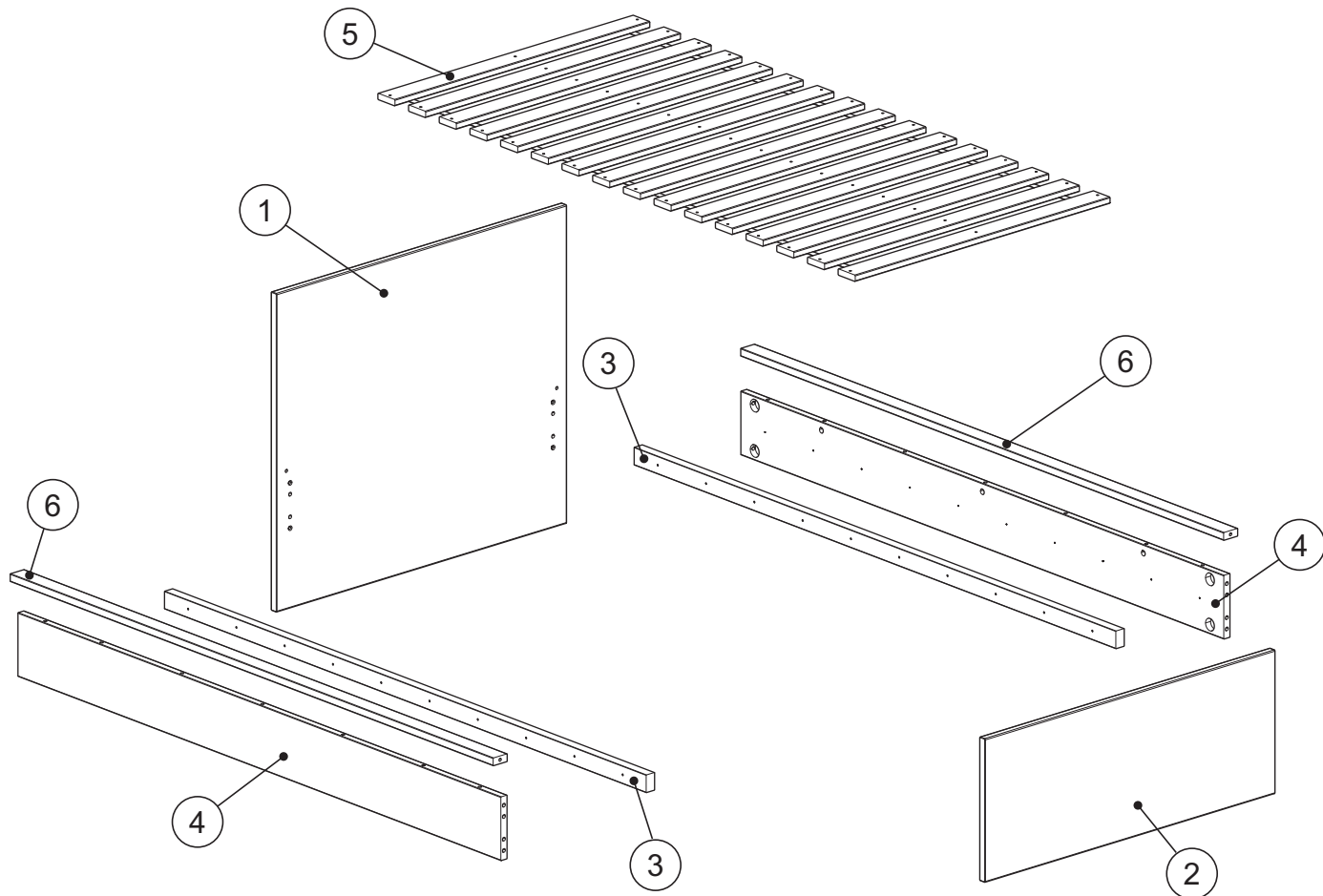

Components supplied. Please use this guide if you require replacement parts.

Ref	Dimensions	Visual	Qty	Ctn
1	103,4 x 90cm		1	1
2	103,4 x 40,6cm		1	1
3	191,5 x 5cm		2	2
4	192 x 18cm		2	2

Ref	Dimensions	Visual	Qty	Ctn
5	189,8x90,8cm		1	2
6	192 x 5cm		2	2

Fixtures and fittings supplied (actual size)

Ref	Dimensions	Quantity
A	8 x 36mm	6
B	15 x 12.5mm	6
C	8 x 30mm	12
D	Ø10 x 40mm	8
E	4 x 45mm	28

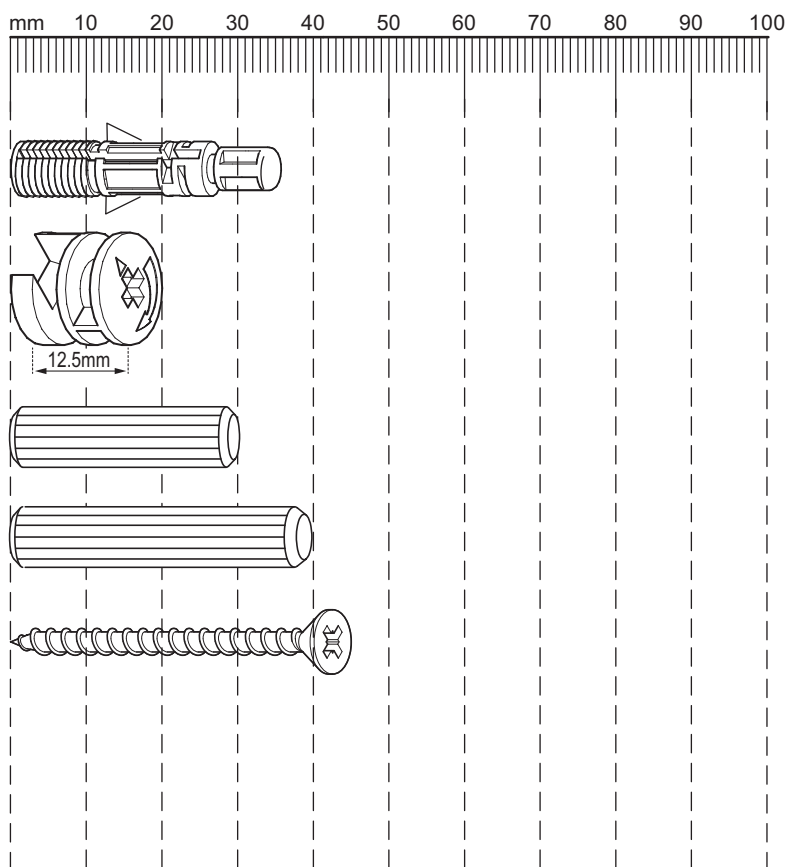

Fixtures and fittings supplied (not to scale)

Ref	Dimensions	Visual	Qty
F	N/A		8
G	N/A		8
J	N/A		1
K	N/A		6

Fixtures and fittings supplied (not to scale)

Ref	Dimensions	Visual	Qty

1

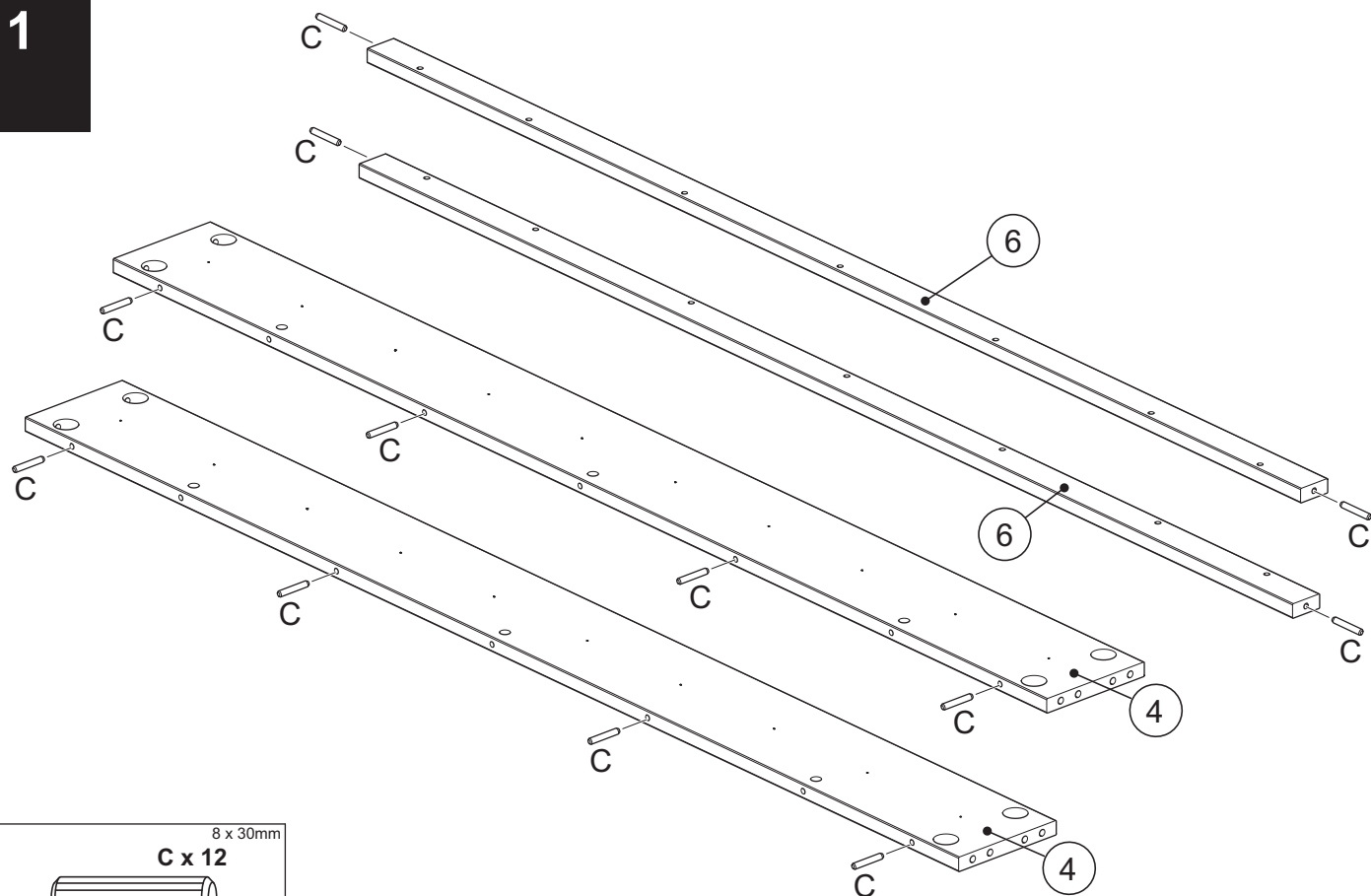

2

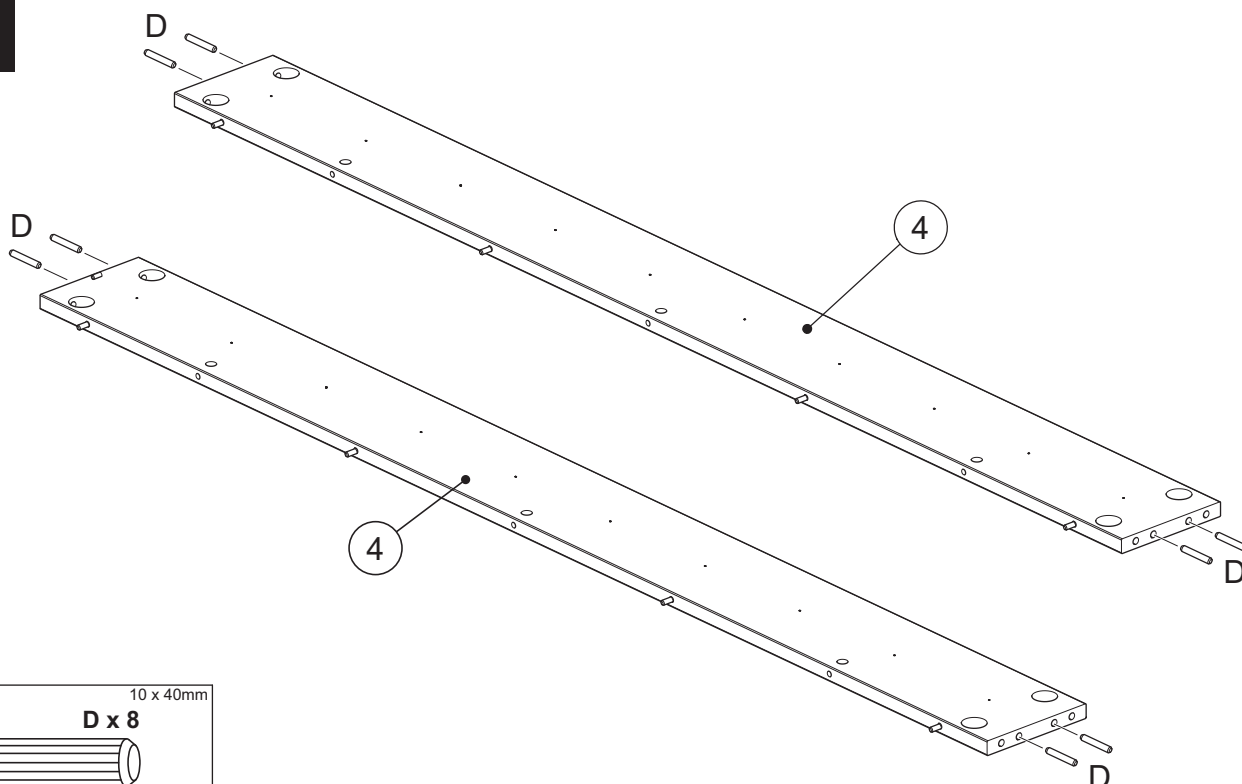

3

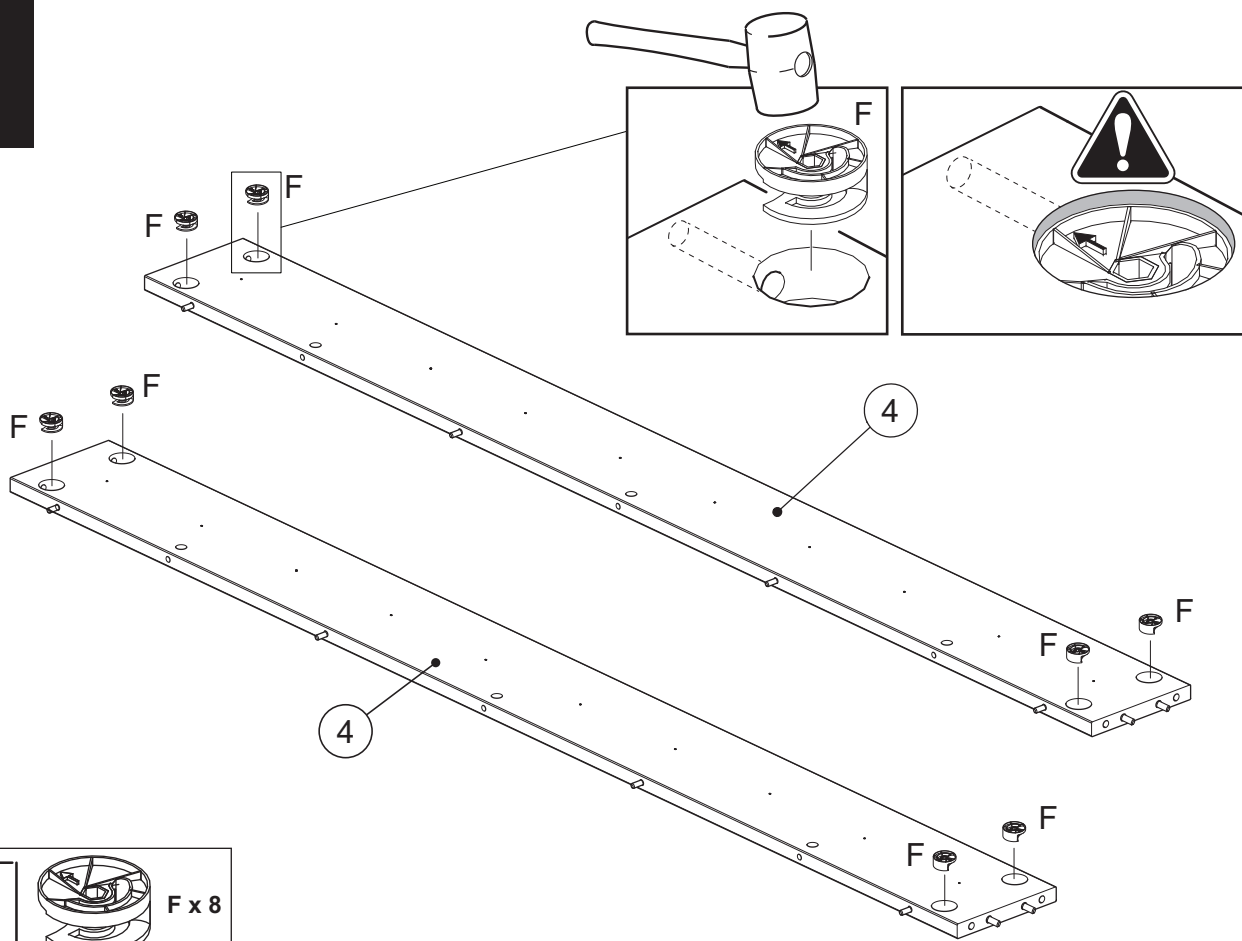

F x 8

4

**WHEN FITTING CAMS**  
ENSURE STARTING POSITION IS CORRECT  
BEFORE YOU INSERT CONNECTING CAM-PILLAR

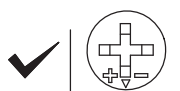

CORRECT

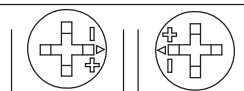

WRONG

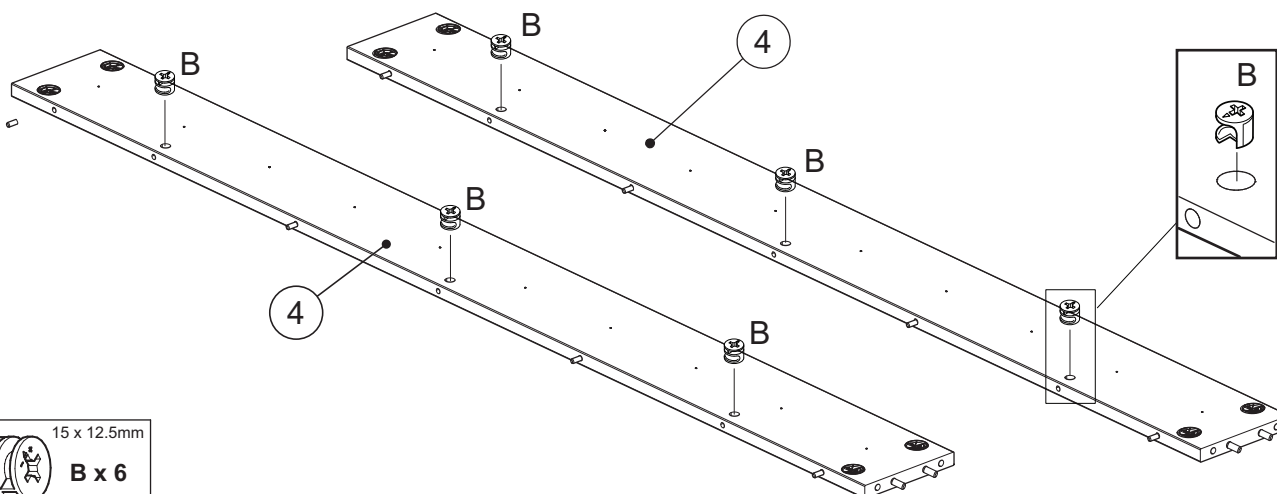

15 x 12.5mm

B x 6

5

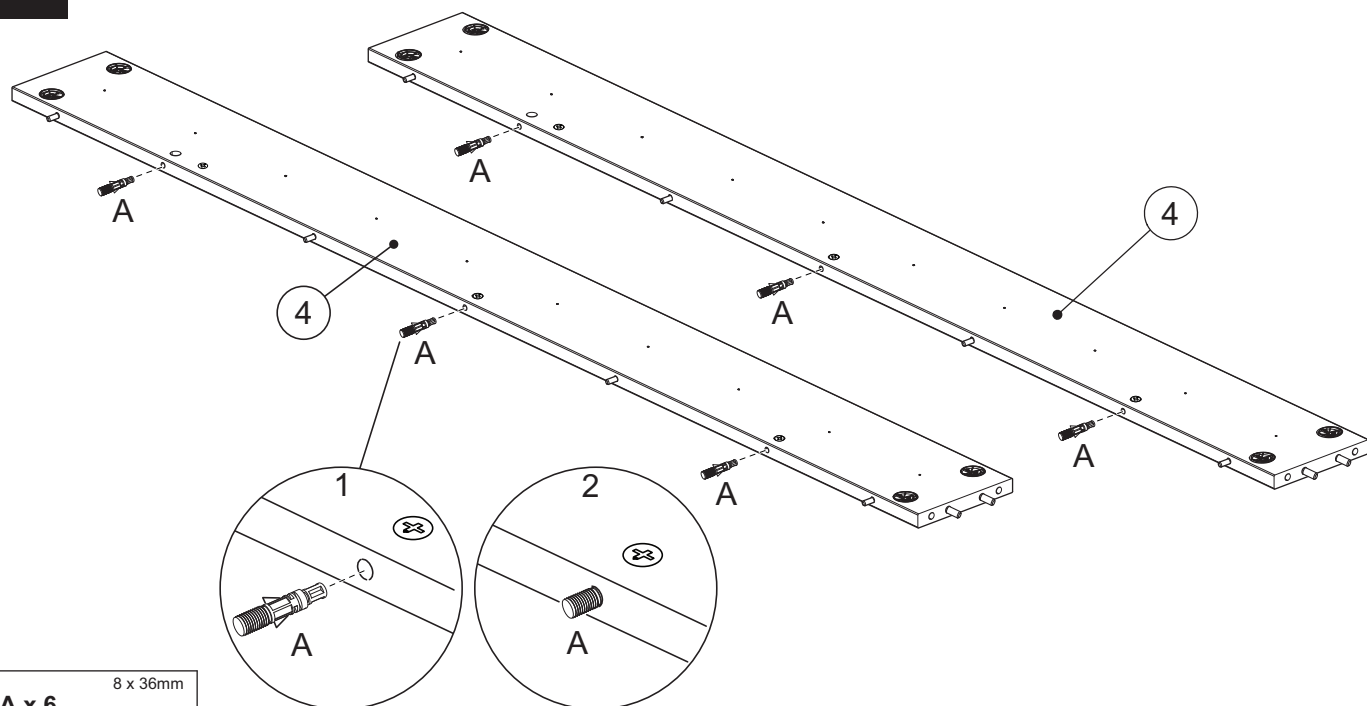

A x 6

8 x 36mm



6

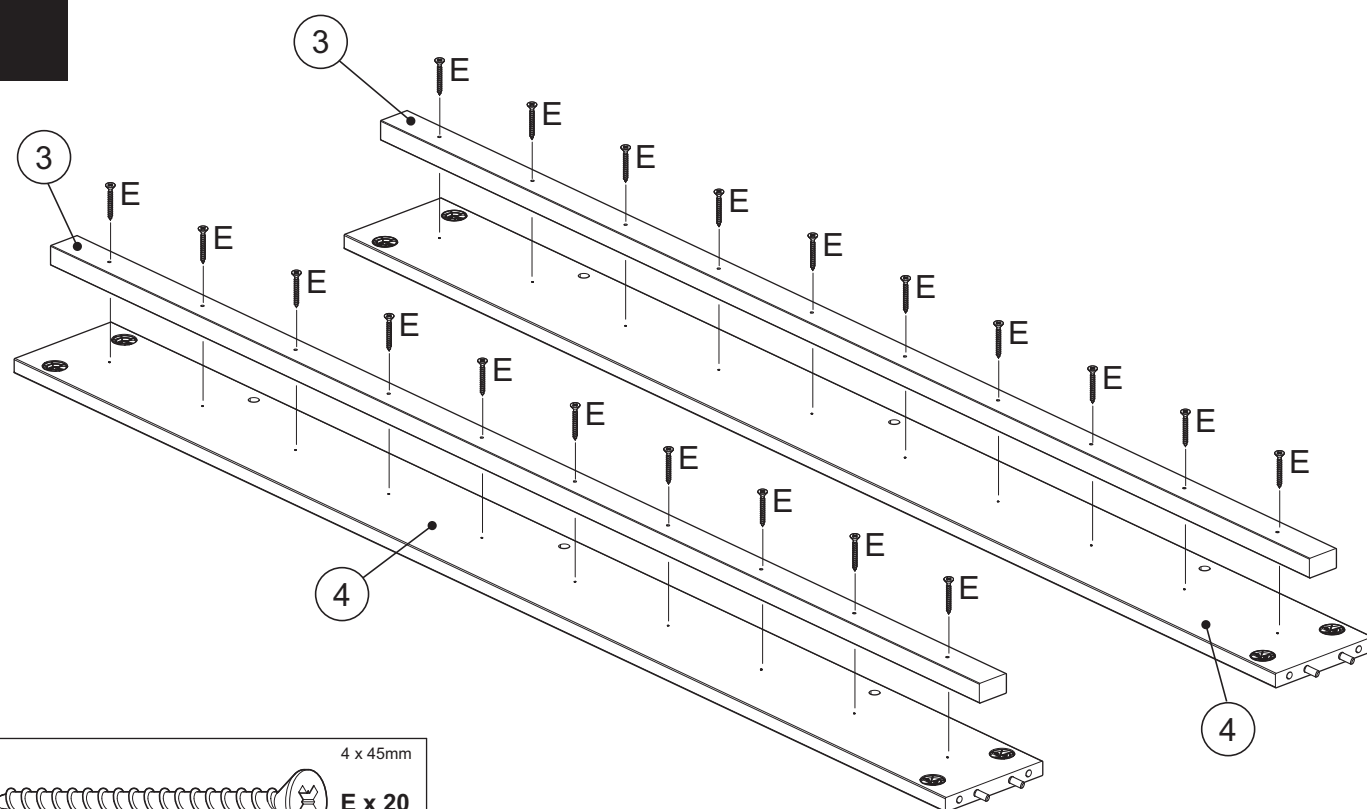

4 x 45mm

E x 20



7

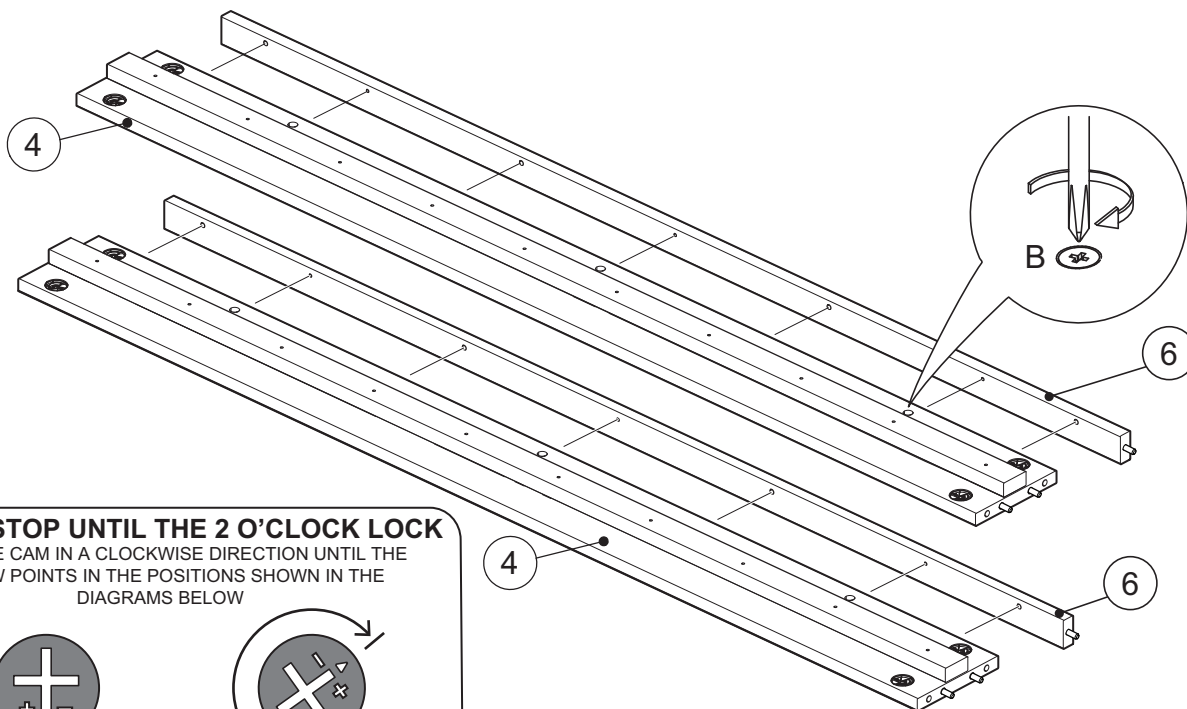

**DON'T STOP UNTIL THE 2 O'CLOCK LOCK**

TURN THE CAM IN A CLOCKWISE DIRECTION UNTIL THE ARROW POINTS IN THE POSITIONS SHOWN IN THE DIAGRAMS BELOW



START



CORRECT LOCK



8

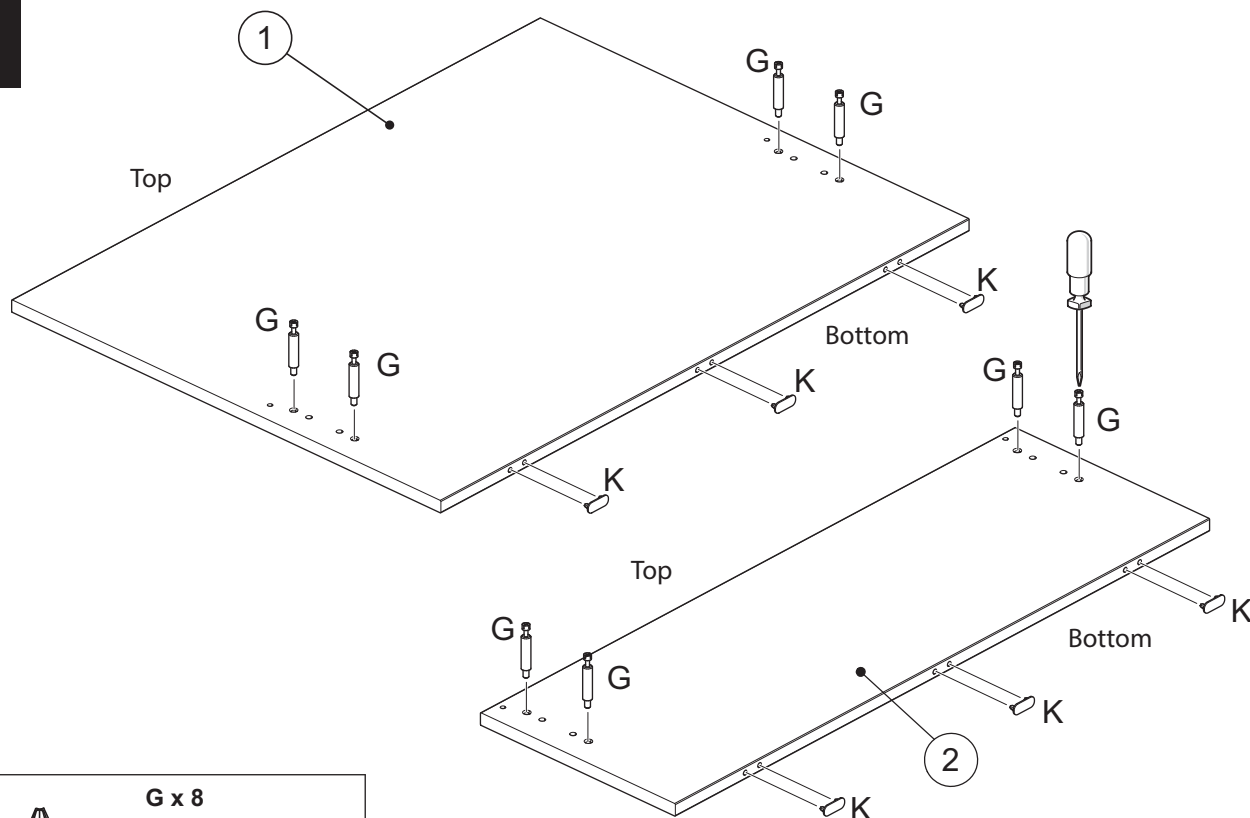

K x 6

G x 8

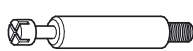



9

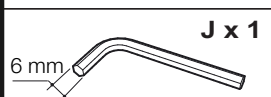
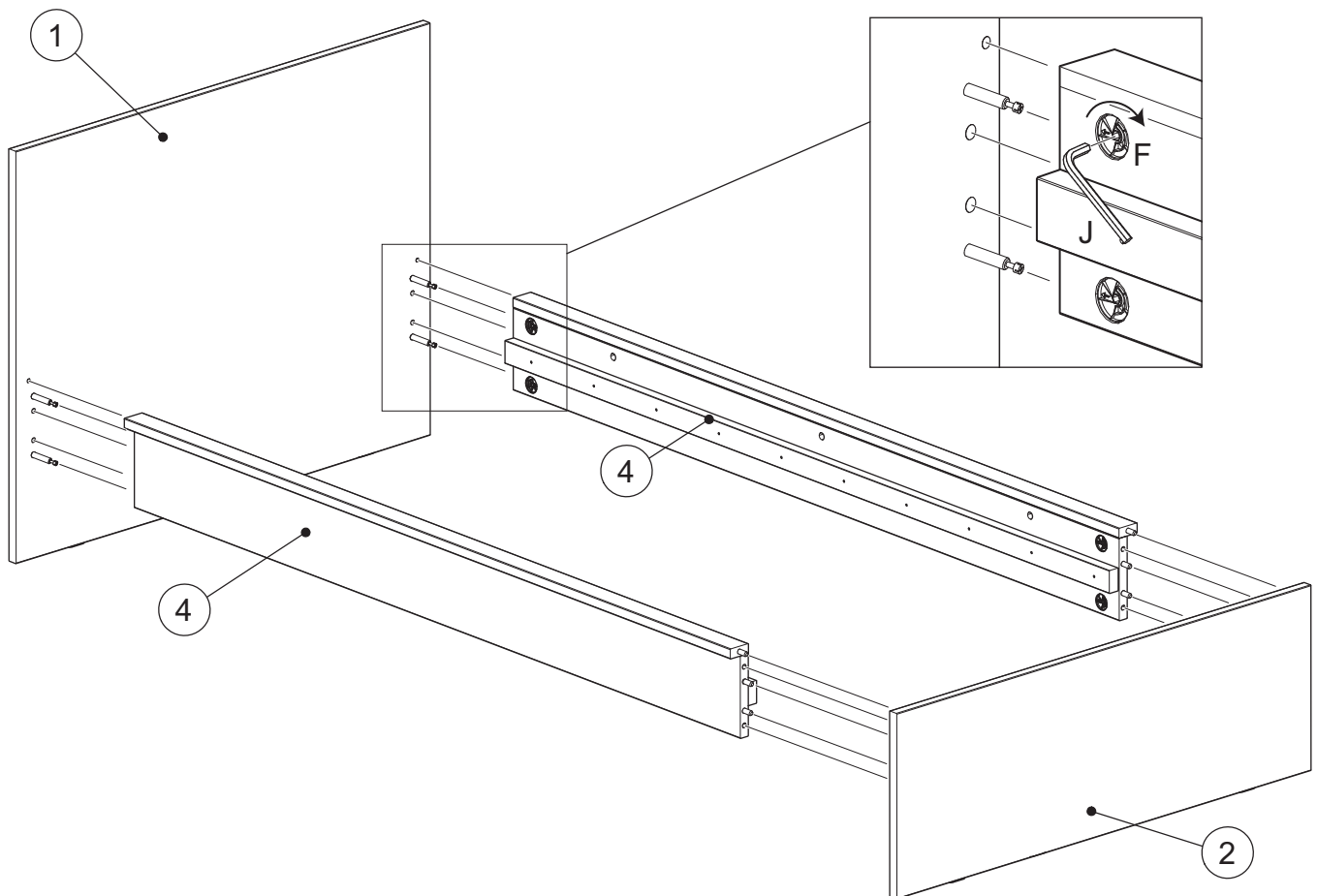

10

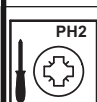
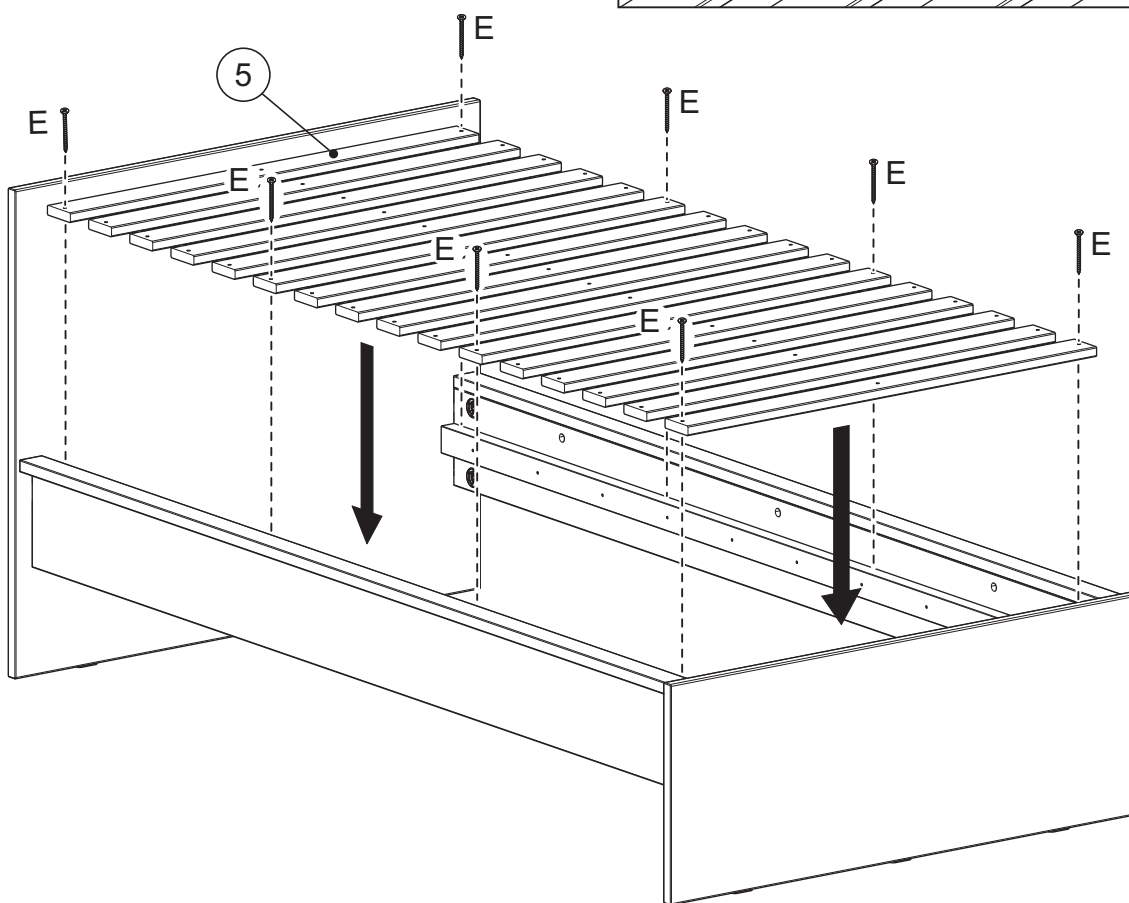
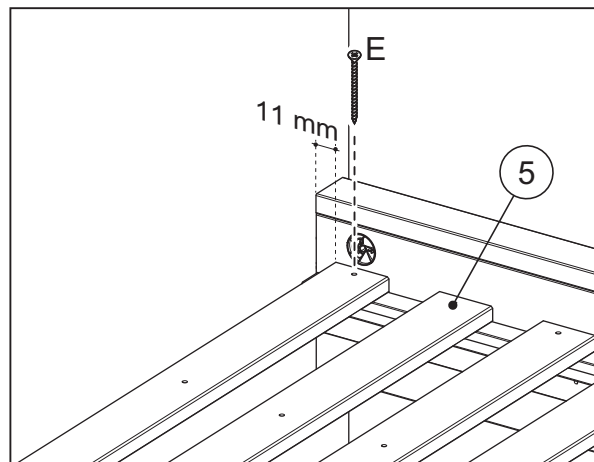

E x 8

Ø4 x 45mm



**Actual product size**

H90 x W103 x D196cm

