

next

WESTCOTT SINGLE STORAGE BED

127530/659171/682841/685955/686140/862522/401683

Assembly instructions

Actual product size

H115 x W103 x D235cm (Single)

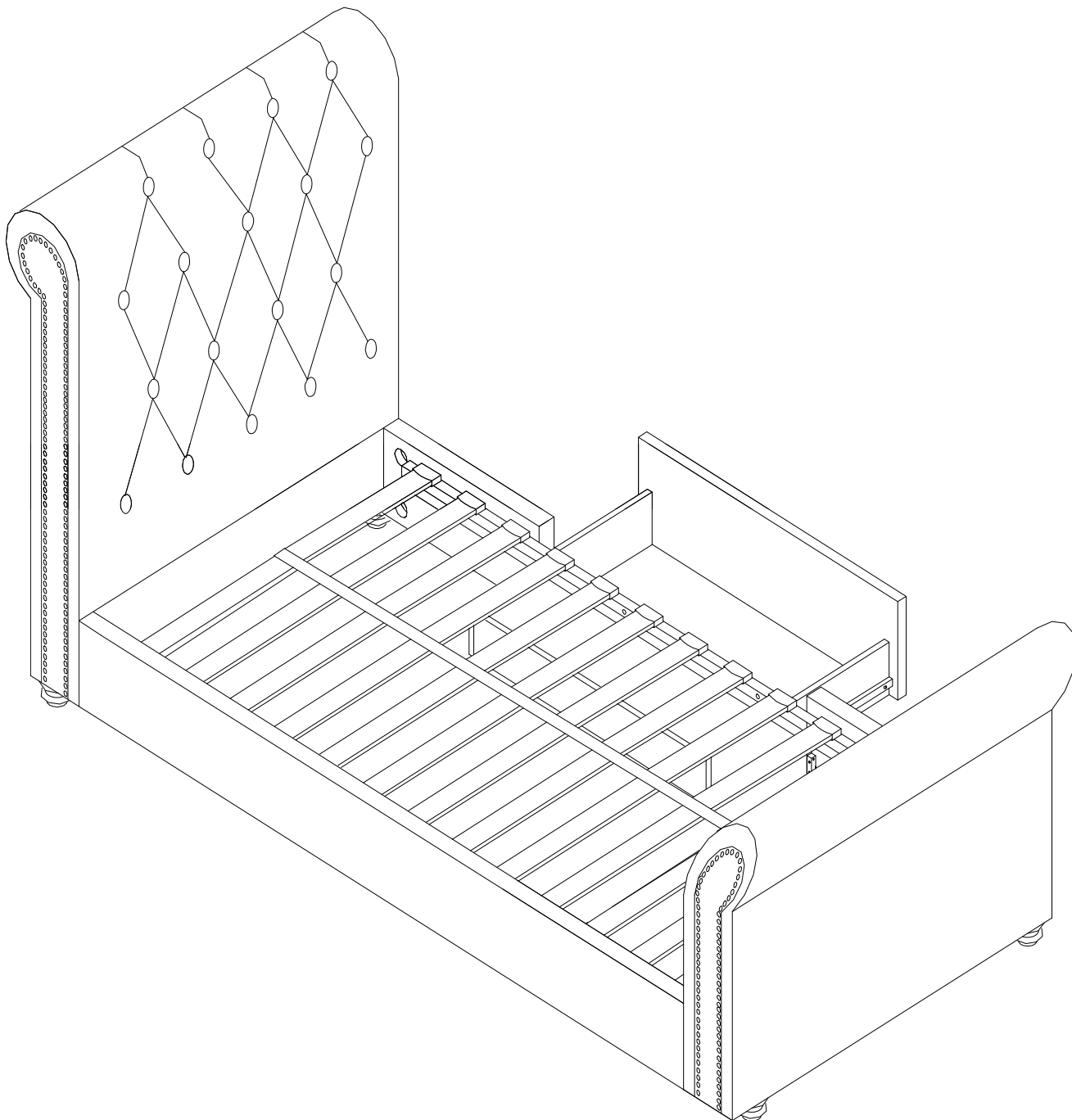

IMPORTANT! KEEP FOR FUTURE REFERENCE

Need Help?

With: Assembly Instructions

Missing or damaged parts

CALL: 0333 777 8999

BEFORE YOU START

WARNINGS

WARNING: Once assembled this bed is not designed to be disassembled and reassembled.

Children are likely to play, bounce, jump and climb on beds, therefore the child's bed should not be placed too close to other furniture or windows, blind cords, curtain pulls or other strings or cords and should be placed either tight to any wall or have a gap of 300mm between the wall and the side of the bed.

This size of the mattress to be used with the child's bed is 900mm x 1900mm.

This Child's bed is intended for children above 4 years old

WARNING: Not suitable for children under 4 years.

Do's

When you are ready to start, make sure that you have the right tools and plenty of space.

Due to the size of the product we recommend that it is assembled in the room intended for use.

Unwrap all packaging materials and place the components on a clean surface to protect it from damage. We recommend that the packaging is used to protect the surfaces during assembly.

Carefully check that you have all the parts before beginning assembly.

Please periodically check all fittings and re-tighten as necessary.

To clean your item, wipe with soft cloth slightly dampened with water. Then buff with a dry clean cloth.

Routinely check that the fittings are secure and tighten any fittings using the appropriate tools.

If any parts are missing please contact Next to obtain replacements. Under no circumstances should missing parts or hardware be substituted unless obtained from Next.

Don'ts

Do not tighten screws until fully assembled.

Do not over tighten screws or bolts.

Do not drag or pull your furniture.

Do not use this product if parts are missing, damaged or worn.

Never use scourers, abrasives or chemical cleaners.

Number of people required to assemble

Two persons are required to assemble this product.

Time to assemble



Tools required

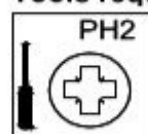

not supplied

Missing parts

If you are missing any fixtures and fittings for your product please contact our customer service team on **0333 777 8999** and they will be happy to arrange for a replacement to be sent to you free of charge.

Home service technicians

If you have a fault with your product please contact our customer service team on **0333 777 8999**. If you have had the product for 28 days or less you may be offered a replacement, refund or for a fully trained home service technician to visit your home to assess the fault and repair the product where possible. If you have had the product for more than 28 days we will send an independent home service technician to review and repair the product where possible and recommend further action.

You can write to us at

Next Retail Ltd,
Desford Road,
Leicester,
LE19 4AT,

To view our full furniture range please visit www.next.co.uk

GETTING TO KNOW YOUR PRODUCT

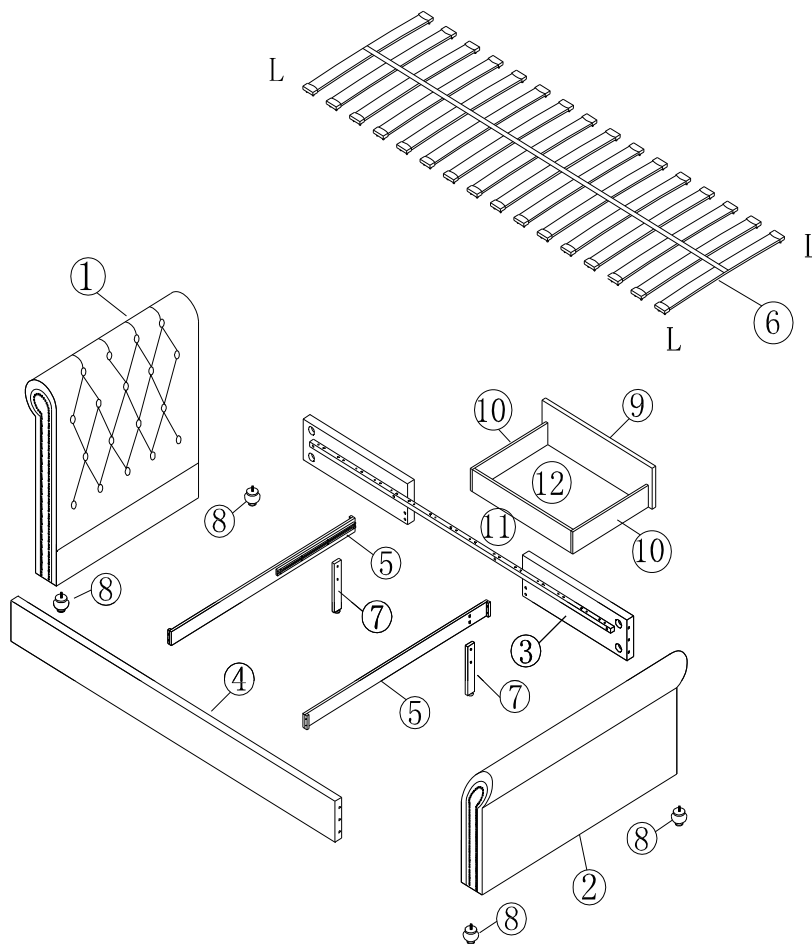

Components supplied. Please use this guide if you require replacement parts.

Ref	Dimensions	Visual	Qty	Ctn
1	Headboard		1	1
2	Footboard		1	3
3	Side rail panel		1	2
4	Right side rail		1	2
5	Drawer support rail		2	1
6	Slats		15	4
7	Wood support leg		2	1
8	Leg		4	3

Ref	Dimensions	Visual	Qty	Ctn
9	Drawer front panel		1	2
10	Drawer side panel		2	1
11	Drawer back panel		1	1
12	Drawer bottom		1	1
13	Drawer strength rail		1	1

Fixtures and fittings supplied

Ref	Dimensions	Qty
A	M8x80	8
B	M6x35	12
C	M6*30	2
D	15*12mm	8
E	M8	8
F	M8	8
G	M6	12
H	M6	12
I	4*29mm	8
J	∅10*40mm	4
K	∅8*30mm	8
L	65*30mm	30
M	M6	1
N	M8	1

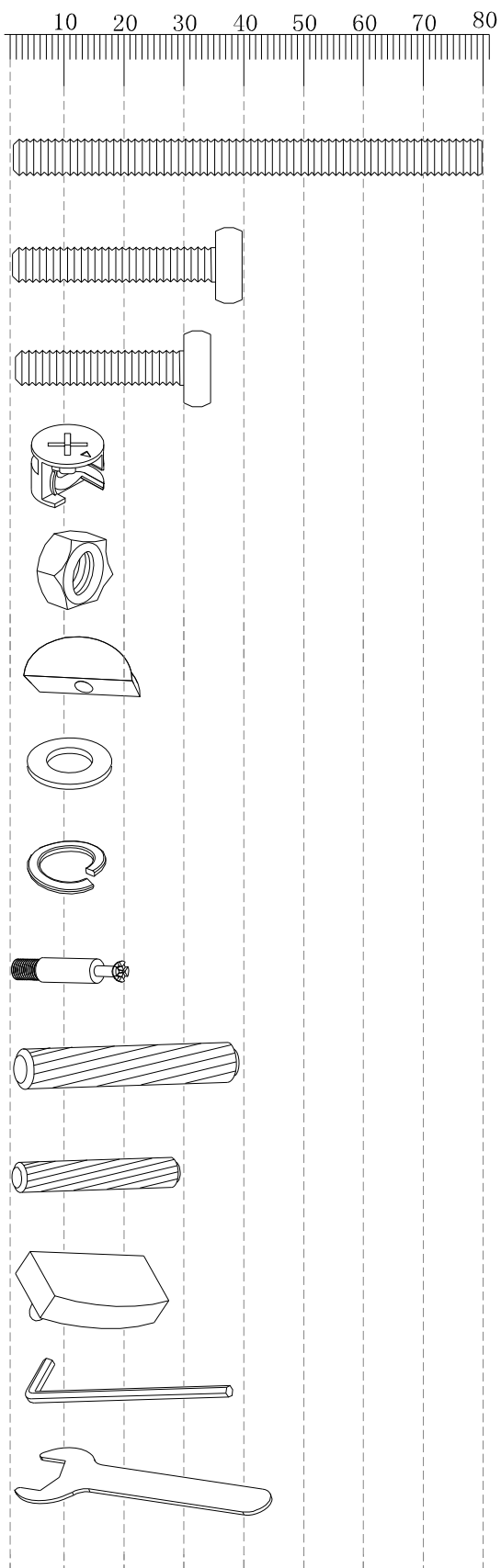

1

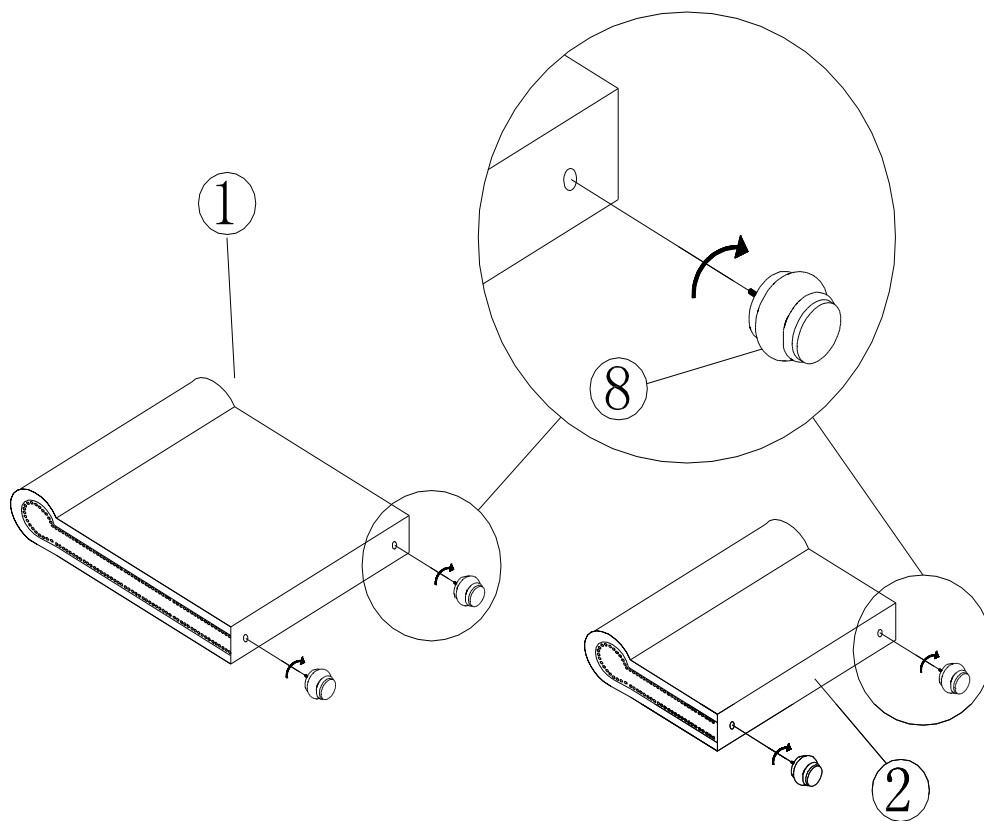

2

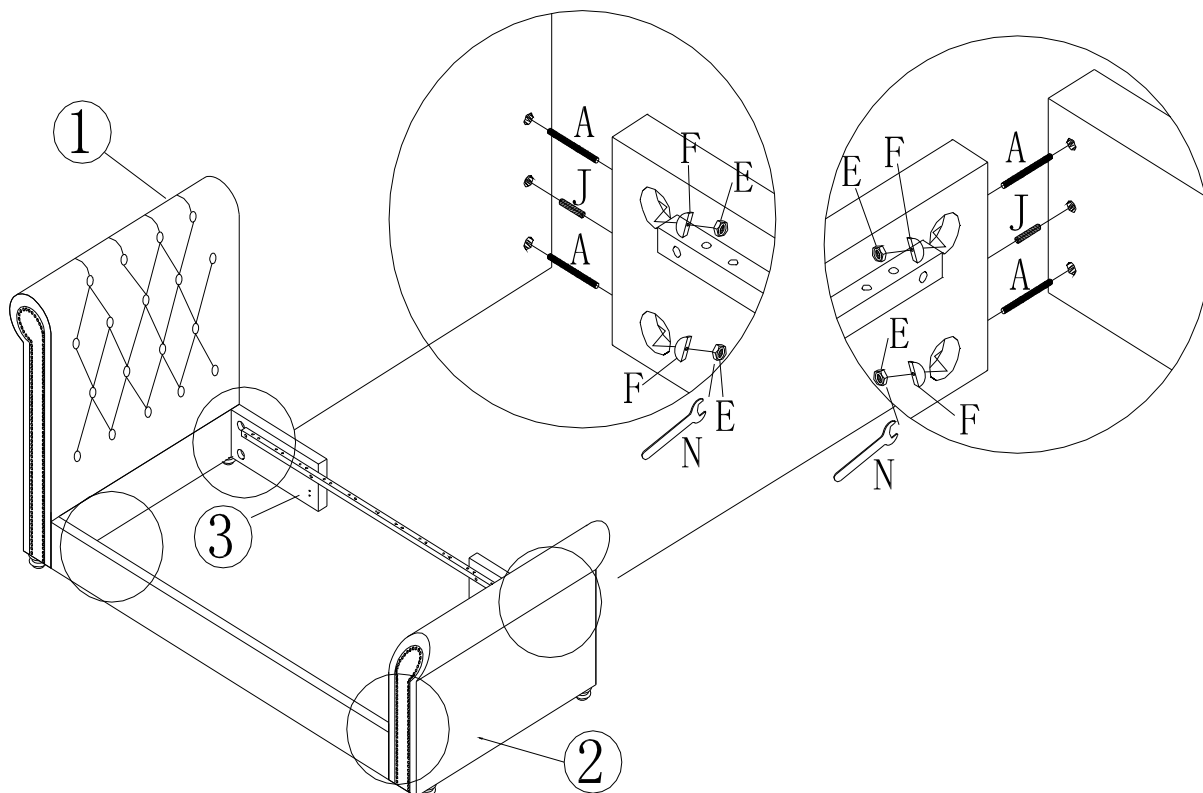

A x8 M8 x 80mm

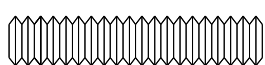

F x8 M8

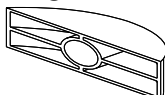

E x8 M8



J x4 $\Phi 10 \times 40\text{mm}$

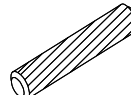

N x1 M8

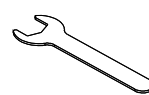

3

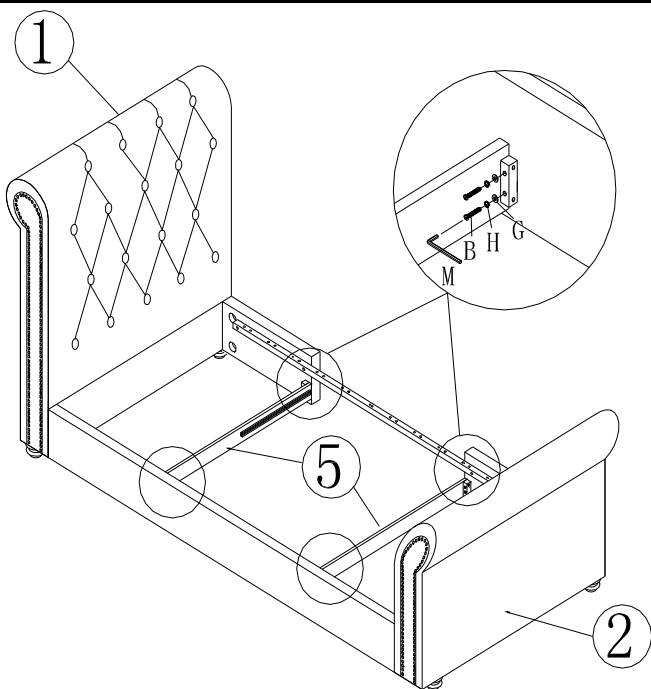

B x8 M6 x 35mm

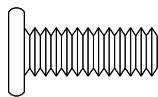

G x8 M6

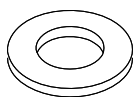

H x8 M6



M x1 M6

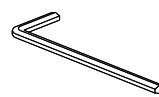

4

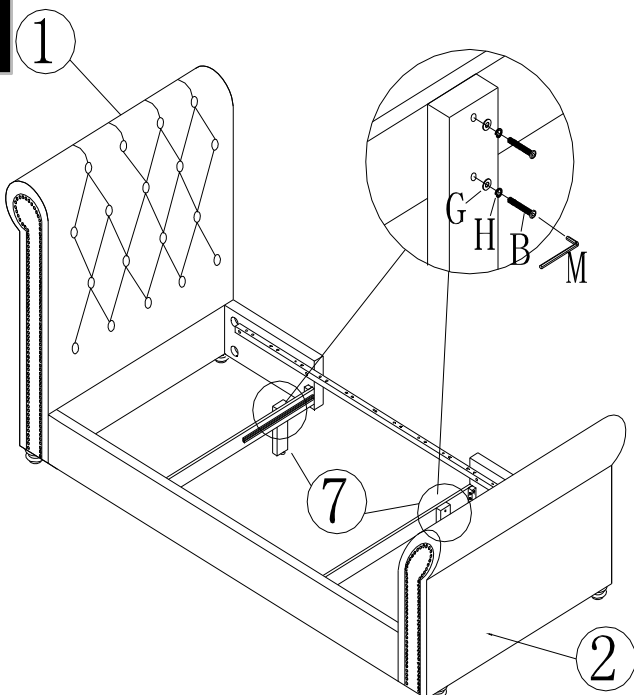

IMPORTANT

Once the feet have been assembled and attached, they should be adjusted to ensure they do not touch the floor, (5mm above the floor) to allow for movement once the mattress is placed on the bed frame.

It is important to note that when moving the bed that it is not dragged into its new position to prevent the possibility of these feet being twisted or angled to one side, which could lead to the collapse of the centre of the bed.

To move the bed, remove the mattress and lift the bed into its new position to avoid damage. Ensure the feet are at 90° to the floor before replacing the mattress.

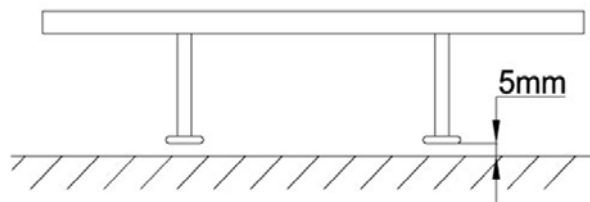

B x4 M6 x 35mm

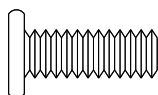

G x4 M6

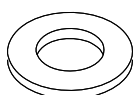

H x4 M6



M x1 M6

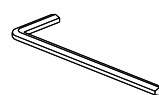

5

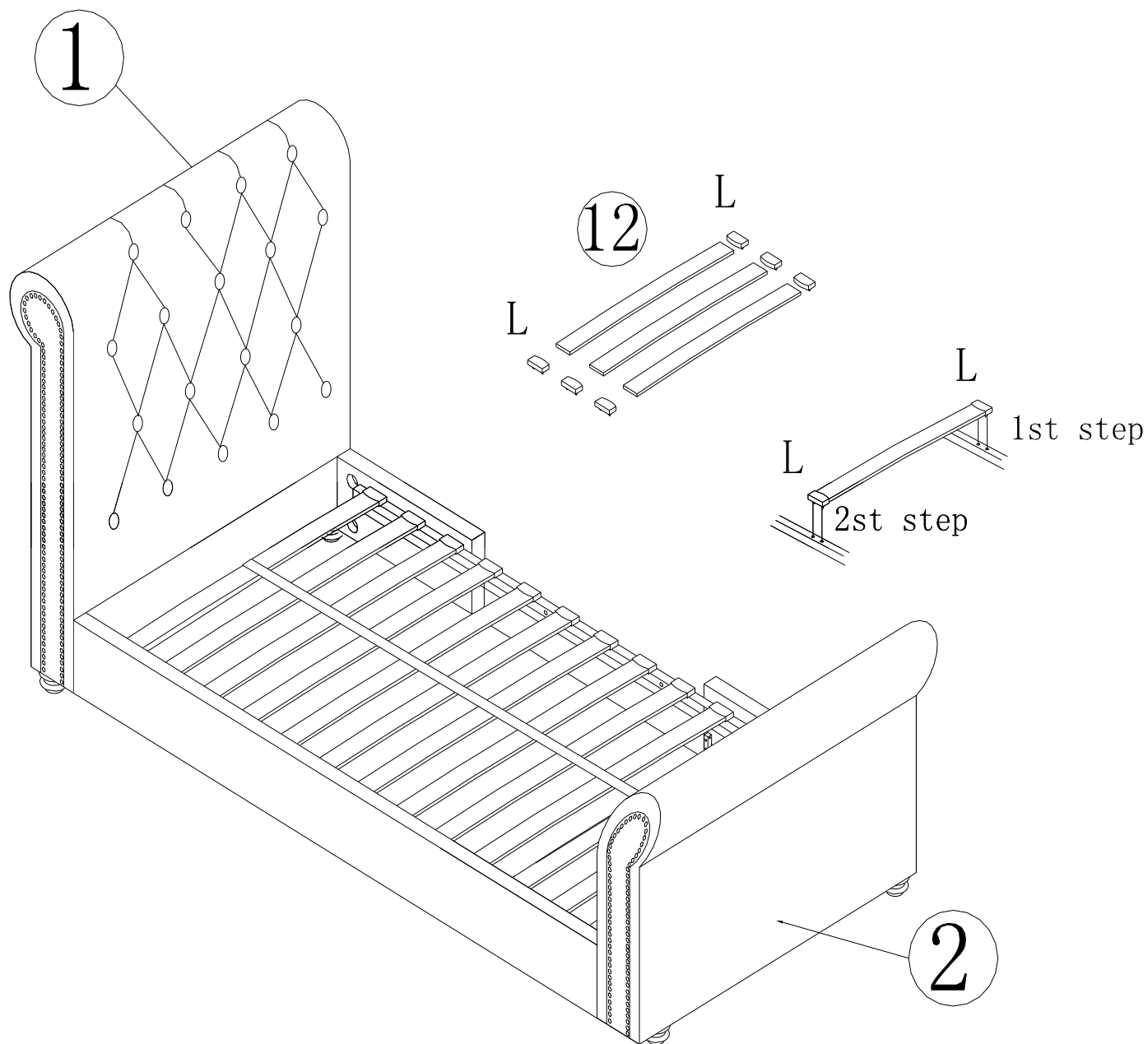

L x30 65 x 60mm

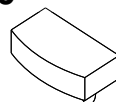

6

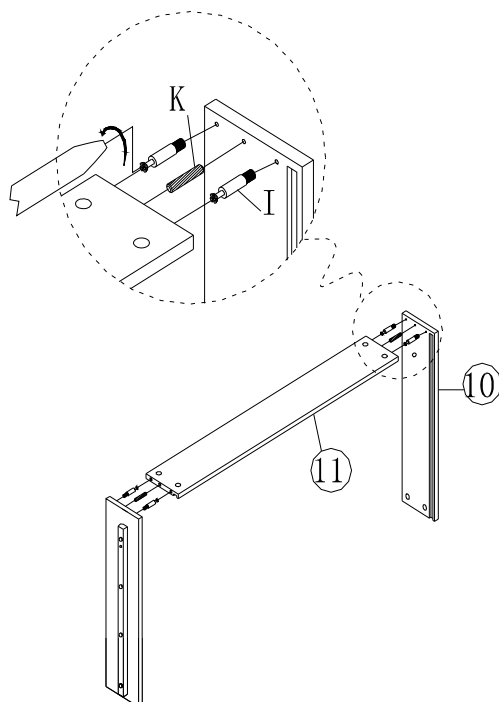

CAM-LOCK

Tighten until shoulder is flush with panel. Do not overtighten or undertighten (see example below)

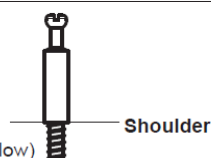

NO GAP

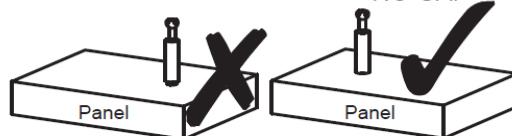

WHEN FITTING CAMS

ENSURE STARTING POSITION IS CORRECT BEFORE YOU INSERT CONNECTING CAM-PILLAR TURN CLOCKWISE UNTIL SECURE

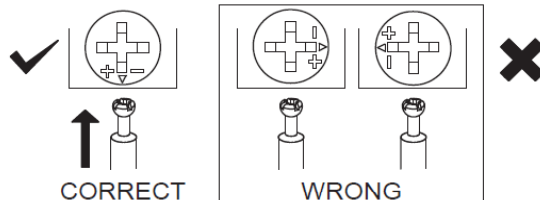

X1

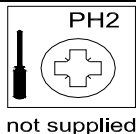

I x4

4 x 29mm

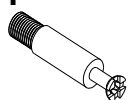

K x2

Φ8*30mm

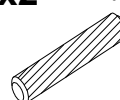

7

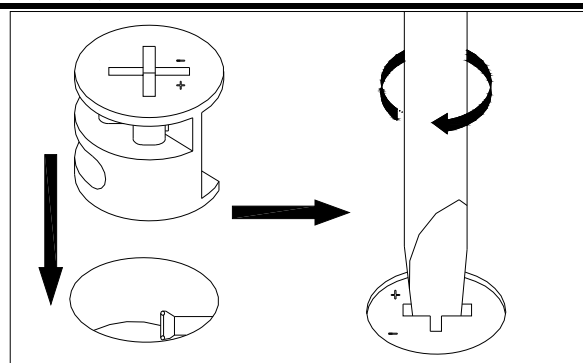
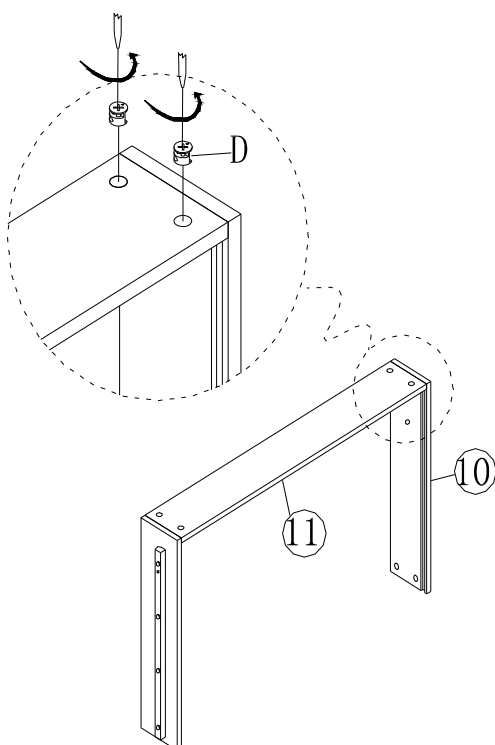

X1

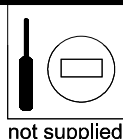

not supplied

D x4

15x12mm

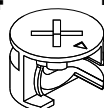

8

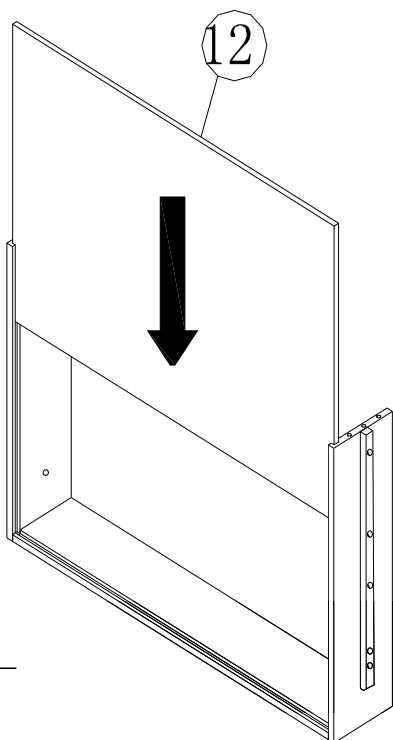

X1

9

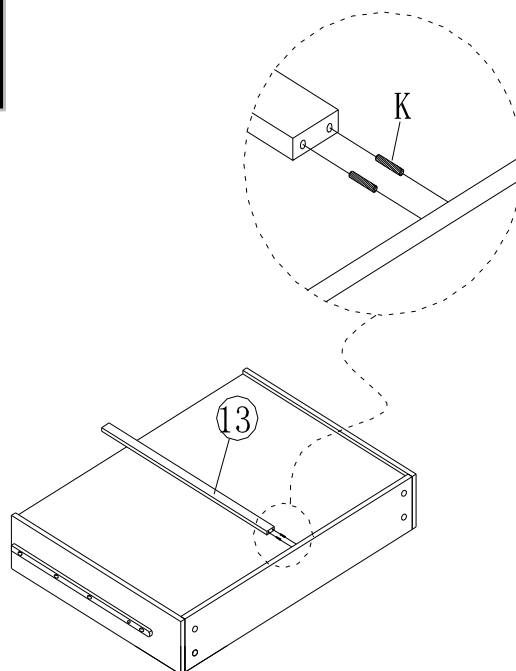

X1

K x2

Φ8*30mm

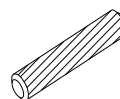

10

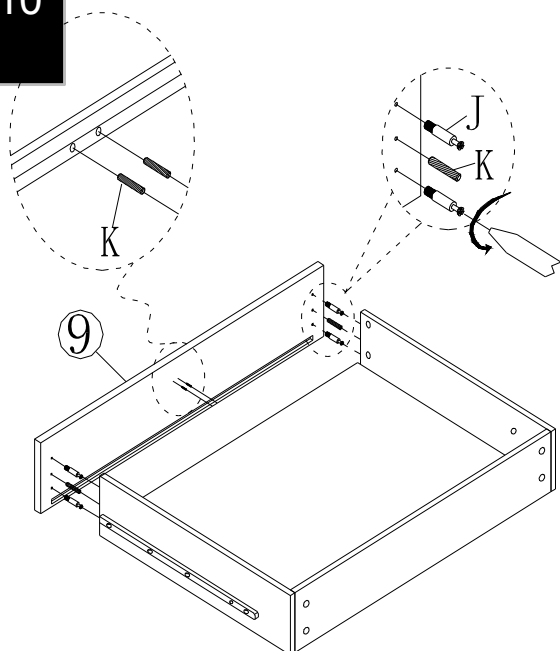

X1

11

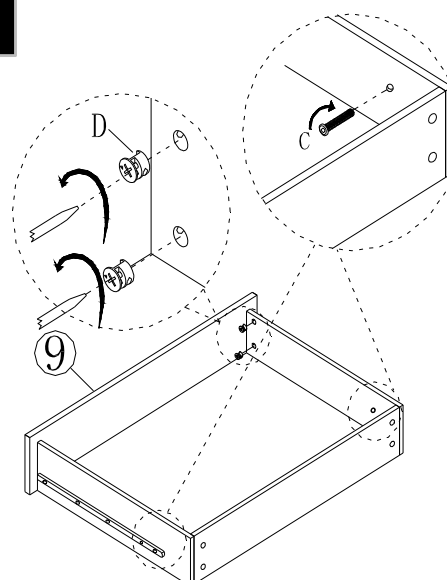

X1

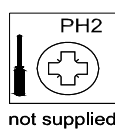

J x4

4 x 29mm

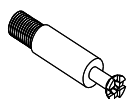

Kx4

Φ8*30mm

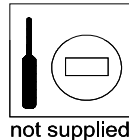

D x4

15x12mm



C x2

M6 x 30mm

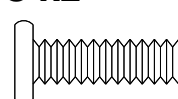

next

WESTCOTT SINGLE STORAGE BED

127530/659171/682841/685955/686140/862522/401683

Actual product size

H115 x W103 x D235cm (Single)

Mattress size

W90 x L190cm (Single)

