

next

FLYNN 6DRW WDE

884292 / 902605 / 969528

Assembly instructions

Actual product size

H95 x W117.4 x D39.2cm

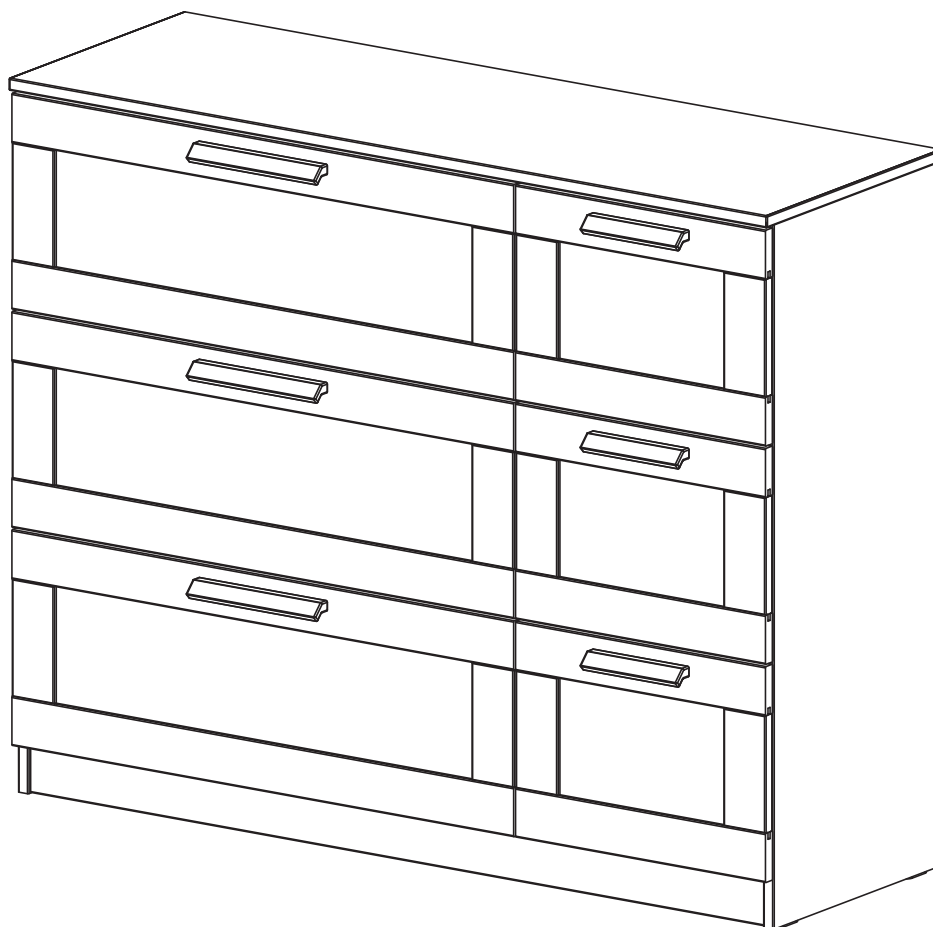

Need Help?

With: Assembly instructions
Missing or damaged parts

IMPORTANT— RETAIN FOR FUTURE REFERENCE

CALL: 0333 777 8999

BEFORE YOU START

****IMPORTANT**** : Assembly to be carried out by a competent adult only - Do not use this item if any components are missing or damaged

Warnings

IMPORTANT: RETAIN THESE INSTRUCTIONS FOR FUTURE REFERENCE

Keep fittings out of children's reach and keep children well away from the construction area.

This product should only be used on firm, level ground.

Please periodically check all fittings and re-tighten as necessary.

Please do not sit or stand on your furniture.

Avoid exposing the furniture to excessive heat or direct sunlight as this can cause deterioration of the colour.

Unwrap all packaging materials and place the components on top of the carton box or on a clean floor to protect it from damage.

Serious or fatal crushing injuries can occur from furniture tip-over. To prevent this furniture from tipping over it must be permanently fixed to the wall.

Fixing devices for the wall are not included since different wall materials require different types of fixing devices. Use fixing devices suitable for the walls in your home.

Recommended Child age for this furniture is age 3-12 years.

5 kg max load per slim drawer + 10.5 kgs max load for wide drawer.

Do's

We suggest you spend a short time reading through this leaflet before you start.

When you are ready to start, make sure that you have the right tools and plenty of space.

Unwrap all packaging materials and place the components on a clean surface to protect it from damage.

We recommend that the packaging is used to protect the surfaces during assembly.

Carefully check that you have all the parts before beginning assembly

Due to the size of the product we recommend that it is assembled in the room intended for use.

Ensure the product is fully assembled as illustrated and all fixings are fully tightened before use.

Wipe occasionally with a soft cloth slightly dampened with water. Then buff with a dry clean soft cloth.

Wood will mellow and change colour over time, we recommend that ornaments and items placed on the surface are moved regularly for the first few months to prevent uneven mellowing.

Number of people required to assemble

One person is required to assemble this item.

Time to assemble



1 hour

Tools required



not supplied

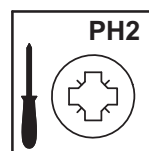

not supplied

Don'ts

Do not drag or pull your furniture.

Do not use silicone based furniture polish. Silicone in furniture polishes can break down the finish.

Never allow any kind of liquid to remain on your furniture.

Absorption can cause wood to warp or finishes to de-laminate.

Do not place hot items (e.g. hot drinks) directly on to the wood surface. Please make sure you use a placement or coaster.

Missing parts

If you are missing any fixtures and fittings for your product please contact our customer service team on 0333 777 8999 and they will be happy to arrange for a replacement to be sent to you free of charge.

Home service technicians

If you have a fault with your product please contact our customer service team on 0333 777 8999. If you have had the product for 28 days or less you may be offered a replacement, refund or for a fully trained home service technician to visit your home to assess the fault and repair the product where possible. If you have had the product for more than 28 days we will send an independant home service technician to review and repair the product where possible and recommend further action.

You can write to us at

Home Customer Services
Next Retail Ltd,
Desford Road,
Leicester,
LE19 4AT

To View our full furniture range please visit www.next.co.uk

PRODUCT SUPPLIED WITH WALL FIXING STRAP

GETTING TO KNOW YOUR PRODUCT

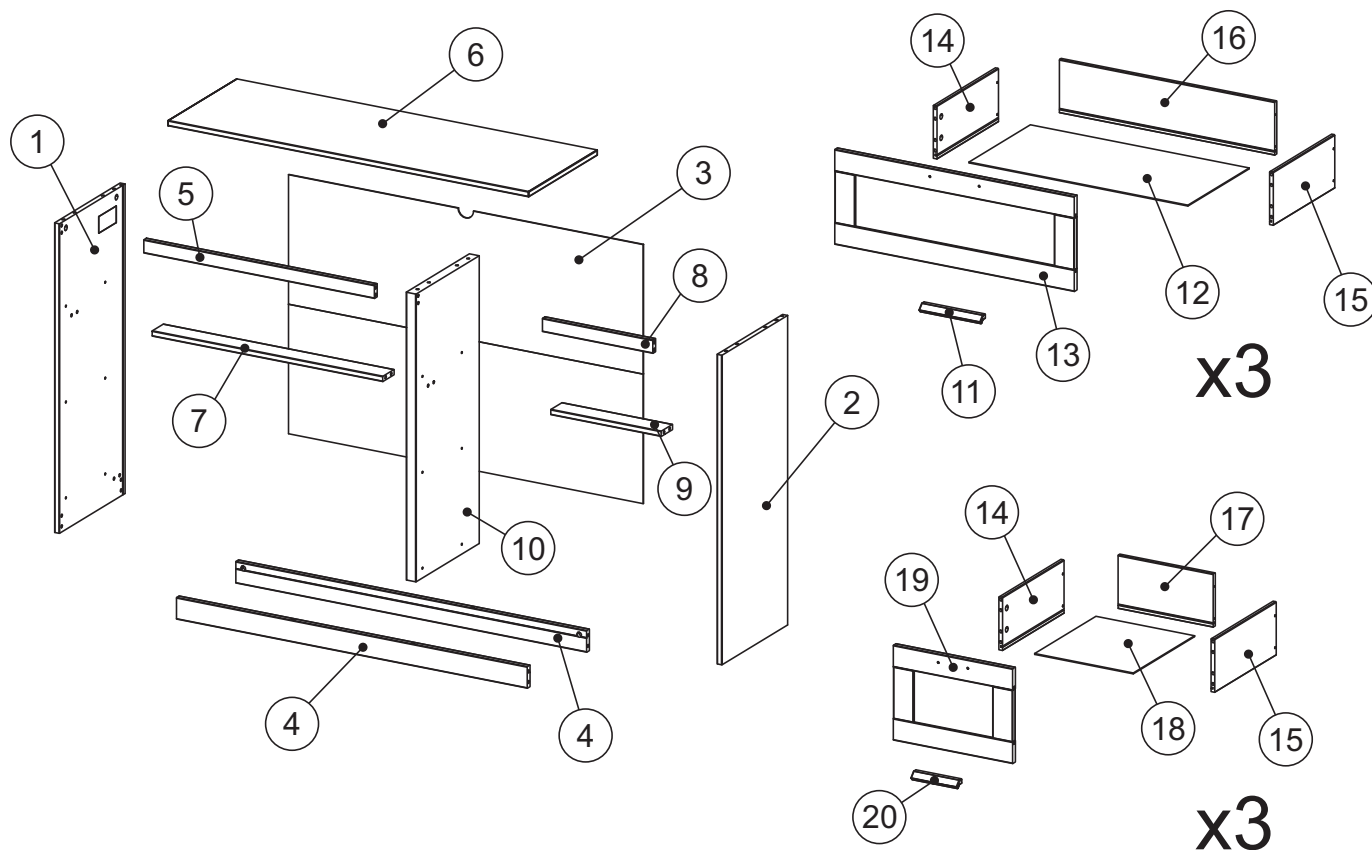

Components supplied. Please use this guide if you require replacement parts.

Ref	Dimensions	Visual	Qty	Ctn
1	93 x 37.4cm		1	.
2	93 x 37.4cm		1	.
3	115.3 x 78cm		1	.
4	113.8 x 6.5cm		2	.
5	74.8 x 4cm		1	.
6	117.4 x 39.2cm		1	.
7	74.8 x 6.5cm		1	.
8	35.8 x 4cm		1	.
9	35.8 x 6.5cm		1	.
10	86.4 x 36cm		1	.

Ref	Dimensions	Visual	Qty	Ctn
11	20 x 1.87cm		3	1
12	71 x 34.9cm		3	1
13	77.7 x 28.5cm		3	1
14	35 x 16cm		6	1
15	35 x 16cm		6	1
16	69.8 x 16cm		3	1
17	30.8 x 16cm		3	1
18	32 x 34.9cm		3	1
19	38.7 x 28.5cm		3	1
20	15 x 1.87cm		3	1

Fixtures and fittings supplied (actual size)

Ref	Dimensions	Quantity
A	8 x 36mm	38
B	15 x 12.5mm	14
C	15 x 10.5mm	24
D	3.5 x 15mm	37
E	4 x 30mm	36
F	8 x 30mm	48
G	6 x 11mm	24
H	3.5 x 25mm	4
L	Ø10 x 1.5mm	12
M	Ø5 x 15mm	2

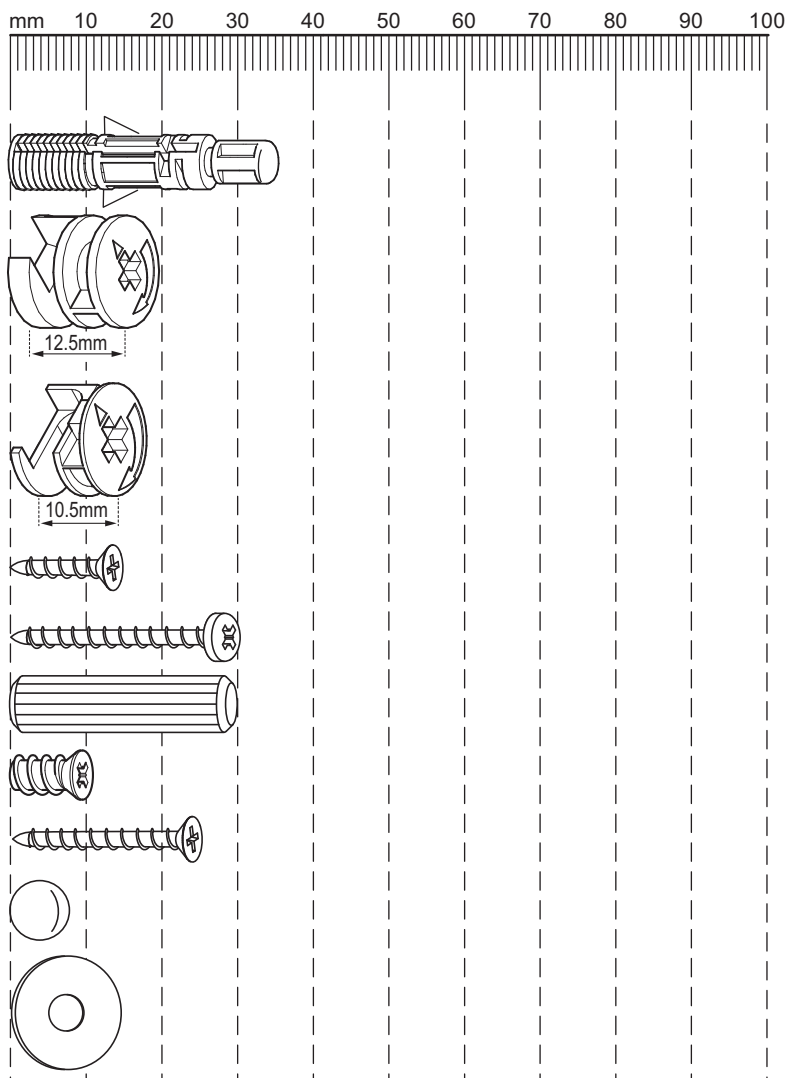

Fixtures and fittings supplied (not to scale)

Ref	Dimensions	Visual	Qty
N	N/A		6
O	N/A		12

Fixtures and fittings supplied (not to scale)

Ref	Dimensions	Visual	Qty
Q	N/A		1
R	N/A		6
S	N/A		6

1

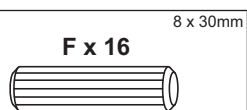
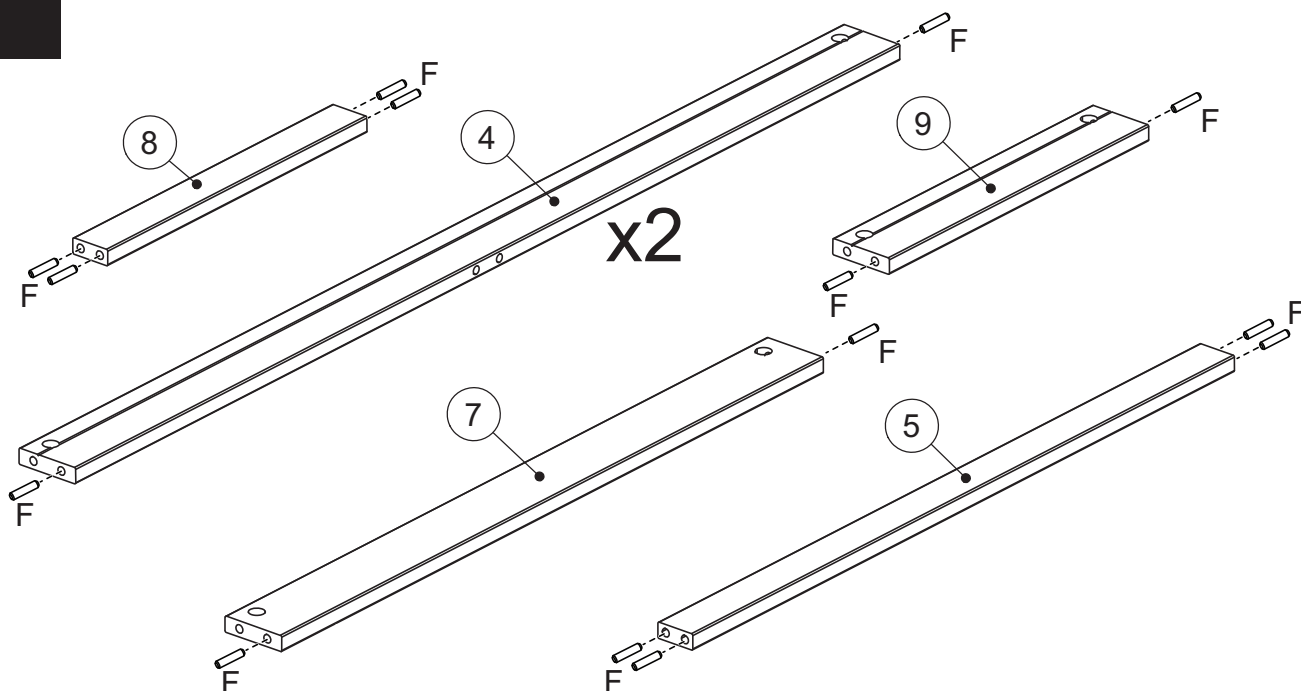

2

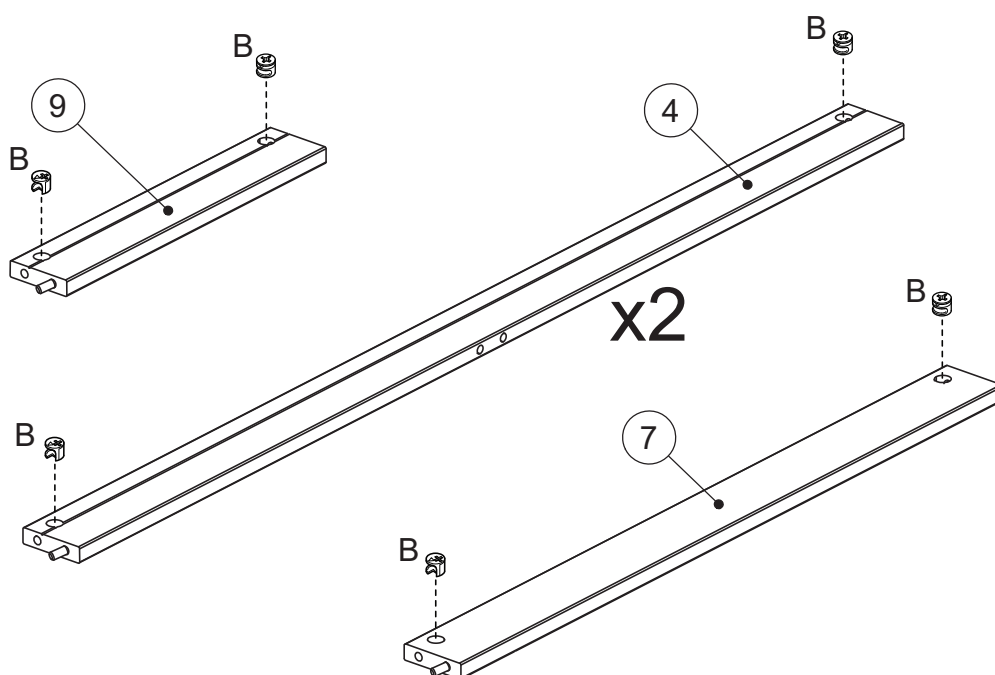

3

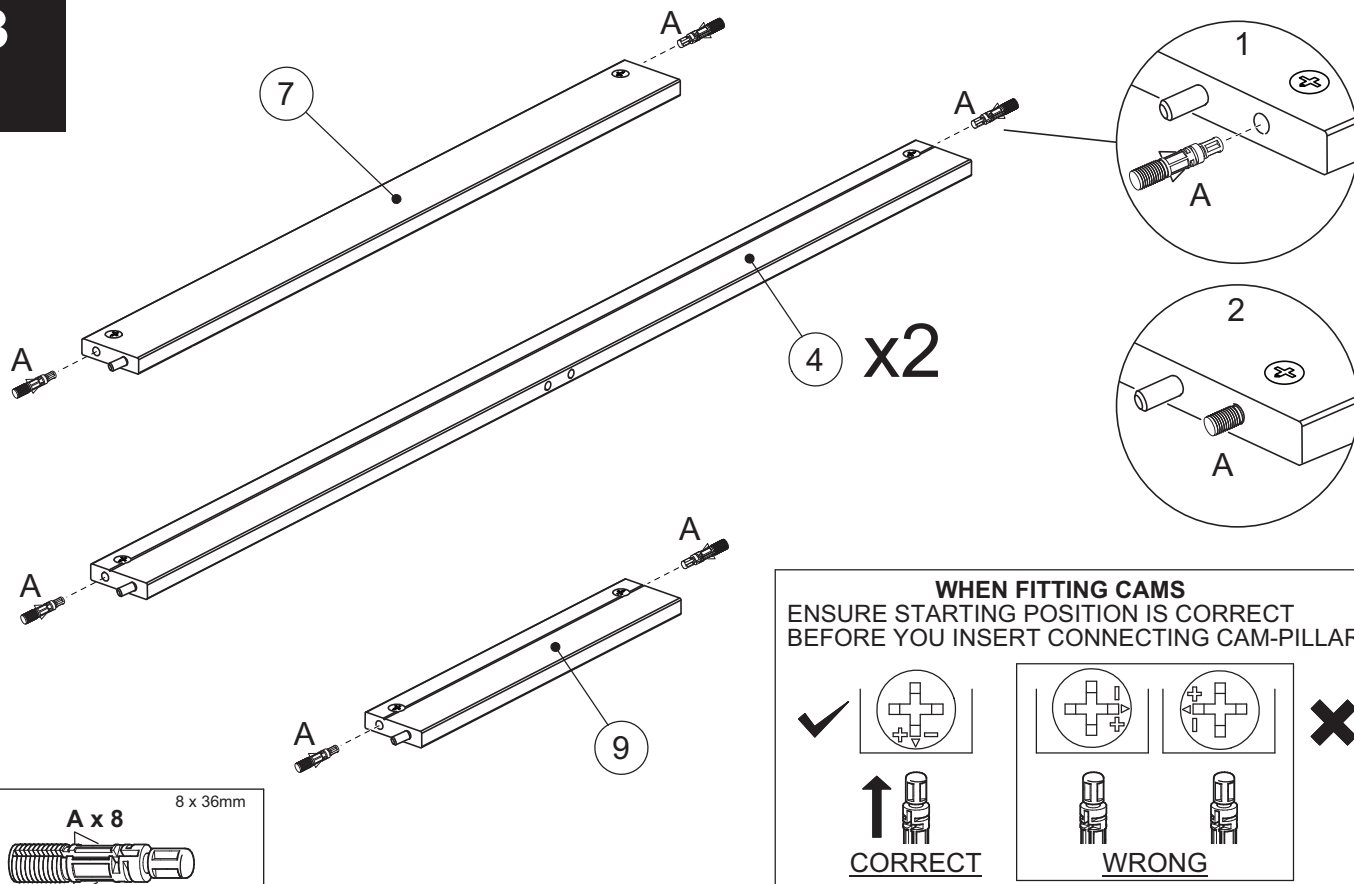

4

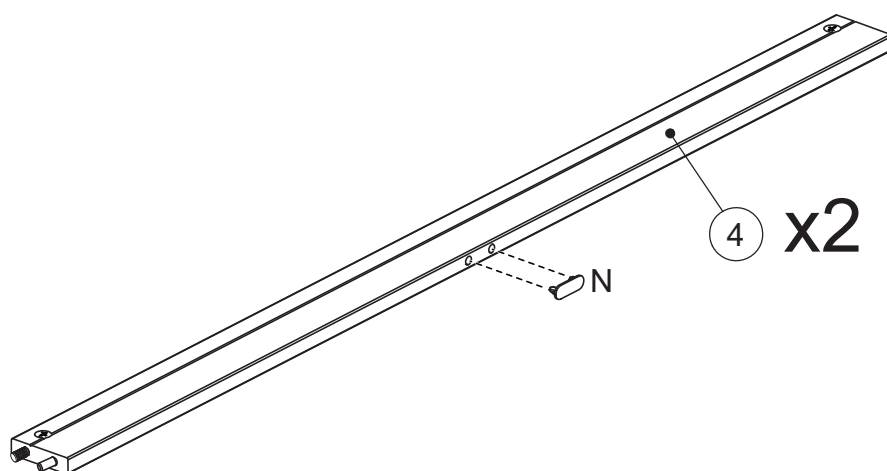

5

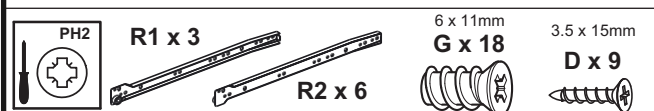
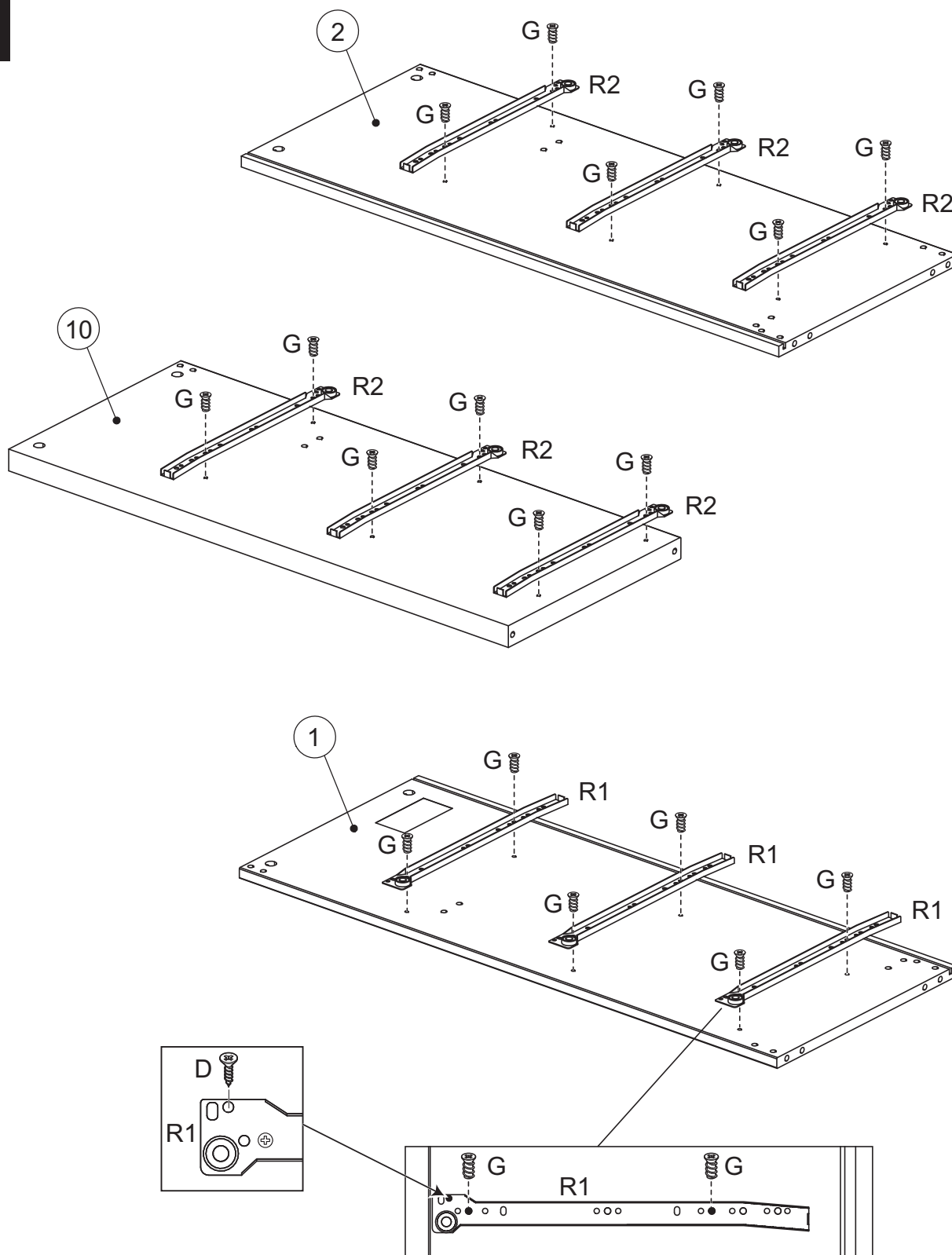

6

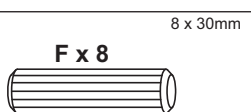
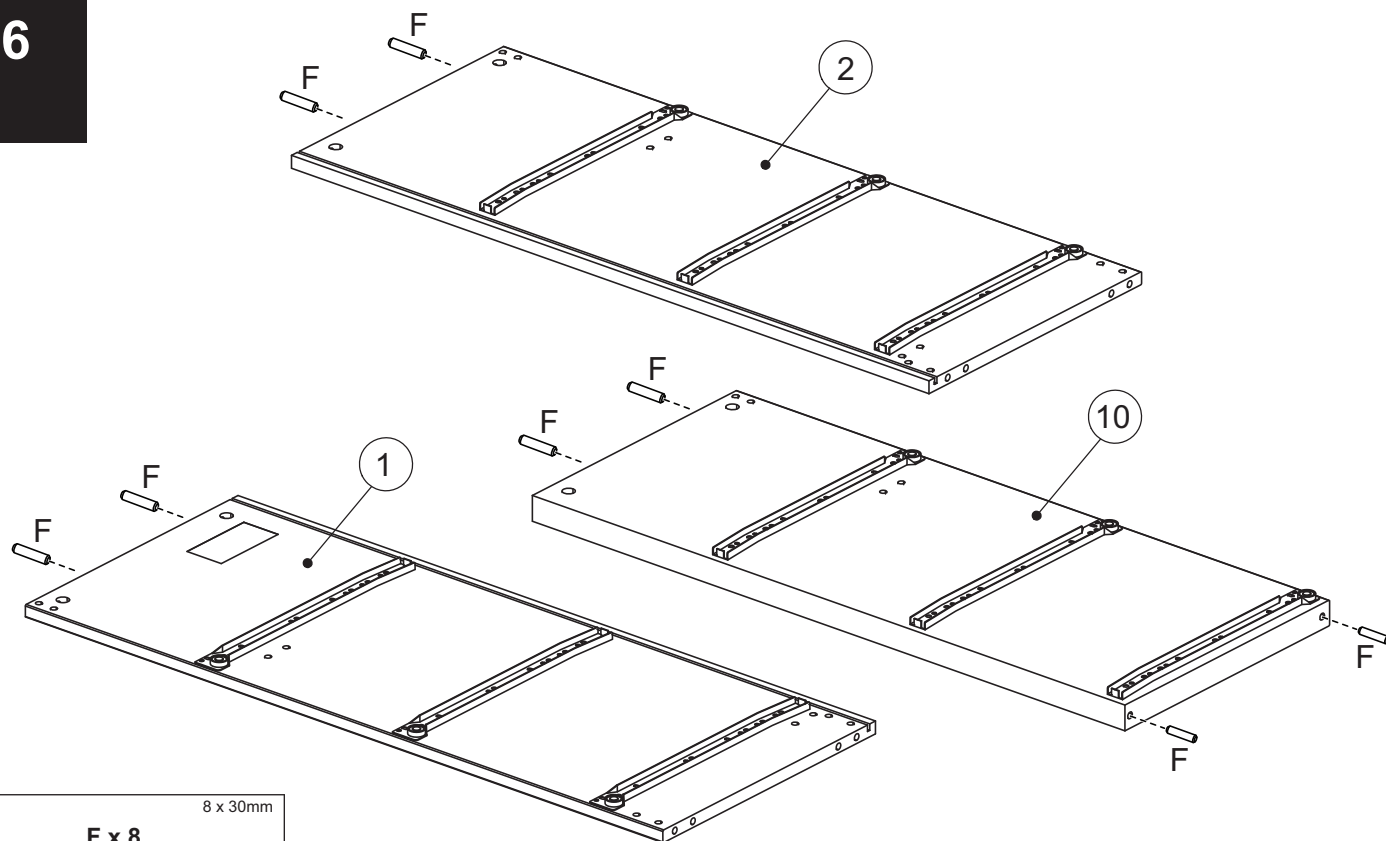

7

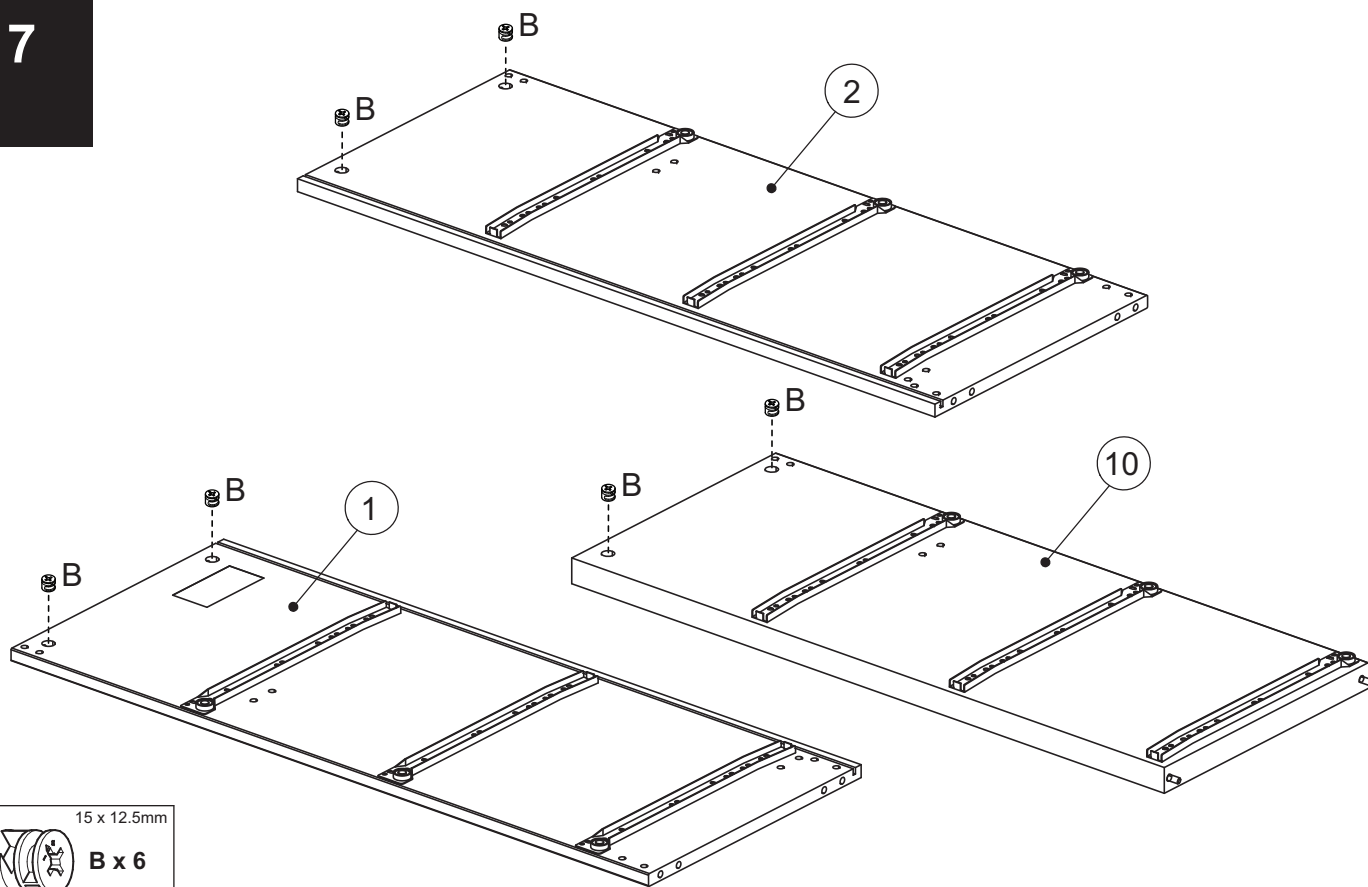

8

WHEN FITTING CAMS
ENSURE STARTING POSITION IS CORRECT
BEFORE YOU INSERT CONNECTING CAM-PILLAR

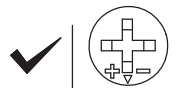

CORRECT

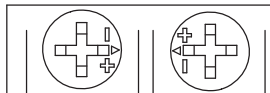

WRONG

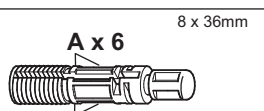
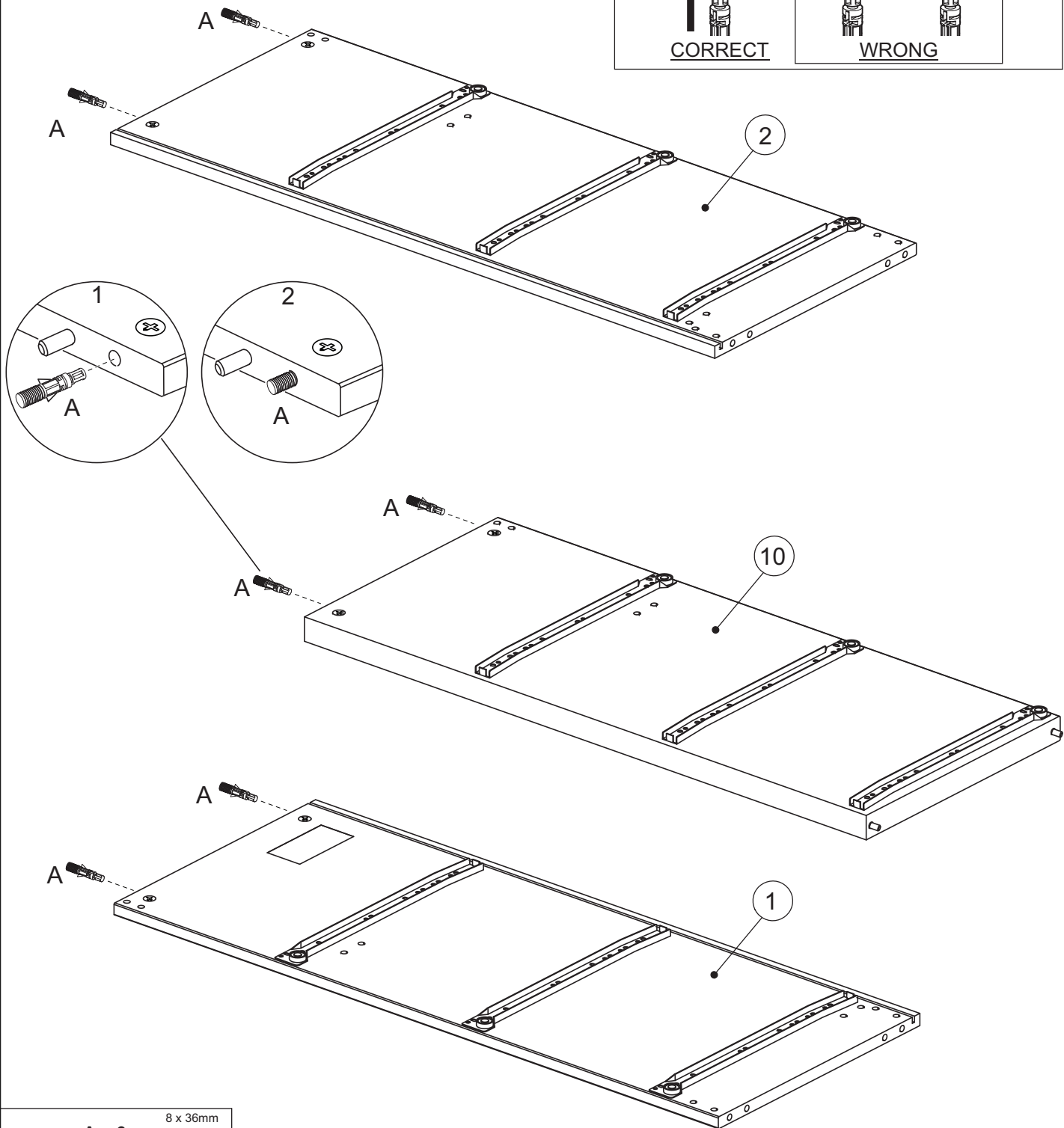

9

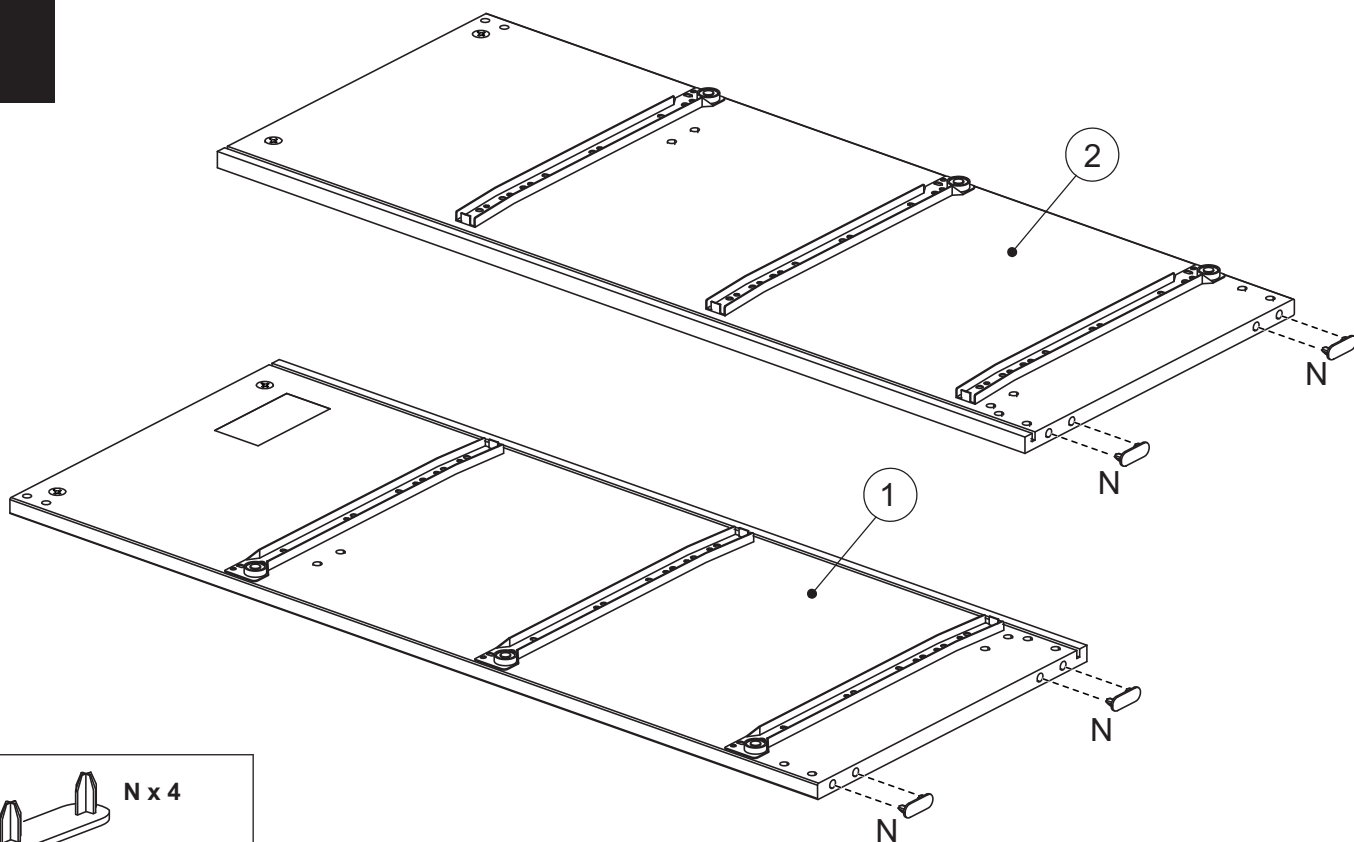

10

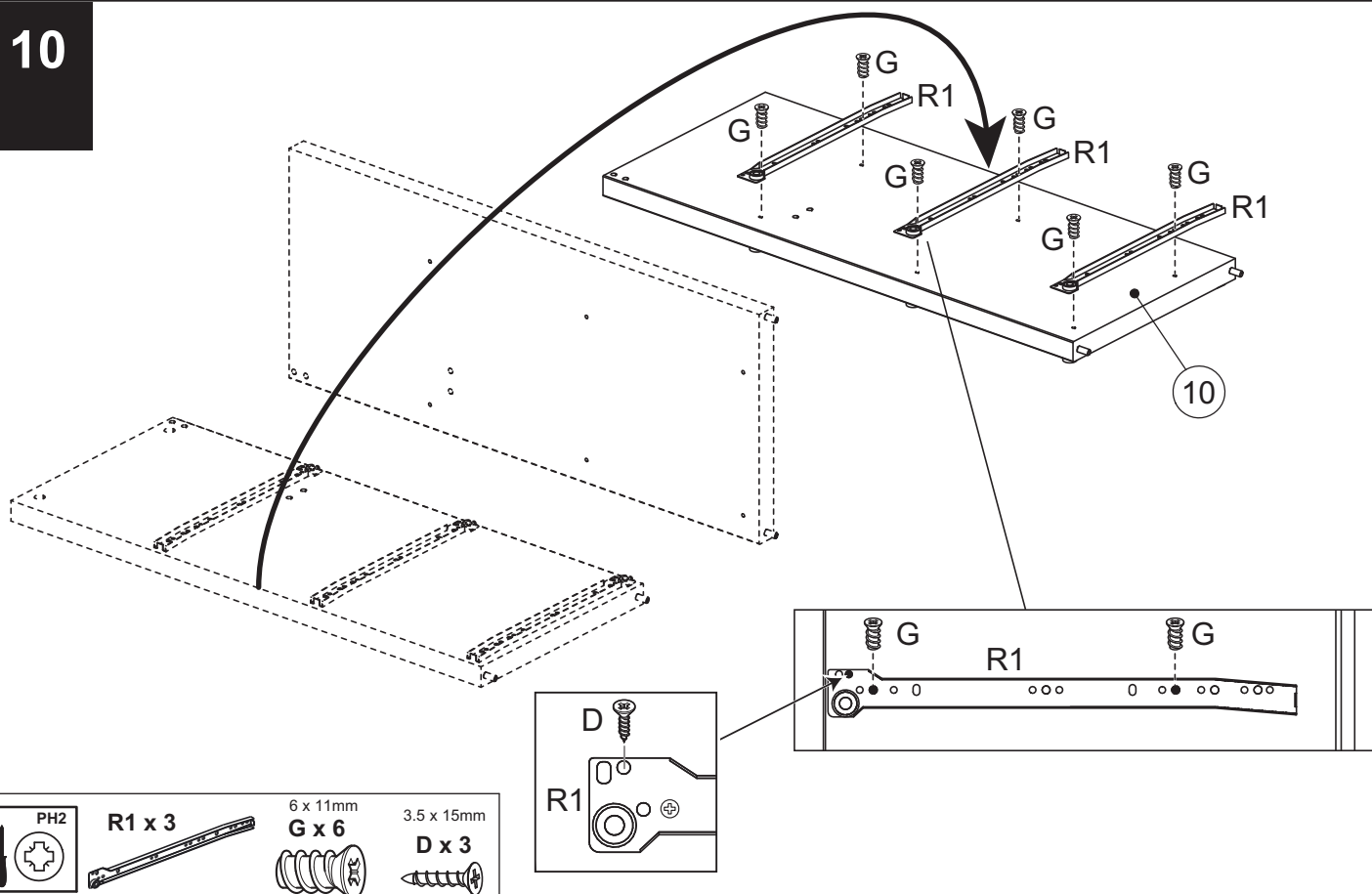

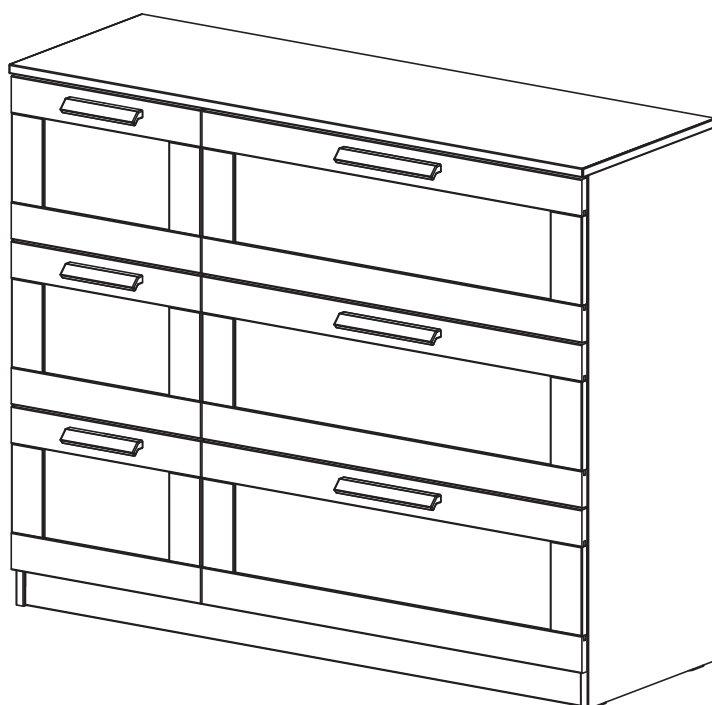
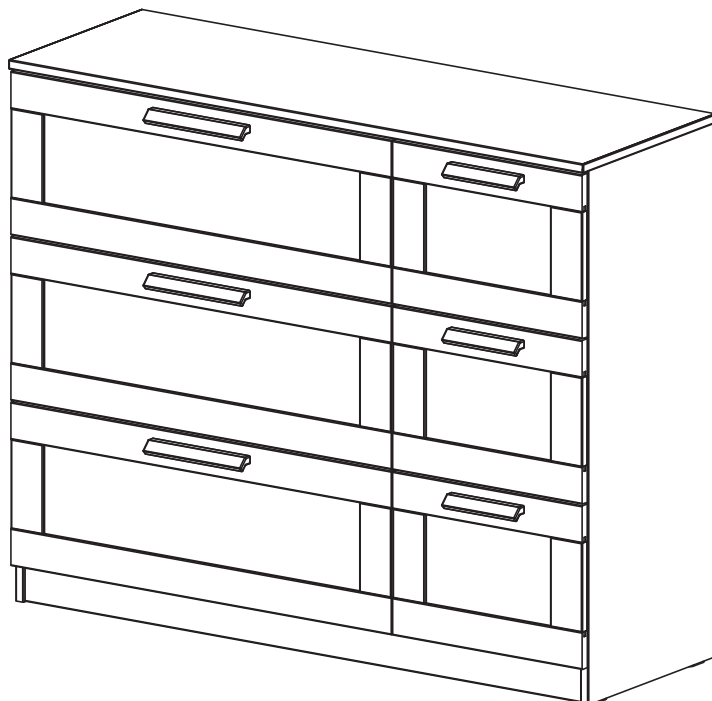

11

DON'T STOP UNTIL THE 2 O'CLOCK LOCK
TURN THE CAM IN A CLOCKWISE DIRECTION UNTIL THE
ARROW POINTS IN THE POSITIONS SHOWN IN THE
DIAGRAMS BELOW



START

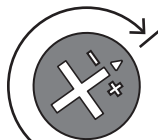

CORRECT
LOCK

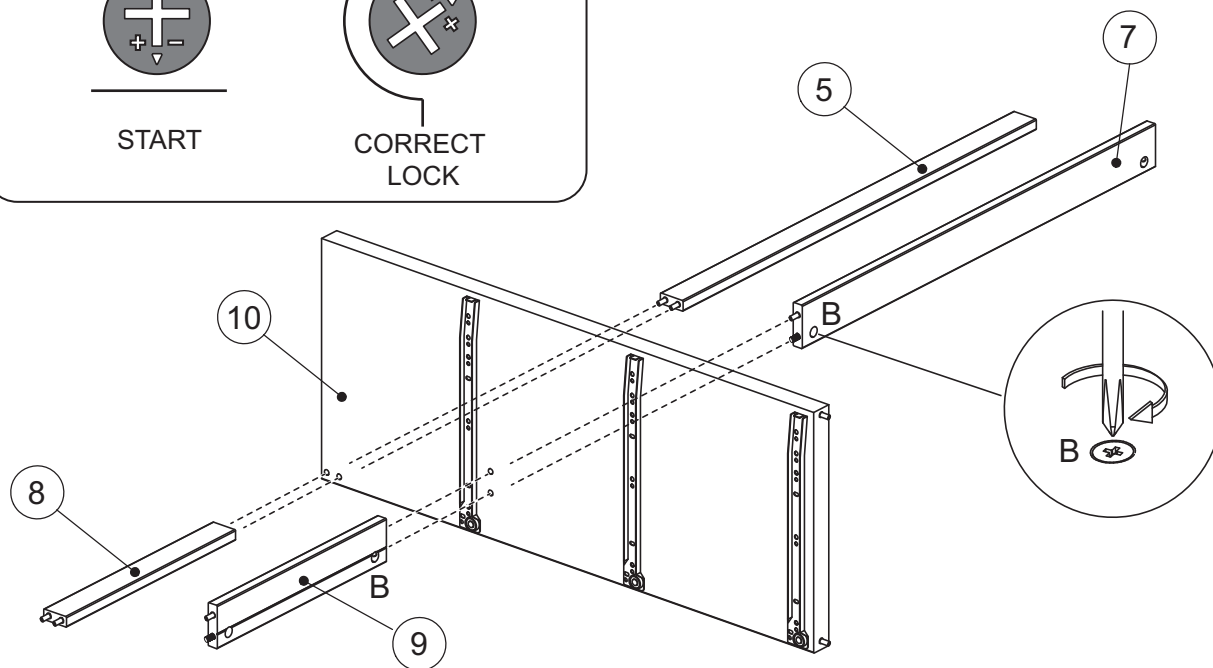

12

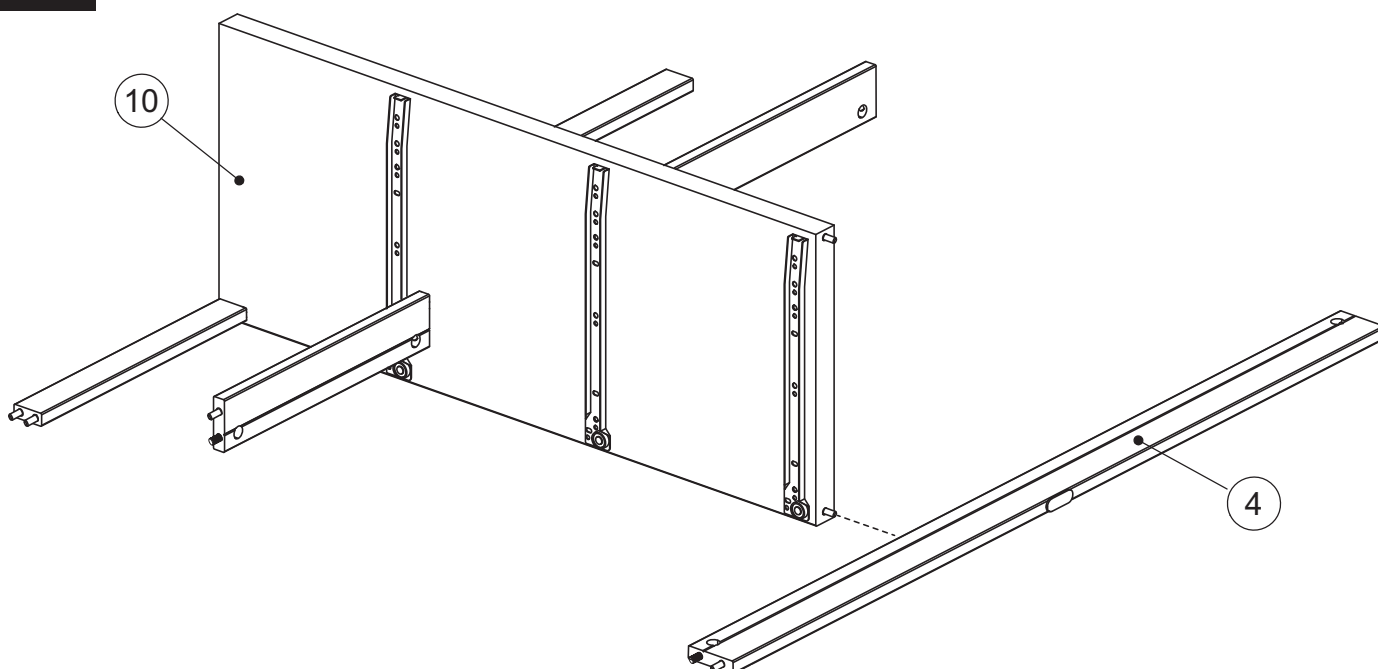

15

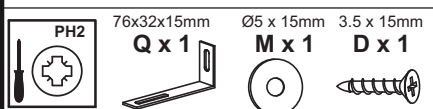
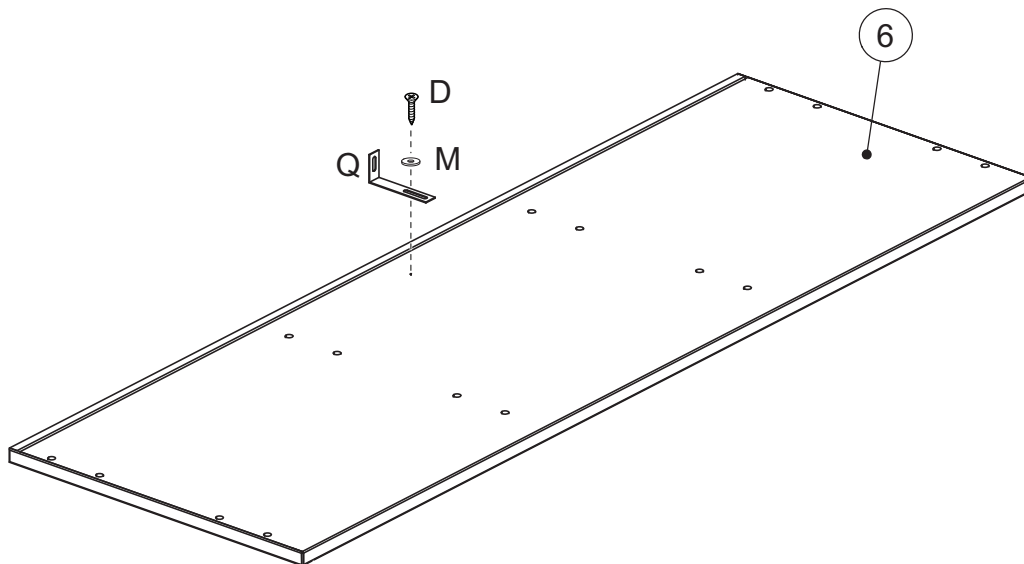

16

DON'T STOP UNTIL THE 2 O'CLOCK LOCK

TURN THE CAM IN A CLOCKWISE DIRECTION UNTIL THE ARROW POINTS IN THE POSITIONS SHOWN IN THE DIAGRAMS BELOW



START

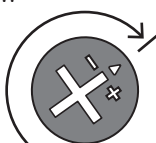

CORRECT LOCK

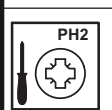
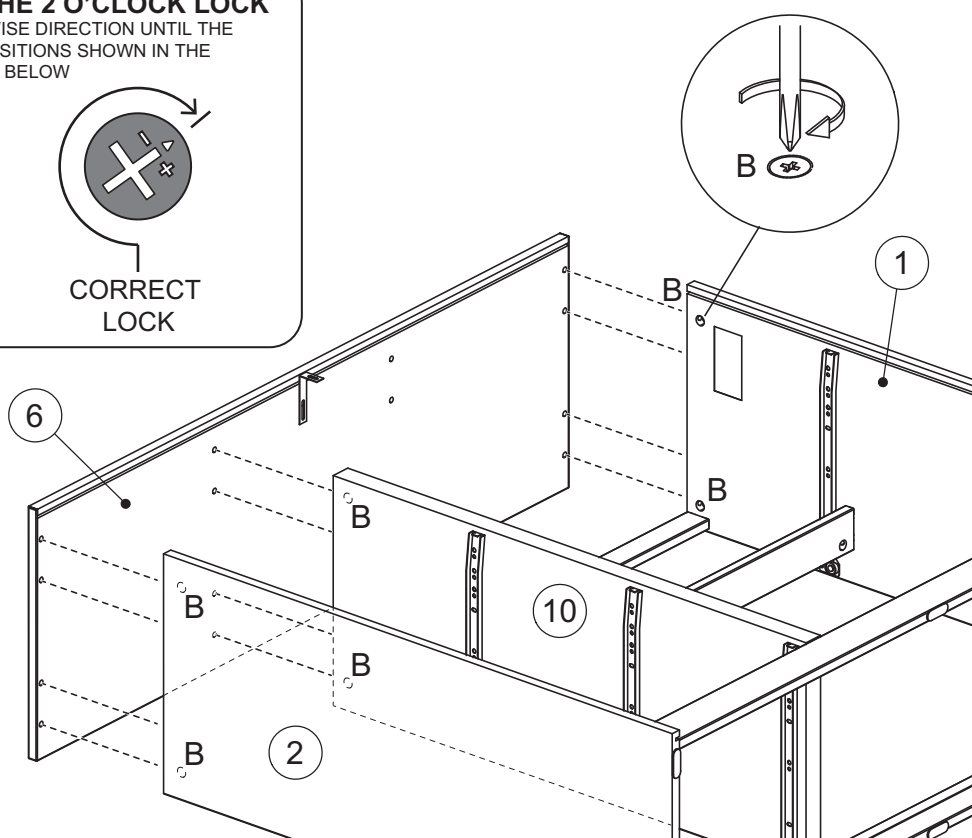

17

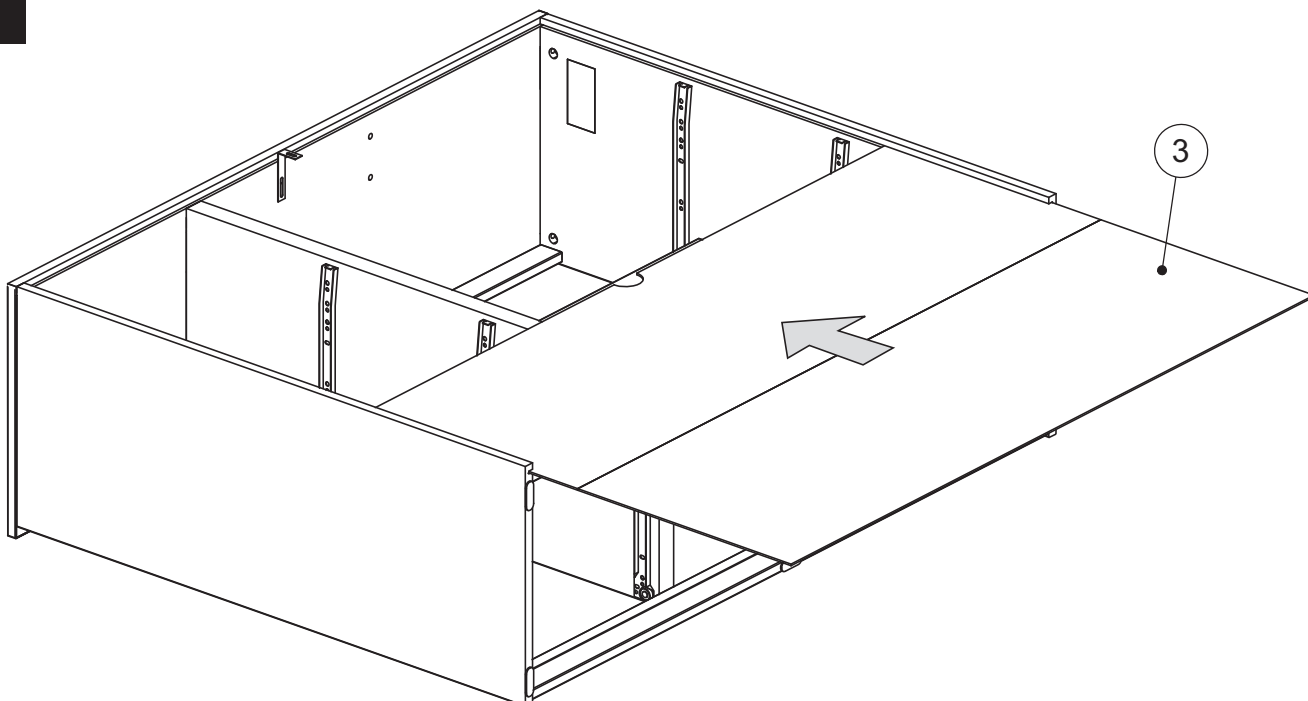

18

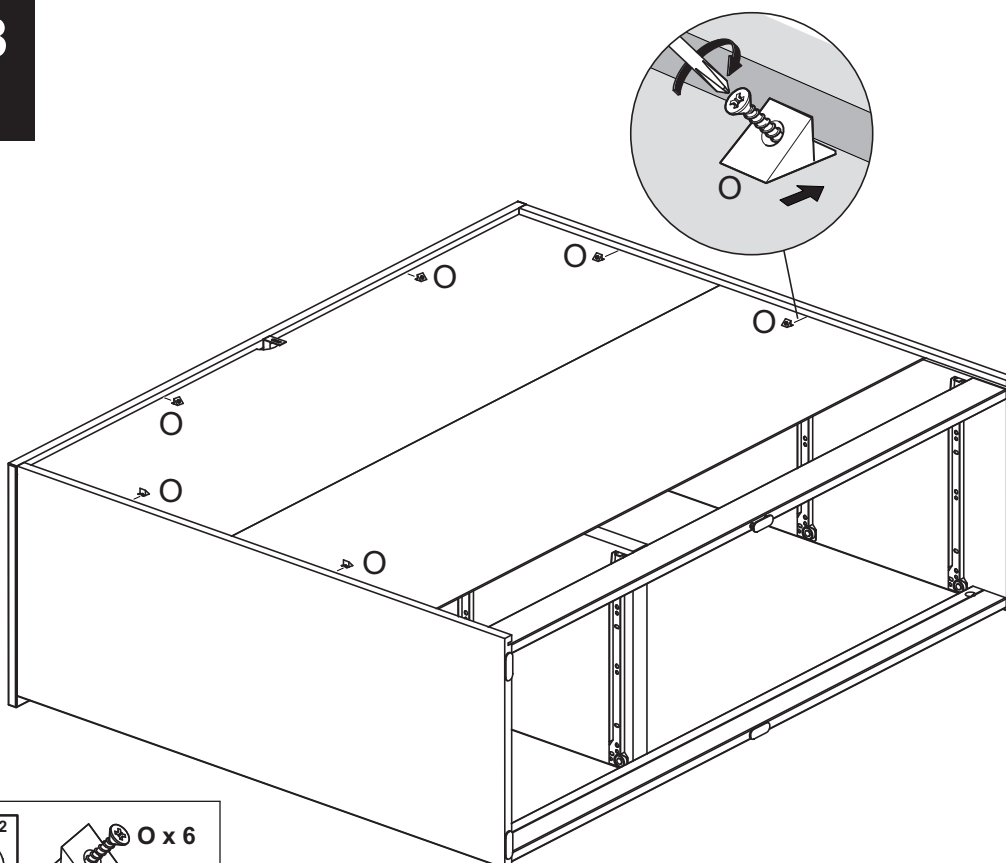

Important:
The cabinet **MUST**
be 'square' when the
back is attached.

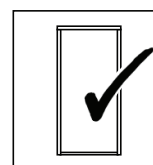
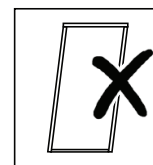

19

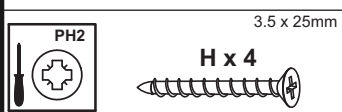
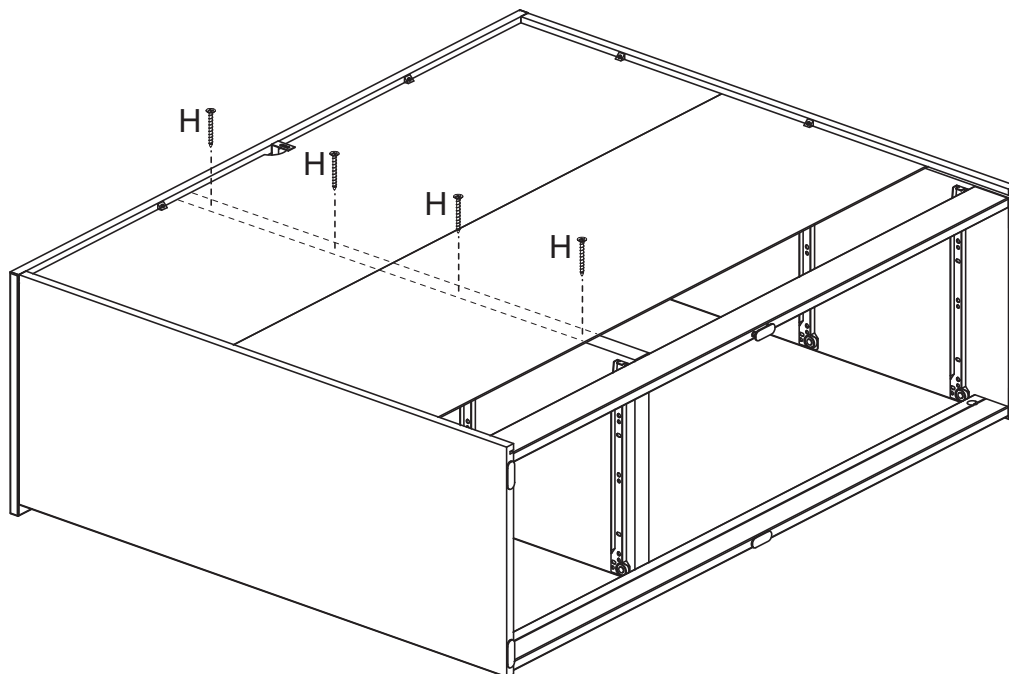

20

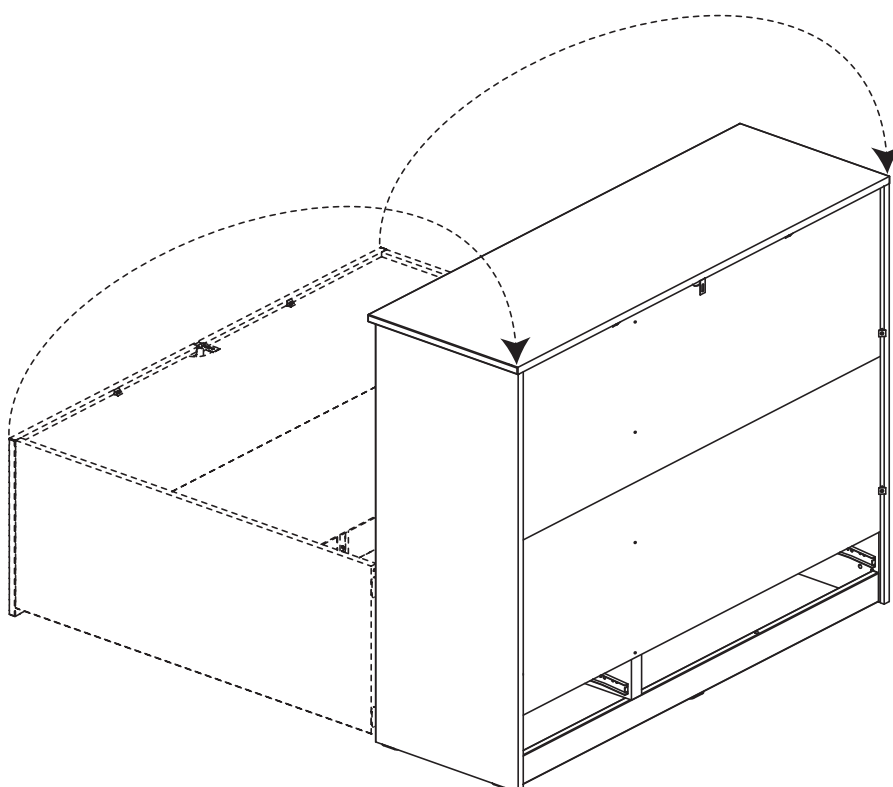

21

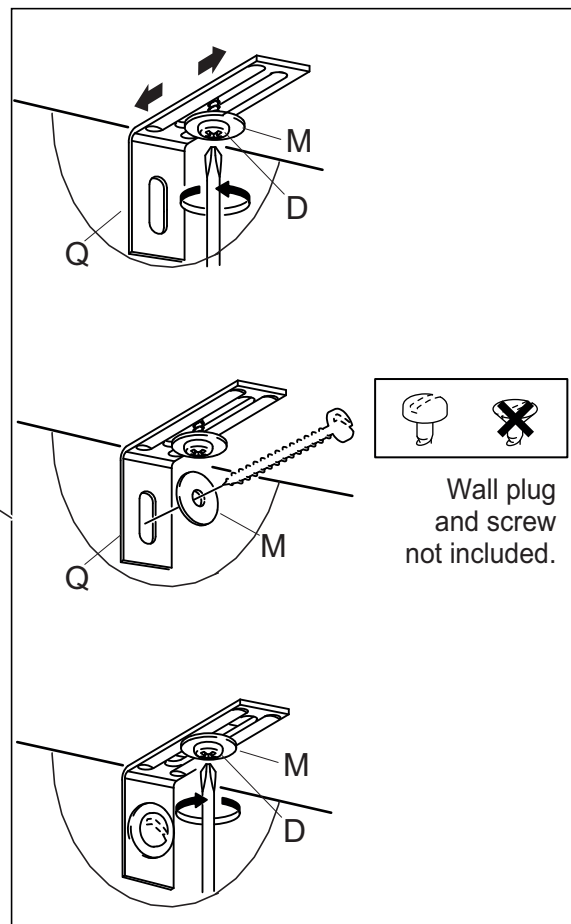
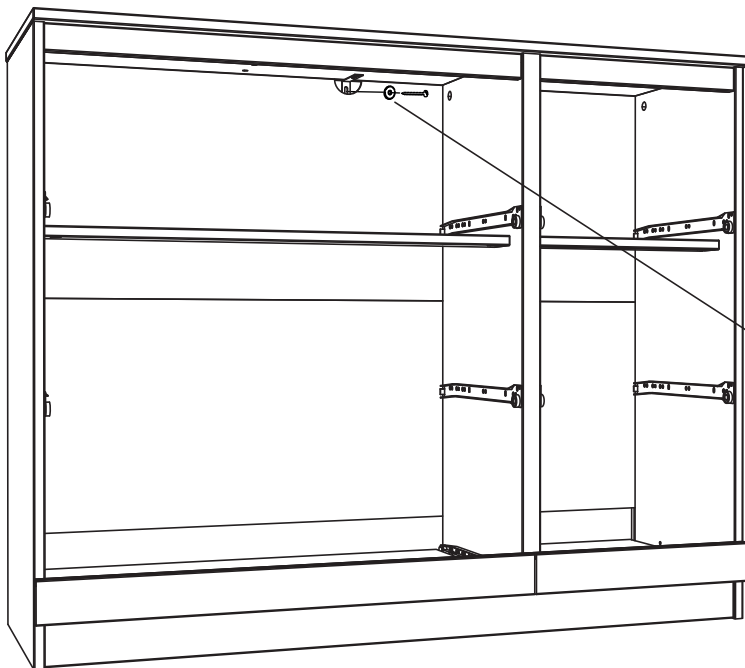

Wall fixing - if in doubt seek professional advice

Wood

If fixing to wood make sure that it isn't chipboard as screws can easily pull away from the core structure

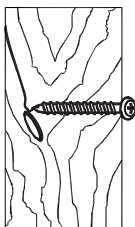

Brick or Masonry

Use an appropriate wall plug provided you are sure your wall is sound.

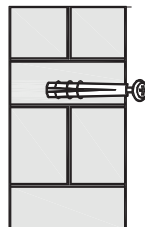

Cavity wall

Special toggle wall plugs are needed. Seek expert advice.

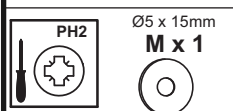
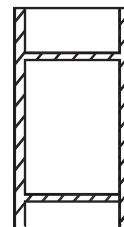

STEP 33



22

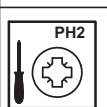
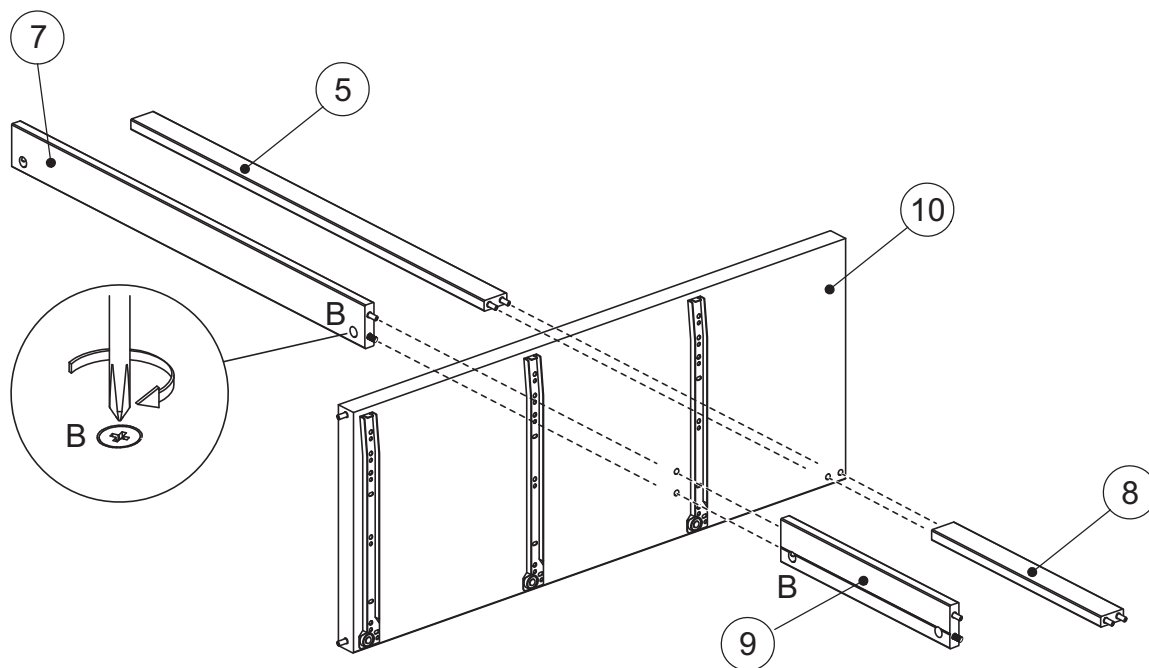

23

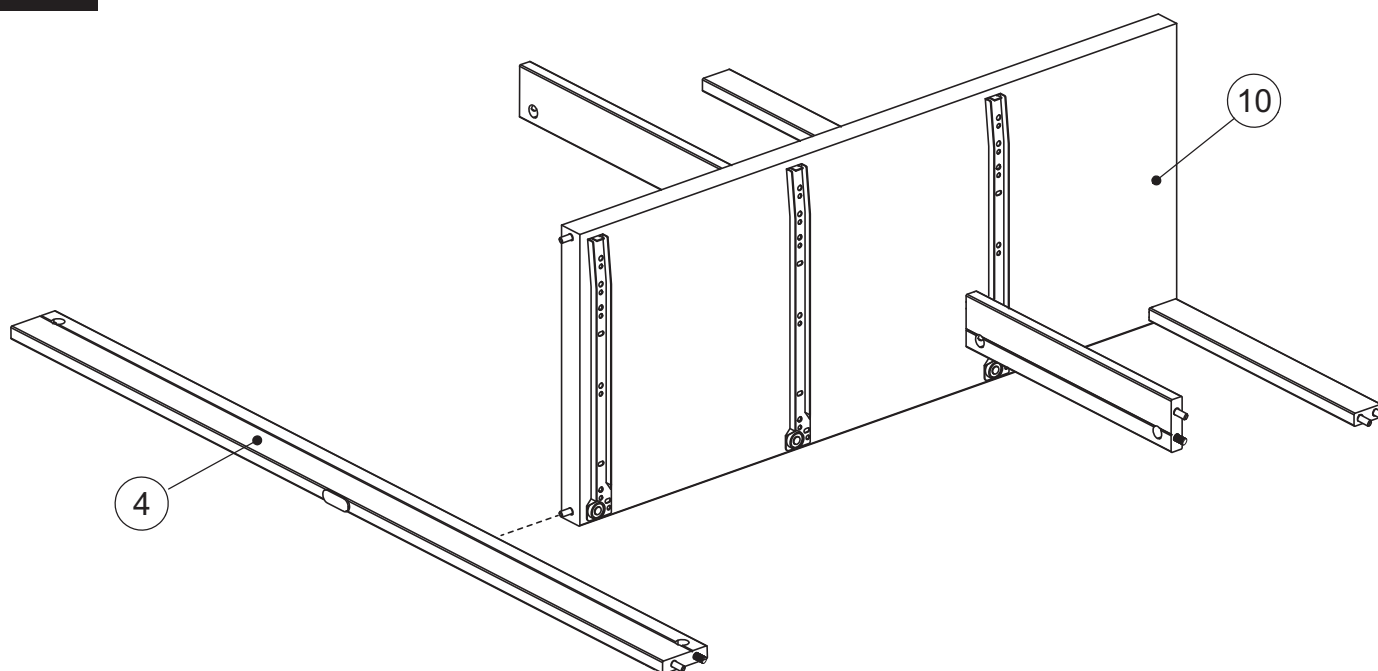

24

DON'T STOP UNTIL THE 2 O'CLOCK LOCK
TURN THE CAM IN A CLOCKWISE DIRECTION UNTIL THE
ARROW POINTS IN THE POSITIONS SHOWN IN THE
DIAGRAMS BELOW

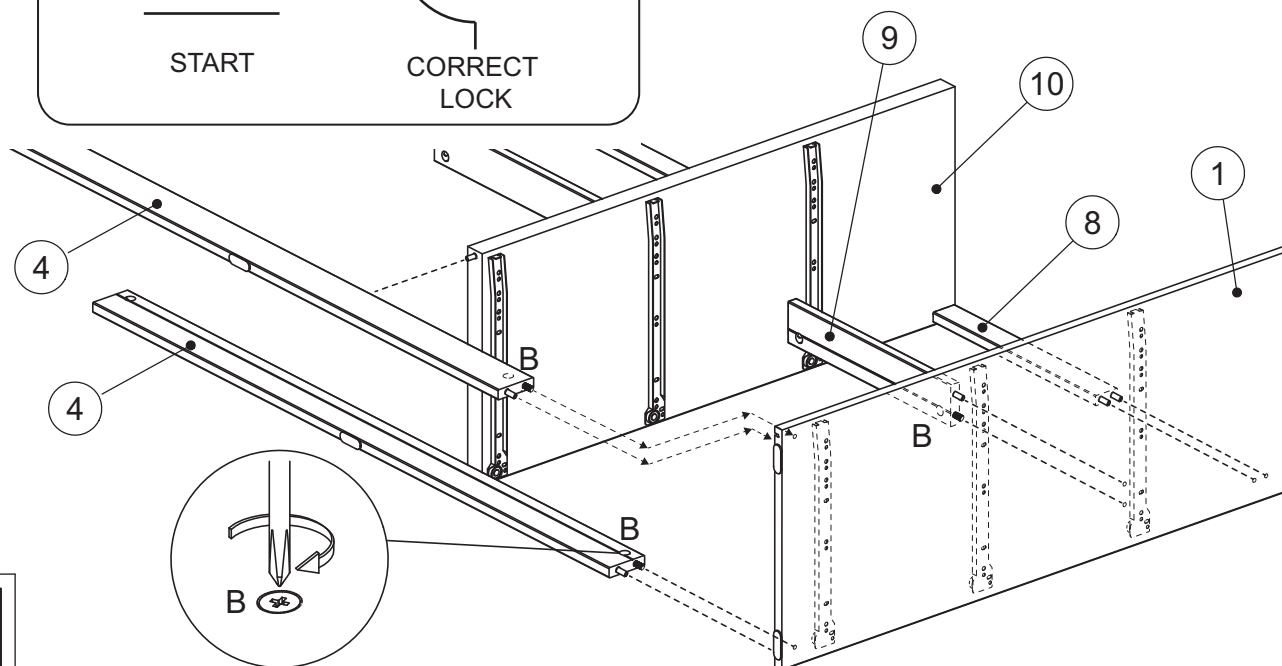
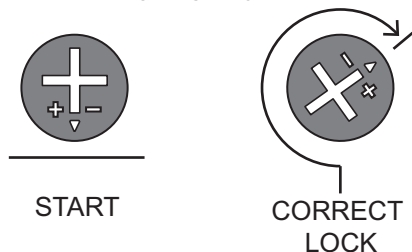

25

DON'T STOP UNTIL THE 2 O'CLOCK LOCK
TURN THE CAM IN A CLOCKWISE DIRECTION UNTIL THE
ARROW POINTS IN THE POSITIONS SHOWN IN THE
DIAGRAMS BELOW

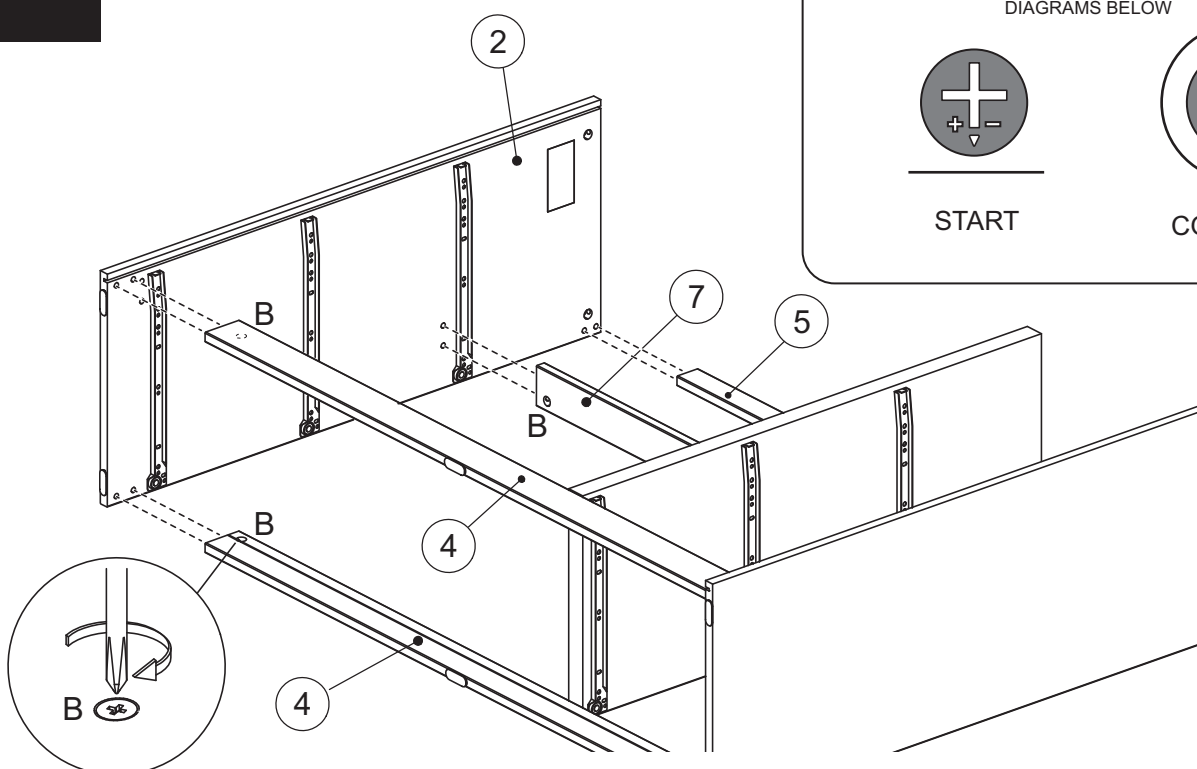
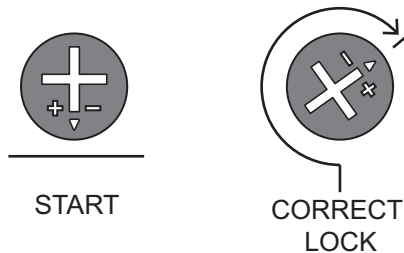

26

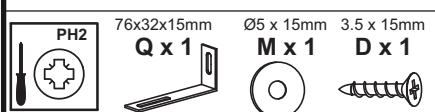
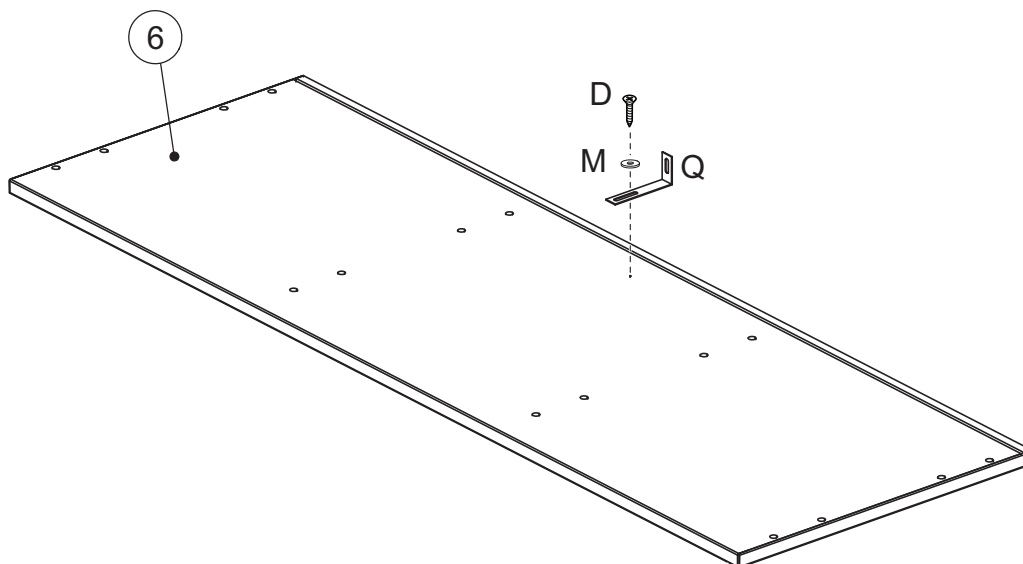

27

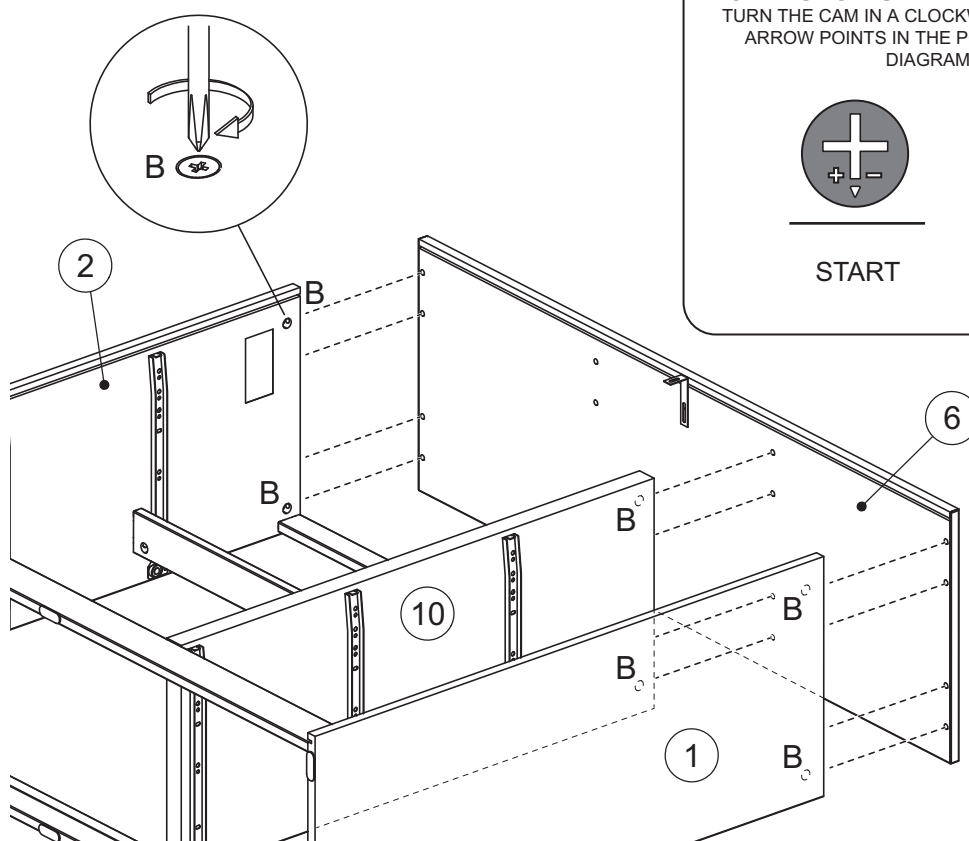

DON'T STOP UNTIL THE 2 O'CLOCK LOCK

TURN THE CAM IN A CLOCKWISE DIRECTION UNTIL THE
ARROW POINTS IN THE POSITIONS SHOWN IN THE
DIAGRAMS BELOW



START

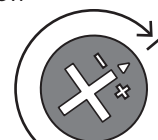

CORRECT
LOCK

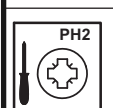

28

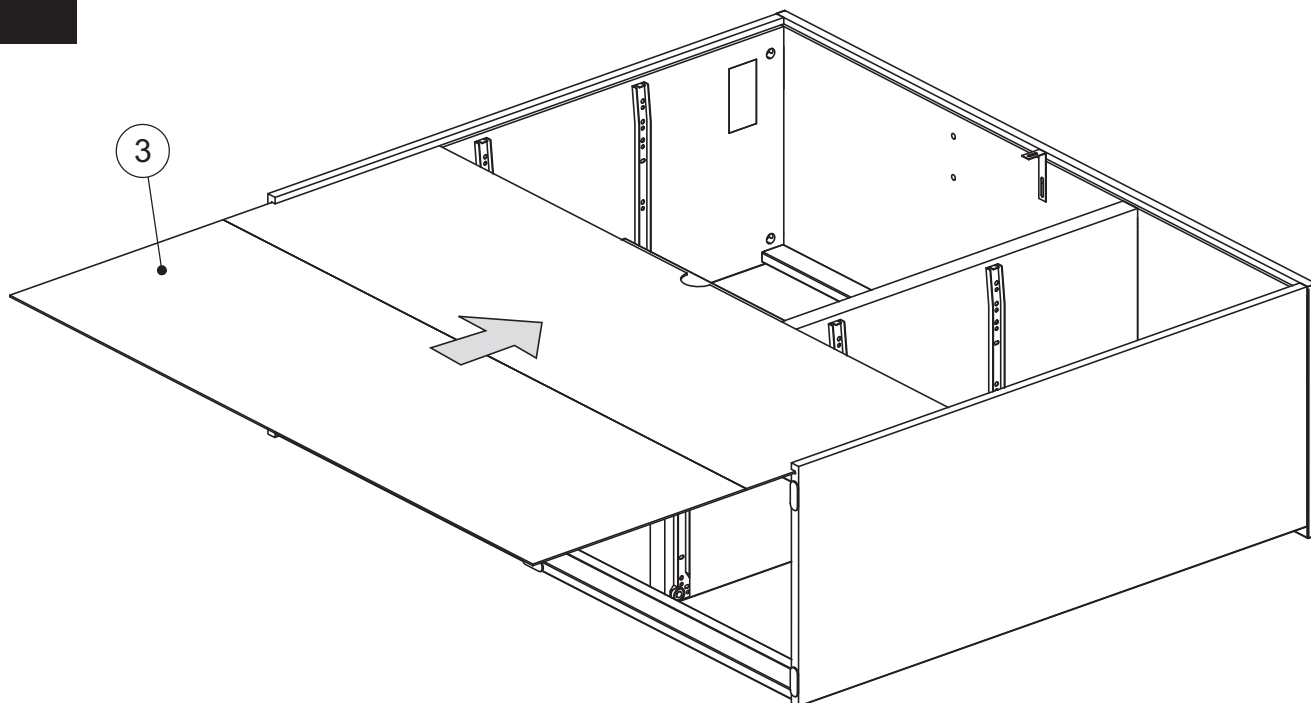

29

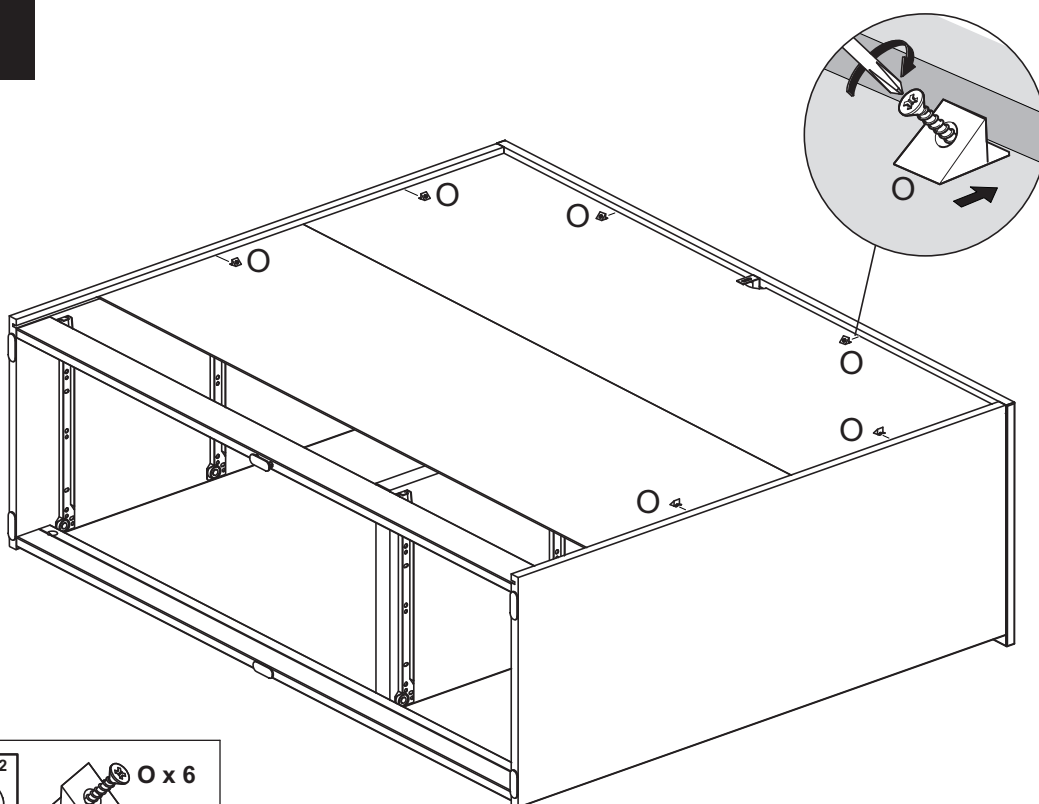

Important:
The cabinet MUST
be 'square' when the
back is attached.

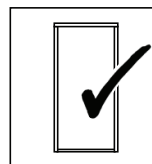
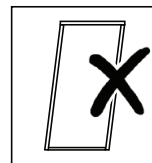

30

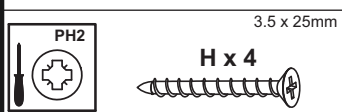
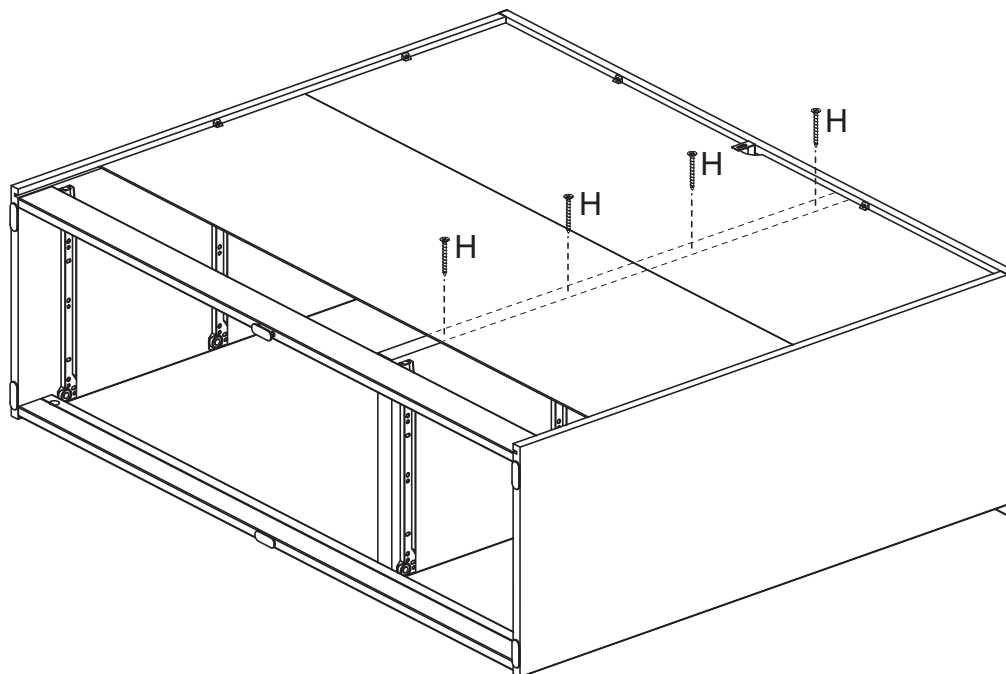

31

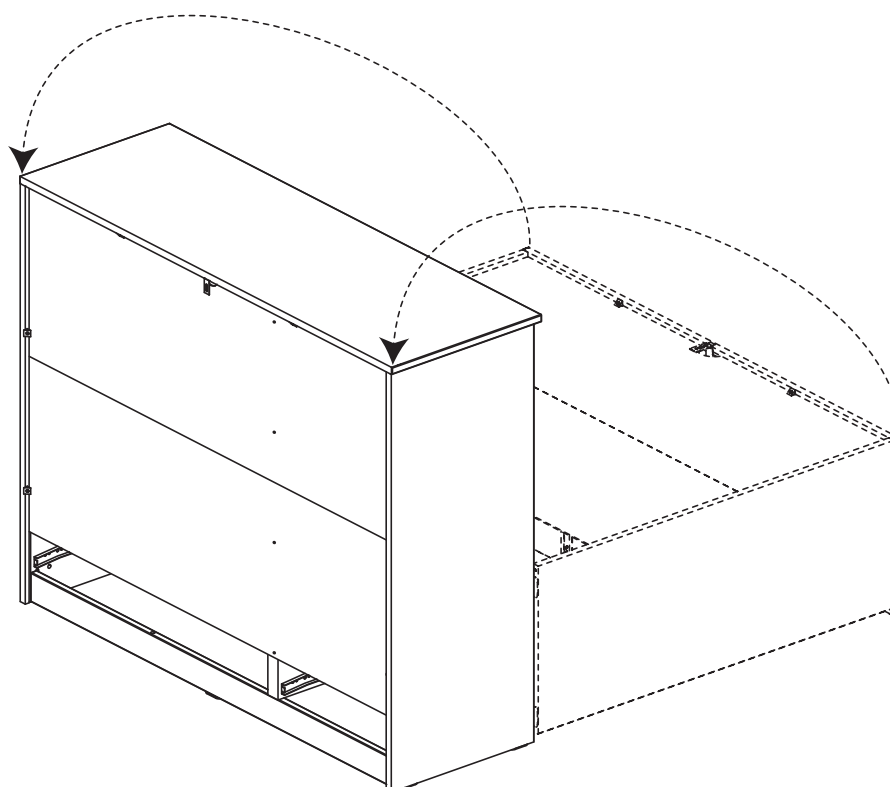

32

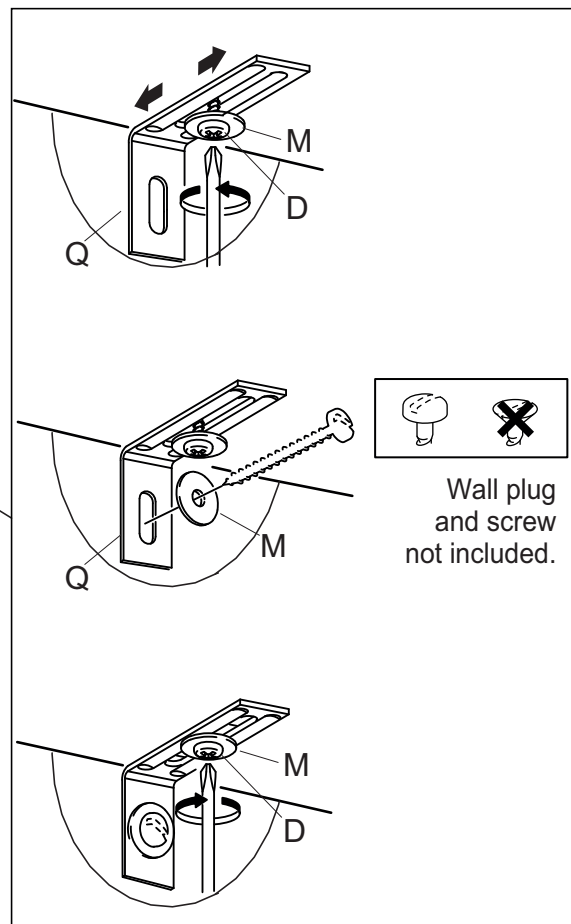
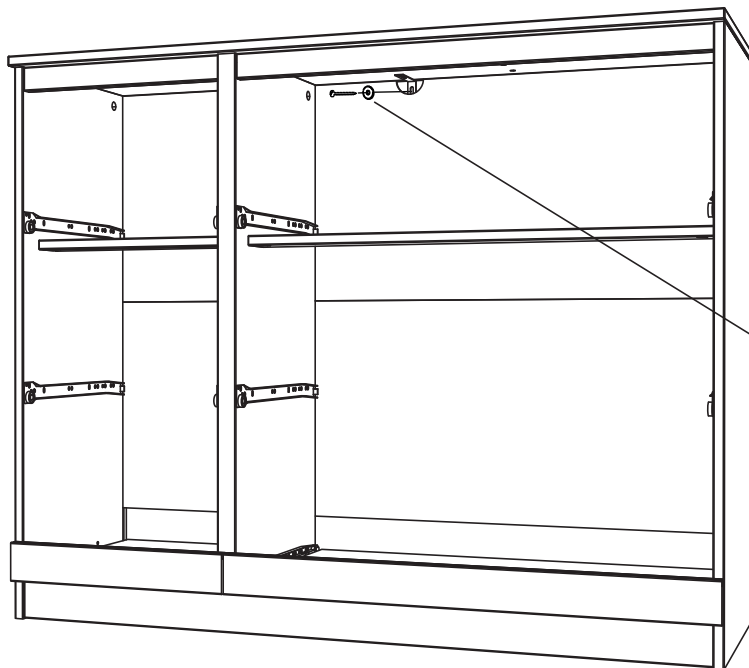

Wall fixing - if in doubt seek professional advice

Wood

If fixing to wood make sure that it isn't chipboard as screws can easily pull away from the core structure

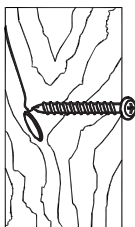

Brick or Masonry

Use an appropriate wall plug provided you are sure your wall is sound.

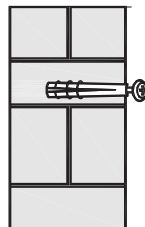

Cavity wall

Special toggle wall plugs are needed. Seek expert advice.

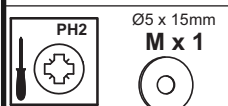
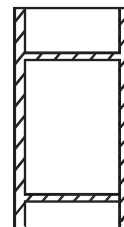

33

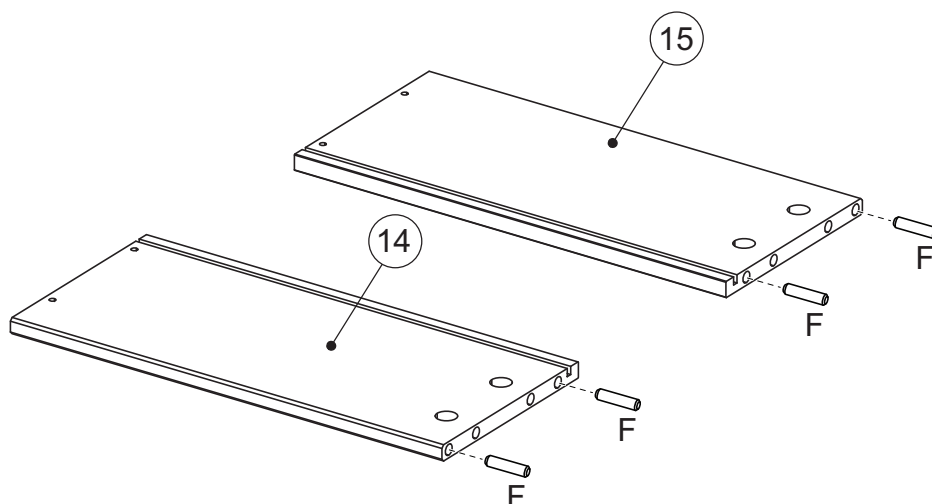

x6

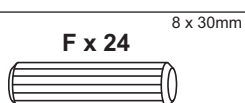

34

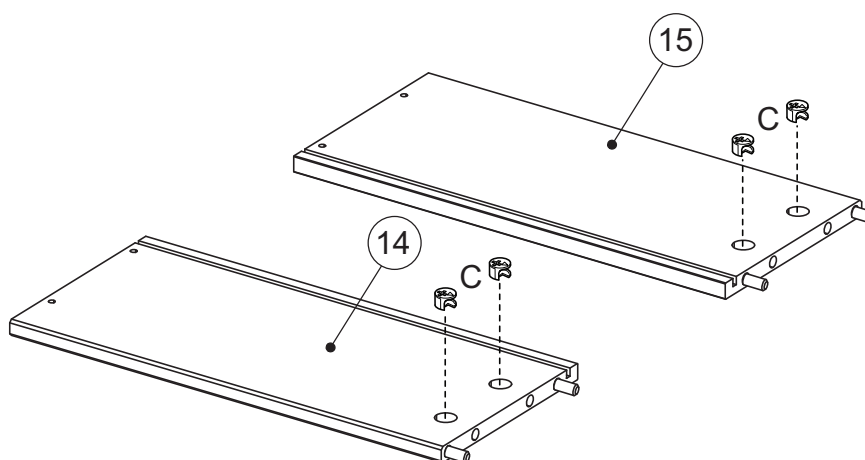

x6

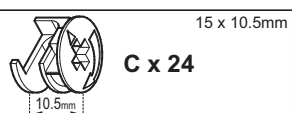

35

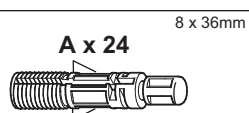
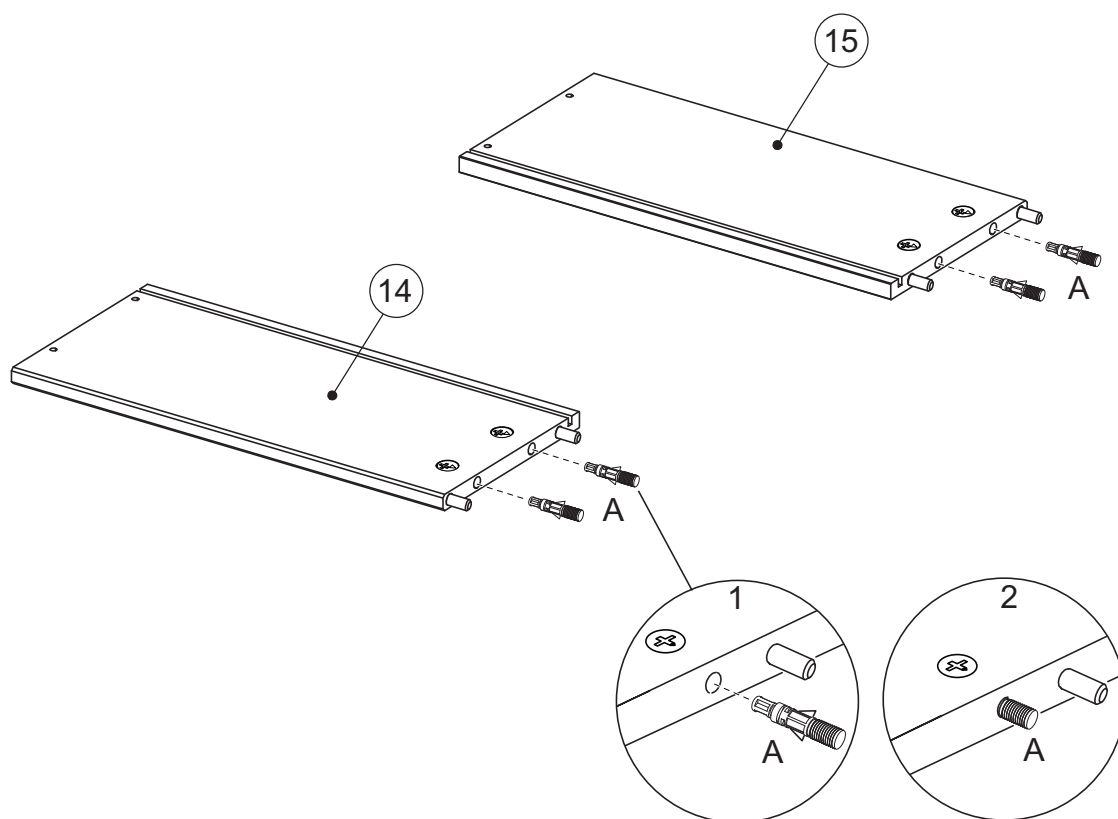
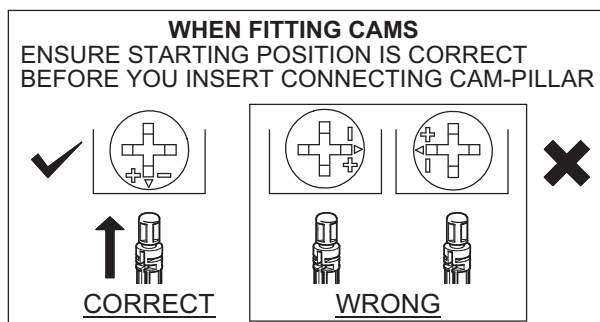

x6

36

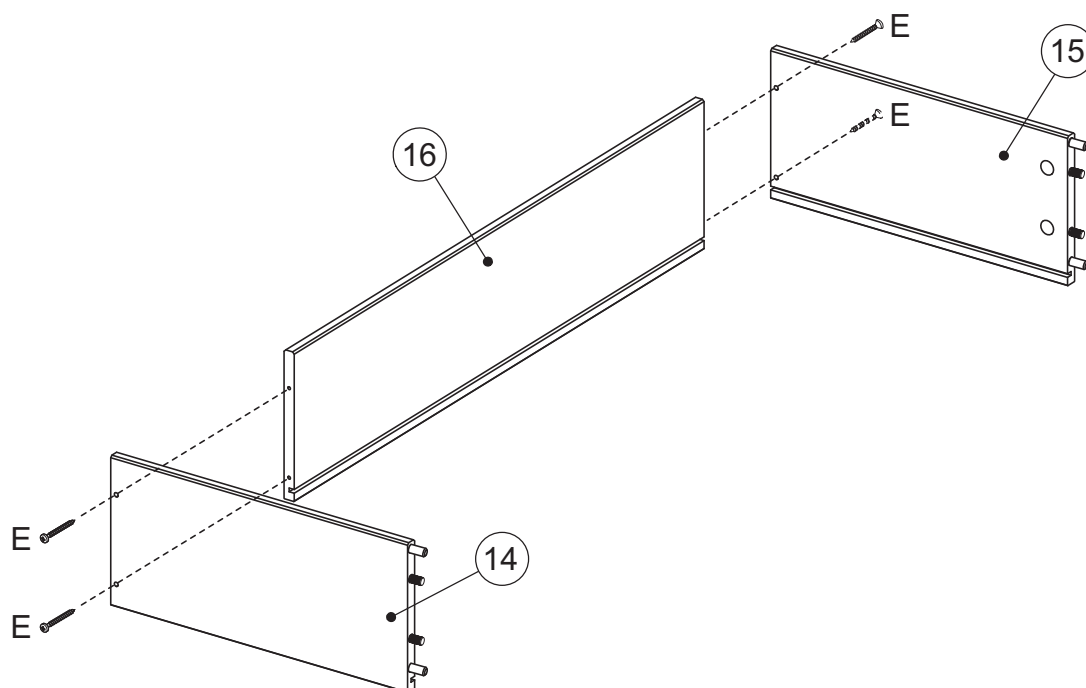

x3

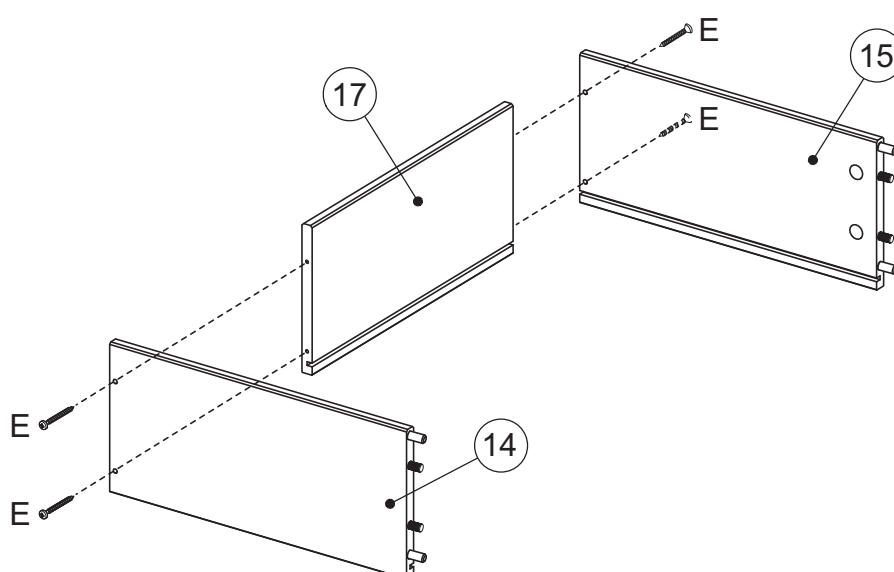

x3

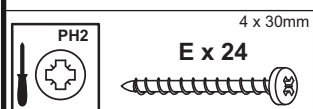

37

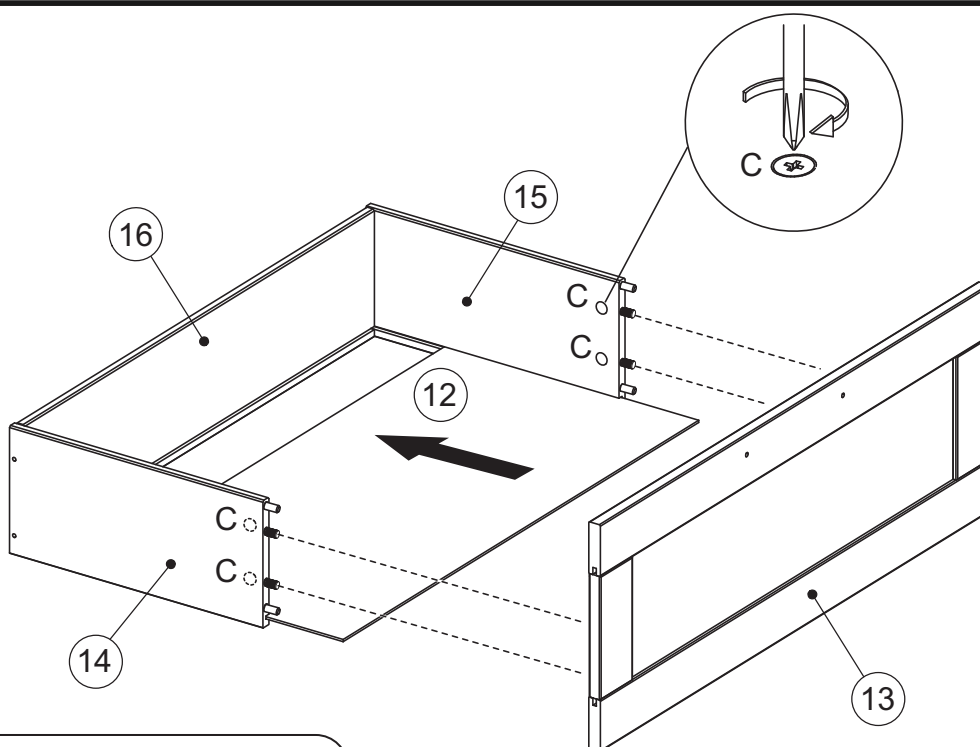

x3

DON'T STOP UNTIL THE 2 O'CLOCK LOCK

TURN THE CAM IN A CLOCKWISE DIRECTION UNTIL THE
ARROW POINTS IN THE POSITIONS SHOWN IN THE
DIAGRAMS BELOW



START

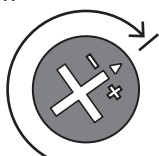

CORRECT
LOCK

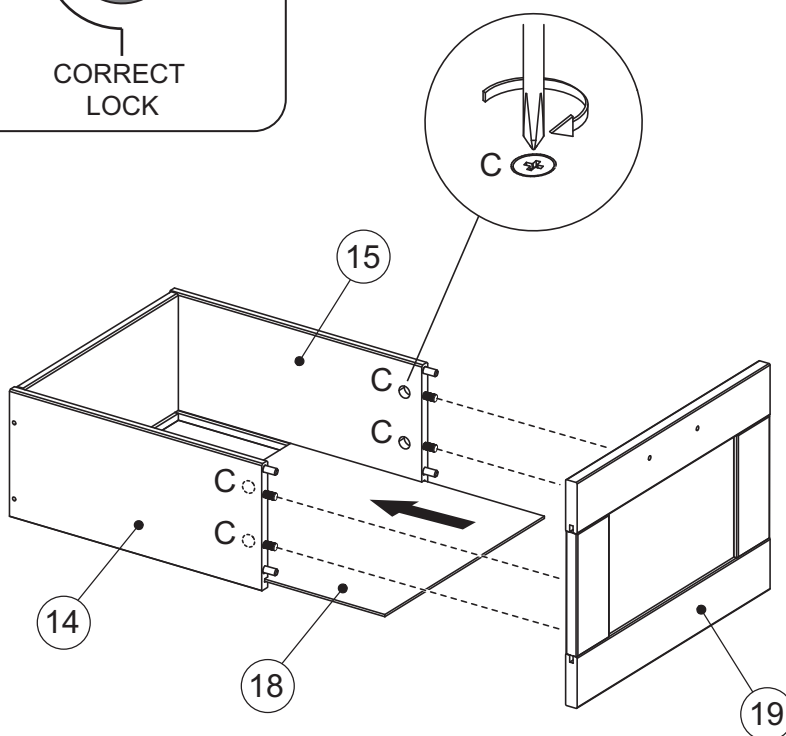

x3

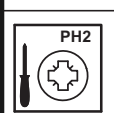

38

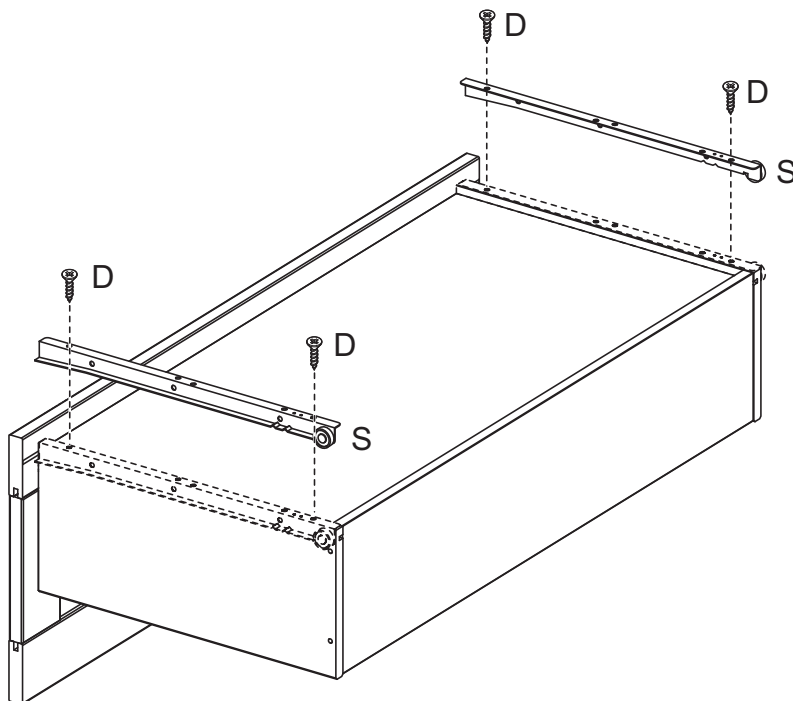

x3

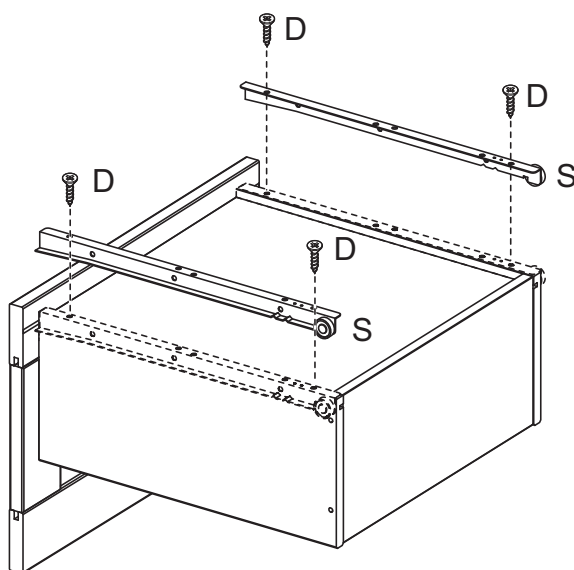

x3

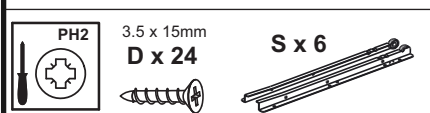

39

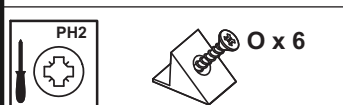
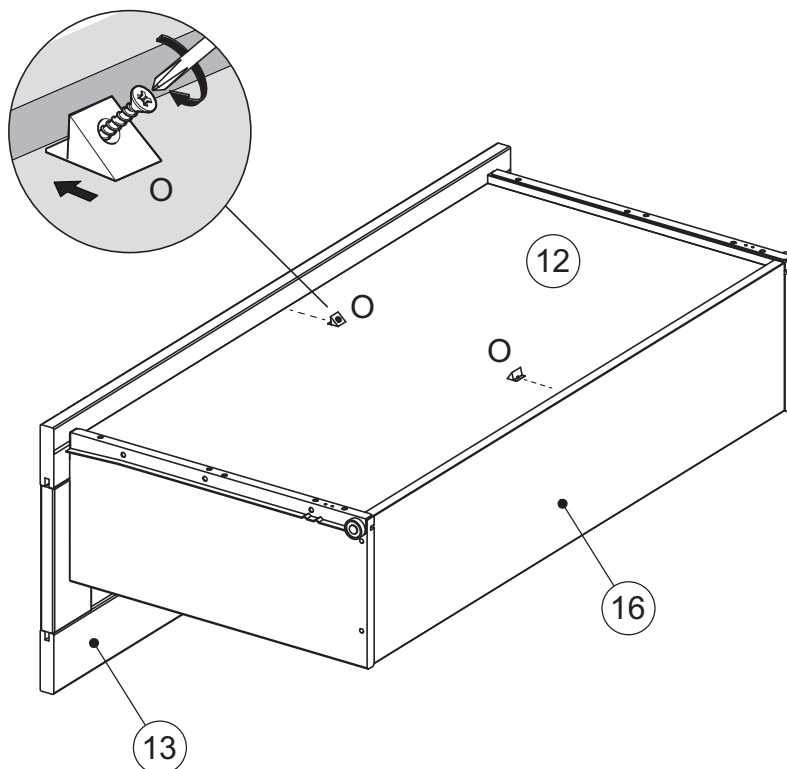

x3

40

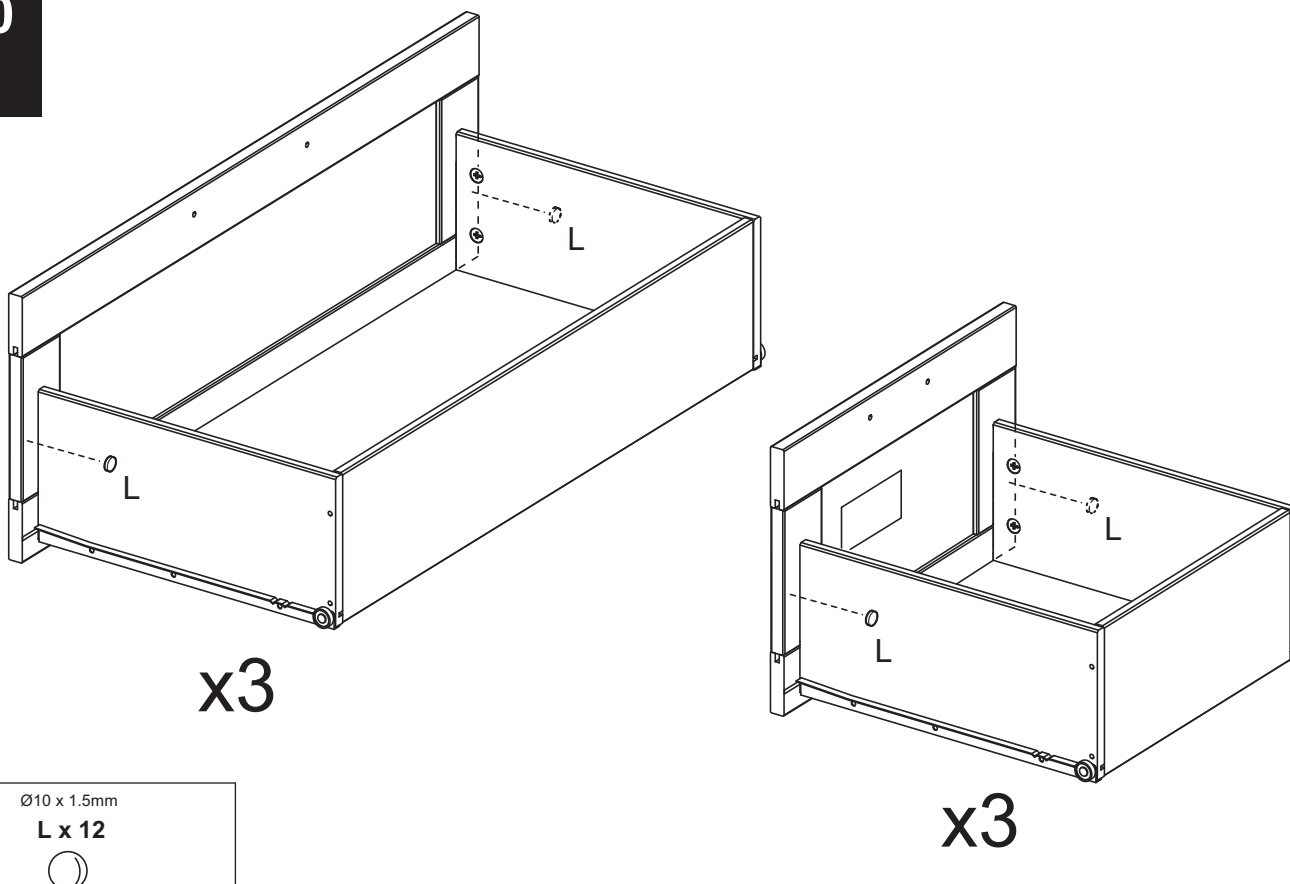

Ø10 x 1.5mm

L x 12



x3

41

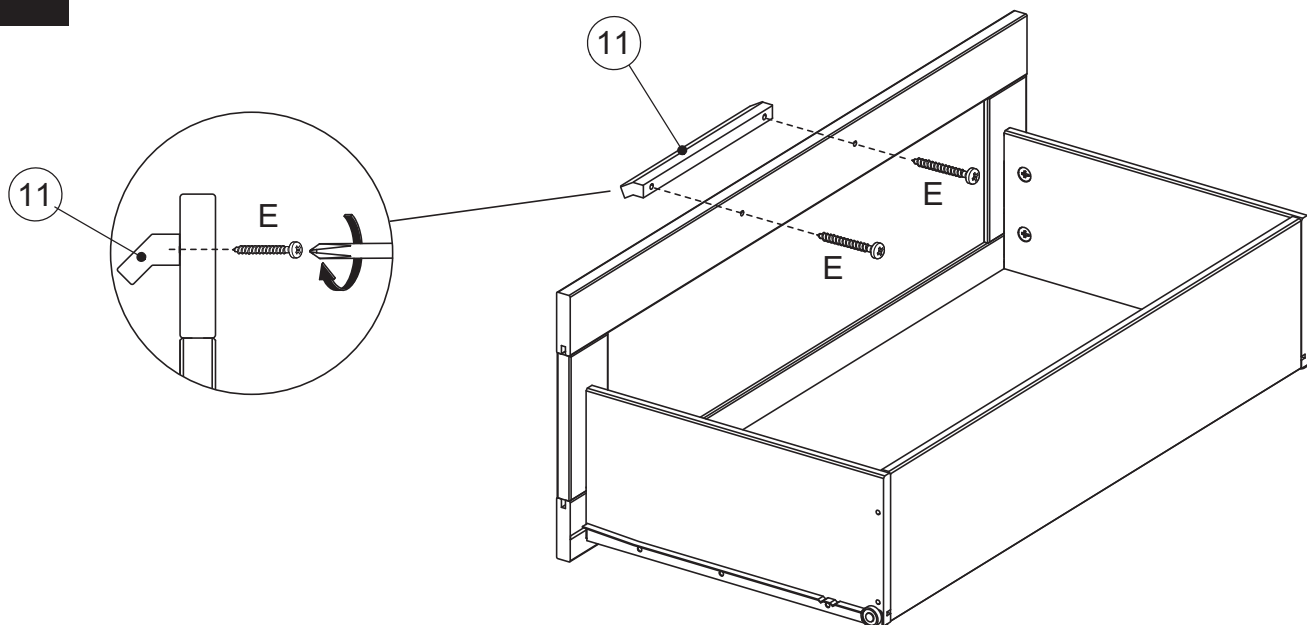

x3

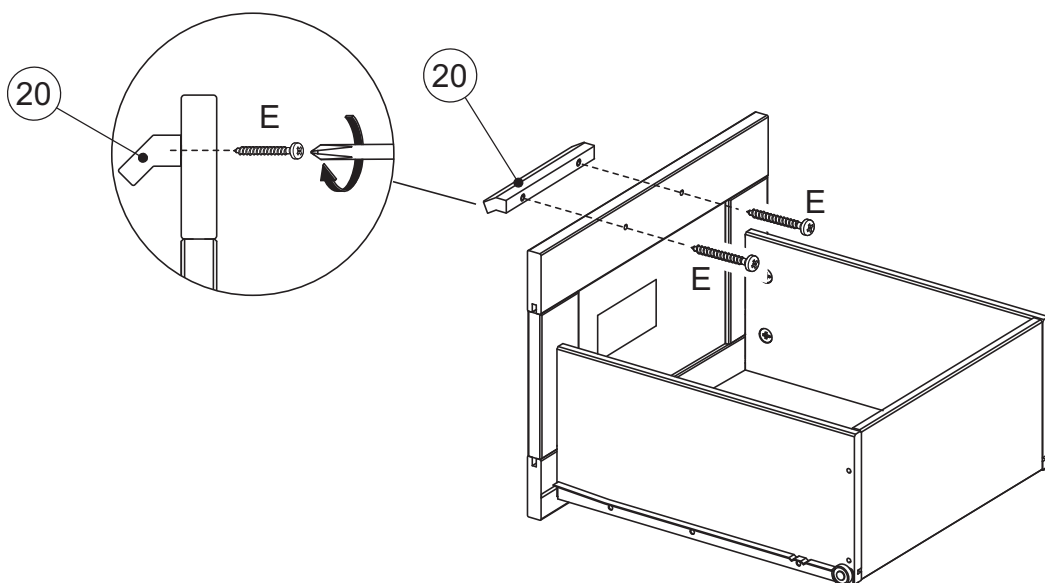

x3

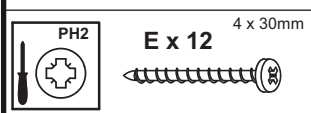

42

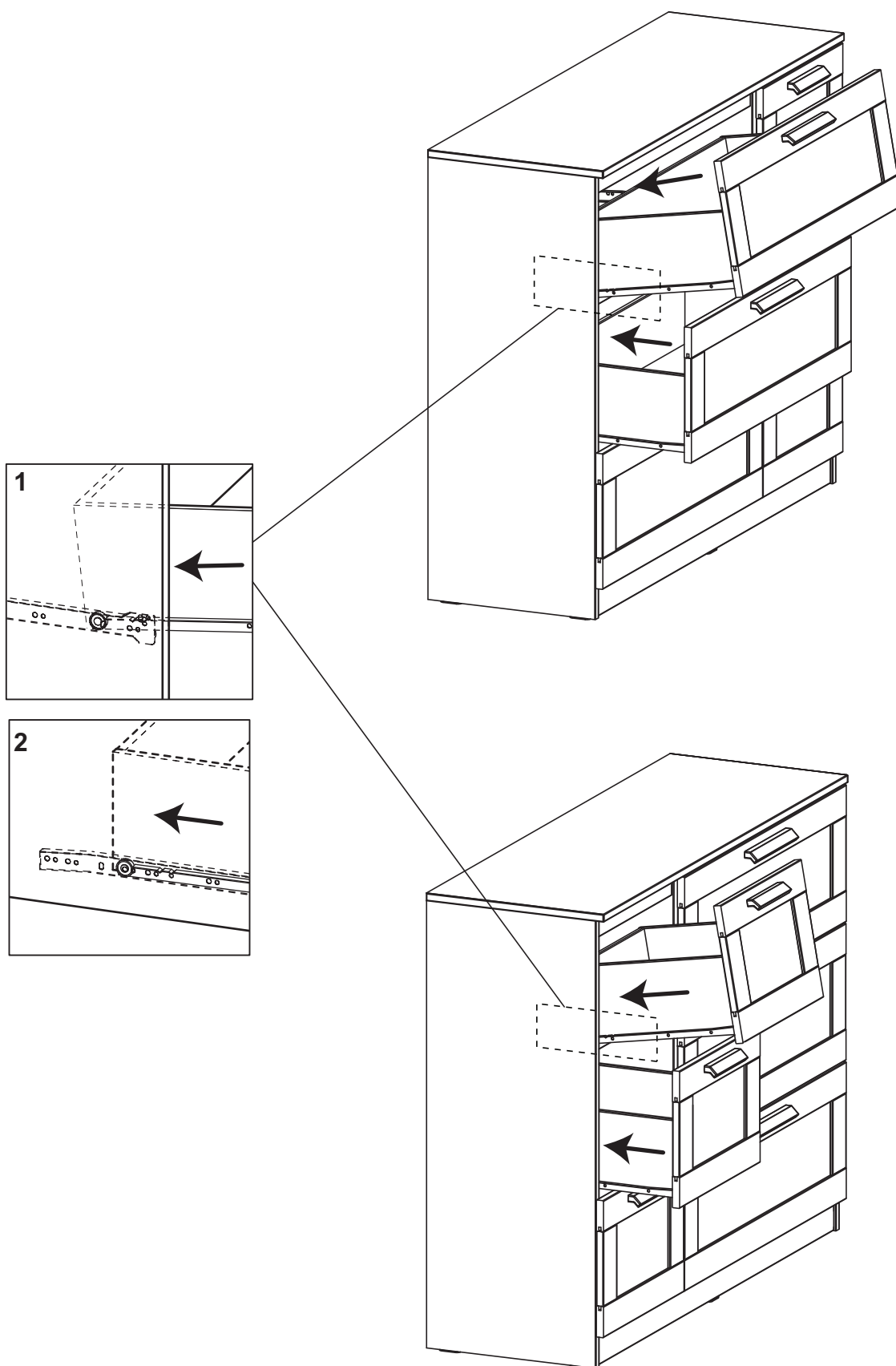

Actual product size

H95 x W117.4 x D39.2cm

