

next

Bella 5 Light Flush

991221

Assembly instructions

Actual product size

H25 x DIAM 47cm

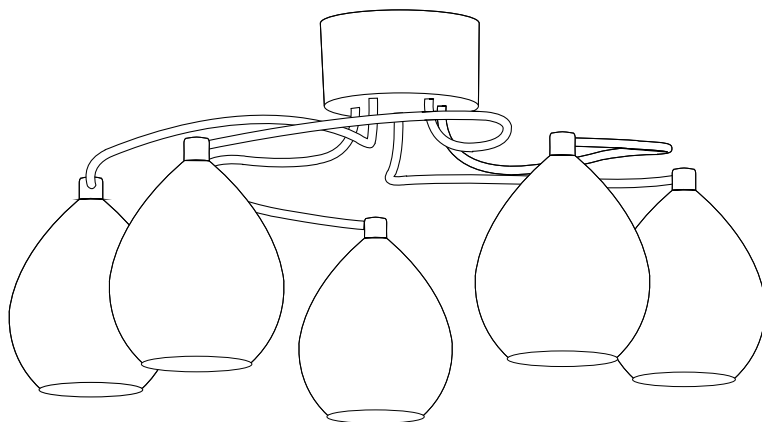

Need Help?

With: Assembly instructions
Missing or damaged parts

CALL: 0333 777 8999

IMPORTANT – RETAIN FOR FUTURE REFERENCE

next

Bella 5 Light Flush

991221

Assembly instructions

Warnings

We suggest you retain these instructions for future reference

For your safety, this product must be installed in accordance with local Building Regulations. If in any doubt, or required by the law, consult a competent person who is registered with an electrician self-certification scheme. Further information is available online or from your Local Authority

This light is suitable for indoor use only

Light fittings should be connected to a 5 amp fused circuit

This light when used with the supplied light bulb may be dimmed using a standard dimmer switch

Before commencing installation, isolate the circuit to be used by removing the fuse or circuit breaker at the consumer distribution unit

Do's

We suggest you spend a short time reading through this leaflet before you start

When you are ready to start, make sure that you have the right tools and plenty of space

Unwrap all packaging materials and place the components on top of the carton box or on a clean floor to protect it from damage

We recommend that the packaging is used to protect the surfaces during assembly

Carefully check that you have all the parts before beginning assembly

Ensure the product is fully assembled as illustrated and all fixings fully tightened before use. Check fixings regularly to ensure they remain tight

Always switch off the supply before changing light bulbs or cleaning

Allow bulbs to cool down before handling

Don'ts

The fitting should not be fixed to newly painted or plastered surfaces as this may cause discolouration of the finish

We recommend cleaning with a soft dry cloth, do not use abrasive materials as these will rub away the protective coating

Number of people required to assemble

One person who is competent with electrical wiring and installation, however we do recommend that this item is installed by a qualified electrician

Time to assemble



20 mins

Tools required

Cross Head Screwdriver

Flat Screwdriver

Insulating Tape

Missing parts

If you are missing any fixtures and fittings for your product please contact our customer service team on 0333 777 8999 and they will be happy to help.

Cleaning Care

We recommend cleaning with a soft dry cloth. Do not use abrasive materials as these will rub away the protective coating.

Maintenance

To ensure your safety, if the cable becomes damaged it must be replaced by only a qualified person.

Safety information

For your safety, please remember the following:

- Always switch off the power supply before changing lightbulbs or cleaning
- Allow bulbs to cool down before handling.

You can write to us at

Home Customer Services
Next Retail Ltd,
Desford Road,
Leicester,
LE19 4AT

To view our full range please visit
www.next.co.uk

GETTING TO KNOW YOUR PRODUCT

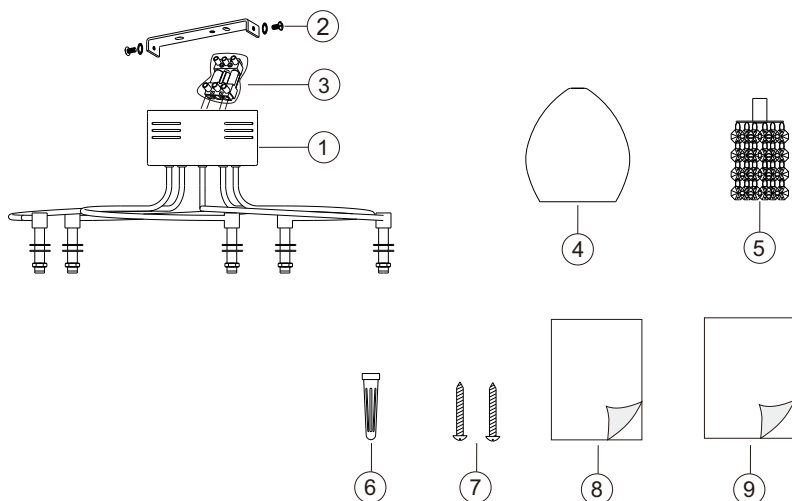

Components supplied. Please use this guide if you require replacement parts.

| Ref | Description | Spec | Qty | Remark |
|-----|--------------------------|----------------|-----|---------------------------|
| 1 | Light fitting | | 1 | |
| 2 | Fixing bracket accessory | | 1 | Attached on light fitting |
| 3 | Terminal block | 2 parts | 1 | Attached on light fitting |
| 4 | Glass shade | Dia 11 x H12cm | 6 | One for spare |
| 5 | Droppers shade | | 5 | Packed in fixing pack |
| 6 | Shade ring tool | | 1 | Packed in fixing pack |
| 7 | Fixing screws | M4 L1.2" | 2 | Packed in fixing pack |
| 8 | Assembly instructions | A3 x 1 | 1 | Packed in fixing pack |
| 9 | Re-pack instructions | A4 x 1 | 1 | Packed in fixing pack |

next

Bella 5 Light Flush

991221

Assembly instructions

Assembly Instructions

1

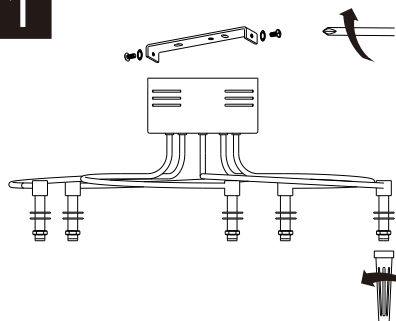

Remove side screws and lock washers from the fixing bracket and retain for later use.

Remove nuts and washers from lampholder by tool provided. and retain for later use.

2

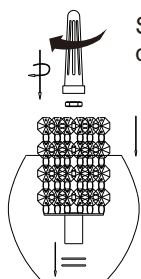

Screw back nut, ensure glass shade and dropper shade are secured in place.

Place silicon washer ,metal washer and droopers shade to inside of glass shade.

Place glass shade over lampholder.

3

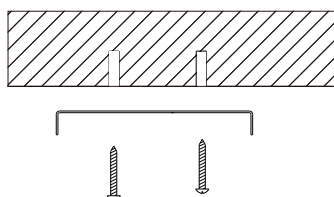

THIS FITTING MUST BE SECURED TO A JOIST OR JOIST BRIDGE.

Taking care not to damage any house wiring, screw fixing bracket to the ceiling . The screws should penetrate the joist by at least 2cm.

4

**WARNING: SWITCH OFF THE POWER SUPPLY
BEFORE WORKING ON THE WIRING!**

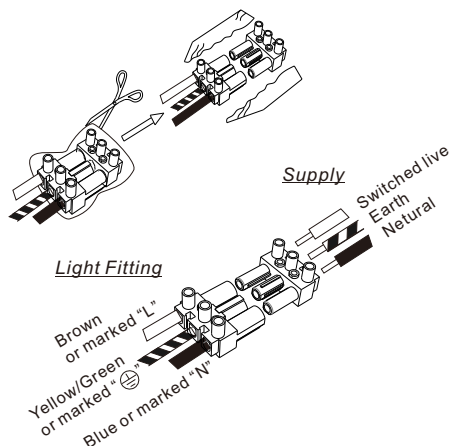

Connect wires

IMPORTANT!

The fitting's earth wires must be connected to the household earth. Check that

- ◆ you have correctly identified the house wires for the light fitting.
- ◆ connections are tight.
- ◆ no loose strands have been left out of the connection block(s).

Insert the lighting terminal block to the main supply part.

5

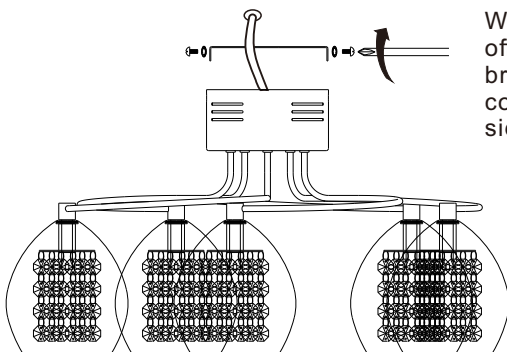

When all connections are insulated, offer the ceiling cup up to the fixing bracket. Align the side screws with the corresponding slots. Then tighten the side screws.

6

Selecting the correct lightbulb(5pcs)

- ◆ Maximum Wattage – 20 Watts.
- ◆ Voltage – 12 Volts.
- ◆ Lightbulb type – G4 Capsule.

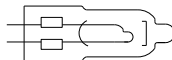

Do not exceed the maximum wattage as this may cause your light fitting to overheat. Use a soft cloth to handle bulbs.

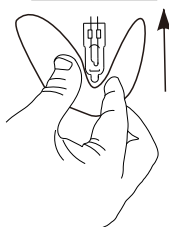
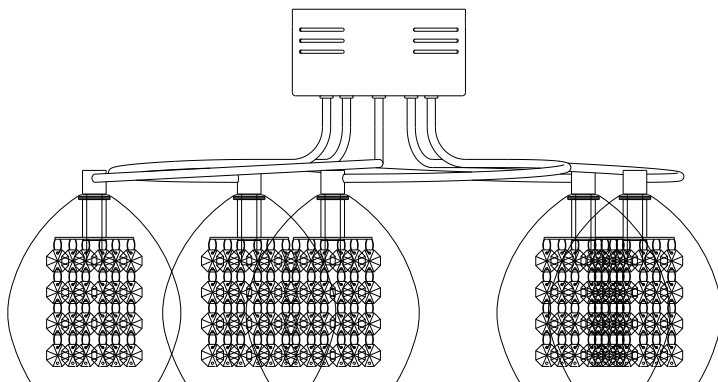

Insert bulb into lampholder

next

Bella 5 Light Flush

991221

Actual product size

H25 x DIAM 47cm

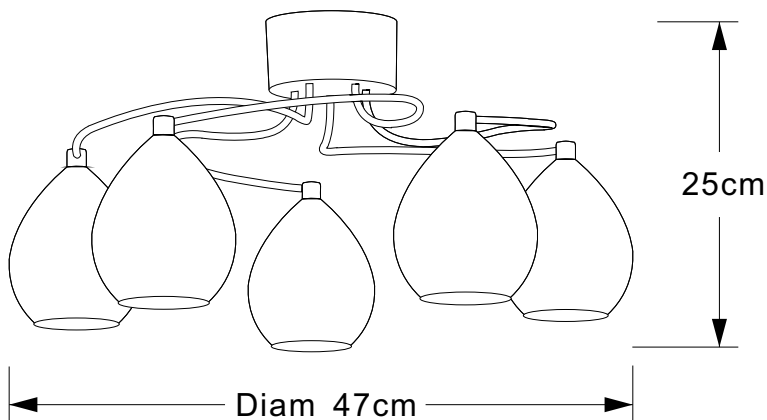

Selecting the correct lightbulb(5pcs)

- ◆ Maximum Wattage – 20 Watts.
- ◆ Voltage – 12 Volts.
- ◆ Lightbulb type – G4 Capsule.

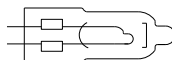

Produced in China for Next Retail Ltd.

991221 - V1

next

Thank you for shopping with us