

# NEXT

Thank you for shopping with us

# NEXT

## RECHARGEABLE LEXINGTON WALL LIGHT AK2373 Assembly Instructions

**Actual Product Size**  
**L206\*W160\*H167mm**

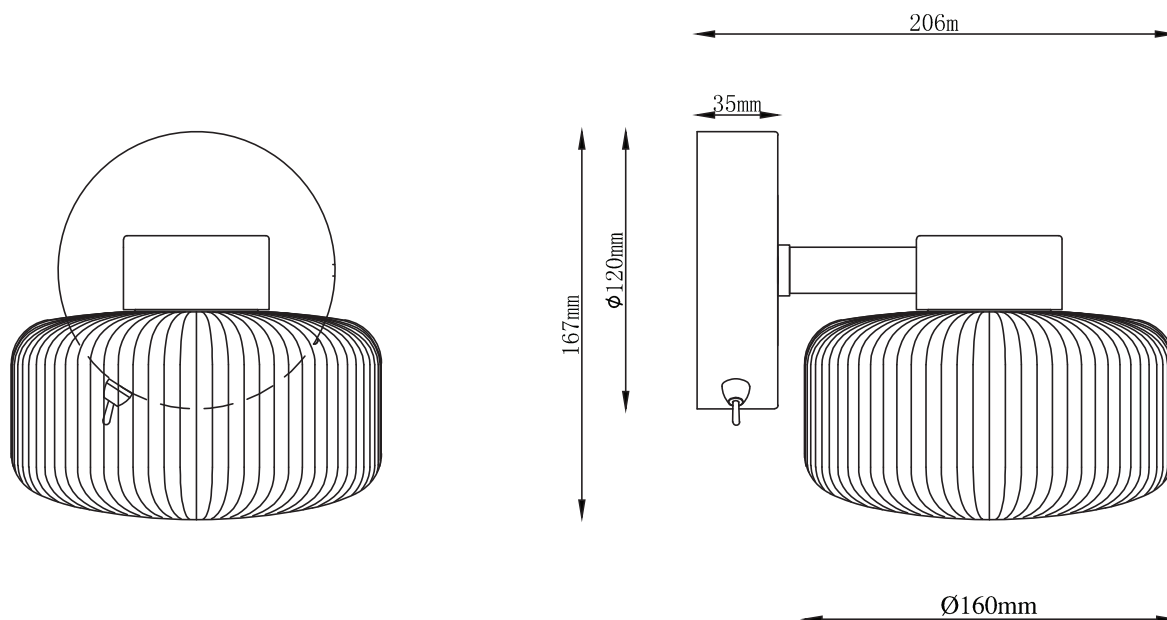

**IMPORTANT - RETAIN FOR FUTURE REFERENCE**

### Need Help?

with: Assembly instructions,  
missing or damaged parts

**CALL:0333 777 8999**

## BEFORE YOU START

### Warnings

We suggest you retain these instructions for future reference

For your safety, this product must be installed in accordance with local Building Regulations. If in any doubt, or required by the law, consult a competent person who is registered with an electrician self-certification scheme. Further information is available online or from your Local Authority

This light is suitable for indoor use only

### Do's

We suggest you spend a short time reading through this leaflet before you start

When you are ready to start, make sure that you have the right tools and plenty of space

Unwrap all packaging materials and place the components on top of the carton box or on a clean floor to protect it from damage

We recommend that the packaging is used to protect the surfaces during assembly

Carefully check that you have all the parts before beginning assembly

Ensure the product is fully assembled as illustrated and all fixings fully tightened before use. Check fixings regularly to ensure they remain tight

### Don'ts

The fitting should not be fixed to newly painted or plastered surfaces as this may cause discolouration of the finish

We recommend cleaning with a soft dry cloth, do not use abrasive materials as these will rub away the protective coating

### Contents and specification:

- 1 x battery lamp which doesn't need to be plugged in to function.
- This product contains 2 x batteries which are replaceable.
- Rechargeable by magnetic USB port: 2m USB charging cable included (USB plug is needed to charge but not included).
- Integrated LED lamp – bulbs not required.
- Average run time: 8 Hrs
- Average charge time from flat: 5 Hrs
- Wattage: 2W
- Light output: 100 lumen
- Colour Temperature: 3000 Kelvin
- This product has a charging indicator light. When charging, the light will show red. Once charging is complete, the light will change to white. In order to maintain the longevity of the product, please do not overcharge or leave on charge for prolonged periods of time.

### Number of people required to assemble

One person who is competent with electrical wiring and installation, however we do recommend that this item is installed by a qualified electrician

### Time to assemble

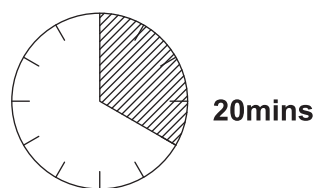

### Tools required

Cross Head Screwdriver

### Missing parts

If you are missing any fixtures and fittings for your product please contact our customer service team on 0333 777 8999 and they will be happy to help.

### Cleaning Care

We recommend cleaning with a soft dry cloth. Do not use abrasive materials as these will rub away the protective coating.

### Maintenance

To ensure your safety, if the cable becomes damaged it must be replaced only by a qualified person.

### Safety information

For your safety, please remember the following:

- Switch off before cleaning.
- Clean only with a soft dry cloth.

### You can write to us at

Home Customer Services  
Next Retail Ltd,  
Desford Road,  
Leicester,  
LE19 4AT  
or  
Next Retail (Ireland) Ltd,  
13-18 City Quay,  
Dublin 2,  
D02 ED70

To view our full range please visit  
[www.next.co.uk](http://www.next.co.uk)

4

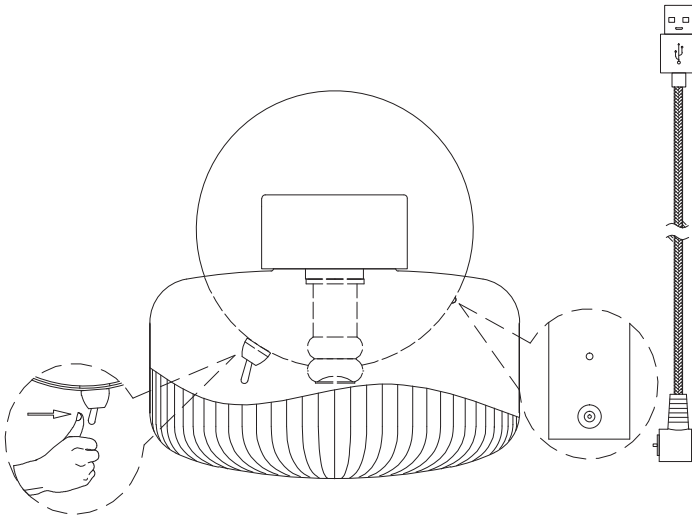

### Step 4

By contact with the toggle switch to turn on/off the light. Rechargeable by using the magnetic USB port. (2m USB charging cable included, USB plug is needed to charge but not included)

5

### Step 5

Batteries can be replaced as per below diagrams. Remove the wall light from wall. Loosen the screws on the back of wall plate and remove the metal plate. Replace the batteries and put the metal plate back on then tighten the screws. Please note the old batteries should be disposed at the end of their life separately from you household waste. There are separate collection system for recycling. And the specification of the new batteries selected must be 18650 1500mAh 3.7Vdc.

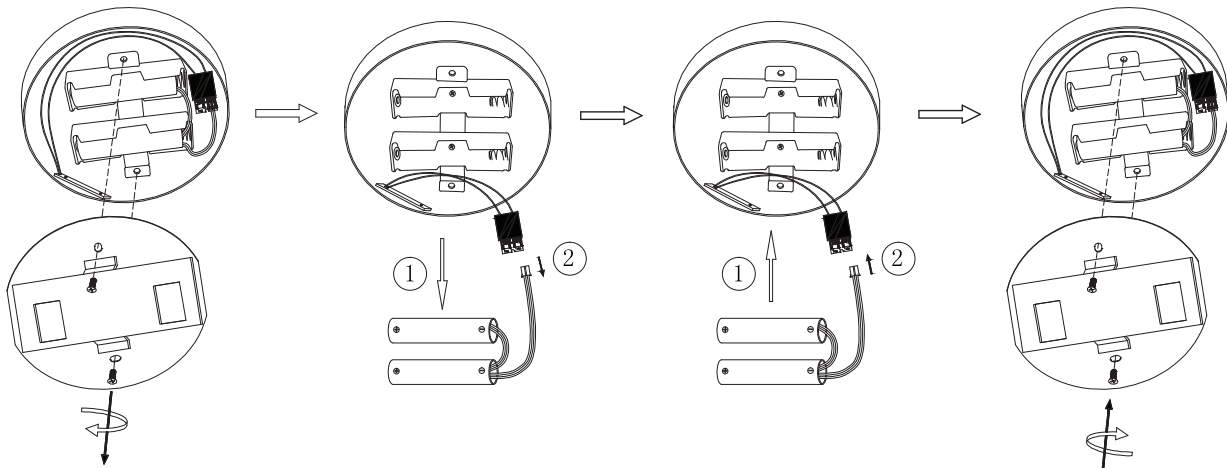

## GETTING TO KNOW YOUR PRODUCT

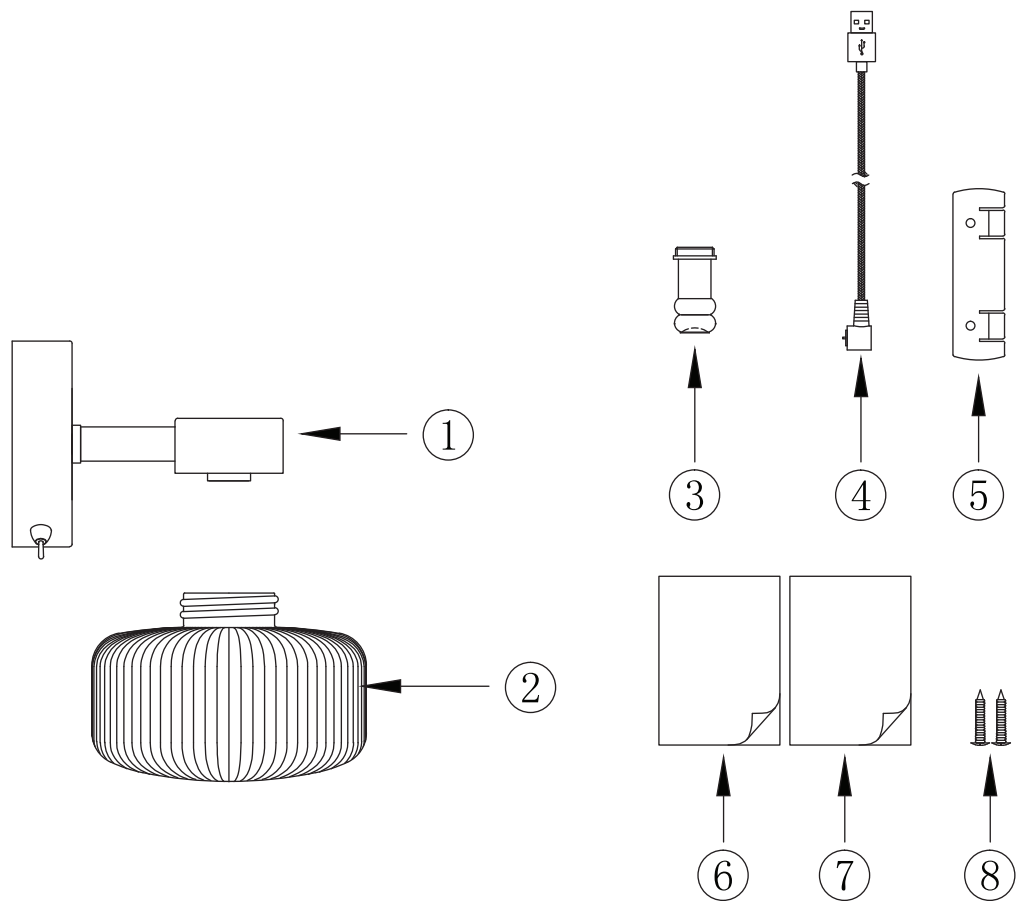

Ref	Description	Specification	Qty	Remark
1	Lamp body		1	Packed in carton
2	Glass shade	Φ160*H108MM	1	Packed in carton
3	Lens	Φ25*H50MM	1	Packed in carton
4	USB charging cable	2M	1	Packed in fixing pack
5	Fixing bracket	L100*W30MM	1	Packed in fixing pack
6	Assembly instructions	A4 X 2	1	Packed in fixing pack
7	Re-package instructions	A4 X 1	1	Packed in fixing pack
8	Fixing screws	L38MM	2	Packed in fixing pack

# NEXT

## RECHARGEABLE LEXINGTON WALL LIGHT

AK2373

### Assembly Instructions

1

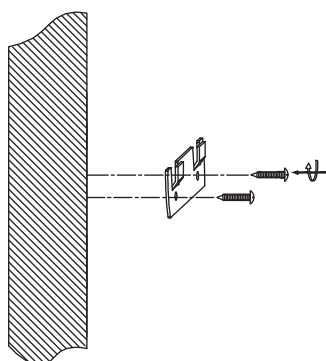

#### Step 1

Using the fixing bracket as a guide, mark screw positions on the wall. Make sure the area is free of any hidden wires, water or gas pipes. Attach fixing bracket to the wall using screws supplied.

2

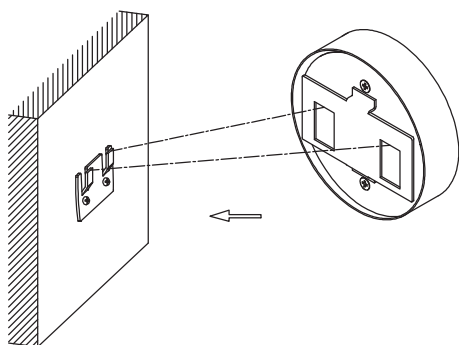

#### Step 2

Attach the wall light onto fixing bracket.

3

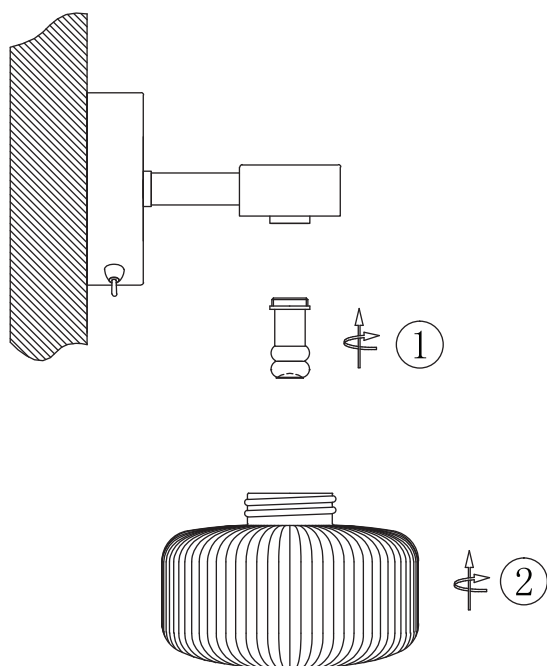

#### Step 3

Put the lens onto lampholder and screw on the glass shade.