

NEXT

Thank you for shopping with us

NEXT

RECHARGEABLE DINOSAUR TABLE LAMP B58361 Assembly Instructions

Actual Product Size

150*H270{ {

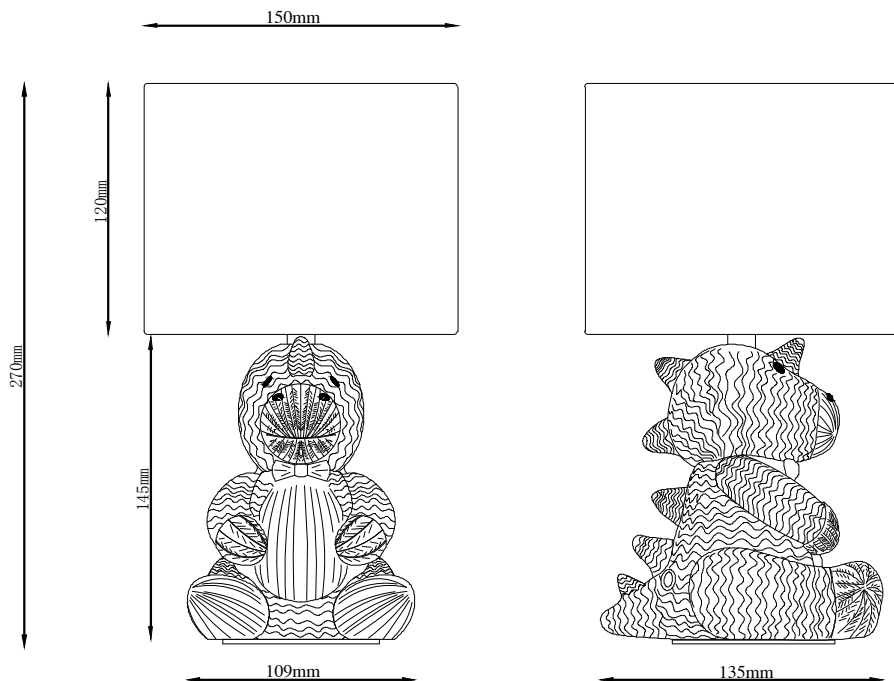

Need Help?

with: Assembly instructions,
missing or damaged parts

CALL:0333 777 8999

IMPORTANT - RETAIN FOR FUTURE REFERENCE

NEXT

RECHARGEABLE DINOSAUR TABLE LAMP B58361 Assembly Instructions

BEFORE YOU START

Warnings

We suggest you retain these instructions for future reference

This light is suitable for indoor use only

Contents and specification:

- 1 x battery lamp which doesn't need to be plugged in to function.
- This product contains 1 x battery which are replaceable.
- Rechargeable by USB port: 1.5m USB charging cable included (USB plug is needed to charge but not included).
- Integrated LED lamp – bulbs not required.
- Average run time: 8 Hrs
- Average charge time from flat: 4 Hrs
- Wattage: 2W
- Light output: 50 lumen
- Colour Temperature: 3000 Kelvin
- The light will only go through the 3 stage touch when in contact with the switch on the base of the lamp.
- This product has a charging indicator light. When charging, the light will show red. Once charging is complete, the light will change to white. In order to maintain the longevity of the product, please do not overcharge or leave on charge for 24 hours.
- Ensure that all packaging is disposed of carefully and responsibly
 - keep all plastic wrapping materials away from children to avoid danger of suffocation.

Tools required

Scissor for unpacking

Missing parts

If you are missing any fixtures and fittings for your product please contact our customer service team on 0333 777 8999.

Cleaning Care

We recommend cleaning with a soft dry cloth. Do not use abrasive materials as these will rub away the protective coating.

Safety information

For your safety, please remember the following:

- Switch off before cleaning.
- Clean only with a soft dry cloth.

You can write to us at

Home Customer Services
Next Retail Ltd,
Desford Road,
Leicester,
LE19 4AT
or
Next Retail (Ireland) Ltd,
13-18 City Quay,
Dublin 2,
D02 ED70

To view our full range please visit
www.next.co.uk

GETTING TO KNOW YOUR PRODUCT

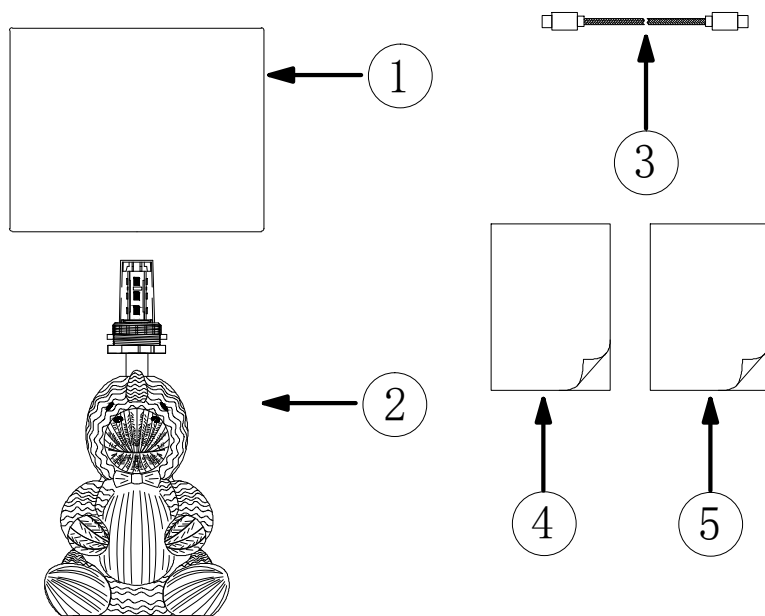

Ref	Description	Specification	Qty	Remark
1	Lamp shade	Φ150*H120MM	1	Packed in carton
2	Lamp body		1	Packed in carton
3	USB charging cable	1.5M	1	Packed in fixing pack
4	Assembly instructions	A4 X 2	1	Packed in fixing pack
5	Re-package instructions	A4 X 1	1	Packed in fixing pack

Assembly Instructions

Unpack the contents of the carton. Lay the contents out on a flat surface giving yourself room to work.

Step 1

Put the lamp shade onto lampholder and secure into position with the shade ring.

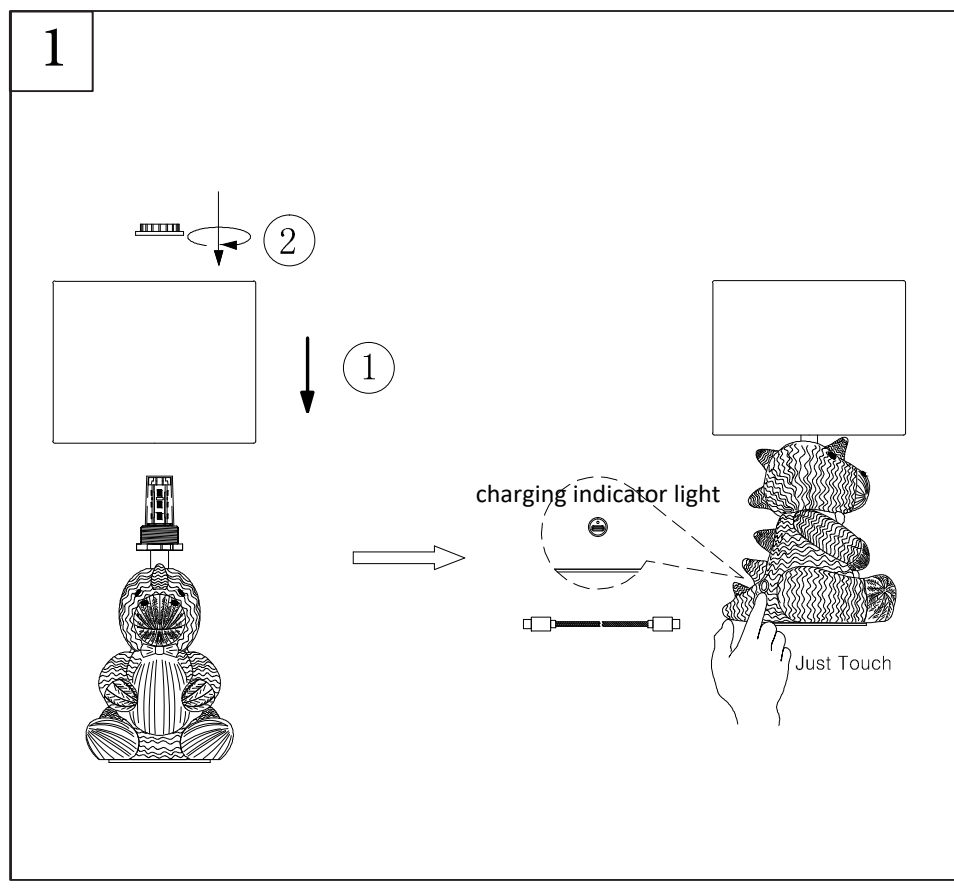

Step 2

Battery can be replaced as per below diagrams. Peel off the felt pad on the bottom of the lamp base. Loosen the screws and remove the metal plate. Replace the battery and put the metal plate back on then tighten the screws. Please note the old battery should be disposed at the end of their life separately from you household waste. There are separate collection system for recycling. And the specification of the new battery selected must be 18650 2200mAH 3.7Vdc.

2

