

# NEXT

## PORTLAND CURV FLOOR LAMP B82099 Assembly instructions

### Actual product size

H182 x W150 x D45 cm

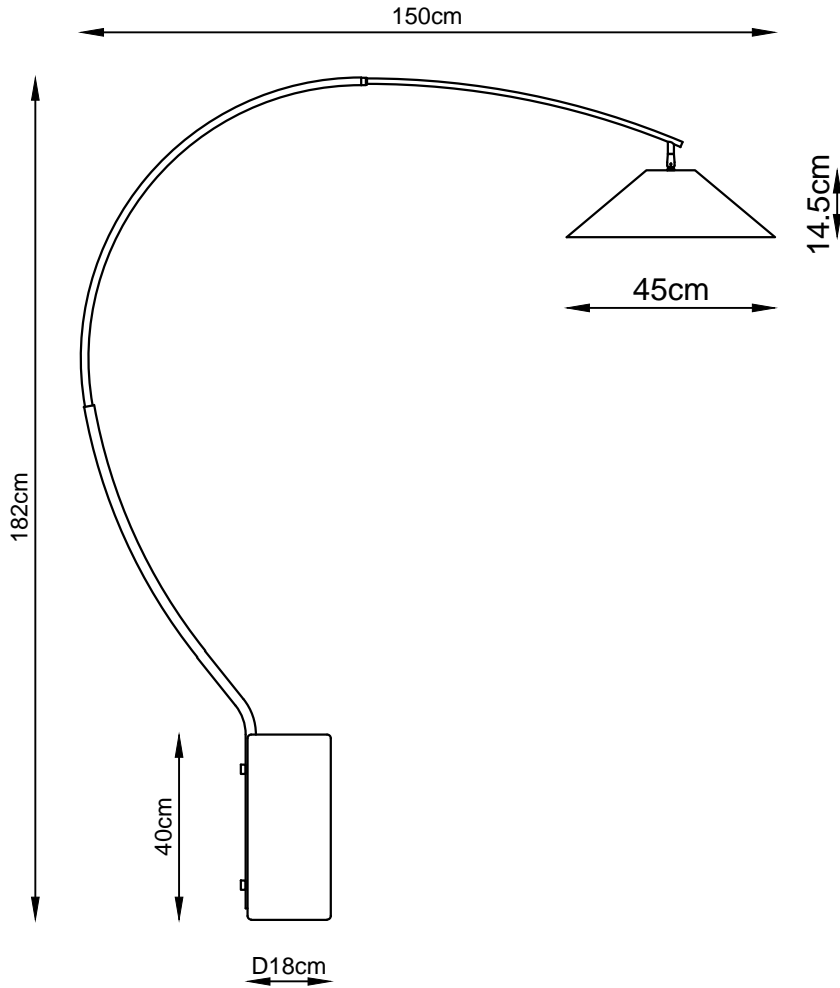

# NEXT

## PORTLAND CURV FLOOR LAMP B82099 Assembly instructions

### Actual product size

H182 x W150 x D45 cm

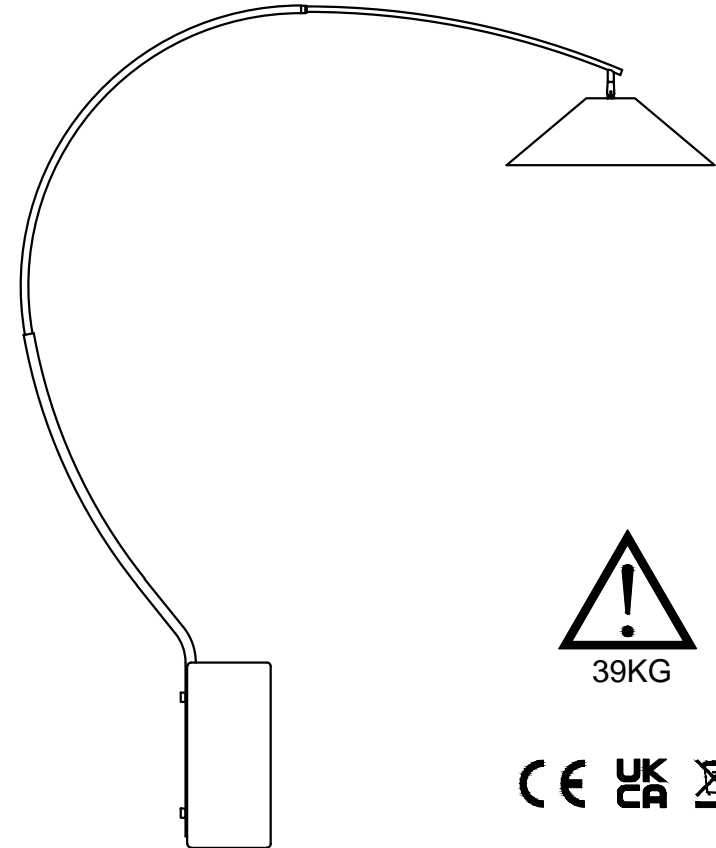

39KG



### Need Help?

with: Assembly instructions  
Missing or damaged parts

**CALL: 0333 777 8999**

IMPORTANT-RETAIN FOR FUTURE REFERENCE

## BEFORE YOU START

### Warnings

We suggest you retain these instructions for future reference. For your safety, this product must be installed in accordance with local building regulations. If in any doubt, or required by the law, consult a competent person who is registered with an electrician self-certification scheme. Further information is available online or from your local authority.

This light is suitable for indoor use only.

We suggest you retain these instructions for future reference.

Recommended Bulb: ES 6W LED MAX 10W

Please be warned that this is **very heavy**.

### Do's

We suggest you spend a short time reading through this leaflet before you start.

When you are ready to start, make sure that you have the right tools and plenty of space.

Unwrap all packaging materials and place the components on top of the carton box or on a clean floor to protect it from damage.

We recommend that the packaging is used to protect the surfaces during assembly. Carefully check that you have all the parts before beginning assembly.

Ensure the product is fully assembled as illustrated and all fixings fully tightened before use. Check fixings regularly to ensure they remain tight.

Always switch off the supply before changing light bulbs or cleaning.

Allow bulbs to cool down before handling.

### Don'ts

We recommend cleaning with a soft dry cloth, do not use abrasive materials as these will rub away the protective coating.



39KG

PLEASE NOTE THIS ITEM IS VERY HEAVY

### Time to assemble



20mins

### Missing parts

If you are missing any fixtures and fittings for your product please contact our customer service team on 0333 777 8999 and they will be happy to help.

### Cleaning Care

We recommend cleaning with a soft dry cloth. Do not use abrasive materials as these will rub away the protective coating.

### Maintenance

To ensure your safety, if the cable becomes damaged it must be replaced by only a qualified person.

### Safety information

For your safety, please remember the following:

- Always switch off the power supply before changing lightbulbs or cleaning
- Allow bulbs to cool down before handling.

### You can write to us at

Home Customer Services  
Next Retail Ltd.  
Desford Road, Leicester, LE19 4AT

Next Retail (Ireland) Ltd.  
13-18 City Quay, Dublin 2, D02 ED70

To view our full range please visit  
[www.next.co.uk](http://www.next.co.uk)

## GETTING TO KNOW YOUR PRODUCT

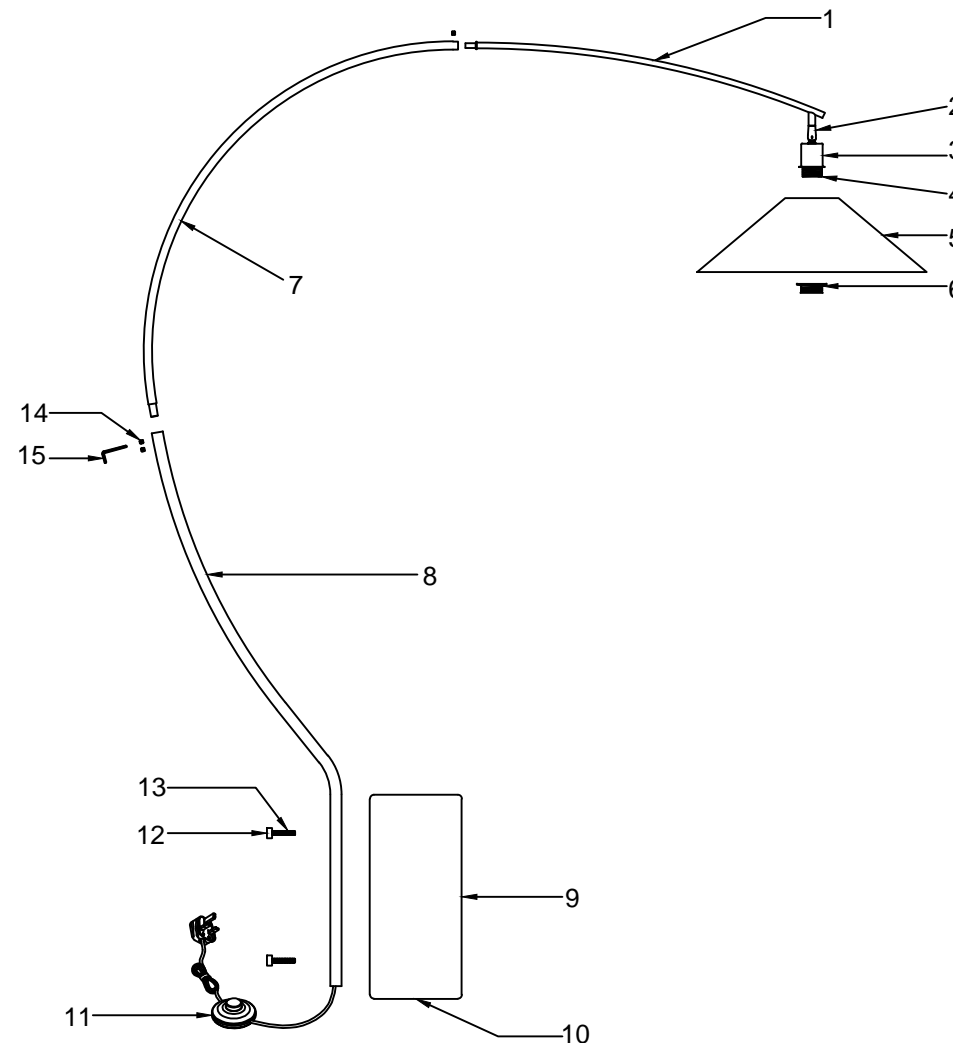

## GETTING TO KNOW YOUR PRODUCT

Ref	Description	Specification	Qty	Remark
1	Elbow Stem	D1.2 * L73 cm	1	
2	Adjustable Head	D1.5 * H4.8 cm	1	
3	Lampholder Cup	D5.1 * H4.6 cm	1	
4	Lampholder	E27	1	
5	Metal Shade	D40*H14.5 cm	1	
6	Lampholder Ring	D6*H1.8 cm	1	
7	Elbow Stem	D1.6*L108 cm	1	
8	Elbow Stem	D2.2*H118 cm	1	
9	Marble Base	D18*H40 cm	1	
10	Felt Pad	D16.5*T0.2 cm	1	
11	Cable	L385 cm	1	
12	Screw Hat	D2*H1 cm	2	
13	Screw Thread	D0.8*L3.5 cm	2	
14	Grub Screws	D4*H5 mm	4	Packed in fixing bag
15	Allen Key	D3*L6 cm	1	Packed in fixing bag

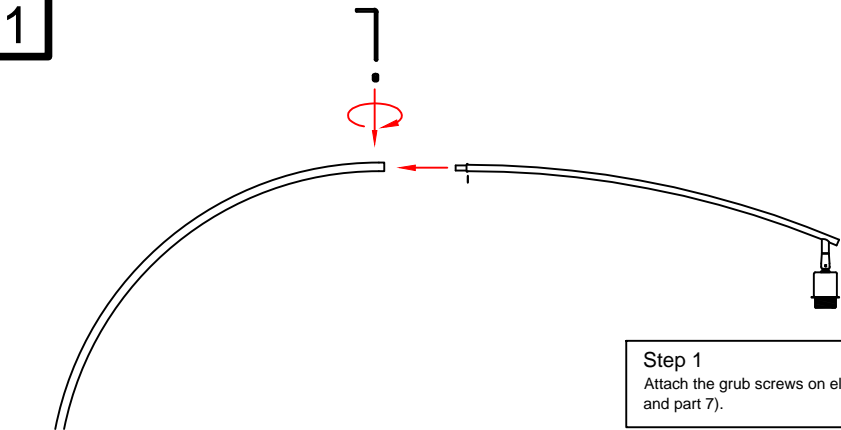

Step 1  
Attach the grub screws on elbow stems (part 1 and part 7).

2

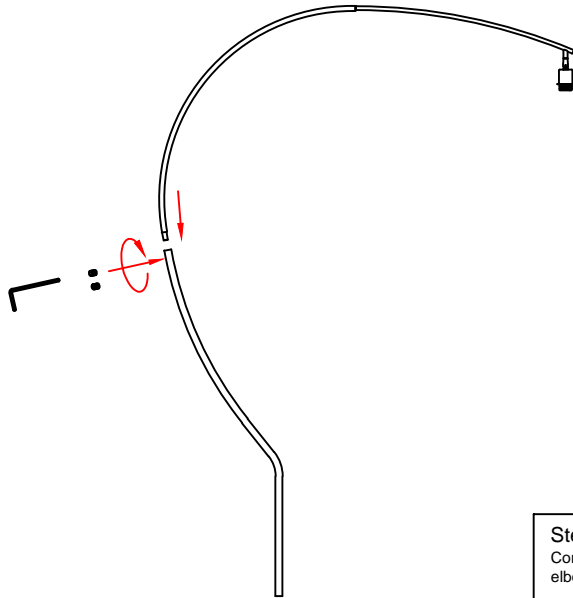

Step 2  
Continue to attach the grub screws on the elbow stems (part 7 and part 8).

3

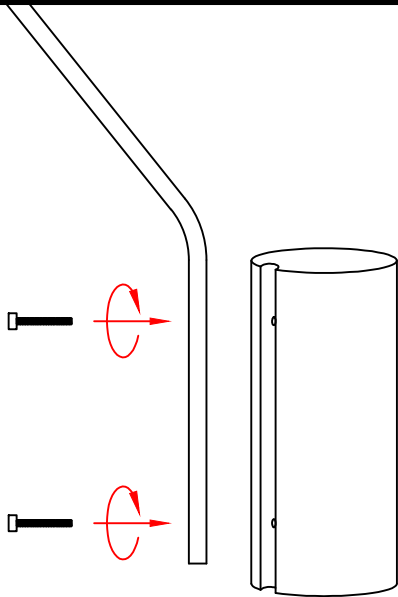

Step 3  
Gently attach the screw to the marble base.

# NEXT

## PORTLAND CURV FLOOR LAMP B82099 Assembly instructions

4

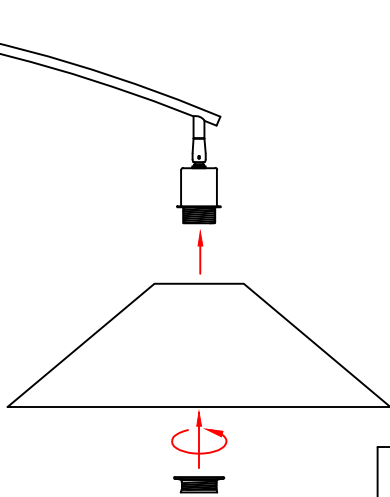

**Step 4**  
Remove the shade ring from the lamp holder,  
then fit the shade onto lamp holder and secure  
into position with the shade ring.

5

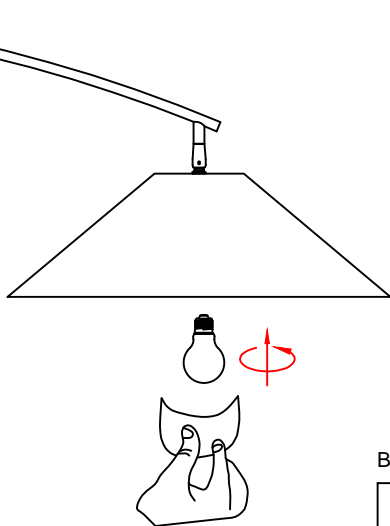

Bulb: Max 10W E27

**Step 5**  
Screw bulb into lampholder. (Bulb not included)

# NEXT

## PORTLAND CURV FLOOR LAMP

### Instructions for repackaging

Thank you for purchasing this Next lighting product. We hope you will be delighted with your purchase, but in the event that you wish to return the product, please follow the repackaging instructions below.

