

BEFORE YOU GET STARTED...

*We're confident you'll love your gorgeous new Next furniture. However, it's worth making absolutely certain before you put it all together.
So, let's quickly run through these three steps:*

1. COLOUR

Make sure you're happy with the colour
No need to unpack everything, just check the first component.

2. PROTECTIVE PACKAGING

If you're happy, then it's time to get opening! Start by laying everything out on the protective packaging – this will prevent anything getting scratched.

3. PARTS PAGE

Finally, double check you have all the pieces by referencing the parts page of the instructions.

TIPS FOR RETURNS

Not completely happy with the product? No problem.
We just need everything back in the original packaging, so follow the steps below and this will ensure a super-smooth returns process and no delay to your refund.

DO



- Check everything is there (the 'parts page' is a handy checklist).
- Pop all the loose fittings and fixtures into the packaging provided or tie them up in a plastic bag.
- Wrap all the big components back up in the original protective packaging.
- Close up the box and seal it securely (don't be afraid to use plenty of tape).

DON'T



- Leave anything assembled - all components should be dismantled and separately packed.
- Put loose fixtures and fittings straight into the box.
- Throw it back in the box carelessly – as it may get damaged.

**NEXT
HOME**

Then just give us a call on 0333 777 8999 and we'll sort out a pick up time for you.

RAINBOW STANDARD BED

NEXT

E22710/E22718

Assembly instructions

Actual product size

Small Double W133cm X L206cm X H101cm

Double W148cm X L206cm X H101cm

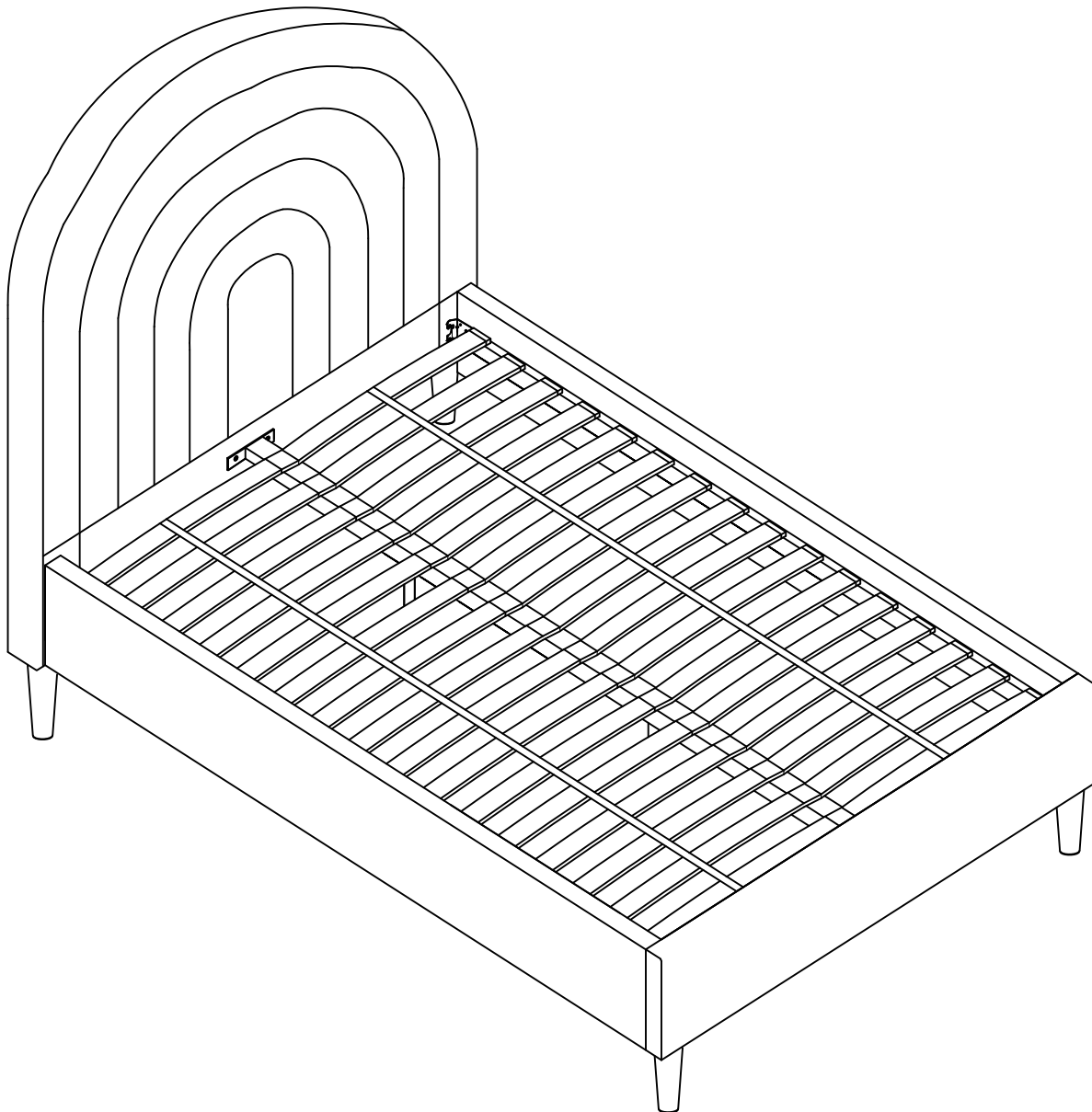

Fabric content

E22710-100% polyester

E22718-100% polyester

IMPORTANT - RETAIN FOR FUTURE REFERENCE

Need Help?

With: Assembly Instructions

Missing or damaged parts

CALL: 0333 777 8999

Assembly instructions

BEFORE YOU START

Number of people required to assemble

Two people are required to assemble this item



Time to assemble : 30 minutes



Tools required

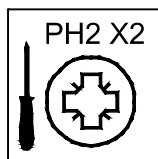

not supplied

Do's

When you are ready to start, make sure that you have the right tools and plenty of space.

Due to the size of the product we recommend that it is assembled in the room intended for use.

Unwrap all packaging materials and place the components on a clean surface to protect it from damage.

We recommend that the packaging is used to protect the surfaces during assembly.

Carefully check that you have all the parts before beginning assembly.

Please periodically check all fittings and re-tighten as necessary.

To clean your item, wipe with soft cloth slightly dampened with water. Then buff with a dry clean cloth.

Routinely check that the fittings are secure and tighten any fittings using the appropriate tools.

If any parts are missing please contact Next to obtain replacements. Under no circumstances should missing parts or hardware be substituted unless obtained from Next.

Don'ts

Do not drag or pull your furniture.

Do not use silicone based furniture polish. Silicone in furniture polishes can break down the lacquer finish

Do not stand or jump on this product.

RAINBOW STANDARD BED

E22710/E22718

Assembly instructions

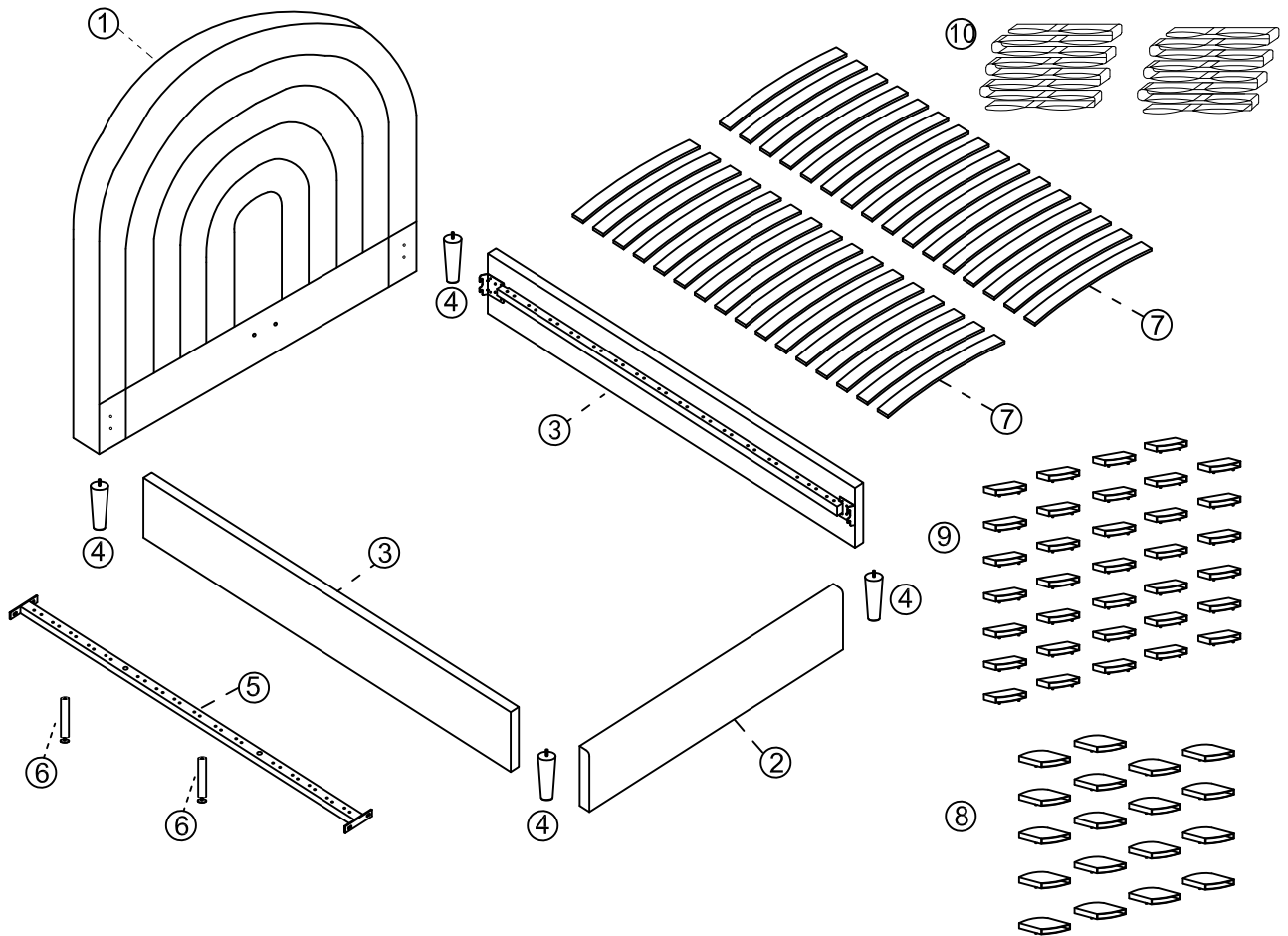

Components supplied. Please use this guide if you require replacement parts.

| Ref | Dimensions | Visual | Qty | Ctn |
|-----|-------------|--------|-----|-----|
| 1 | Headboard | | 1 | 1 |
| 2 | Footboard | | 1 | 2 |
| 3 | Side Rails | | 2 | 2 |
| 4 | Feet | | 4 | 2 |
| 5 | Center Rail | | 1 | 2 |

| Ref | Dimensions | Visual | Qty | Ctn |
|-----|-------------------------------|--------|---|-----|
| 6 | Support legs (250mm-270mm) | | 2 | 2 |
| 7 | Slats | | Small Double 32 Double 32 | 3 |
| 8 | Centre Plastic Cap (Big) | | Small Double 18 Double 18 (2pcs spare part included) | 2 |
| 9 | End Plastic Cap (Small) | | Small Double 34 Double 34 (2pcs spare part included) | 2 |
| 10 | Belts for slat | | 2 | 2 |

RAINBOW STANDARD BED

E22710/E22718

NEXT

Assembly instructions

| Ref | Dimensions | Qty |
|-----|------------|-----|
| A | M8x25 | 8 |
| B | M5 | 2 |
| C | M8x25 | 6 |
| D | M8x19 | 6 |
| E | M8 | 4 |

102030405060708090100110120

RAINBOW STANDARD BED

E22710/E22718

NEXT

Assembly instructions

1

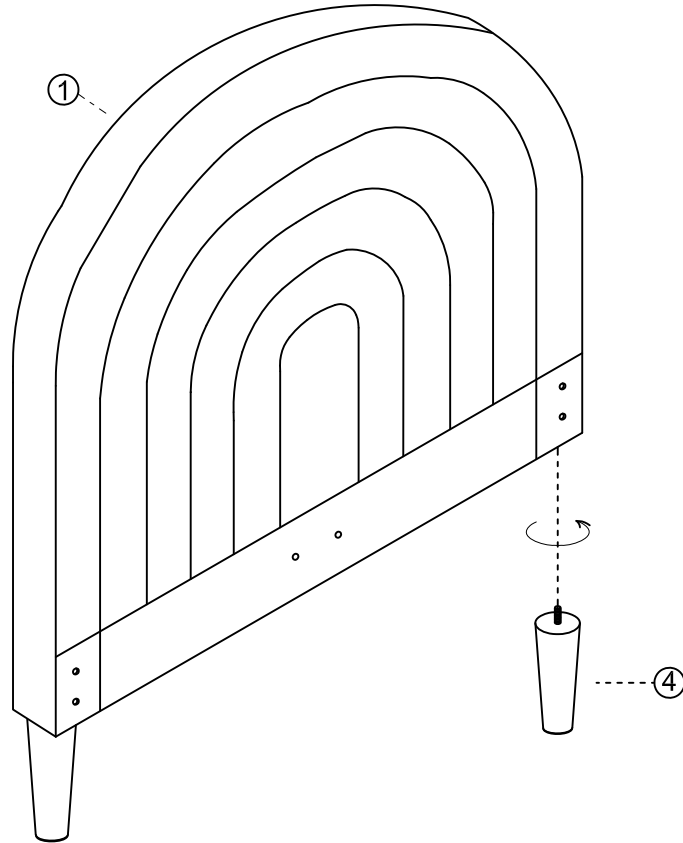

2

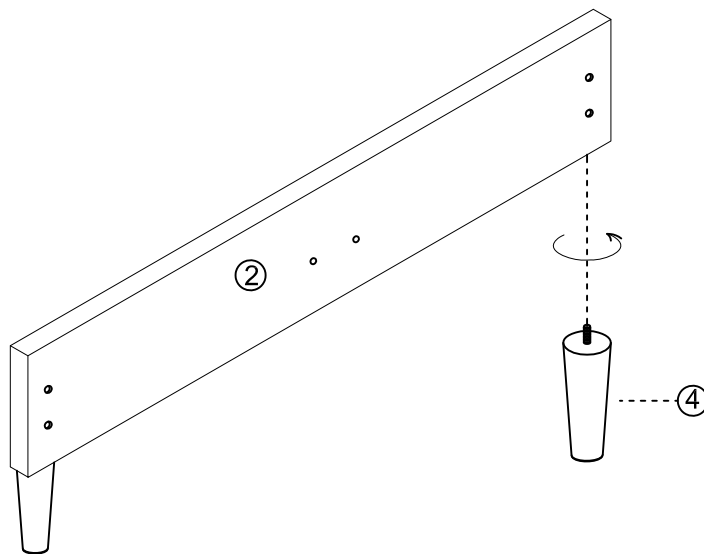

RAINBOW STANDARD BED

E22710/E22718

NEXT

Assembly instructions

3

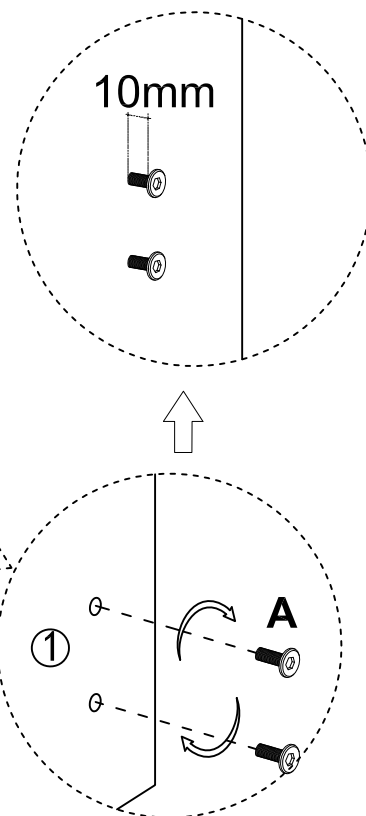
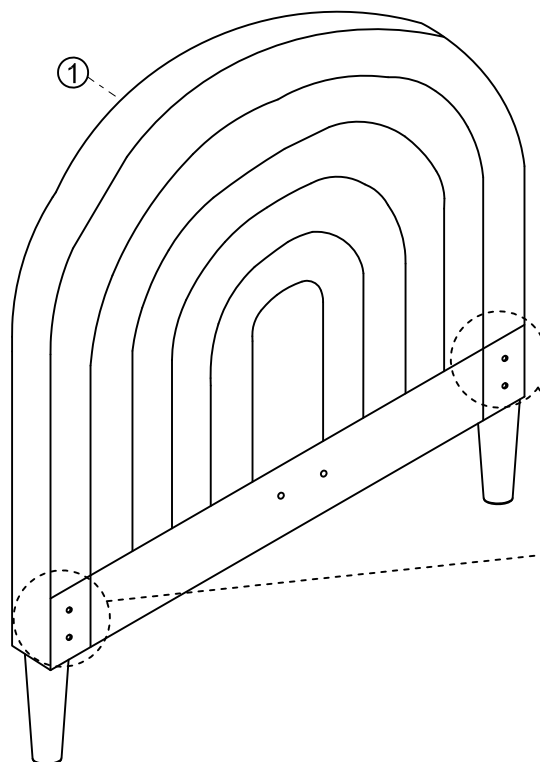

Ax4 M8x25mm

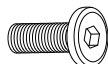

4

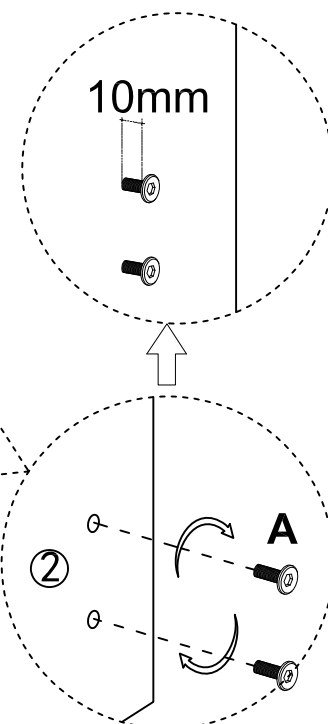
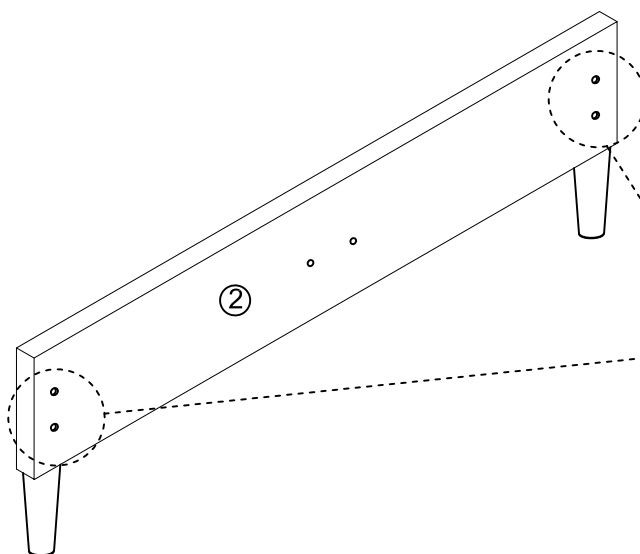

Ax4 M8x25mm

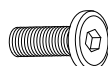

RAINBOW STANDARD BED

E22710/E22718

Assembly instructions

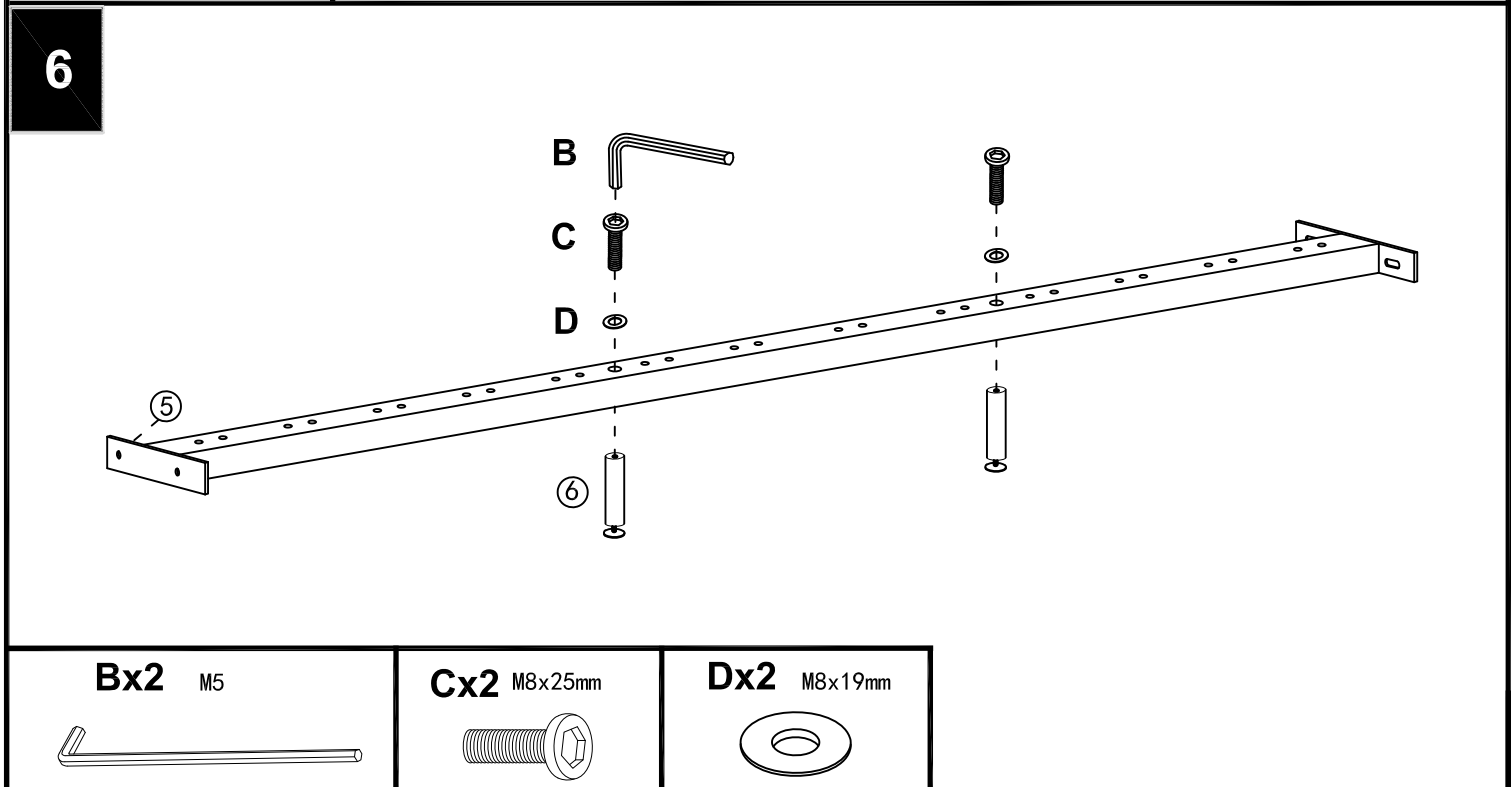
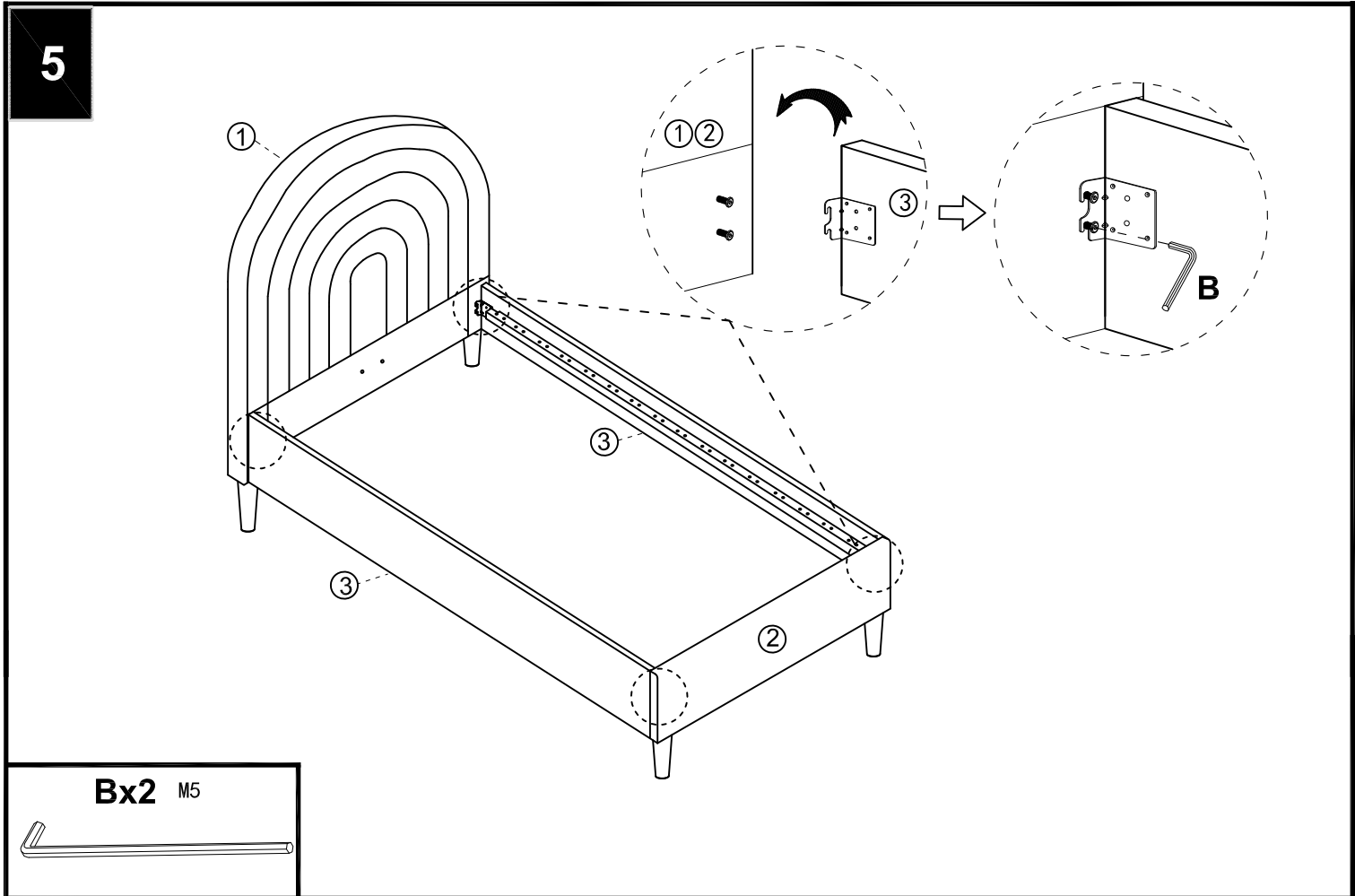

RAINBOW STANDARD BED

E22710/E22718

Assembly instructions

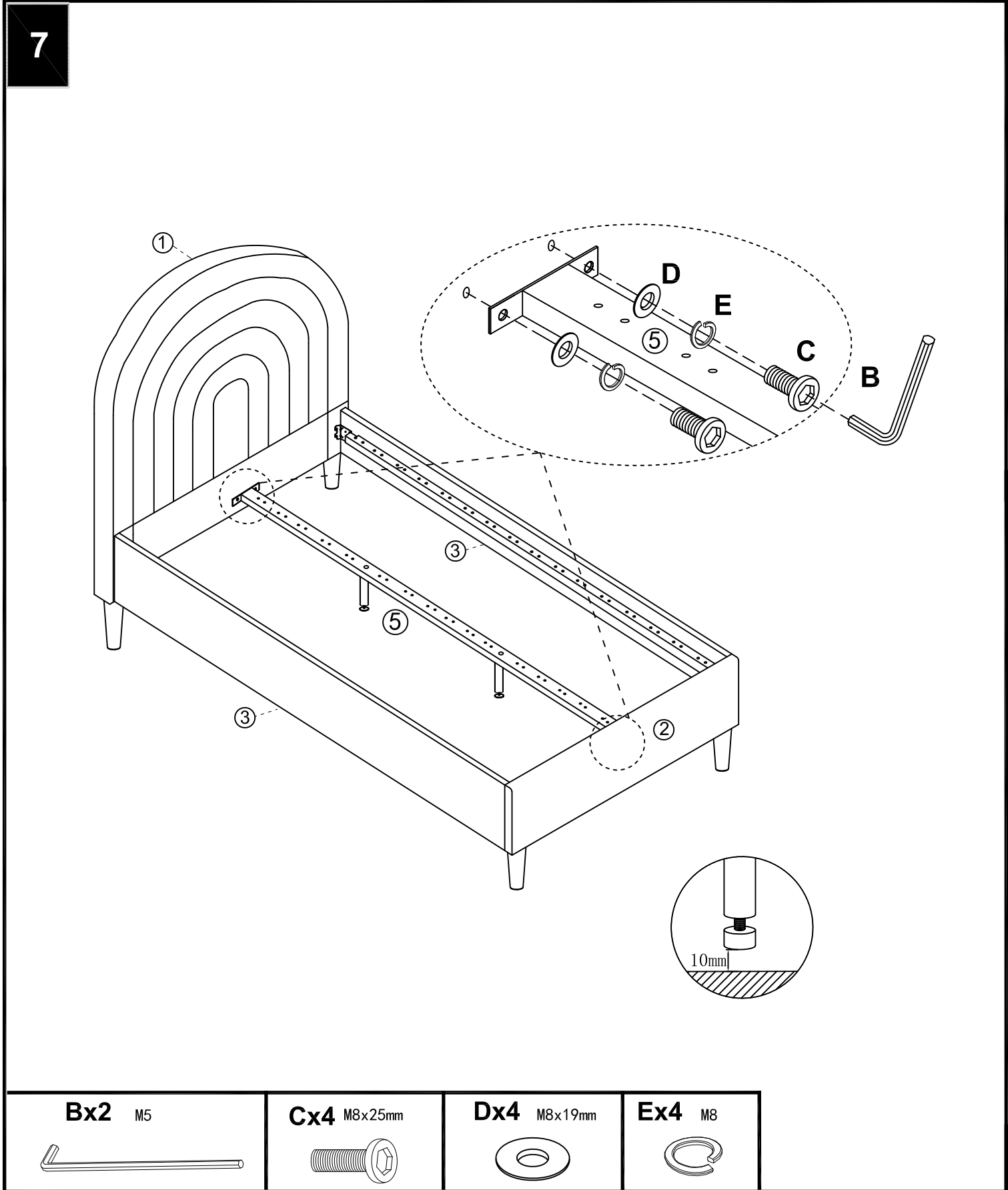

RAINBOW STANDARD BED

E22710/E22718

NEXT

Assembly instructions

8

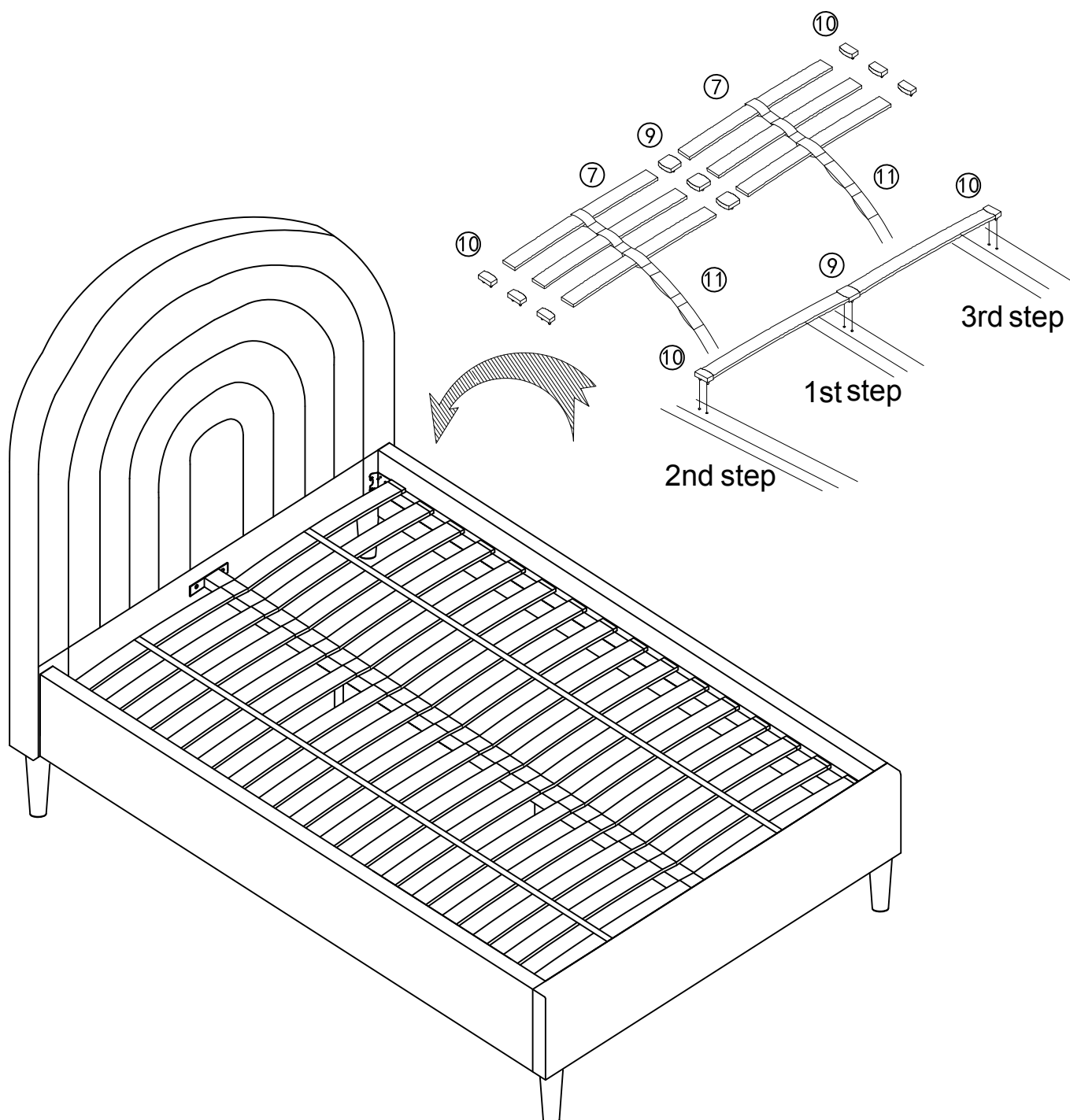

Warning: When you need to move the bed please lift it, do not drag it.

RAINBOW STANDARD BED

NEXT

E22710/E22718

Assembly instructions

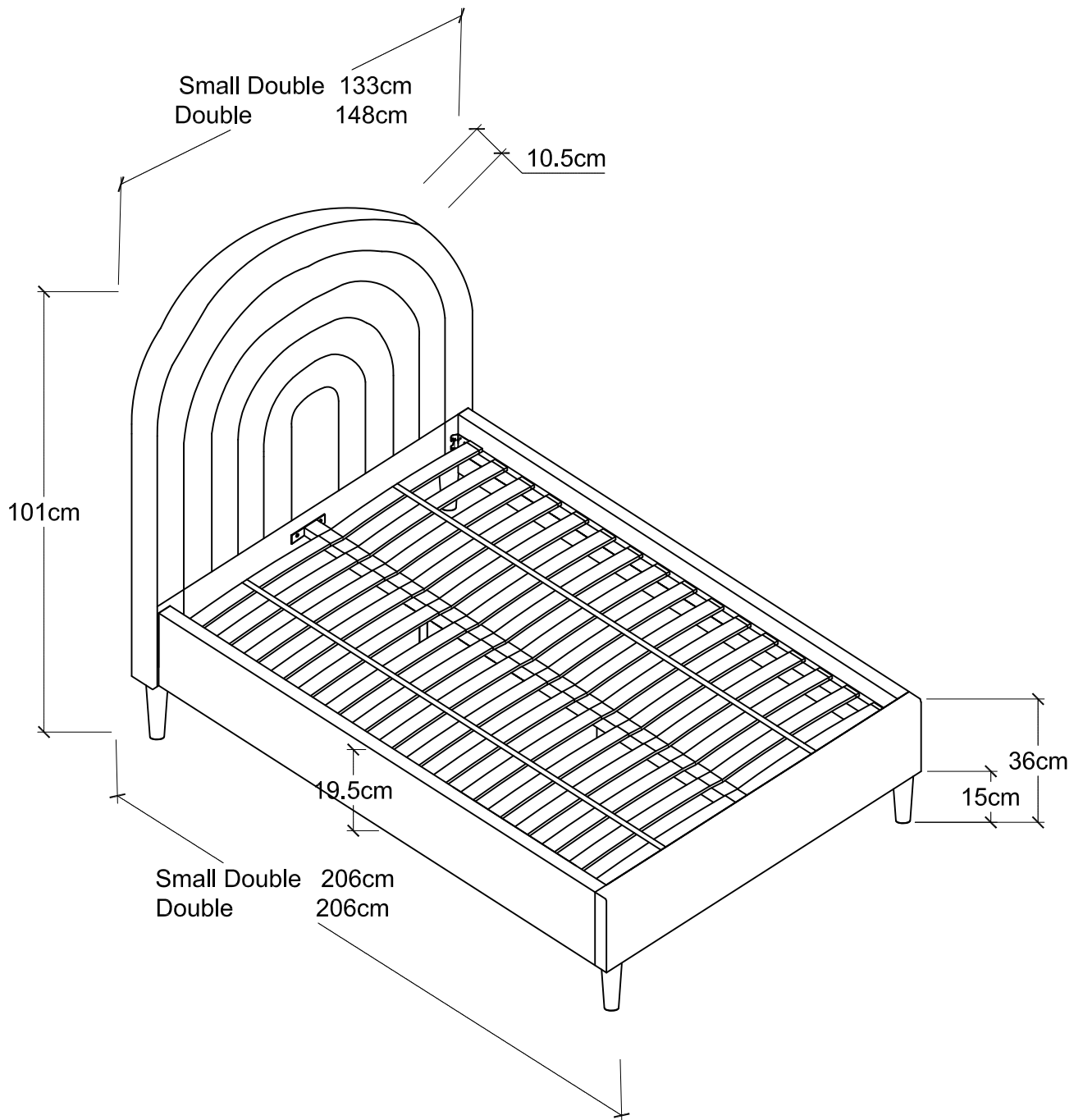

Assembly instructions

This child's bed conforms to BS8509:2008+A1:2011

WARNINGS

WARNING: All assembly fittings should always be tightened properly and checked periodically.

WARNING: Do not place this child's bed near heat sources, windows and other furniture.

WARNING: Do not use this child's bed if any part is broken, torn or missing.

WARNING: Assembly by adult only.

WARNING: Once assembled this bed is not designed to be disassembled and reassembled. Children are likely to play, bounce, jump and climb on beds, therefore the child's bed should not be placed too close to other furniture or windows, blind cords, curtain pulls or other strings or cords and should be placed either tight to any wall or have a gap of 300mm between the wall and the side of the bed.

WARNING: Not suitable for children under 4 years of age (junior beds only).

This size of the mattress to be used with the child's bed is 900mm x 1900mm .

This Child's bed is intended for children above 4 years old

Missing parts

If you are missing any fixtures and fittings for your product.
Please contact our customer service team on 0333 777 8999
and they will be happy to arrange for a replacement to be sent
to you free of charge.

Home service technicians

If you have a fault with your product, please contact our customer service team on 0333 777 8999. If you have had the product for 28 days or less you may be offered a replacement, refund or for a fully trained home service technician to visit your home to assess the fault and repair the product where possible. If you have had the product for more than 28 days we will send an independent home service technician to review and repair the product where possible and recommend further action.

You can write to us at

Home Customer Services
Next Retail Ltd.
Desford Road,
Leicester,
LE19 4AT

To view our full furniture range please visit www.next.co.uk