

# NEXT

## LAYTON 3LT

E76260  
Assembly instructions

**Actual product size:**  
H24.5 x DIAM 50cm

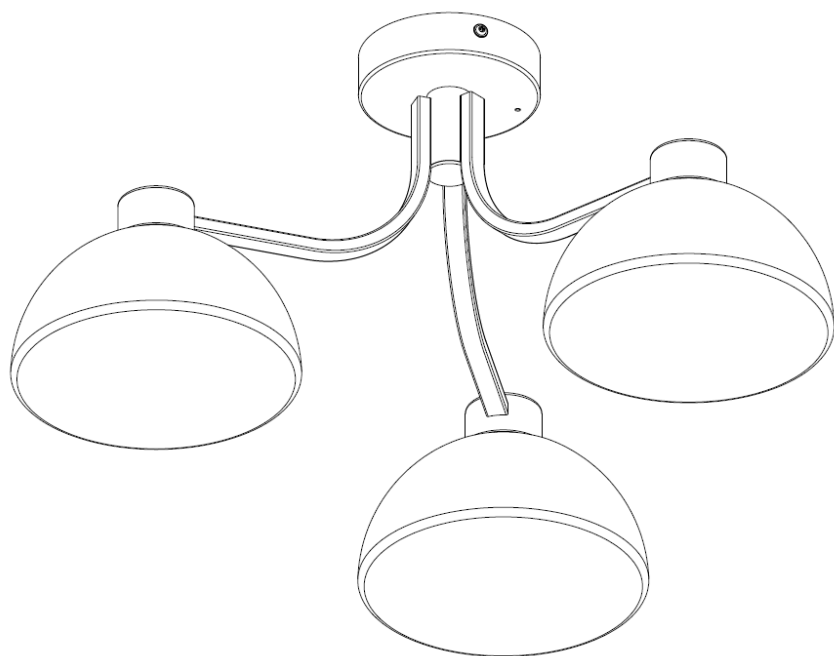

UK  
CA CE IP44

IMPORTANT – RETAIN FOR FUTURE REFERENCE

### Need Help?

With: Assembly instructions  
Missing or damaged parts

**CALL: 0333 777 8999**

# NEXT

## LAYTON 3LT

E76260  
Assembly instructions

### BEFORE YOU START

#### Warnings

We suggest you retain these instructions for future reference

For your safety, this product must be installed in accordance with local Building Regulations. If in any doubt, or required by the law, consult a competent person who is registered with an electrician self-certification scheme. Further information is available online or from your Local Authority

This light is suitable for indoor use only

Light fittings should be connected to a 5 amp fused circuit

Use Max 240 Volts 5 Watt LED G9 Bulb (Not included)

Before commencing installation, isolate the circuit to be used by removing the fuse or circuit breaker at the consumer distribution unit

#### Do's

We suggest you spend a short time reading through this leaflet before you start

When you are ready to start, make sure that you have the right tools and plenty of space

Unwrap all packaging materials and place the components on top of the carton box or on a clean floor to protect it from damage

We recommend that the packaging is used to protect the surfaces during assembly

Carefully check that you have all the parts before beginning assembly

Ensure the product is fully assembled as illustrated and all fixings fully tightened before use. Check fixings regularly to ensure they remain tight

Always switch off the supply before changing light bulbs or cleaning

Allow bulbs to cool down before handling

#### Don'ts

The fitting should not be fixed to newly painted or plastered surfaces as this may cause discolouration of the finish

We recommend cleaning with a soft dry cloth, do not use abrasive materials as these will rub away the protective coating

#### Number of people required to assemble

One person who is competent with electrical wiring and installation, however we do recommend that this item is installed by a qualified electrician

#### Time to assemble



**20 mins**

#### Tools required



Cross Head Screwdriver (Not supplied)



Flat Screwdriver (Not supplied)



Scissors (Not supplied)

#### Missing parts

If you are missing any fixtures and fittings for your product please contact our customer service team on 0333 777 8999 and they will be happy to help.

#### Cleaning Care

We recommend cleaning with a soft dry cloth. Do not use abrasive materials as these will rub away the protective coating.

#### Safety information

For your safety, please remember the following:

- Always switch off the power supply before changing lightbulbs or cleaning
- Allow bulbs to cool down before handling.

#### You can write to us at

Home Customer Services  
Next Retail Ltd,  
Desford Road,  
Leicester,  
LE19 4AT

Next retail (Ireland) Ltd  
13-18 City Quay,  
Dublin 2,  
D02 ED70

**To view our full range please visit**  
**[www.next.co.uk](http://www.next.co.uk)**

GETTING TO KNOW YOUR PRODUCT

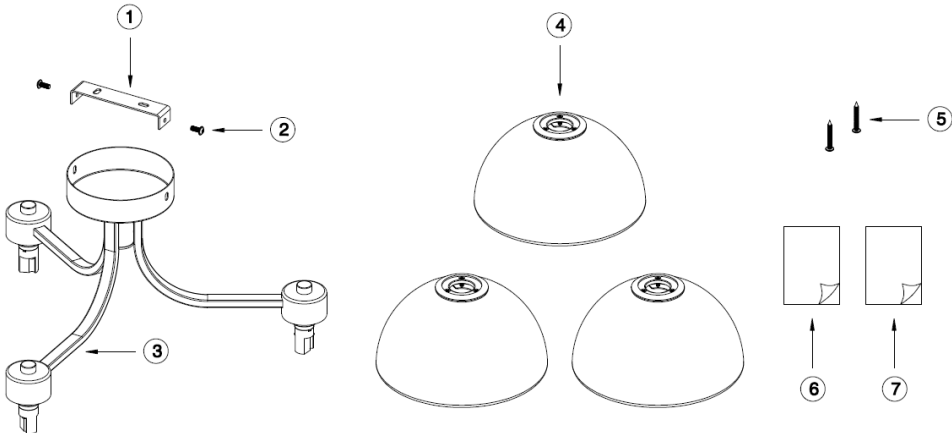

Ref	Description	Specification	Qty	Remark
1	Fixing bracket	L96 x W20 x H15mm	1	Attached on light fitting
2	Screw	PWM4 x 8mm	2	Attached on light fitting
3	Light fitting	H24.5 x DIAM 50cm	1	Package in carton
4	Glass shade	D160 x H90mm	3	Package in carton
5	Screw	PA4 x 35mm	2	Package in fixing pack
6	Assembly instructions	A5	1	Package in fixing pack
7	Re-package instructions	A4	1	Package in fixing pack

1

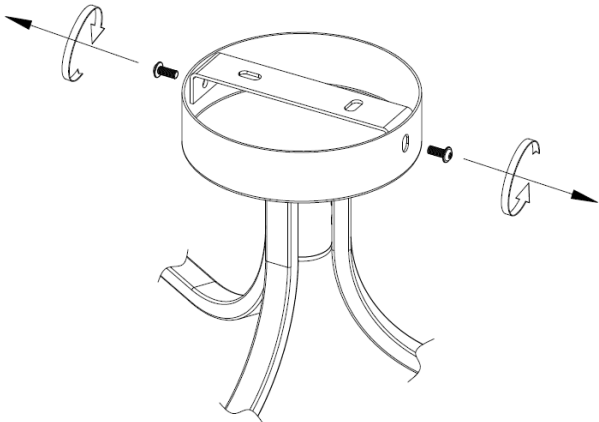

Step 1:  
- Remove the fixing bracket from the ceiling cup.

2

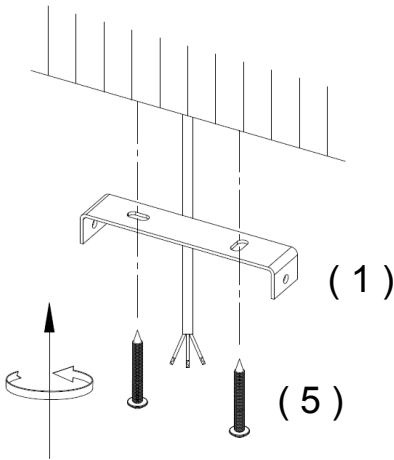

Step 2:  
- Attach the fixing bracket to the ceiling.  
- Make sure the screws penetrate a ceiling joist by at least 25mm.

3

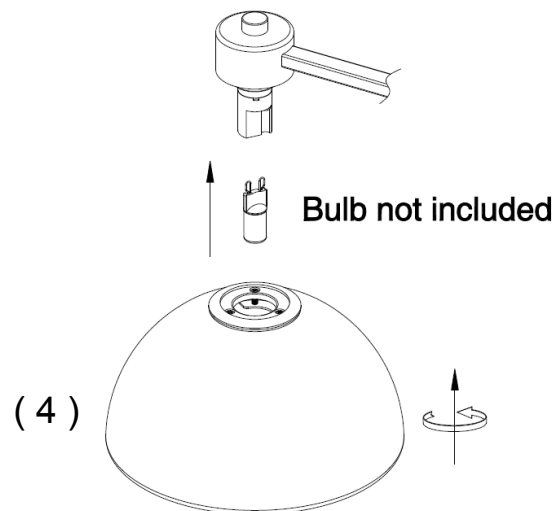

Step 3:

- Insert the bulb to the lampholder. Use Max 240 Volts 5 Watt LED G9 Bulb.
- Screw the glass shade to the lampholder.

4

Light fitting flex

Household circuit

Blue or wire marked "N".....Connect to....Black or Blue (Neutral)  
Green/Yellow or wire marked "⊕" .....Connect to....Green/Yellow-sleeved Copper (Earth) ⊕  
Brown or wire marked "L".....Connect to....Switched live

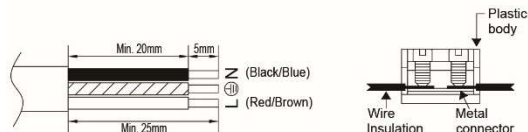

- When you are ready to connect your fitting to the electricity supply, carefully remove any heat shrinkable film around the terminal block using a pair of scissors. Take care not to damage the wiring or terminal block while removing the sleeve.
- Open the terminal box, take the waterproof rubber out, use the sharp tool to drill the hole in the middle of waterproof rubber, then let the cable go through and connect to the terminal like above diagram.
- Ensure that connections are tight and that no loose strands are left out of the connectors, then close the terminal box.
- This product must be earthed – if no earth wire (Green/Yellow wire) is available, consult an electrician.

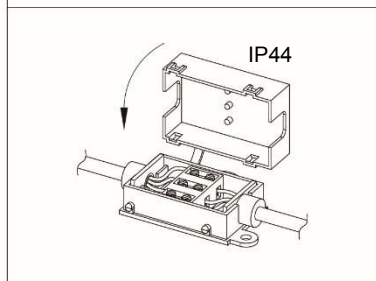
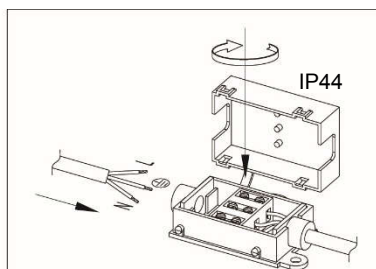

5

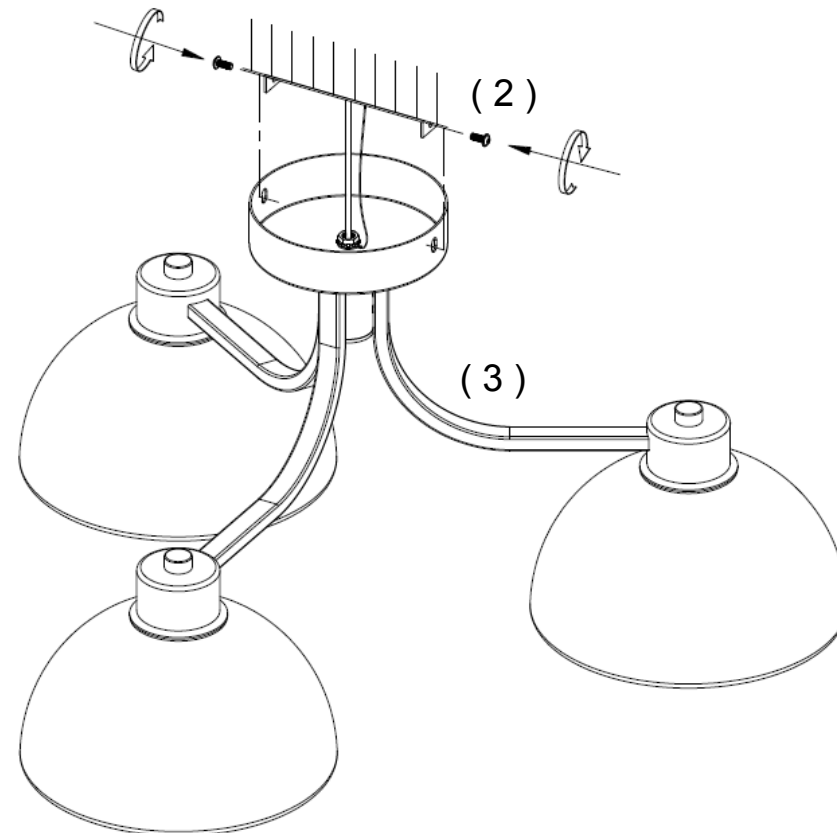

Step 5:

- Secure the ceiling cup to the mounting bracket by tighten the side screws.

# NEXT

## LAYTON 3LT

E76260  
Assembly instructions

**Actual product size:**

H24.5 x DIAM 50cm

