

T43150 BRONX TOWEL RAIL SHELF

next

Tools Needed

One person assembly

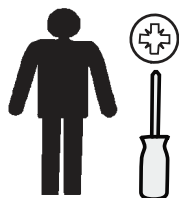

Helpline

If you have any problems with this product please contact:

Customer Services Tel: 0333 777 8185

Assembly Instructions

Please keep these instructions for future reference

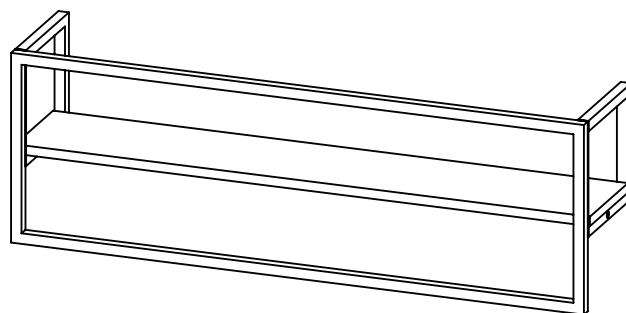

Should you need to return the unassembled product, please repack in its original packaging.

Important

- We suggest you spend a short time reading through this leaflet and then follow the simple step-by-step instructions.
- Carefully check that you have all the parts before beginning assembly.
- Keep fittings out of children's reach and keep children well away from construction area.
- We suggest you retain these instructions for future reference.
- Maximum weight load of each shelf 3kg (6.6lb) .

Product Information

- Made in China.
- Made with powder coated steel and wood panels.

Care Instructions

- Clean with soap and water only and clean the product thoroughly.
- Do not rub or scrub the surface when cleaning.
- Do not use any cleaning agents containing solvents, acids or any scouring agents or scrubbing sponges.

WARNING

- WARNING Please check for hidden pipes and wires before drilling, if in doubt consult a qualified tradesman.

NB: Wall fixings are not included-please source suitable fixing for your wall type. If in doubt consult a qualified tradesman.

Next Retail Ltd, Desford Road, Leicester. LE19 4AT

Next Retail (Ireland) LTD, D02 ED70

Page 1 of 4

Fittings

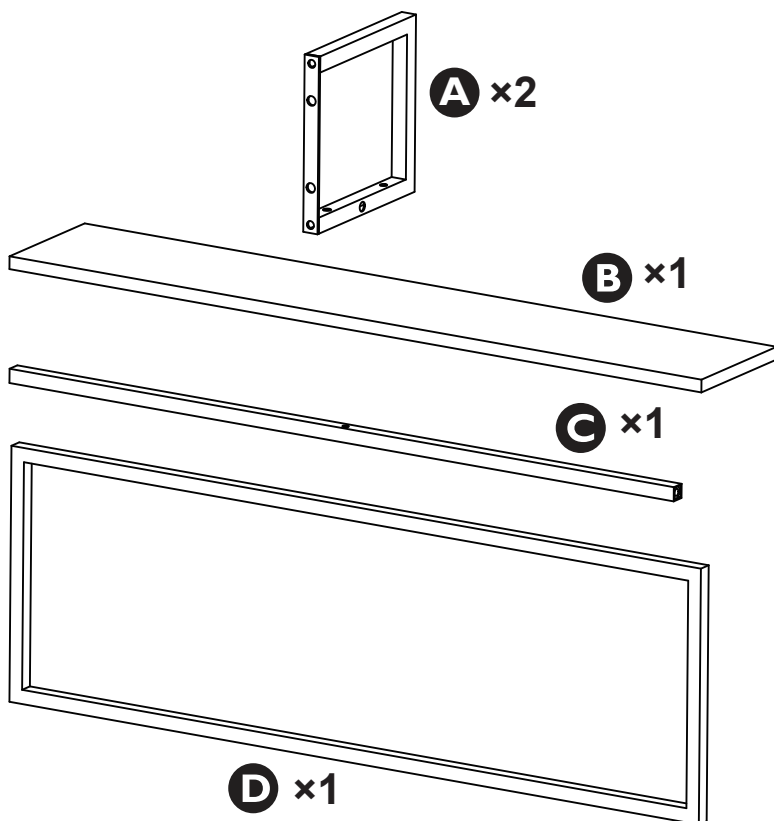

E x4
(Extra x1)

F x2
(Extra x1)

G x1

H x5
(Extra x1)

x4
(Not supplied)

Assembly Diagram

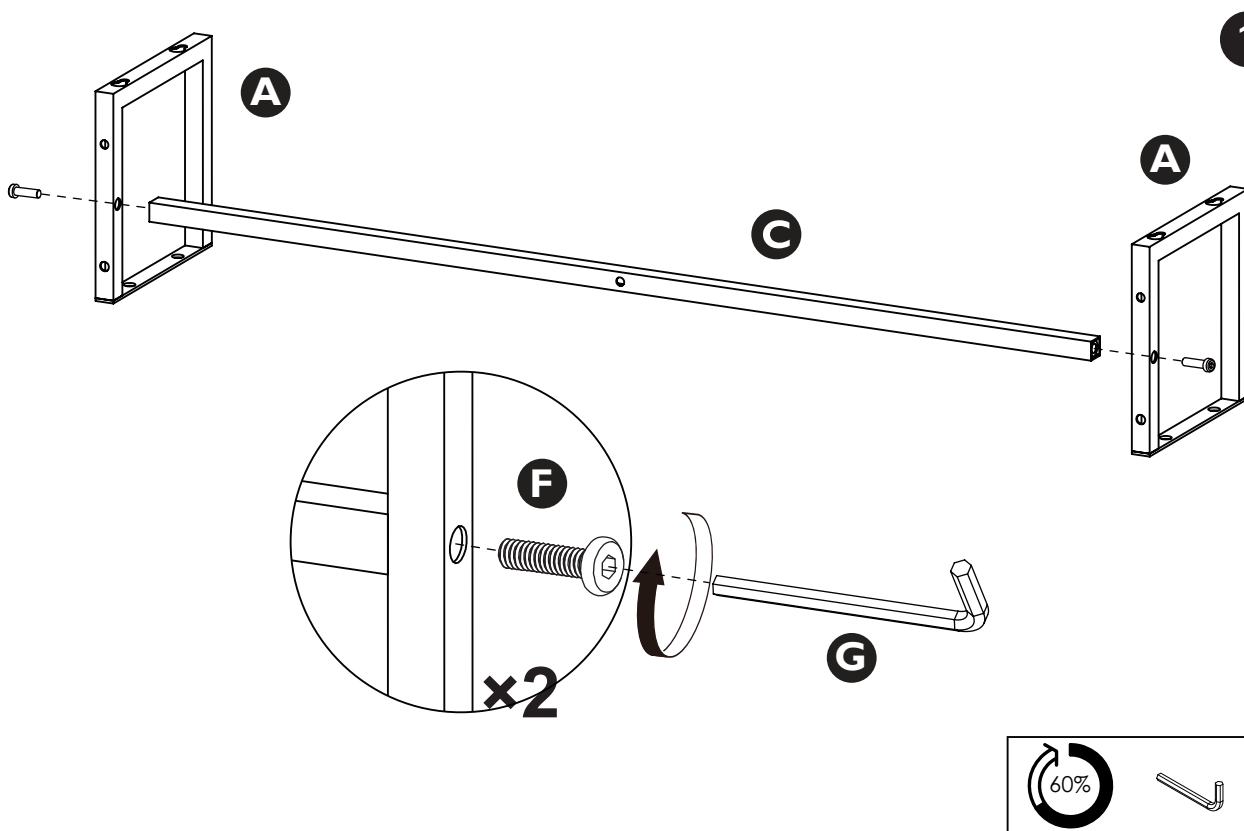

Assembly Diagram

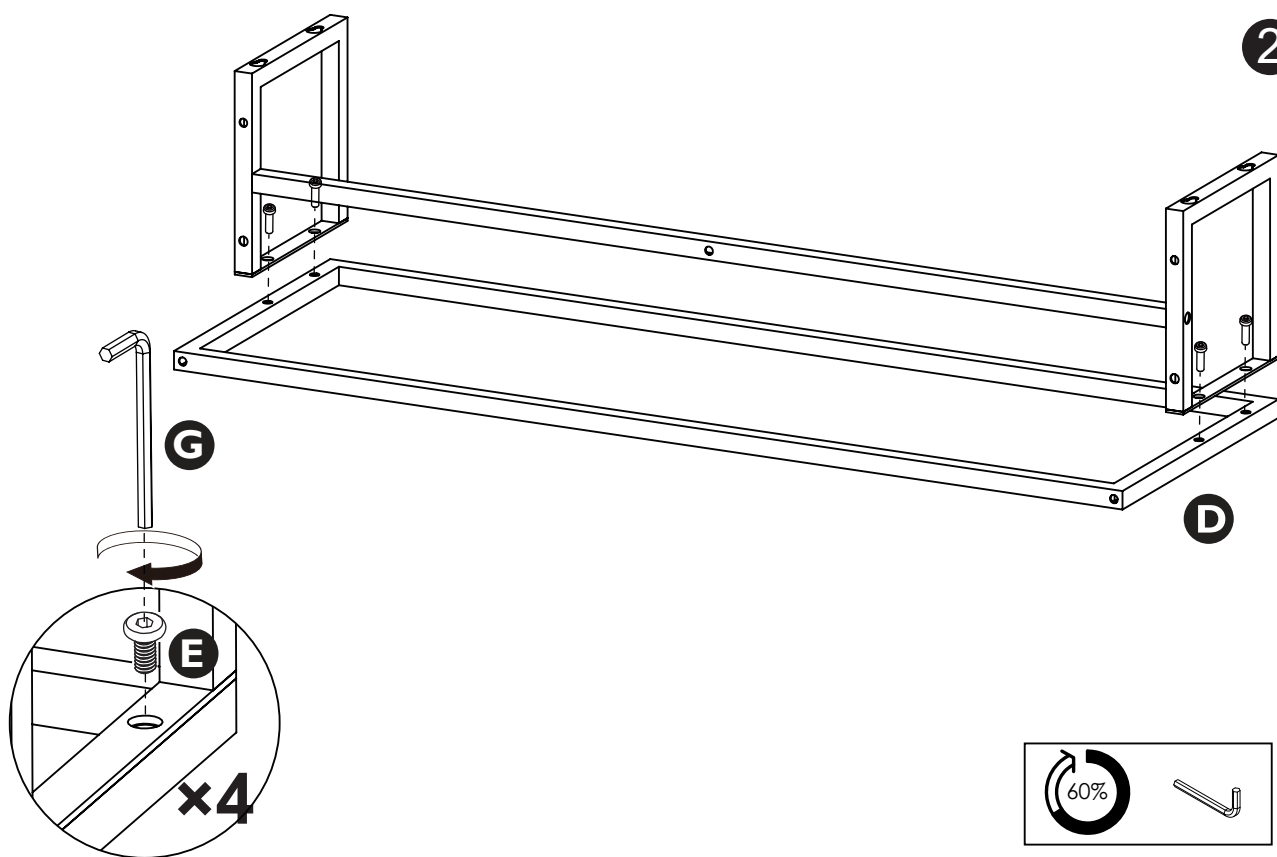

Assembly Diagram

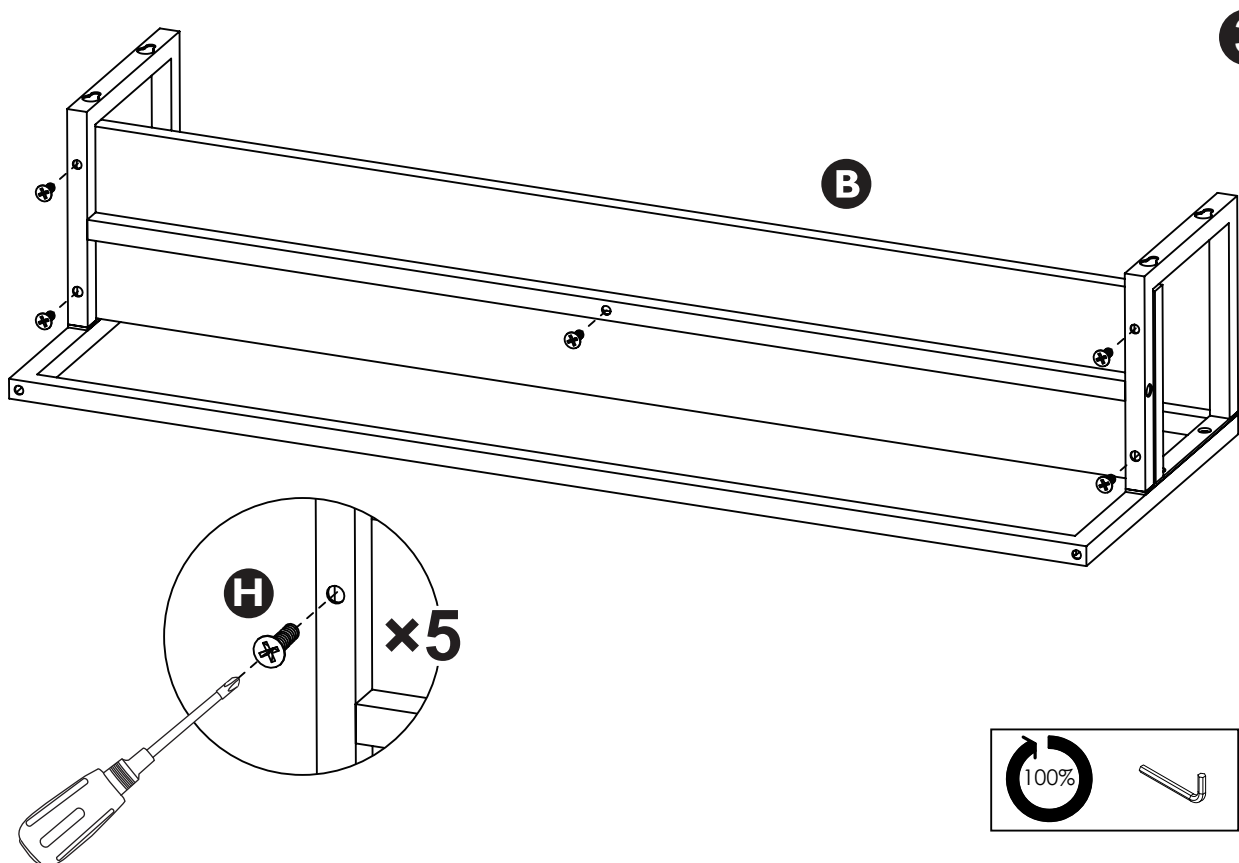

Assembly Diagram

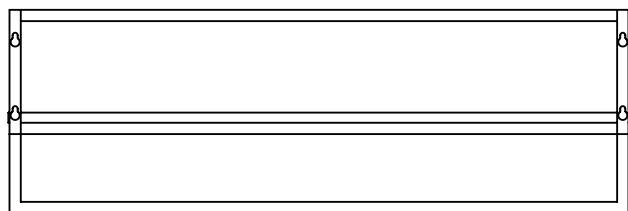

1

Mark drill holes in the desired position.

Use a spirit level to check that the fixings are level.

spirit level

not supplied

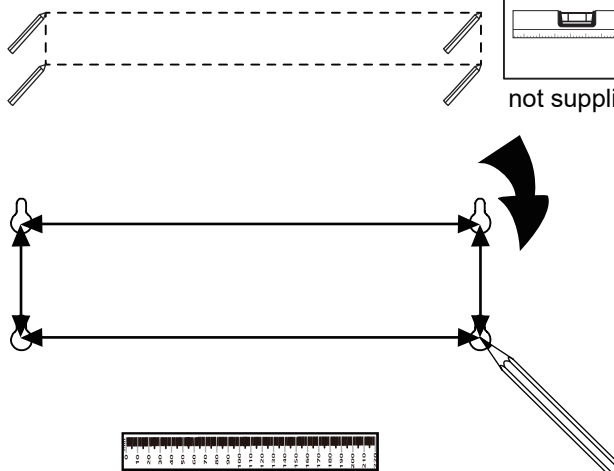

2

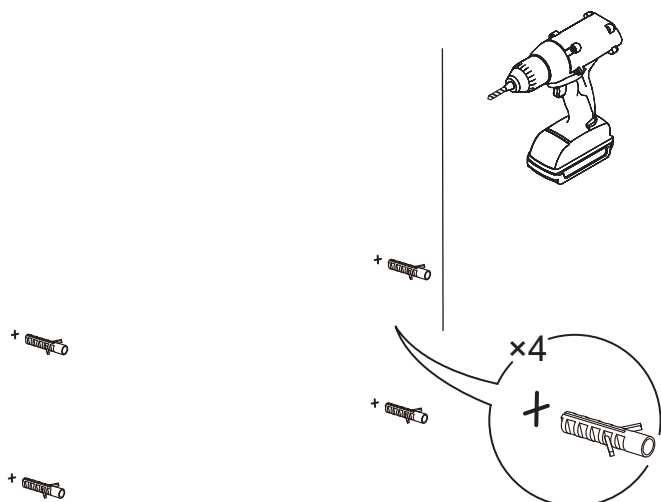

3



4

