

BEFORE YOU GET STARTED...

*We're confident you'll love your gorgeous new Next furniture. However, it's worth making absolutely certain before you put it all together.
So, let's quickly run through these three steps:*

1. COLOUR

Make sure you're happy with the colour
No need to unpack everything, just check the first component.

2. PROTECTIVE PACKAGING

If you're happy, then it's time to get opening! Start by laying everything out on the protective packaging – this will prevent anything getting scratched.

3. PARTS PAGE

Finally, double check you have all the pieces by referencing the parts page of the instructions.

TIPS FOR RETURNS

Not completely happy with the product? No problem.
We just need everything back in the original packaging, so follow the steps below and this will ensure a super-smooth returns process and no delay to your refund.

DO



- Check everything is there (the 'parts page' is a handy checklist).
- Pop all the loose fittings and fixtures into the packaging provided or tie them up in a plastic bag.
- Wrap all the big components back up in the original protective packaging.
- Close up the box and seal it securely (don't be afraid to use plenty of tape).

DON'T



- Leave anything assembled - all components should be dismantled and separately packed.
- Put loose fixtures and fittings straight into the box.
- Throw it back in the box carelessly – as it may get damaged.

**NEXT
HOME**

Then just give us a call on 0333 777 8999 and we'll sort out a pick up time for you.

NEXT

MATSON STANDARD BED

W78580

Assembly instructions

Actual product size

Small Double W132cm X L205cm X H104.5cm

Double W147cm X L205cm X H104.5cm

King W162cm X L215cm X H104.5cm

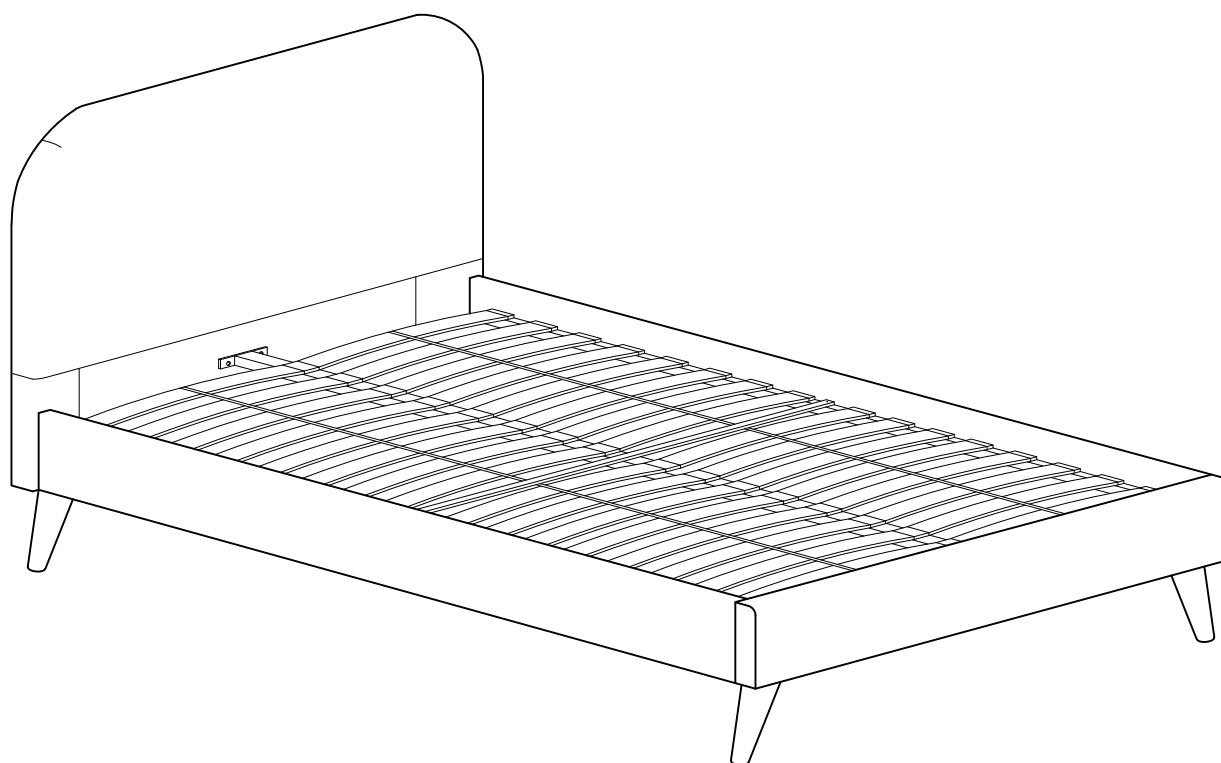

Item number	Fabric name	Fabric composition
W78580	Alaska Faux Fur Leopard	100% polyester

IMPORTANT - RETAIN FOR FUTURE REFERENCE

Need Help?

With: Assembly Instructions
Missing or damaged parts
CALL: 0333 777 8999

Assembly instructions

BEFORE YOU START

Warnings

We suggest you retain these instructions for future reference.

Keep fittings out of children's reach and keep children well away from construction area.

This product should only be used on firm level ground.

Please periodically check all fittings and re-tighten as necessary.

Please do not stand on your bed.

Avoid exposing the furniture to excessive heat or direct sunlight as this can cause damage to the materials and deterioration of the colour.

Do's

We suggest you spend a short time reading through this leaflet before you start.

When you are ready to start, make sure that you have the right tools, plenty of space.

Due to the size of this product we recommend that it is assembled in the room intended for use.

Unwrap all packaging materials and place the components on a clean surface to protect them from damage.

We recommend that the packaging is used to protect the surfaces during assembly.

Carefully check that you have all the parts before beginning assembly.

Ensure the product is fully assembled as illustrated and all fixings are fully tightened before use. Check fixings regularly to ensure they remain tight.

When moving the assembled bed, remove mattress, and lift the bed. Do not drag the bed, as this can cause structural damage. Please check that the centre support rail is securely fixed in place.

When adjusting the support legs ensure that the foot is set 5mm from the floor surface without the mattress in place. When in use the legs will create the required support for the product.

Never allow any kind of liquid to remain on your furniture. Absorption can cause materials to warp or finishes to de-laminate.

To clean your item, please use a vacuum or lightly brush clean. Never allow any kind of liquid to remain on your furniture. Absorption can cause finishes to de-laminate.

Don'ts

Do not tighten screws until fully assembled.

Do not over tighten screws or bolts.

Do not drag or pull your furniture.

Do not use this product if parts are missing, damaged or worn.

Never use scourers, abrasives or chemical cleaners.

Number of people required to assemble

Two people are required to assemble this item



Time to assemble :1.5 hours



Tools required

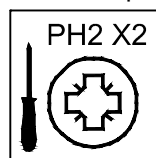

not supplied

Missing parts

If you are missing any fixtures and fittings for your product please contact our customer service team on 0333 777 8999 and they will be happy to arrange for a replacement to be sent to you free of charge.

Home service technicians

If you have a fault with your product please contact our customer service team on 0333 777 8999. If you have had the product for 28 days or less you may be offered a replacement, refund or for a fully trained home service technician to visit your home to assess the fault and repair the product where possible.

If you have had the product for more than 28 days we will send an independent home service technician to review and repair the product where possible and recommend further action.

You can write to us at

Home Customer Services
Next Retail Ltd,
Desford Road,
Leicester,
LE19 4AT,

To view our full furniture range please visit www.next.co.uk

Assembly instructions

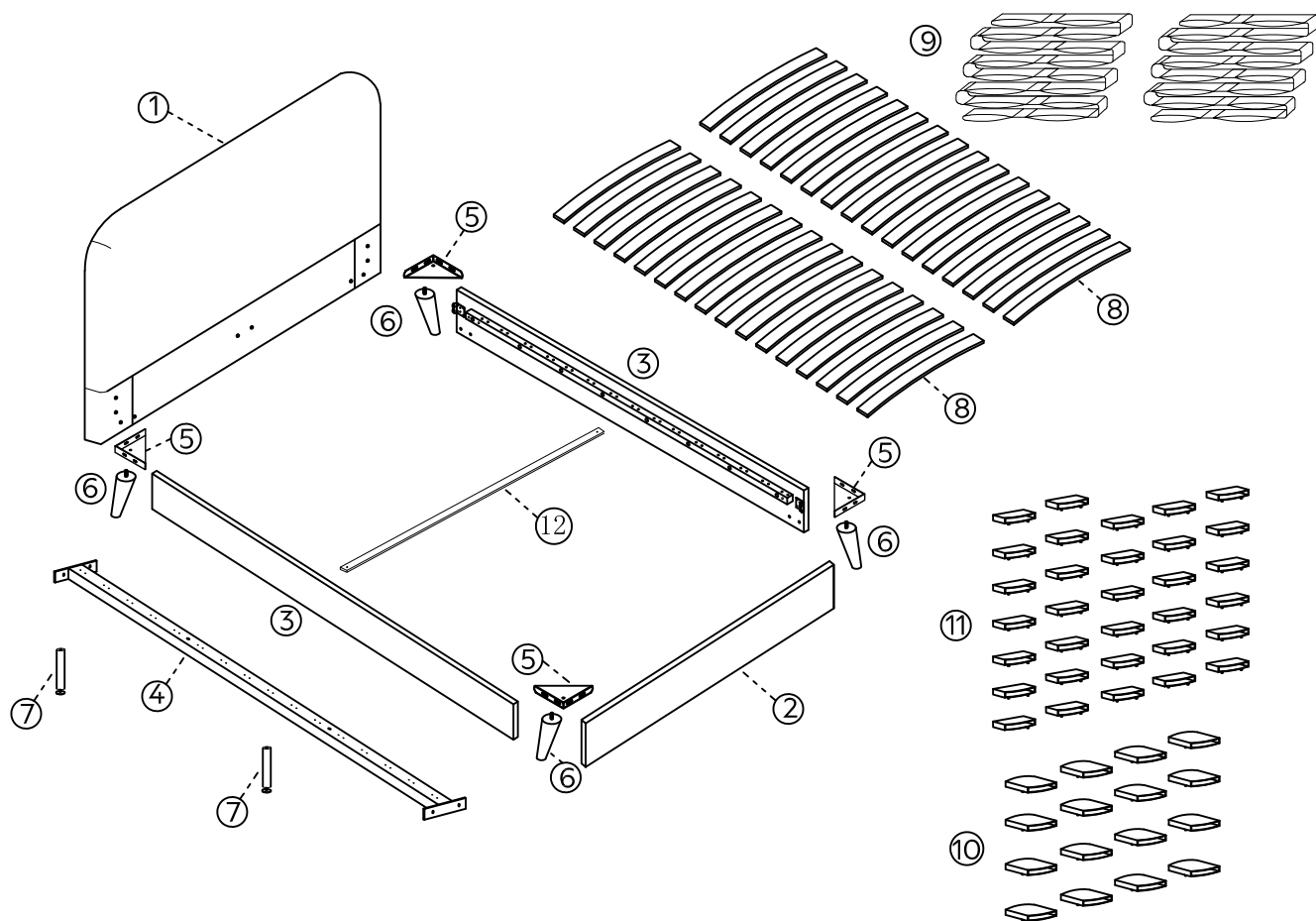

Components supplied. Please use this guide if you require replacement parts.

Ref	Dimensions	Visual	Qty	Ctn
1	Headboard Small Double 132x86cm Double 147x86cm King 162x86cm		1	1
2	Footboard Small Double 129x19cm Double 144x19cm King 159x19cm		1	2
3	Side Rails Small Double 192x18cm Double 192x18cm King 202x18cm		2	2
4	Center Rail Small Double 192x9cm Double 192x9cm King 202x9cm		1	2
5	Brackets (18x18x4cm)		4	2
6	Feet (Ø5x19cm)		4	2

Ref	Dimensions	Visual	Qty	Ctn
7	Support legs (Ø2x29cm)		2	2
8	Slats Small Double 60x6cm Double 68x6cm King 75x6cm		Small Double 30 Double 30 King 32	3
9	Belts for slat Small Double 181x3cm Double 181x3cm King 195x3cm		2	2
10	Centre Plastic Cap (Big)		Small Double 17 Double 17 King 18 (2pcs spare part included)	2
11	End Plastic Cap (Small)		Small Double 32 Double 32 King 34 (2pcs spare part included)	2
12	Wooden Cross Rail Small Double 122x4cm Double 137x4cm King 152x4cm		1	2

Assembly instructions

Ref	Dimensions	Qty
WLG130	M8x25mm	8
WBS12	M5x90mm	2
WLG108	M8x25mm	22
WDP17	Plastic Washers Ø50x3.5mm	4
WDP22	M8x19mm	26
WDP23	M8	8
WLM24	M8	4
WBS13	Ø13	2
WLS14	M8x32mm	2
WBZB12	Felt pad 40x20x3mm	1

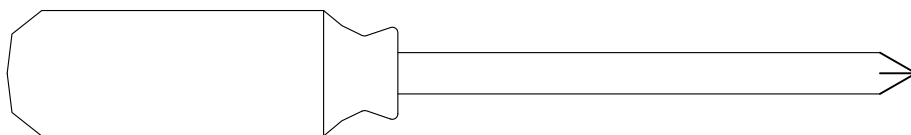
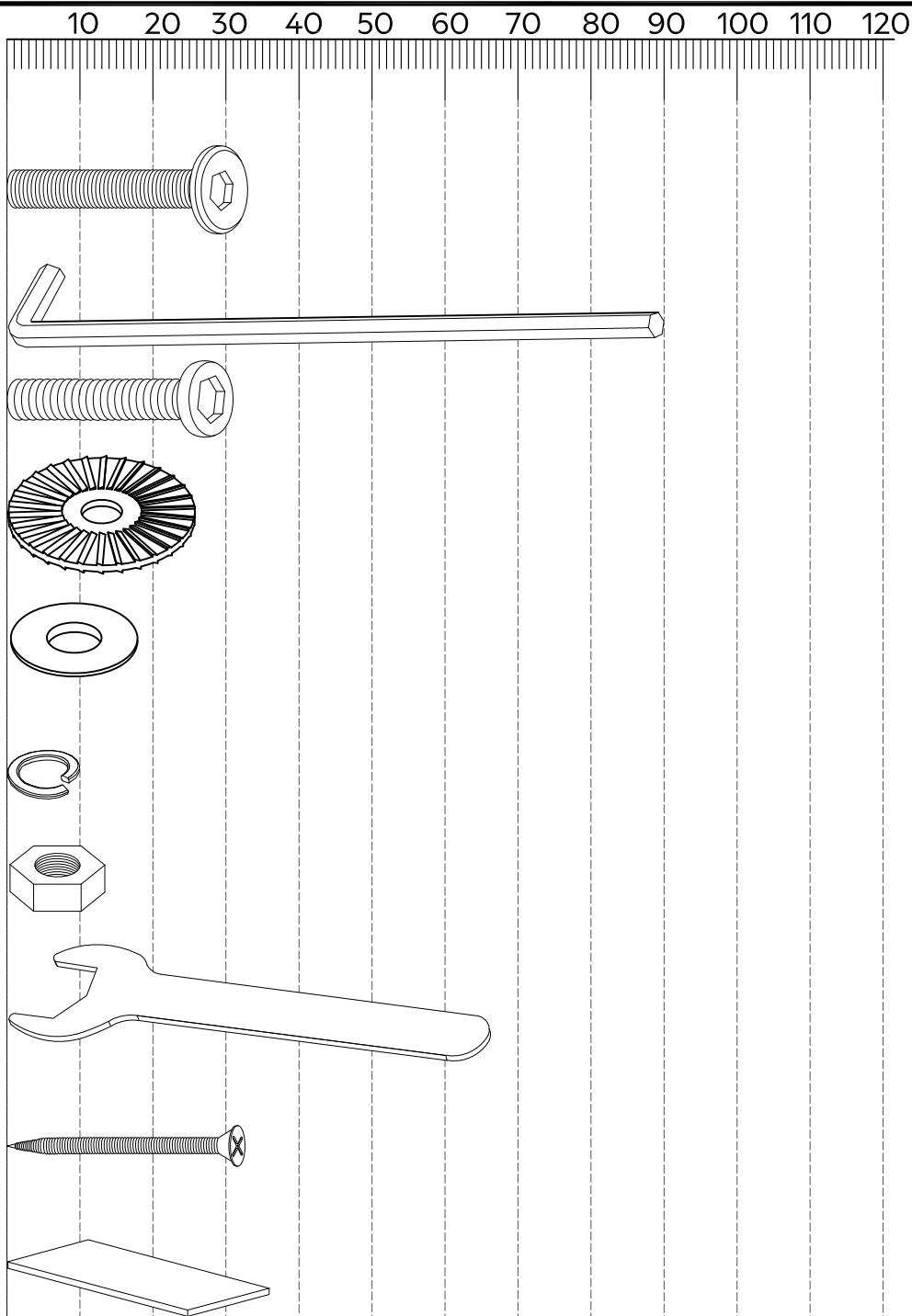

PH2x2 NOT SUPPLIED

Assembly instructions

1

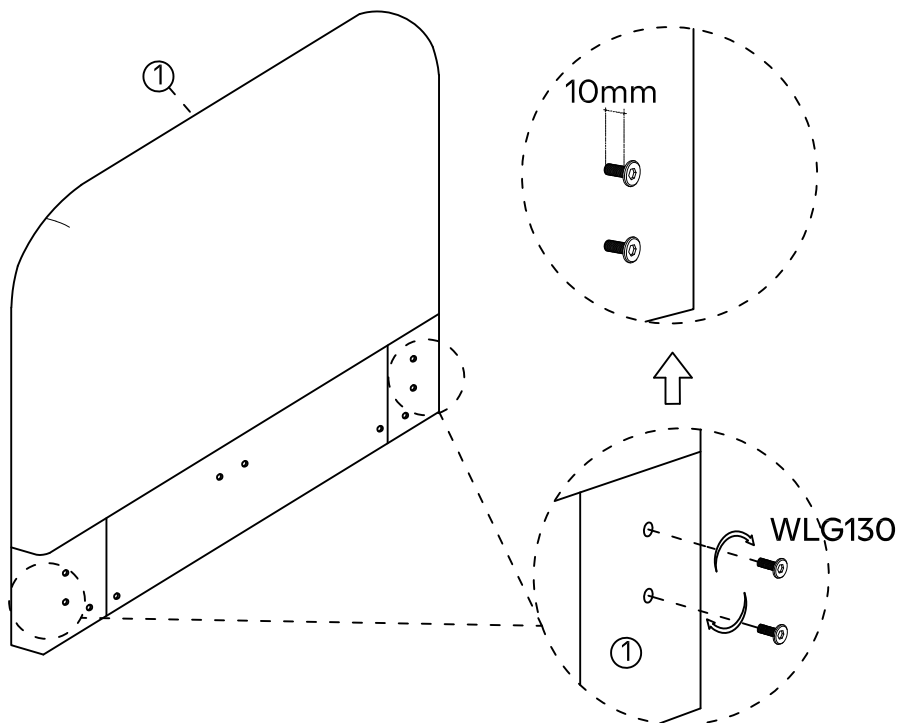

WLG130x4
M8x25mm

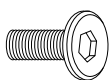

2

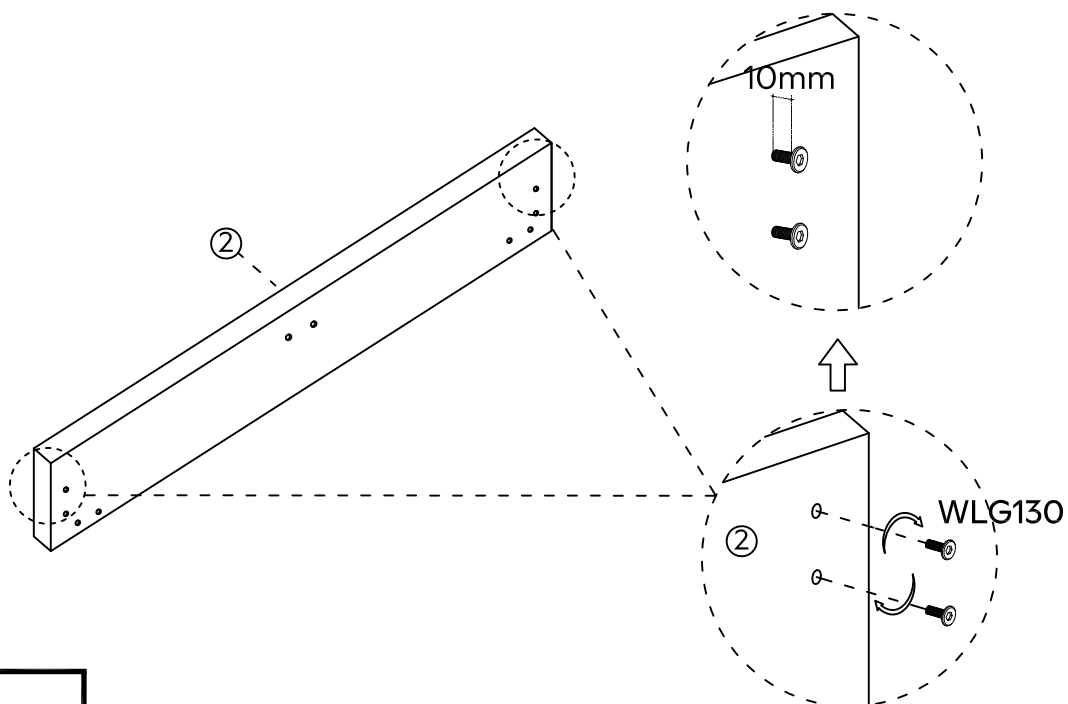

WLG130x4
M8x25mm

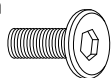

Assembly instructions

3

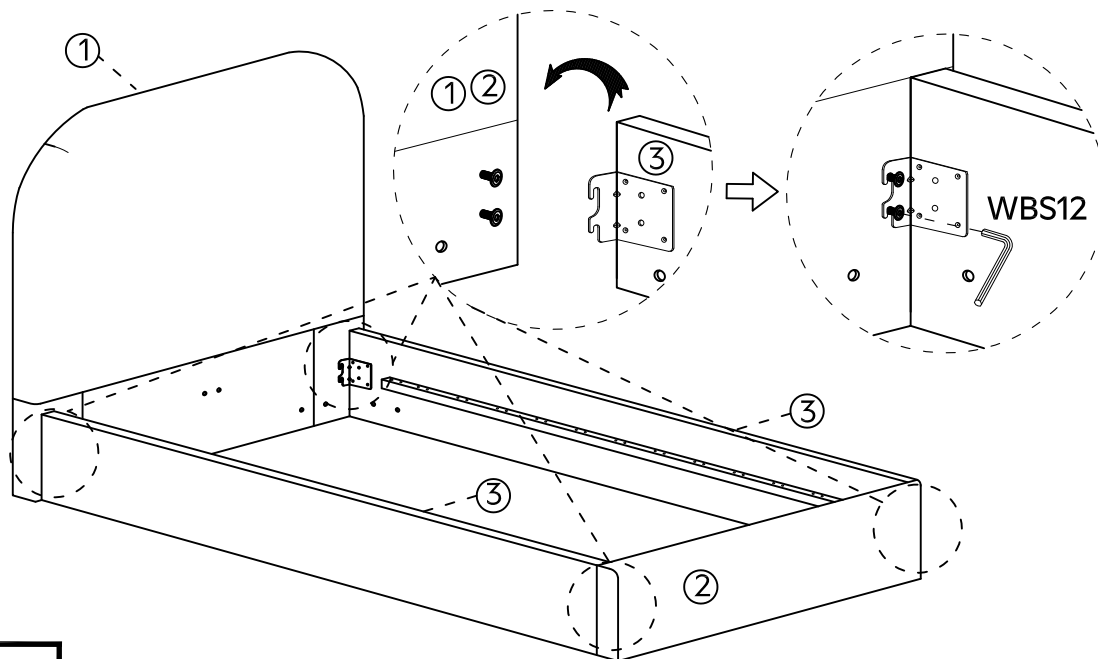

WBS12x2
M5x90mm



4

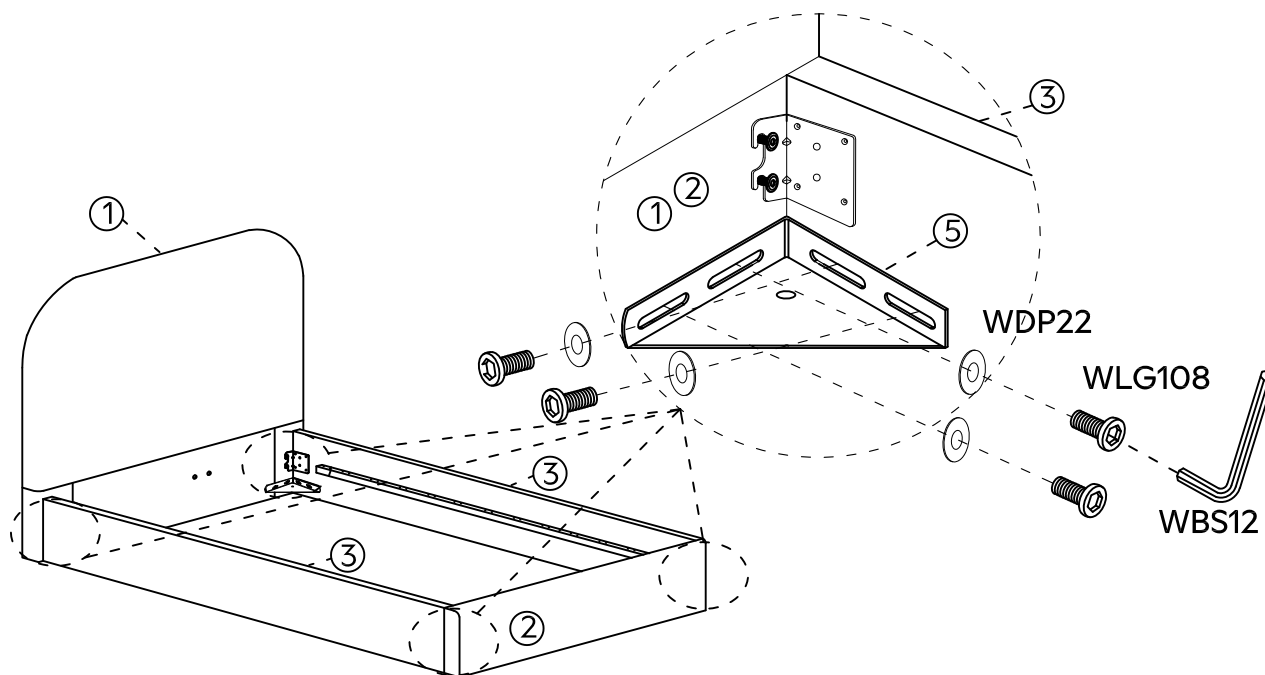

WBS12x2
M5x90mm



WLG108x16
M8x25mm

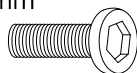

WDP22x16
M8x19mm



Assembly instructions

5

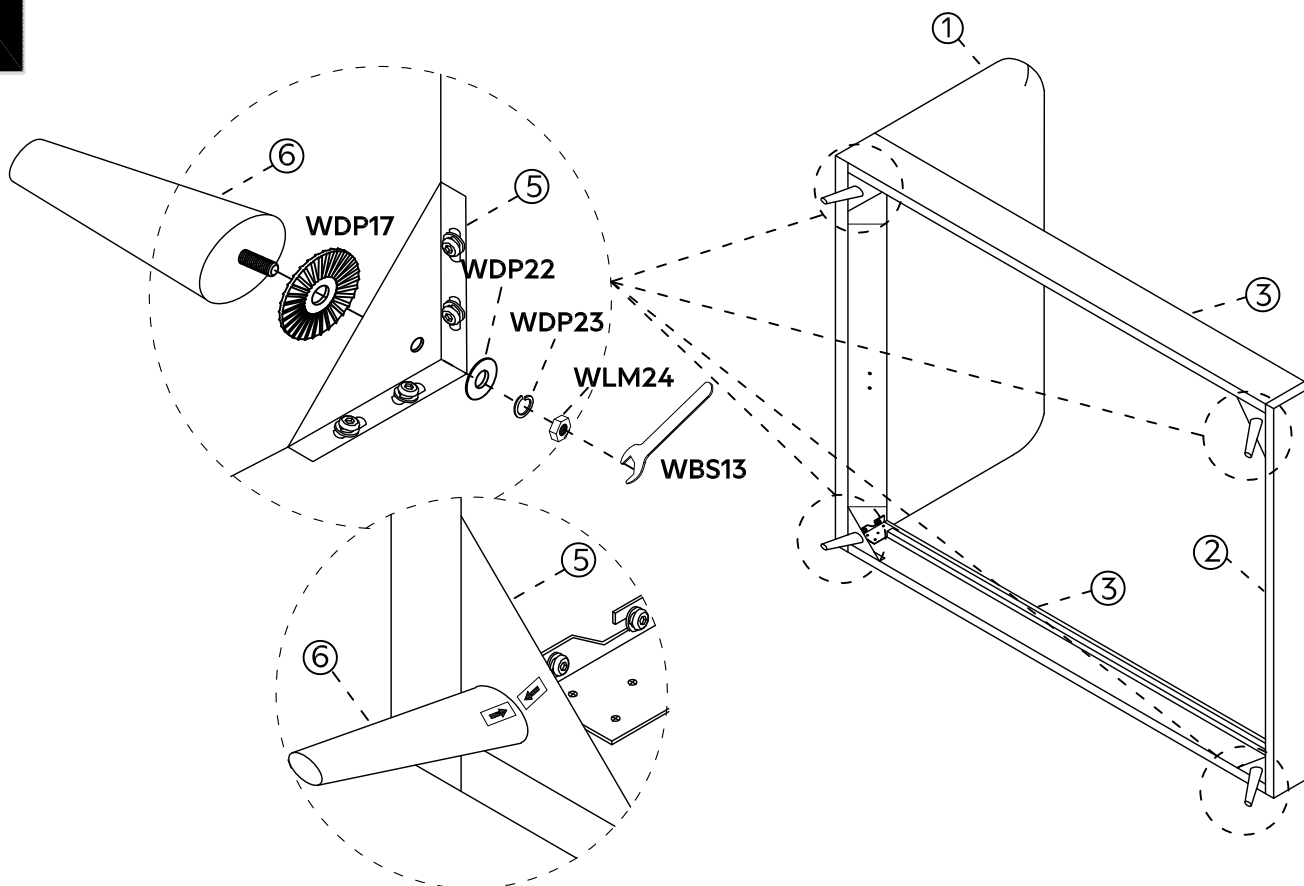

WDP17x4
Ø50x3.5mm



WDP22x4
M8x19mm



WDP23x4
M8



WLM24x4
M8



WBS13x2
Ø13



6

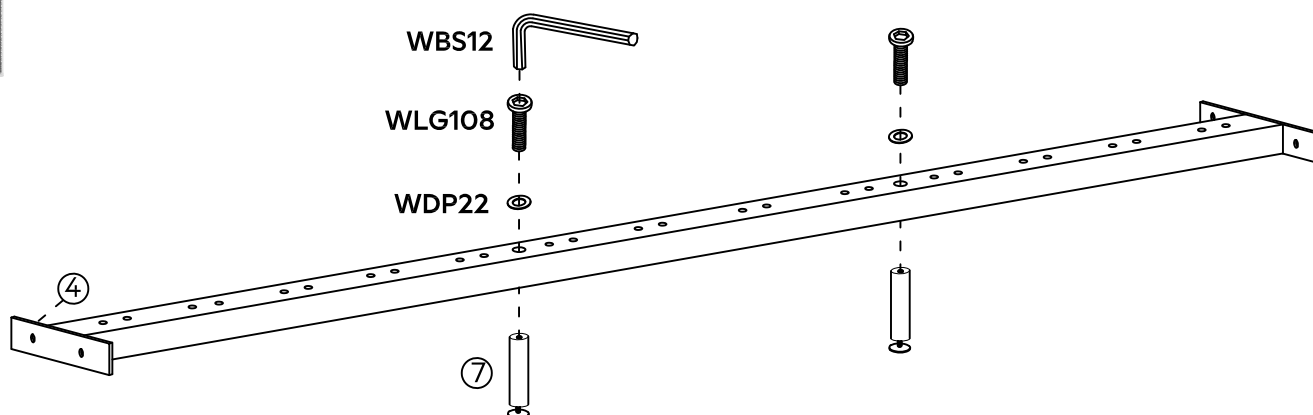

WBS12x2
M5x90mm



WLG108x2
M8x25mm

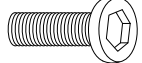

WDP22x2
M8x19mm



7

Fully tighten all the bolts at this stage.

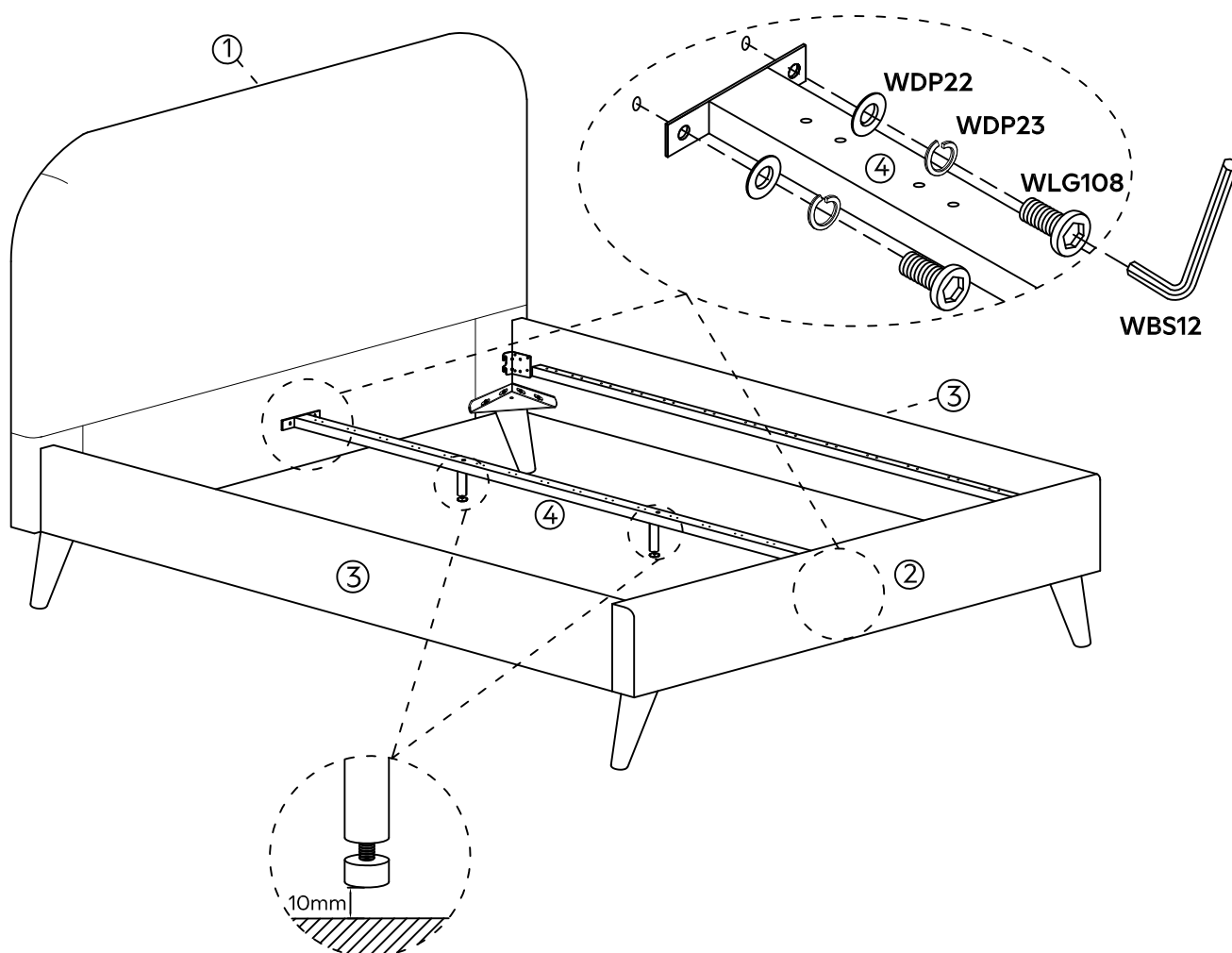

WBS12x2
M5x90mm



WLG108x4
M8x25mm

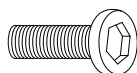

WDP22x4
M8x19mm

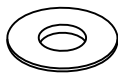

WDP23x4
M8



Assembly instructions

8

Periodically check the condition of your bed slats and plastic locating caps to ensure they are in good condition and have not become loose.

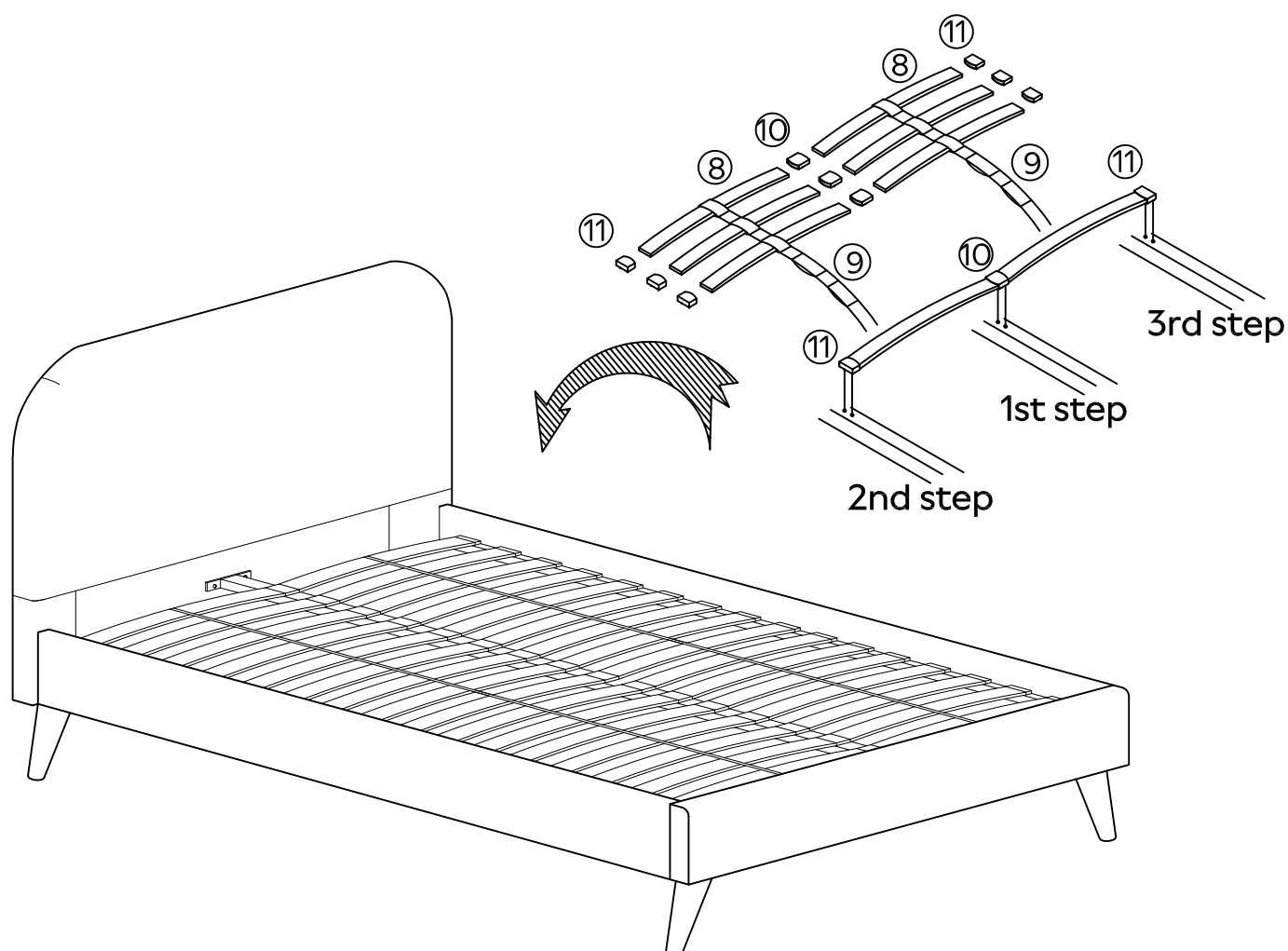

Warning: When you need to move the bed, please lift it, do not drag it.

Assembly instructions

9

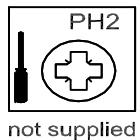
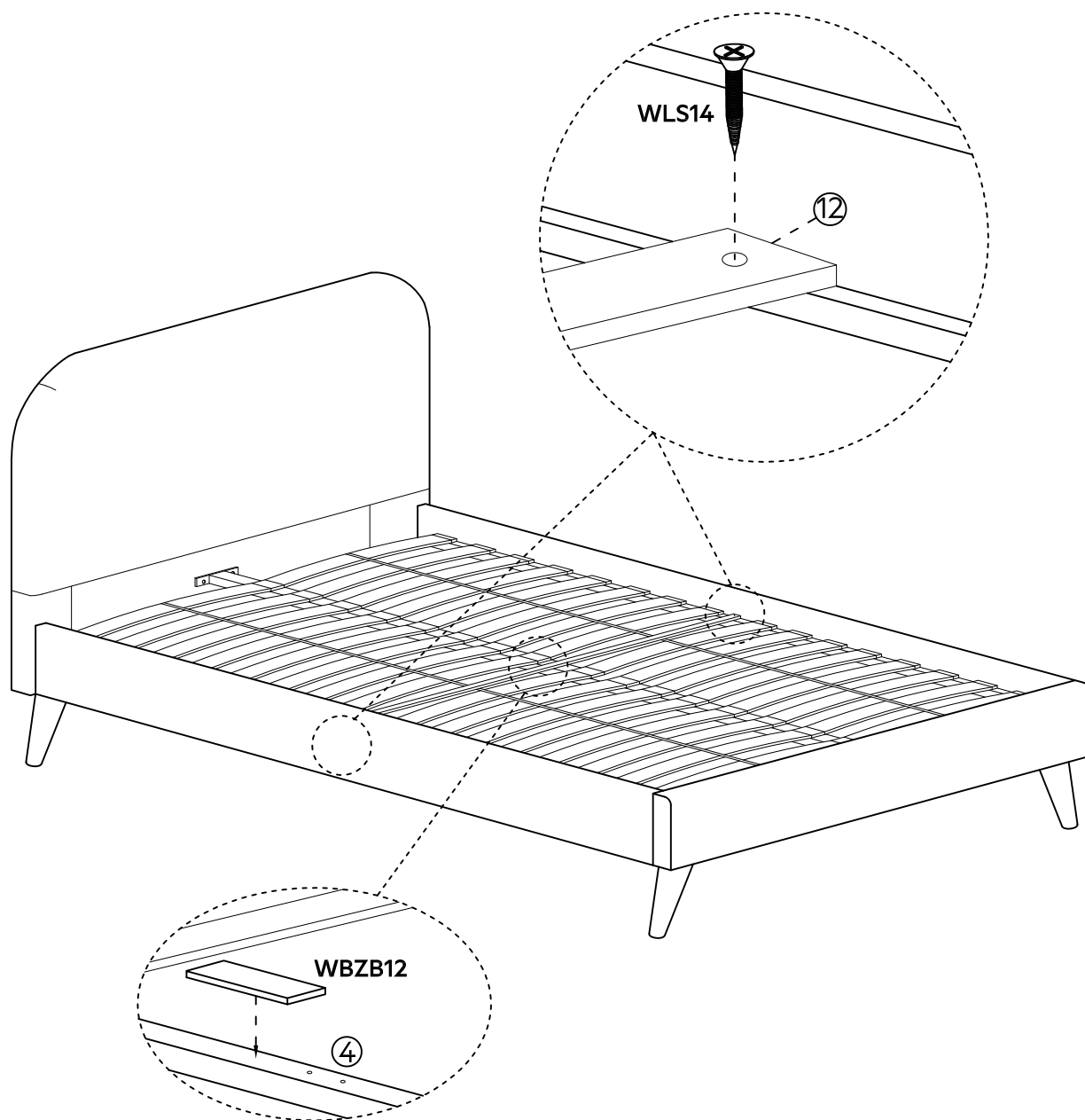

WLS14x2
M8x32mm



WBZB12x1
40x20x3mm

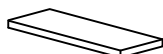

Overall Dimensions (WxLxH cm)

Small Double: 132 x 205 x 104.5/37.5
Double: 147 x 205 x 104.5/37.5
King: 162 x 215 x 104.5/37.5

Internal Dimensions (WxL cm)

122 x 192
137 x 192
152 x 202

Delivery Box Size (HxWxD cm)

	Small Double	Double	King
Box1	10 x 135 x 89	10 x 150 x 89	10 x 165 x 89
Box2	16 x 233 x 23	16 x 233 x 23	16 x 243 x 23
Box3	13 x 64 x 18	13 x 71 x 18	13 x 79 x 20

